

The State of Wisconsin

Office of the Secretary of State

VILLAGE 82

VILLAGE OF BROKAW

COUNTY OF MARATHON

ANNEXATION ORDINANCE NUMBER 2000-4

FILED APRIL 17, 2003

VILLAGE OF BROKAW

P.O. BOX 108
BROKAW, WISCONSIN 54417

V-82

ORDINANCE CERTIFICATION

I, the undersigned Clerk of the Village of Brokaw, Marathon County, Wisconsin, certify that the attached is a true and correct copy of the original annexation ordinance, that the legal title holder of the annexed property is the Village of Brokaw, and that at the time of the adoption of the ordinance there were no electors or other persons residing in the territory to be annexed.

Wayne H. Utecht
VILLAGE CLERK

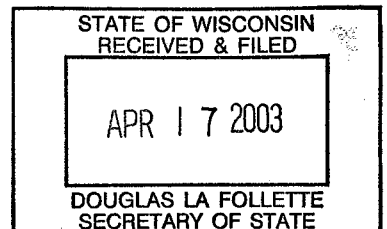

Village of Brokaw
Marathon County, Wisconsin

Ordinance No. 2000-14

It is hereby ordained by the Board of Trustees of the Village of Brokaw, Marathon County, Wisconsin as follows:

1. The following described property is detached from the Town of Maine, Marathon County and annexed as an addition to the Village:

Lot 2 as described in Certified Survey Map #11062 recorded in the office of the Register of Deeds for Marathon County, Wisconsin, in Volume 46 of Certified Survey Maps on page 114 as Document Number 1193589 located in the Southeast Quarter (SE ¼) of the Southeast Quarter (SE ¼) in Section Four (4) and the Southwest Quarter (SW ¼) of the Southwest Quarter (SW ¼) of Section Three (3), all in Township Twenty-nine (29) North, Range Seven (7) East, Town of Maine, Marathon County, Wisconsin.

2. Until such time as it shall be platted and zoned pursuant to recommendation of the village planning commission and approved by the Board of Trustees, the annexed property is temporarily zoned for agricultural use.

Adopted	<u>3/14/2000</u>
Published	<u>3/27/2000</u>
Effective	<u>3/27/2000</u>

Wayne Utecht, Village Clerk

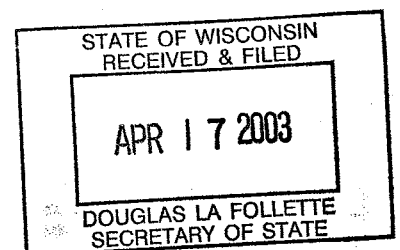

1173587

11062

Lot 1: 052.4.2907.044.0958
 Lot 2: 052.4.2907.044.0957

CERTIFIED SURVEY MAP

MARATHON COUNTY NO. VOL. 11062 PAGE 1

LOCATED IN SE 1/4 SEC 4, SECTION 4, AND SW 1/4 SEC 4, SECTION 3, TOWNSHIP 29 NORTH,

RANGE 7 EAST, TOWN OF MAINE, MARATHON COUNTY

PREPARED BY: VREELAND ASSOCIATES P.O. BOX 41, MOSINEE, WI 54455
 PHONE: (715)693-3979 FAX: (715)693-5439

D.O.T. NO. 37 051-169-99

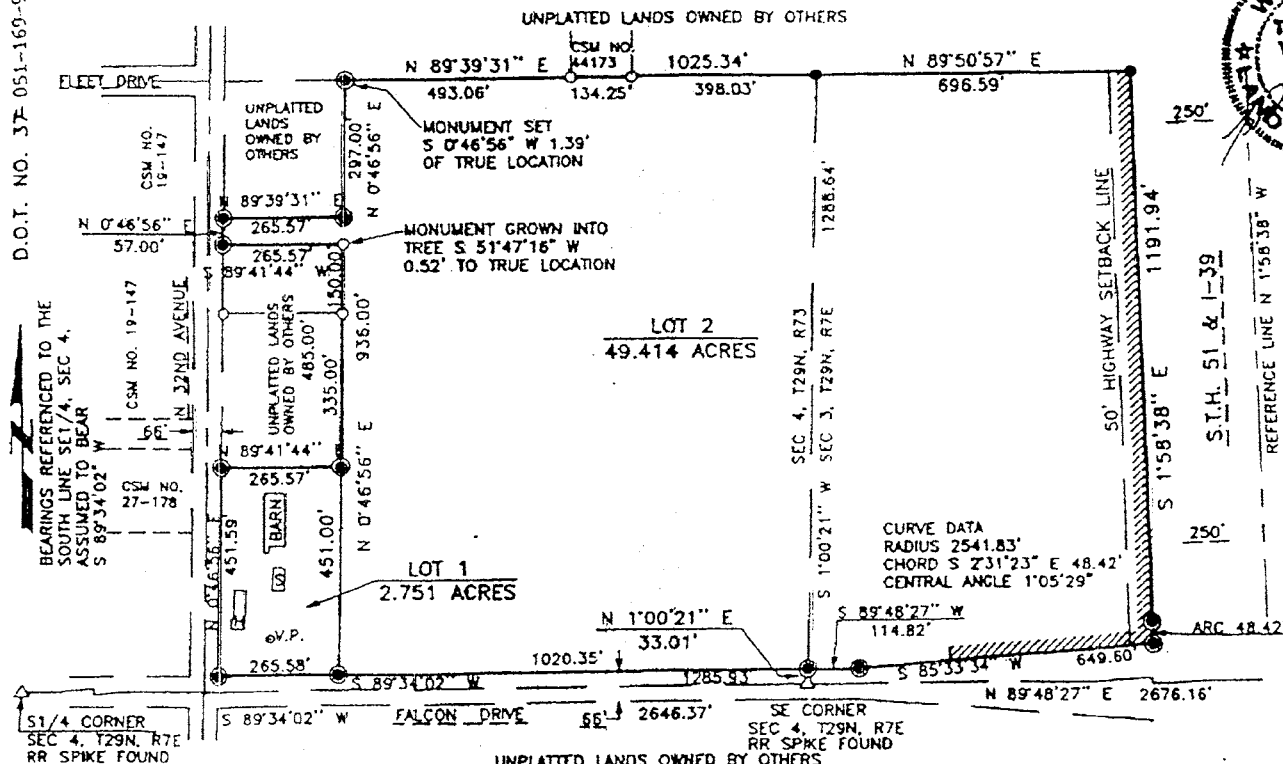

Scale 1" = 300'

UNPLATTED LANDS OWNED BY OTHERS

- LEGEND
- △ = GOVERNMENT CORNER LOCATION PER COUNTY SURVEYORS RECORDS
 - = 3/4in. REBAR FOUND
 - = 1in. IRON PIPE FOUND
 - ⊙ = 7/8in. x 24in. REBAR SET 2.05lb#/# SET
 - /// = NO ACCESS

SEE REVERSE SIDE

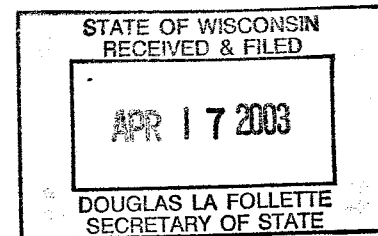

Vol. 46 pg. 117

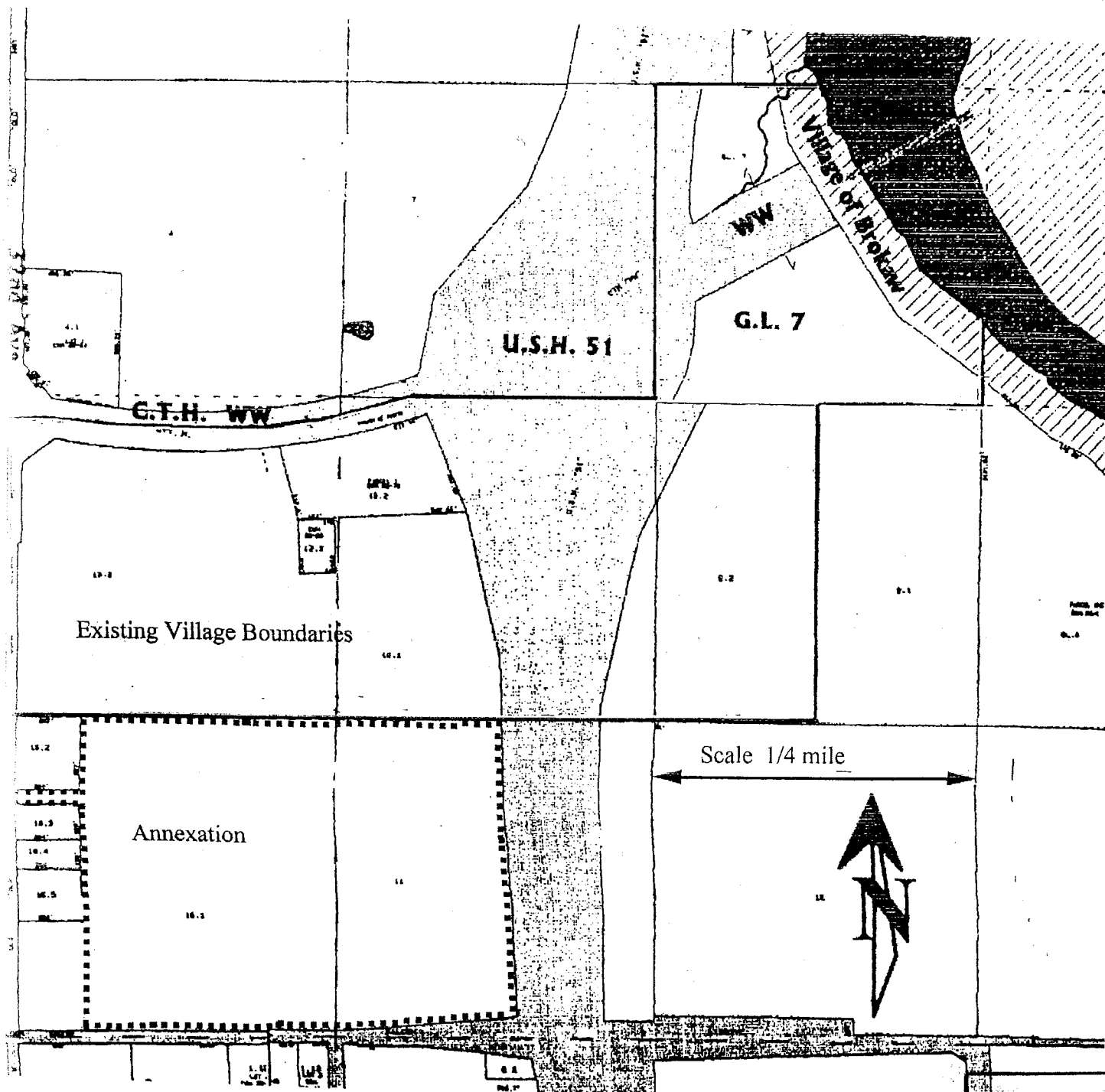

Parts of Sections 3 and 4, Township 29 North, Range 7
East, Marathon County, Wisconsin

Attachment B

DOUGLAS LA FOLLETTE
SECRETARY OF STATE

APR 17 2003

STATE OF WISCONSIN
RECEIVED & FILED

Village of Brokaw

Brokaw WI 54417

January 24, 2001

To : Betty Hoenisch, Clerk
Town of Maine
205 Brentwood Road,
Wausau, WI 54401

Notice of Zoning Change

The Planning Commission of the Village of Brokaw, Marathon County, Wisconsin has proposed a change in the zoning of Lot 2, Marathon County Certified Survey Map Number 11062, formerly owned by Charlotte M. Lemke, from agricultural to residential and multi-family residential classifications. The specific changes are set forth in the accompanying legal description and map.

A hearing will be held on the proposed zoning change on February 13, 2001 at the Brokaw Village Hall commencing at 6:30 P.M.

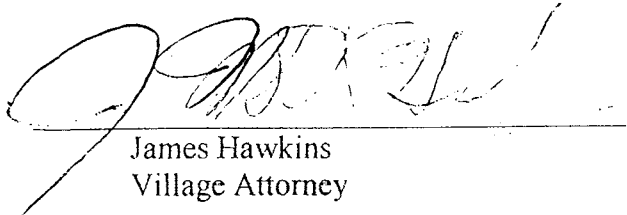

James Hawkins
Village Attorney

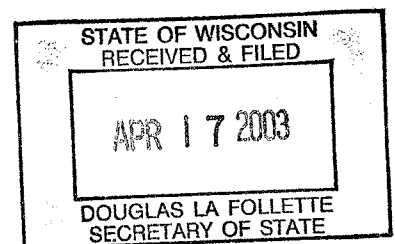

Village of Brokaw

Brokaw WI 54417

Parcel A. Rezone from Agricultural to R-1, Single-Family

Part of Lot 2 of Marathon County Certified Survey Map No. 11062, located in the Southwest 1/4 of the Southwest 1/4 of Section 3 & the Southeast 1/4 of the Southeast 1/4 of Section 4, all in Township 29 North, Range 7 East, Village of Brokaw, Marathon County, Wisconsin more particularly described as follows:

All of said Lot 2 of Marathon County Certified Survey Map No. 11062 recorded in Volume 46 on page 114 at the Marathon County Register of Deeds office located in the Southwest 1/4 of the Southwest 1/4 of Section 3 & the Southeast 1/4 of the Southeast 1/4 of Section 4, all in Township 29 North, Range 7 East EXCEPT the following described parcel;

Commencing at the Northeast corner of said Lot 2; thence S 01° 58' 38"E, 229.08 feet along the East line of said Lot 2 to the point of beginning; thence continuing S 01° 58' 38"E, 962.86 feet along the East line of said Lot 2; thence Southerly feet along the arc of a tangential curve to the left having a radius of 2541.83 feet and a central angle of 1 degree 05 minutes 38 seconds; thence S 85° 32' 46"W, 400.00 feet along the North right-of-way line of Falcon Drive; thence N 00° 1' 33"W, 223.36 feet; thence Northerly 47.16 feet along the arc of a tangential curve to the right having a radius of 67.00 feet and a central angle of 40 degrees 19 minutes 48 seconds; thence N 40° 08' 15" E, 144.25 feet; thence Northerly 93.62 feet along the arc of a tangential curve to the left having a radius of 133.00 feet and a central angle of 40 degrees 19 minutes 48 seconds; thence N 00° 1' 33"W, 231.56 feet; thence Northerly 188.89 feet along the arc of a tangential curve to the left having a radius of 233.00 feet and a central angle of 46 degrees 26 minutes 58 seconds; thence N 04° 58' 29" E, 178.14 feet; thence N 89° 48' 27" E, 282.47 feet to the East line of said Lot 2 and the point of beginning.

That said parcel contains 42.34 acres more or less.

Parcel B. Rezone from Agricultural to R-4 Multi-Family Residential

Part of Lot 2 of Marathon County Certified Survey Map No. 11062 located in the Southwest 1/4 of the Southwest 1/4 of Section 3 & the Southeast 1/4 of the Southeast 1/4 of Section 4, all in Township 29 North, Range 7 East, Village of Brokaw, Marathon County, Wisconsin more particularly described as follows:

Commencing at the Northeast corner of said Lot 2; thence S 01° 58' 38" E, 229.08 feet along the East line of said Lot 2 to the point of beginning; thence continuing S 01° 58' 38"E, 962.86 feet along the East line of said Lot 2; thence Southerly 48.54 feet along the arc of a tangential curve to the left having a radius of 2541.83 feet and a central angle of 1 degree 05 minutes 38 seconds; thence S 85° 32' 46" W, 400.00 feet along the North right-of-way line of Falcon Drive; thence N 00° 1' 33" W, 223.36 feet; thence Northerly 47.16 feet along the arc of a tangential curve to the right having a radius of 67.00 feet and a central angle of 40 degrees 19 minutes 48 seconds; thence N 40° 08' 15"E, 144.25 feet; thence Northerly 93.62 feet along the arc of a tangential curve to the left having a radius of 133.00 feet and a central angle of 40 degrees 19 minutes 48 seconds; thence N 00° 1' 33" W, 231.56 feet; thence Northerly 188.89 feet along the arc of a tangential curve to the left having a radius of 233.00 feet and a central angle of 46 degrees 26 minutes 58 seconds; thence N 04° 58' 29"E, 178.14 feet; thence N 89° 48' 27" E, 282.47 feet to the East line of said Lot 2 and the point of beginning.

That said parcel contains 7.08 acres more or less.

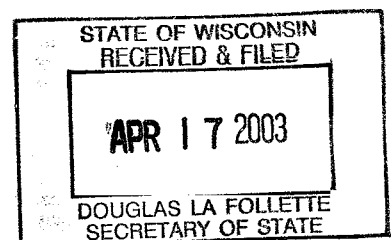

Village of Brokaw

Brokaw Wisconsin 54417

I, Wayne Utecht, clerk of the Village of Brokaw, Marathon County Wisconsin, hereby certify as follows:

1. The Village of Brokaw, Marathon County Wisconsin is a duly incorporated village under the laws of the state of Wisconsin.
2. The Village is legal title holder to certain vacant lands located in the Town of Maine, County of Marathon, described in Attachment A hereto.
3. On March 14, 2000, the Village Board of Trustees, pursuant to notice and at a duly convened regular meeting of the Board of Trustees, enacted an ordinance annexing the described property to the Village. A true copy of said ordinance is attached as Attachment A, together with a scale map, Attachment B.
4. Notice of the proposed annexation was provided to the Town of Maine Clerk, the Marathon County Clerk, and the Wisconsin Department of Administration pursuant to sec 66.021, Attachment C1 and C2.
5. The Wisconsin Department of Administration has reviewed the proposed annexation and found it not to be against the public interest.
6. I have caused a copy of the annexation ordinance to be forwarded to the Marathon County Register of Deeds, the Wisconsin Secretary of State, Wisconsin Public Service Corporation, and the Clerk of the Wausau School District.

5-23-2000

Date

Wayne A. Utecht

Wayne Utecht, Clerk

Village of Brokaw

Marathon County, Wisconsin

Signature of Wayne Utecht authenticated.

James Hawkins
James Hawkins
Village Attorney

This document drafted by James M.D.R. Hawkins

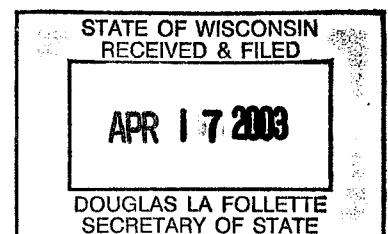

Notice of Proposed Annexation

The Village of Brokaw gives notice of the proposed annexation to the Village of certain lands contained in the Town of Maine, Marathon County, Wisconsin.

1. The lands are more closely described as follows:

Lot 2 as described in Certified Survey Map #11062 recorded in the office of the Register of Deeds for Marathon County, Wisconsin, in Volume 46 of Certified Survey Maps on page 114 as Document Number 1193589 located in the Southeast Quarter (SE $\frac{1}{4}$) of the Southeast Quarter (SE $\frac{1}{4}$) in Section Four (4) and the Southwest Quarter (SW $\frac{1}{4}$) of the Southwest Quarter (SW $\frac{1}{4}$) of Section Three (3), all in Township Twenty-nine (29) North, Range Seven (7) East, Town of Maine, Marathon County, Wisconsin.

2. The described lands are wholly owned by the Village of Brokaw and there are no electors residing on said lands. The proposed annexation comprises approximately 50 acres.
3. A scale map delineating the boundaries of the proposed annexation is attached.

Wayne A. Utecht
Village Clerk

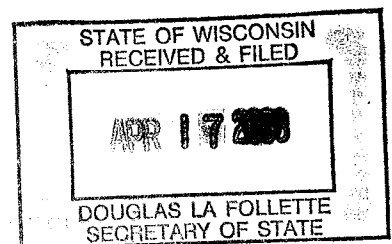

James M.D.R. Hawkins
Attorney

To : Betty Hoenisch, Clerk, Town of Maine, Marathon County
205 Brentwood Road, Wausau, WI 54401
Nan Kottke, Clerk, Marathon County
Marathon County Courthouse
Wisconsin Department of Administration,
Office of Land Information Services
101 East Wilson Street • Madison, WI 53707

Re : Village of Brokaw -- Annexation

Date : April 3, 2000

I am transmitting this notice to you pursuant to sec. 66.021, Wisconsin Statutes.

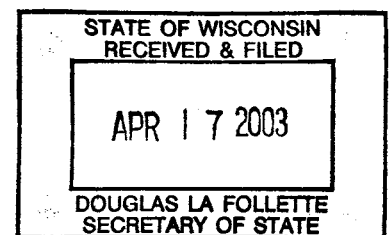
James Hawkins, Village Attorney

Notice of Proposed Annexation

The Village of Brokaw gives notice of the proposed annexation to the Village of certain lands contained in the Town of Maine, Marathon County, Wisconsin.

1. The lands are more closely described as follows:

Lot 2 as described in Certified Survey Map #11062 recorded in the office of the Register of Deeds for Marathon County, Wisconsin, in Volume 46 of Certified Survey Maps on page 114 as Document Number 1193589 located in the Southeast Quarter (SE ¼) of the Southeast Quarter (SE ¼) in Section Four (4) and the Southwest Quarter (SW ¼) of the Southwest Quarter (SW ¼) of Section Three (3), all in Township Twenty-nine (29) North, Range Seven (7) East, Town of Maine, Marathon County, Wisconsin.

2. The described lands are wholly owned by the Village of Brokaw and there are no electors residing on said lands. The proposed annexation comprises approximately 50 acres.
3. A scale map delineating the boundaries of the proposed annexation is attached.

Wayne A. Utecht
Village Clerk

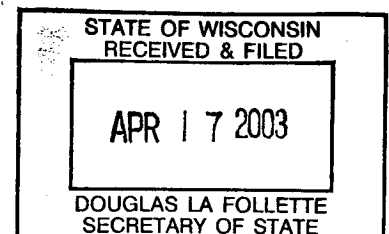

VILLAGE OF BROKAW

P.O. BOX 108
BROKAW, WISCONSIN 54417

March 21, 2003

Annexations and Railroads
Division of Government Records
Office of the Secretary of State
P.O. Box 7848
Madison, WI 53707-7848

Re: Village of Brokaw Annexation.

I was informed by Susan Greeno at the Wisconsin Department of Transportation, Wisconsin Rapids, WI that you have been unable to locate any record of an annexation to the Village of Brokaw in 2000.

Enclosed is a copy of our Ordinance No. 2000-4, along with the property description, showing detachment from the Town of Maine, Marathon County, WI and annexation to the Village of Brokaw.

I contacted our attorney and was told he was sure he sent this information to your office back in 2000, but it may have been lost in the mail or somehow mis-placed.

If you have any questions, please call me.

Sincerely,

Wayne H. Utecht

Wayne H. Utecht, Clerk
Village of Brokaw

P.S. I, Wayne H. Utecht, Clerk of the Village of Brokaw do hereby certify the area annexed was vacant farm land resulting in no increase in population for the Village.

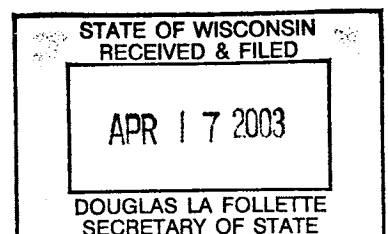

VILLAGE OF BROKAW

P.O. BOX 108
BROKAW, WISCONSIN 54417

March 21, 2003

Susan Greeno
Wisconsin Department of Transportation
Division of Transportation Districts-4
1681 Second Avenue South
Wisconsin Rapids, WI 54495-4722

RE. Village of Brokaw Annexation.

Dear Ms. Greeno:

Per your E-Mail of 3/20/03, enclosed are the documents you requested. I have also enclosed a copy of our River Ridge Sub-Division plat map showing the streets we have been talking about.

I have also sent this information to the Secretary of State. I talked to our attorney and he said he was sure he sent this in back in 2000, but it may have been lost in the mail or somehow mis-placed.

If you have any questions, please call me.

Sincerely,

Wayne H. Utecht

Wayne H. Utecht, Clerk
Village of Brokaw

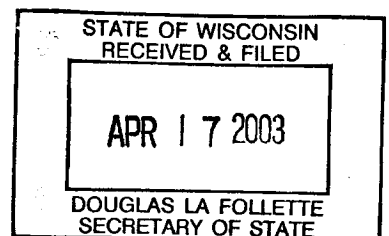

VILLAGE OF BROKAW

P.O. BOX 108

BROKAW, WISCONSIN 54417

March 21, 2003

Annexations and Railroads
Division of Government Records
Office of the Secretary of State
P.O. Box 7848
Madison, WI 53707-7848

Re: Village of Brokaw Annexation.

I was informed by Susan Greeno at the Wisconsin Department of Transportation, Wisconsin Rapids, WI that you have been unable to locate any record of an annexation to the Village of Brokaw in 2000.

Enclosed is a copy of our Ordinance No. 2000-4, along with the property description, showing detachment from the Town of Maine, Marathon County, WI and annexation to the Village of Brokaw.

I contacted our attorney and was told he was sure he sent this information to your office back in 2000, but it may have been lost in the mail or somehow mis-placed.

If you have any questions, please call me.

Sincerely,

Wayne H. Utecht

Wayne H. Utecht, Clerk
Village of Brokaw

P.S. I, Wayne H. Utecht, Clerk of the Village of Brokaw do hereby certify the area annexed was vacant farm land resulting in no increase in population for the Village.

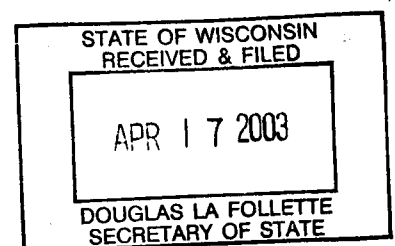

Subj: **Village of Brokaw Street Annexations**
Date: 3/20/2003 11:06:24 PM Central Standard Time
From: Vilbro
To: Vilbro

Subj: **FW: Village of Brokaw Street Annexations**
Date: 3/20/2003 12:57:05 PM Central Standard Time
From: susan.greeno@dot.state.wi.us (Greeno, Susan)
To: Vilbro@aol.com (Vilbro@aol.com)

Wayne, I had our Central Office look for this annexation after I found nothing in our District office. They came up empty handed also. Could you please send me a copy of the ordinance and legal description so I can at least get it drawn on for this year. You will also have to send a complete copy of the ordinance along with map and legal description to the Secretary of States office in Madison. That is where they originally go and it then gets filtered down to me.

Thanks any questions please contact me.

Susan Greeno
District 4 Local Roads/Traffic Count Coordinator
office: 715-421-8343
cell: 715-459-4285

-----Original Message-----

From: Schieldt, Kelly
Sent: Thursday, March 20, 2003 12:05 PM
To: Greeno, Susan
Subject: RE: Village of Brokaw Street Annexations

Hey Sue,

I checked 2000, 2001 and even 2002 for this annexation. I have no record of this annexation.
Are they sure they submitted the completed ordinance to the SOS office?

-----Original Message-----

From: Greeno, Susan
Sent: Tuesday, March 04, 2003 8:02 AM
To: Schieldt, Kelly
Subject: FW: Village of Brokaw Street Annexations

Kelly, I have no record of this annexation. Could you look down there? I know you are really busy right now but there are new streets that are in this area they say is annexed.

-----Original Message-----

From: Vilbro@aol.com [mailto:Vilbro@aol.com]
Sent: Monday, March 03, 2003 2:49 PM
To: susan.greeno@dot.state.wi.us
Subject: Village of Brokaw Street Annexations

The streets we talked about are North 28th Avenue and Flagstone Lane which are new streets which were constructed in our River Ridge Sub-Division and

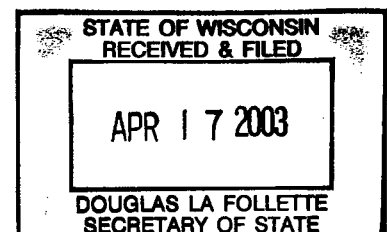

opened to the public in October of 2002. The Area involved was a vacant farm in the Town of Maine which was annexed to the Village of Brokaw by our Ordinance #2000-4 adopted on 3/14/2000 effective 3/27/2000.

If you have problems locating the ordinance, call me at (715) 675-8712 and I will send you a copy

Village of Brokaw
Wayne H. Utecht, Clerk
P.O. Box 108
Brokaw, WI 54417-0108

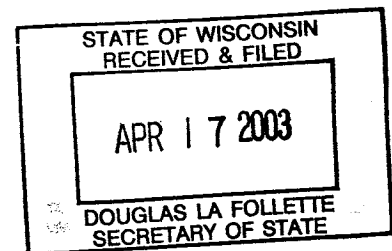

Subj: **Annexation**
Date: 3/28/2003 3:18:57 PM Central Standard Time
From: Vilbro
To: Vilbro

Subj: **Annexation**
Date: 3/27/2003 11:23:45 AM Central Standard Time
From: susan.greeno@dot.state.wi.us (Greeno, Susan)
To: Vilbro@aol.com (Vilbro@aol.com)

I received the copy of the ordinance, thank you very much. We will be getting this on for this years cert. cycle so the Village can claim the new roads. I believe that the attorney sent the original to the Department of Administration instead of the Secretary of States office. That is what it looks like reading through all the papers you sent to me. So just that they know in the future the original gets sent to the Secretary of States office and they forward a copy to Department of Administration. The S.O.S. is the office that approves the annexations.
Any questions let me know.

Susan Greeno
District 4 Local Roads/Traffic Count Coordinator
office: 715-421-8343
cell: 715-459-4285

