

The State of Wisconsin

Office of the Secretary of State

CITY 125

CITY OF STOUGHTON

COUNTY OF DANE

ANNEXATION ORDINANCE NUMBER O-10-05

FILED APRIL 4, 2005

C-125

CITY OF STOUGHTON

April 4, 2005

381 East Main Street
Stoughton, WI 53589

(608) 873-6677

Mr. Douglas LaFollette
Wisconsin Secretary of State
PO Box 7848
Madison WI 53707-7848

Dear Mr. LaFollette:

I, Luann J. Alme, City Clerk of the City of Stoughton, County of Dane, State of Wisconsin, pursuant to Section 66.021 of the Wisconsin Statutes, do hereby certify adoption of Annexation Ordinance O-10-05.

An accurate metes and bounds description of the territory so affected is attached. The population of the annexed area is 0.

Sincerely,



Luann J. Alme
City Clerk

Enc.

Cc: Dane County Register of Deeds
Clerk, Town of Dunkirk
Dane County Clerk
Dane County Property Listing, Land Regulations
Wisconsin Power & Light Company
Stoughton Municipal Utilities
Stoughton Area School District
Dane County Treasurer
Ameritech
Waste Management
Stoughton Police Chief Patrick O'Connor
Charter Communications
Accurate Appraisals
Martin Lamers, Fire Chief
Karl Manthe, Street Superintendent
Cathy Rigdon, Stoughton Area EMS Director

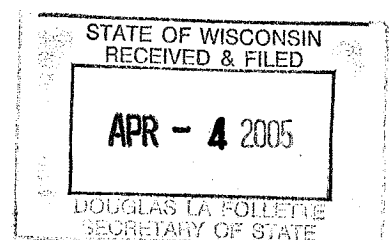
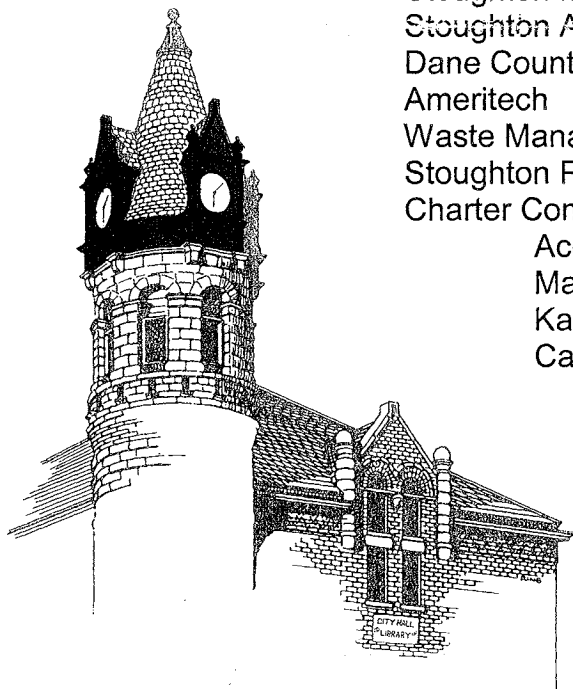

Title of Document

Name and return address

City of Stoughton
Luann J. Alme, City Clerk
381 E. Main Street
Stoughton WI 53589

26/0511-071-0388-5

Parcel Identification Number

STATE OF WISCONSIN
RECEIVED & FILED

APR - 4 2005

DOUGLAS LA FOLLETTE
SECRETARY OF STATE

ANNEXATION ORDINANCE

The Common Council of the City of Stoughton, Dane County, Wisconsin, do ordain as follows:

Section 1. The following described tract of land owned by the following: Alvin O. Stockstad, in the Town of Dunkirk, County of Dane, State of Wisconsin, and lying adjacent to the City of Stoughton, is hereby annexed to the City of Stoughton, and hereby made and constituted a part of the Third Aldermanic District and Census Ward 7 of said City, viz.:

LEGAL DESCRIPTION

A parcel of land located in the Town of Dunkirk, Dane County, Wisconsin, to-wit:

ERICKSON PARK PRT LOT NE OF HWY EXC E 1 RD VOL M 251 P 400. Being said lot 8 Erickson Park subdivision north to the municipal boundary at approximately the center line of Hamilton Street. Said parcel contains .13 acres.

Section 2. This ordinance shall take effect upon its passage and publication.

Adopted on roll call at a regular meeting of the Common Council of the City of Stoughton held on the 8th day of March, 2005.

VOTE:

Ayes: 11

Noes: 0

Adopted: 3-8-05

Published: 4-7-05

APPROVED:



Helen J. Johnson, Mayor

ATTEST:

Luann J. Alme, City Clerk

f:\common\lja\ord&res\annexstockstad-hamiltonrevised

This is to certify that this is a true and correct copy of Ordinance 0-10-05 adopted by the Common Council of the City of Stoughton on 3-8-05.

Luann J. Alme
City Clerk
City of Stoughton

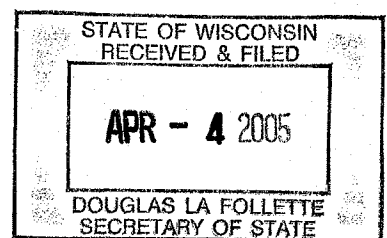

**Petition for Annexation by Alvin O Stockstad
Direct Annexation By Unanimous Approval**

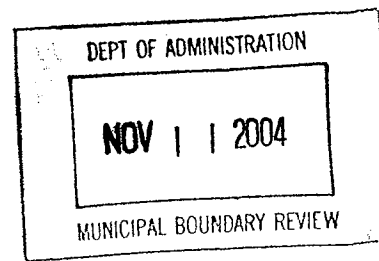

I, the undersigned owner of lot 8 Erickson park Subdivision in the town of Dunkirk, Dane County, Wisconsin, lying contiguous to the city of Stoughton, petition the common council of the City of Stoughton to annex the territory described below and shown on the attached map to the City of Stoughton, Dane County, Wisconsin.

(Please See Attached Description and Scale Map)

The Current population of the territory is zero (0).

I, the undersigned owner of the property elect that this annexation shall take effect to the full extent consistent with outstanding priorities of other annexation, incorporation or consolidation proceedings, if any-

Dated this the 27th day of October, 2004.

A handwritten signature in black ink, appearing to read "Alvin O. Stockstad".

Alvin O Stockstad
Owner
209 Lincoln St.
Stoughton WI 53589
608-873-3969

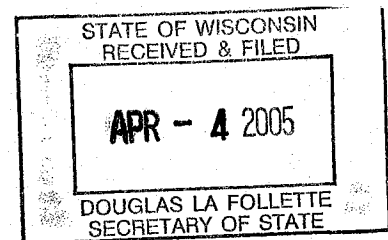

Parcel Description

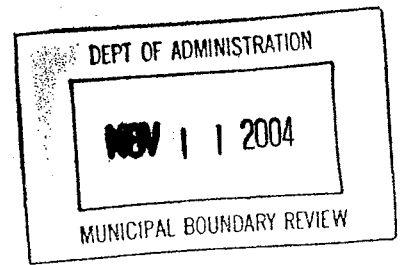

Parcel Number :- 26/0511-071-0388-5

Municipality: Town of Dunkirk

Lot size: .13 acres

Property Tax Description: ERICKSON PARK PRT LOT NE OF HWY EXC E 1 RD VOL M
251 P 440

Property for Annexation: Lot 8 Erickson park subdivision to the center line of Hamilton St.

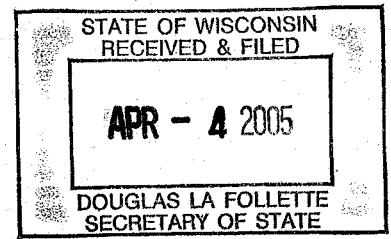

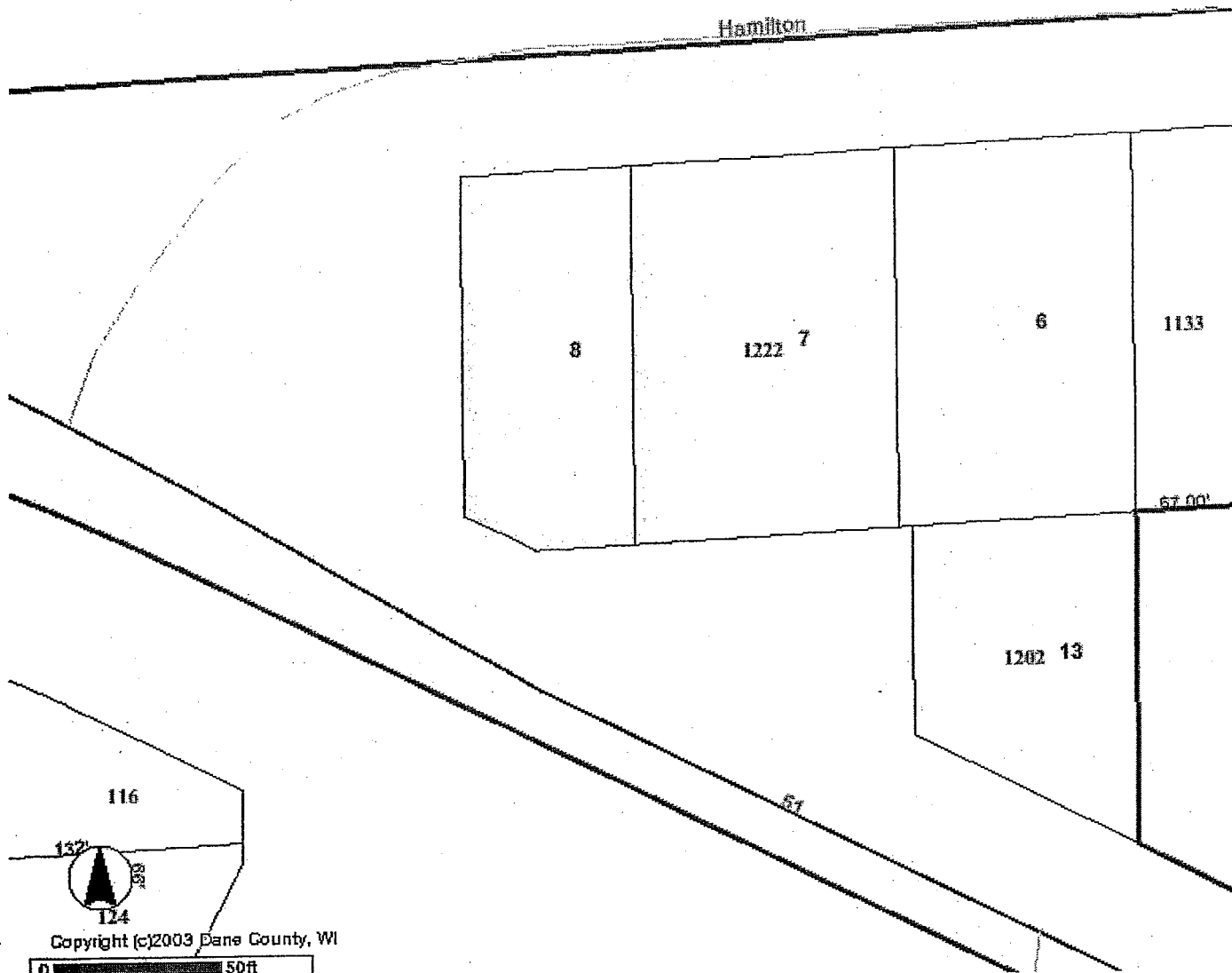

DEPT OF ADMINISTRATION

NOV | | 2004

MUNICIPAL BOUNDARY BOARD

STATE OF WISCONSIN
RECEIVED & FILED

APR - 4 2005

DOUGLAS LA FOLLETTE
SECRETARY OF STATE

Stockstad Annexation

Print

Close

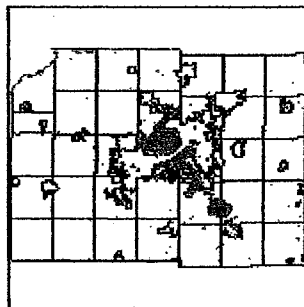
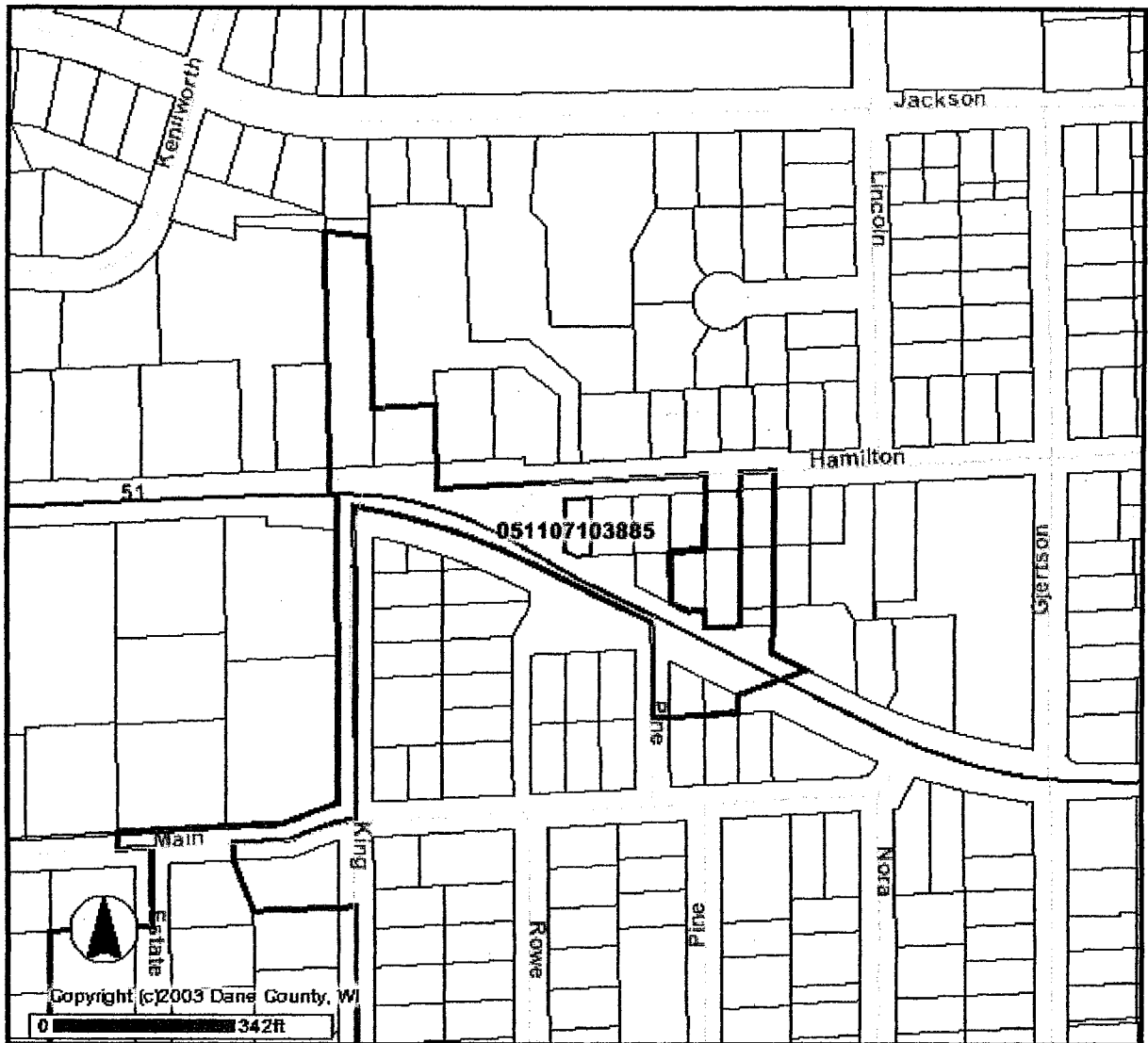
**DISCLAIMER**

This map was prepared using the Dane County DCIMap online geographic information system. All information is believed accurate but is NOT guaranteed to be without error. This map and its underlying data is intended to be used as a general index to land related information and is not intended for detailed, site-specific analysis. Dane County GIS datasets used to produce this map are copyrighted.

STATE OF WISCONSIN
RECEIVED & FILED

APR - 4 2005

DOUGLAS LA FOLLETTE
SECRETARY OF STATE