

The State of Wisconsin

Office of the Secretary of State

CITY 39

CITY OF STEVENS POINT

COUNTY OF PORTAGE

ANNEXATION

FILED OCTOBER 28, 2005

C-39

City of Stevens Point
1515 Strongs Avenue
Stevens Point, WI 54481-3594
FAX 715-346-1498



John Moe
City Clerk
715-346-1569

October 24, 2005

Annexations and Railroads
Division of Government Records
Office of the Secretary of State
P.O. Box 7848
Madison, WI 53707-7848

RE: Annexation from Town of Hull - Misiewicz Annexation
Annexation - 135 Green Avenue North
Approximately 0.38 acres - File #1809

Enclosed is a copy of an ordinance annexing territory to the City of Stevens Point, along with a map and certification.

This parcel was annexed from the Town of Hull. The current population of the area to be annexed is 2.

John Moe/ky
City Clerk

Enclosures

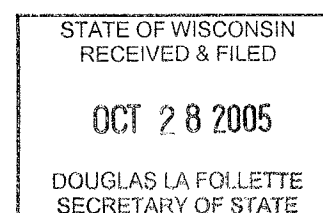

City of Stevens Point
1515 Strongs Avenue
Stevens Point, WI 54481-3594
FAX 715-346-1498

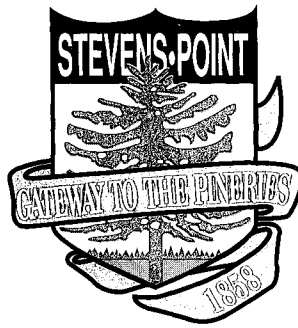

John Moe
City Clerk
715-346-1569

STATE OF WISCONSIN)

COUNTY OF PORTAGE)

I, John Moe, hereby certify that I am the duly elected City Clerk of the City of Stevens Point, Wisconsin, a Municipal Corporation. I further certify that I have compared the attached ordinance annexing territory to the City of Stevens Point with the original in my possession and that the same is a true, correct and complete copy thereof.

City population was increased by two as a result of this annexation.

IN WITNESS WHEREOF, I have hereto set my hand and the seal of said City at the City of Stevens Point, Wisconsin, this 24th day of October, 2005.



John Moe, City Clerk

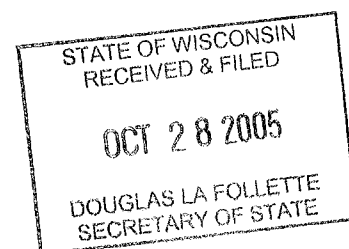

OCT 28 2005

DOUGLAS LA FOLLETTE
SECRETARY OF STATE

**AN ORDINANCE ANNEXING TERRITORY
TO THE CITY OF STEVENS POINT, WISCONSIN**

(135 Green Avenue North)

The Common Council of the City of Stevens Point, Wisconsin, do ordain as follows:

SECTION I: Territory Annexed. In accordance with Section 66.0217 of the Wisconsin Statutes, the following described territory in the Town of Hull, Portage County, Wisconsin, is annexed to the City of Stevens Point, Wisconsin:

That part of the Southeast Quarter of the Northwest Quarter of Section 27, Township 24 North, Range 8 East, Town of Hull, Portage County, Wisconsin described as follows:

Commencing at the northwest corner of said Section 27; thence North 89 degrees 37 minutes 30 seconds East 1,302.83 feet; thence South 00 degrees 30 minutes 20 seconds East 1,344.03 feet to the northwest corner of said Southeast Quarter of the Northwest Quarter; thence South 00 degrees 03 minutes 05 seconds West along the west line of said Southeast Quarter of the Northwest Quarter 850 feet to it's the intersection with the north line of the south 100 feet of the north 950 feet of said Southeast Quarter of the Northwest Quarter; thence North 88 degrees 42 minutes 40 seconds East on a line parallel with the north line of said Southeast Quarter of the Northwest Quarter 33 feet to the east right of way line of Green Avenue North and the **Point of Beginning of this annexation** said point also being the southeast corner of Green Avenue North and Doolittle Drive; Thence continuing North 88 degrees 42 minutes 40 seconds East along said south right of way line of Doolittle Drive 167 feet to the east line of the west 200 feet of said Southeast Quarter of the Northwest Quarter; thence South 00 degrees 03 minutes 05 seconds West along said east line 100 feet to the south line of the north 950 feet of said Southeast Quarter of the Northwest Quarter; thence South 88 degrees 42 minutes 40 seconds West along said south line to 167 feet to the east right of way line of Green Avenue North; thence North 00 degrees 03 minutes 05 seconds East along said right of way line 100 feet to the point of beginning and there terminating. Said annexation contains 0.38 acres.

SECTION II: Effect of Annexation. From and after the date of this ordinance, the territory described in Section I shall be a part of the City of Stevens Point for any and all purposes provided by law and all persons coming or residing within such territory shall be subject to all ordinances, rules and regulations governing the City of Stevens Point.

SECTION III: Zoning Classification. Such land shall be temporarily designated as

"R-2" Single Family Zoning.

SECTION IV: Legislative District and Aldermanic District Designation. The territory described above is hereby made a part of the **71st Assembly District** and **8th Aldermanic District** of the City of Stevens Point subject to the ordinances, rules and regulations of the City governing districts.

SECTION V: Severability. If any provision of this ordinance is invalid or unconstitutional or if the application of this ordinance to any person or circumstance is invalid or unconstitutional, such invalidity or unconstitutionality shall not affect any provisions or applications of this ordinance which can be given effect without the invalid or unconstitutional provision or application.

SECTION VI: Tax Payment. The City of Stevens Point shall pay annually to the Town of Hull for a period of five years, an amount equal to the amount of property taxes that the Town levied for municipal purposes on the annexed territory, as shown by the tax roll under State Statute 70.65, in the year in which the annexation is final.

SECTION VII: Effective Date. This ordinance shall take effect upon passage and publication as provided by law.

APPROVED: _____

Gary W. Wescott, Mayor

ATTEST: _____

John Moe, City Clerk

Dated: October 17, 2005
Adopted: October 17, 2005
Published: October 21, 2005

ANNEXATION MAP

FOR
JOSEPH A. & REGINA R.
MISIEWICZ

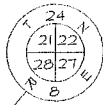

SECTION CORNER
P.O.C.



75' 0 100'
50' 300'
SCALE

N88°37'30"E 1302.83' 1/16 CORNER

500°30'20"E 1344.03'

135 GREEN AVENUE NORTH
0.38 ACRES

NORTH LINE SE-NW

NORTHWEST CORNER
SE-NW SECTION 27, T24N,R8E

MITCHELL DRIVE

KENNEDY DRIVE

INTERSTATE 39

GREEN AVENUE NORTH

500°03'05"N 850'
WEST LINE SE-NW

NORTH
150'

SE-NW

P.O.B.

N88°42'40"E 167'

DOOLITTLE DRIVE

N88°42'40"E 33'

N00°03'05"E 100'

500°03'05"N 100'

588°42'40"W 167'

WEST
200'

TOWN OF HULL

CITY OF STEVENS POINT

EAST MARIA DRIVE

SOUTH LINE SE-NW

STATE OF WISCONSIN
RECEIVED & FILED

OCT 28 2005

DOUGLAS LA FOLLETTE
SECRETARY OF STATE

RECEIVED

SEP 23 2005

CITY CLERK'S
OFFICE

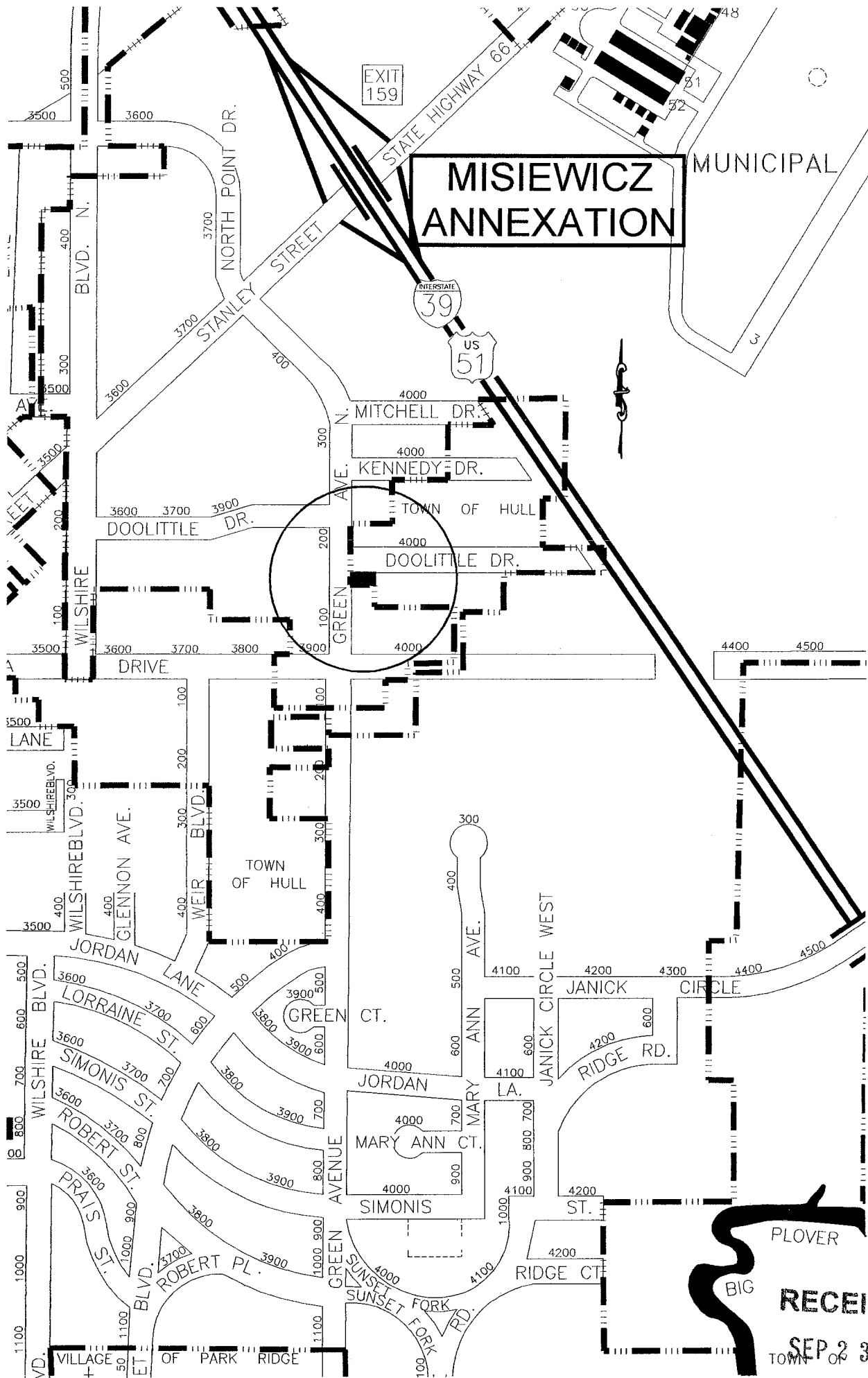

EXIT 159

MISIEWICZ ANNEXATION

INTERSTATE 39

US 51

MUNICIPAL

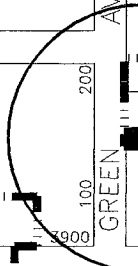

RECEIVED

SEP 23 2005

CITY CLERK'S OFFICE