

ORD9101

**CITY of WATERTOWN**

MEMBER: LEAGUE OF WISCONSIN MUNICIPALITIES

ORD# 00-11

August 10, 2007

Annexations, Railroads Div. of Gov  
Office of Secretary of State  
PO Box 7848  
Madison, WI 53707-7848

Dear Secretary of State,

Enclosed please find the ordinances, annexations and maps for the City of Watertown from 1995 to present. I have also enclosed the list of ordinances from 1995 until present. You may or may not have some of these already.

If you have further questions, please contact me at (920) 262-4009.

Sincerely,



Michael H. Hoppenrath  
City Clerk/Treasurer

MHH/sm

Enclosures

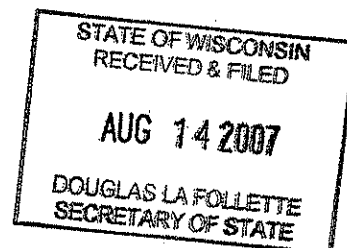

C-40

STATE OF WISCONSIN )  
 )  
JEFFERSON COUNTY )

I, Michael H. Hoppenrath, hereby certify that I am the duly appointed qualified City Clerk of the City of Watertown, Wisconsin, a Municipal Corporation, and as such official, I am the legal custodian of all papers and records of said City. I further certify that I have compared the attached Ordinance #00-11 - An ordinance annexing property to the City of Watertown with the original in my possession and that the same is a true, correct and complete copy thereof.

I further certify that the petition for direct annexation currently reflects four (4) total residents of the area annexed.

IN WITNESS WHEREOF, I have hereto set my hand and the seal of said City at the City of Watertown, Wisconsin, this 5<sup>th</sup> day of May 2000.

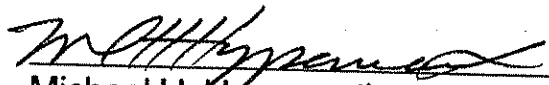
  
Michael H. Hoppenrath  
City Clerk

(SEAL)

STATE OF WISCONSIN  
RECEIVED & FILED  
AUG 14 2007  
DOUGLAS LA FOLLETTE  
SECRETARY OF STATE

1036143

Document No.

Document Title

**ANNEXATION ORDINANCE**

**Sponsor Mayor Smith  
From: Plan Commission**

WHEREAS, Thomas E. Funk and Heidi M. Funk, owners, have filed with the Common Council a Petition for the Annexation of real estate to the City of Watertown, Jefferson County, Wisconsin; and

WHEREAS, a copy of said Petition has been reviewed by the Watertown Plan Commission and the State Department of Administration, and has been given to the Town Board of the Town of Watertown in compliance with Section 66.021 (12) of the Wisconsin Statutes; and

WHEREAS, the Watertown Plan Commission and the Wisconsin Department of Administration have indicated their support for the annexation:

NOW, THEREFORE, THE COMMON COUNCIL OF THE CITY OF WATERTOWN DO ORDAIN AS FOLLOWS:

SECTION 1. That the following described real estate be, and the same is, hereby annexed to the corporate city limits of the City of Watertown, from the Town of Watertown, Jefferson County, Wisconsin, to-wit:

The Southwest ¼ of the Southwest ¼ of Section 16, Township 8 North, Range 15 East, Town of Watertown, Jefferson County, Wisconsin, containing 40 acres more or less.

IT IS FURTHER ORDAINED AS FOLLOWS:

That the above described real estate shall be made a part of the Eighth (8<sup>th</sup>) Aldermanic District, Nineteenth (19<sup>th</sup>) Ward of the City of Watertown, Jefferson County, Wisconsin.

(April 3, 2000) Ord. #00-11

**VOL 1146 PAGE 601**

RECEIVED FOR RECORD  
at 10:30 o'clock A . M

*[Signature]*  
**APR 28 2000**  
Register of Deeds  
Jefferson County, WI

RETURN TO:  
MIKE HOPPENRATH  
106 JONES STREET  
WATERTOWN, WI 53094

032-0815-1633-000  
Parcel No.  
N8577 Airport Rd., Watertown  
Address

STATE OF WISCONSIN  
RECEIVED & FILED  
**AUG 14 2007**  
DOUGLAS LA FOLLETTE  
SECRETARY OF STATE

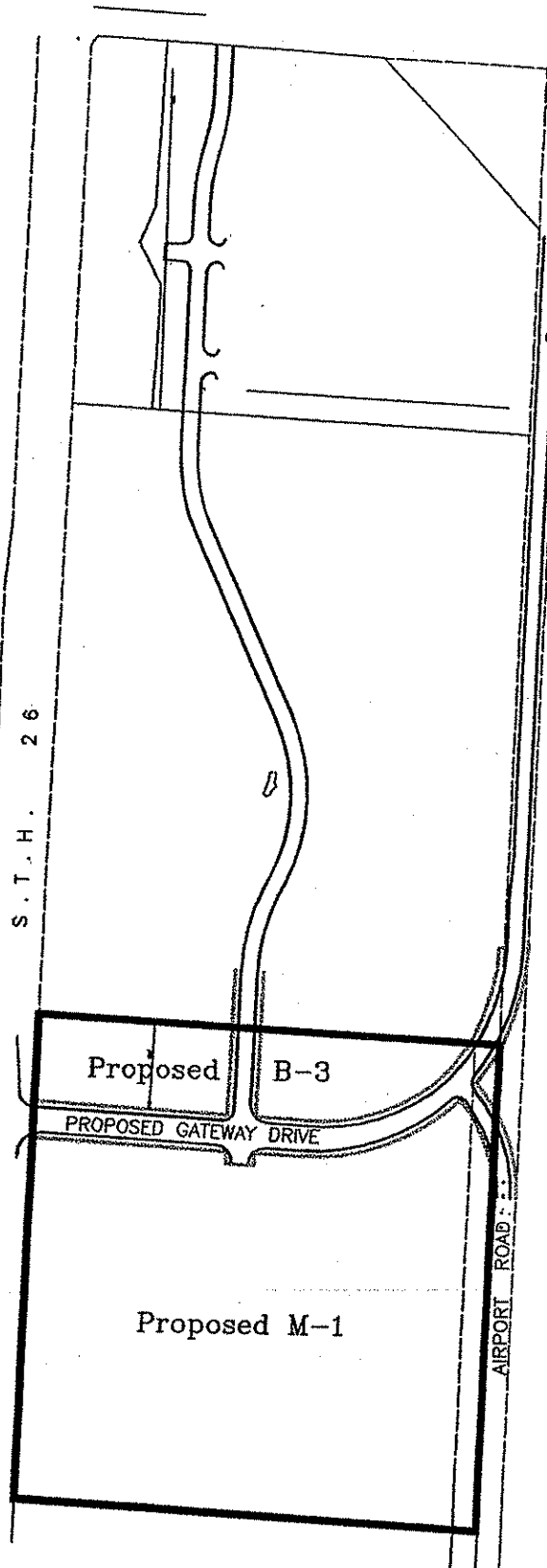

STATE OF WISCONSIN  
RECEIVED & FILED  
  
AUG 14 2007  
  
DOUGLAS LA FOLLETTE  
SECRETARY OF STATE

**PROPOSED ANNEXATION**

SCALE: 1" = 500'  
3-00



IT IS FURTHER ORDAINED AS FOLLOWS:

That the above-described real estate shall be zoned as follows:

All that portion lying north of a proposed east-west street right-of-way (proposed to be named Gateway Drive) shall be zoned B-3, General Business. All that portion lying south of said proposed right-of-way shall be zoned M-1, Light Manufacturing.

SECTION 2. All ordinances or parts of ordinances inconsistent with the provisions of this ordinance are hereby repealed.

SECTION 3. This ordinance shall take effect and be in force the day after its passage and publication.

DATE:	4.3.00		4-18.00	
	1 <sup>ST</sup>		2 <sup>ND</sup>	
READING:	YES	NO	YES	NO
KELM	1/		/	
RADTKE	/		/	
BERG	/		1/	
KUEHL (HERBER)	/		/	
BLESKE	/		/	
DAVID	/		2/	
BUMGARDANER	/		/	
KRUEGER (BATEL)	2/		/	
MILLER	/		/	
MAYOR SMITH				
TOTAL	9	0	9	0

Adopted 18 April 2000

*Michael W. Hoppenrath*  
City Clerk/Treasurer

Approved 19 April 2000

*F.H. Smith*  
Mayor

This is to certify that this is the original copy of this ordinance and in witness thereof I affix my signature and the seal of the City of Watertown this 27th day of April 2000.

This is to certify that I have compared the attached copy with the original record now on file in my office and that the same is a correct transcript thereof and of the whole thereof. In Testimony Whereof, I have hereunto subscribed my name and affixed the seal of the City of Watertown this 27th day of April, 2000.

*Michael W. Hoppenrath*  
City Clerk/Treasurer

STATE OF WISCONSIN  
RECEIVED & FILED  
**AUG 14 2007**  
DOUGLAS LA FOLLETTE  
SECRETARY OF STATE

*Michael W. Hoppenrath*  
Michael W. Hoppenrath City Clerk

(April 3, 2000) Ord. #00-11

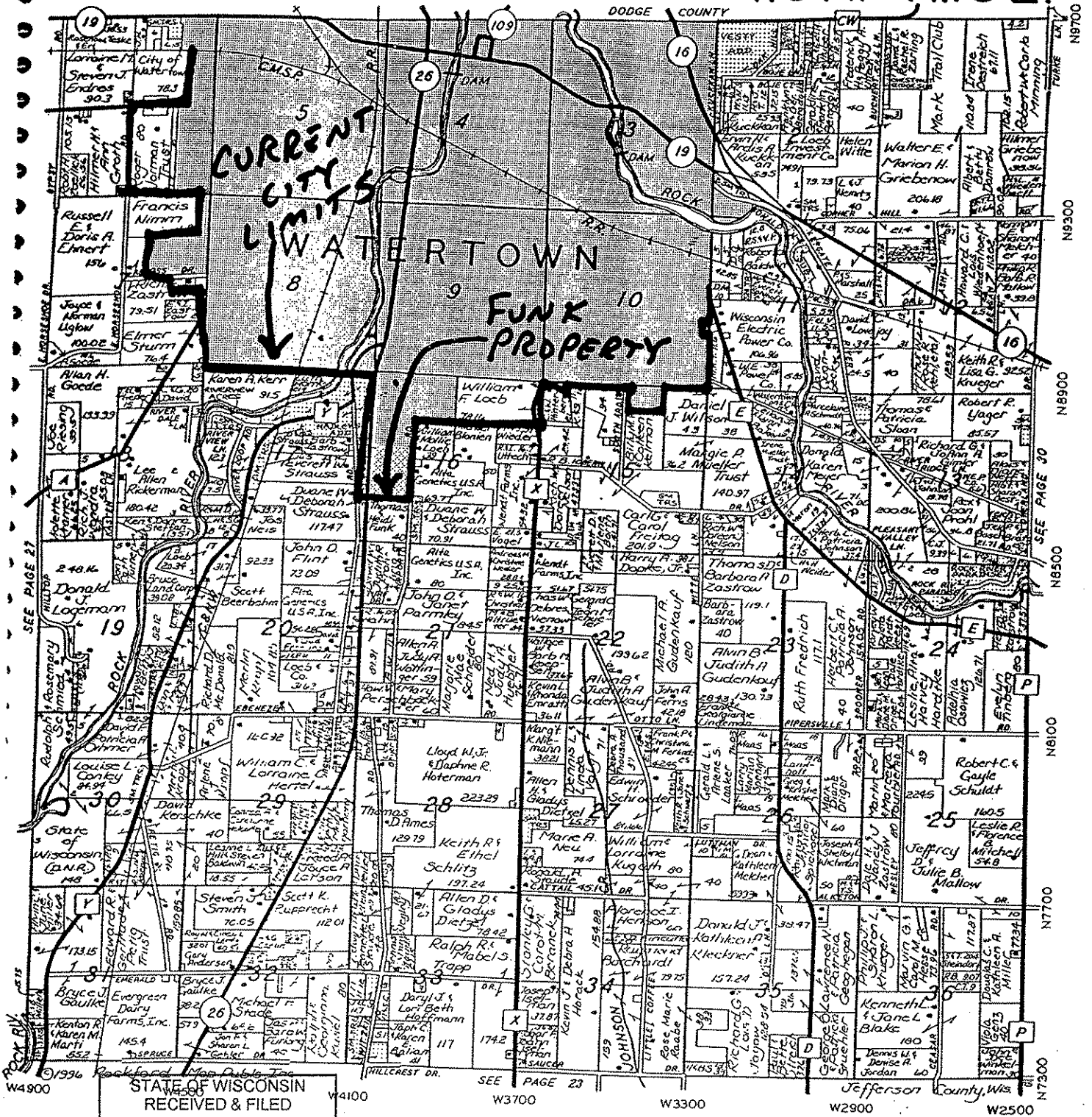

STATE OF WISCONSIN RECEIVED & FILED

AUG 14 2007

DOUGLAS LA FOLLETTE SECRETARY OF STATE

**MID-STATE EAST, INC.**

N8690 High Road — Highway 26 South  
Watertown, Wisconsin

**(414) 593-8540 or (414) 261-8118**

Store Hours:

7:30 - 5:00 Monday thru Friday • 7:30 - 3:00 Saturday

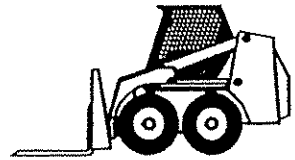

**PETITION FOR DIRECT ANNEXATION**  
**PURSUANT TO SECTION 66.021(2)(a), WISCONSIN STATUTES**

The purpose of this Petition is to petition the City of Watertown, Wisconsin, to annex the territory described in this Petition to the City of Watertown.

The undersigned, being the sole qualified electors residing in, and all of the owners of the land within, the following territory in the Town of Watertown, Jefferson County, Wisconsin, lying contiguous to the City of Watertown, petitions the Common Council of the City of Watertown to annex the territory described below and shown on the attached scale map to the City of Watertown, Wisconsin:

The following land owned by Thomas E. Funk and Heidi M. Funk:

The Southwest 14/ of the Southwest ¼ of Section 16, Township 8 North, Range 15 East, Town of Watertown, Jefferson County, Wisconsin.

The area of the territory to be annexed is 40 acres, more or less. The number of qualified electors presently residing in the area to be annexed is two.

The undersigned intend that this annexation shall take effect to the full extent consistent with outstanding priorities of other annexation, incorporation or consolidation proceedings, if any.

DATE: 3/21/00

Thomas E. Funk  
Thomas E. Funk

DATE: 3/21/00

Heidi M. Funk  
Heidi M. Funk

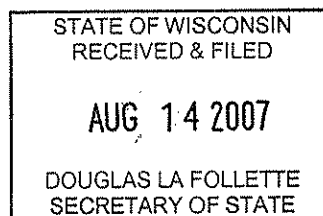

1320 feet

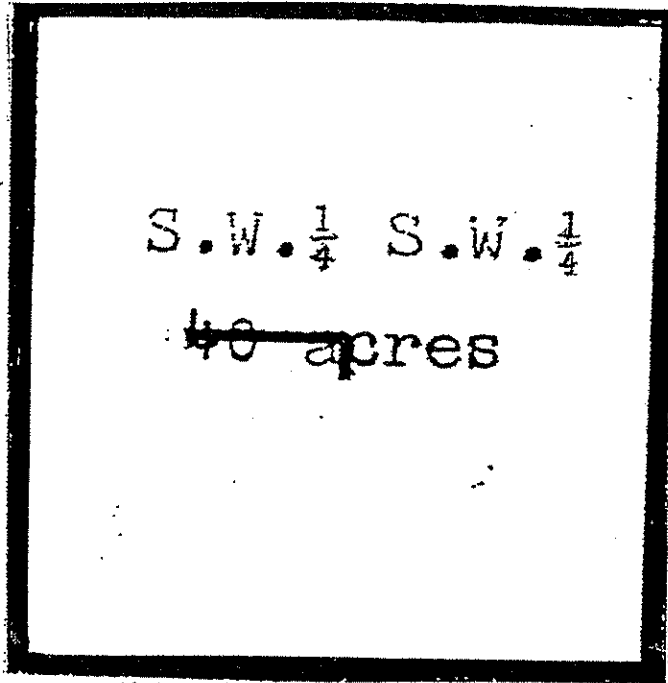

1320 feet

S.W.  $\frac{1}{4}$  S.W.  $\frac{1}{4}$

~~40~~ acres

1320 feet

1320 feet

STATE OF WISCONSIN  
RECEIVED & FILED  
  
AUG 14 2007  
  
DOUGLAS LA FOLLETTE  
SECRETARY OF STATE