



City of Eagle River

525 E. Maple Street • P.O. Box 1269 • Eagle River • WI 54521

Phone: (715) 479-8682 • Fax: (715) 479-9674

Website: www.eagleriver.govoffice2.com

C-161



FEBRUARY 22, 2008

ORD 9310

OFFICE OF THE SECRETARY OF STATE
GOVERNMENT RECORDS DIVISION
TINESHA SCOTT
30 WEST MIFFLIN STREET, 10 TH FLOOR
P.O. BOX 7848
MADISON, WI 53707-7848

DATE OF RECEIPT
GOVERNMENT RECORDS

FEB 26 2008

DUPED BY TINESHA SCOTT
SECRETARY OF STATE

SUBJECT: ORDINANCES 456 & 457

TO WHOM IT MAY CONCERN:

I AM ENCLOSING THE FOLLOWING INFORMATION REGARDING THE ANNEXING OF TERRITORY TO THE CITY OF EAGLE RIVER, WISCONSIN.

- 1) COPY OF ORDINANCES 456 & 457 W/MAPS
- 2) PETITION FOR DIRECT ANNEXATION
- 3) CERTIFICATION.

PLEASE NOTE THAT THE LEGAL DESCRIPTION IS IN EXHIBIT A..

FURTHERMORE, THE POPULATION OF THE AREA IS ZERO (0).

IF THERE IS ANYTHING ELSE YOU REQUIRE PLEASE FEEL FREE TO CALL ME AT 715-479-8682 EXTENSION 222.

SINCERELY,

DEBRA A. BROWN, WCMC-CMTW
CLERK/TREASURER

ENCLOSURE ORDINANCES 456 & 457

463616
Document Number

Ordinance 456

Document Title

VOL 1545 PAGE 645

STATE OF WISCONSIN
RECEIVED & FILED

FEB 26 2008

DOUGLAS LA FOLLETTE
SECRETARY OF STATE

RECORDED

FEB 15 2008

2:20 pm
Jean Hansen
REGISTER OF DEEDS, VILAS CO., WI

Recording Area

Name and Return Address

25. Chg
DEBRA A. BROWN ✓
CITY OF EAGLE RIVER
CLERK * TREASURER
P.O. BOX 1269
EAGLE RIVER, WI 54521

Parcel Identification Number (PIN)

THIS PAGE CONTAINS RECORDING INFORMATION
AND IS PART OF THE LEGAL DOCUMENT
DO NOT REMOVE

This information must be completed by submitter: document title, name & return address, and PIN (if required). Other information such as the granting clauses, legal description, etc. may be placed on this first page of the document or may be placed on additional pages of the document.
Note: Use of this cover page adds one page to your document and \$2.00 to the recording fee. Wisconsin Statutes, 59.43(2m) WRDA 2/99

An Ordinance Annexing Territory To the City of Eagle River, Wisconsin

The Common Council of the City of Eagle River, Wisconsin, does hereby ordain as follows:

SECTION 1. Territory Annexed. In accordance with sec. 66.0217 of the Wisconsin Statutes and the petition for direct annexation filed with the City Clerk on the 26th day of December, 2007, signed by all of the electors residing in the territory to be annexed, the following described territory, in the Town of Lincoln, Vilas County, Wisconsin, is annexed to the City of Eagle River, Wisconsin:

See attached "Exhibit A, B, & C" Description and Maps marked "Exhibit A1, B1 & C1" of the annexed area

SECTION 2. Effect of Annexation. From and after the date of this ordinance the territory described in section 1 shall be a part of the City of Eagle River for any and all purposes provided by law and all persons coming or residing within such territory shall be subject to all ordinances, rules and regulations governing the City of Eagle River.

SECTION 3. Zoning Classification. (a) Upon recommendation of the Plan Commission, the territory annexed to the City of Eagle River by this ordinance is zoned as follows, pursuant to sec. 66.0217 of the Wisconsin Statutes:

INDUSTRIAL ZONING

SECTION 4. Ward Designation. The territory described in section 1 of this ordinance is hereby made a part of Ward 5 of the City of Eagle River.

SECTION 5. Severability. If any provision of this ordinance is invalid or unconstitutional, or if the application of this ordinance to any person or circumstances is invalid or unconstitutional, such invalidity or unconstitutionality shall not affect the other provisions or applications of this ordinance which can be given effect without the invalid or unconstitutional provision or application.

SECTION 6. Effective Date. This ordinance shall take effect upon passage and publication as provided by law.

Dated this 12th day of February, 2008.

City of Eagle River

Handwritten signature of Jeffrey A. Hyslop, Mayor

Jeffrey A. Hyslop, Mayor

STATE OF WISCONSIN RECEIVED & FILED

FEB 26 2008

DOUGLAS LA FOLLETT SECRETARY OF STATE

Handwritten signature of Debra A. Brown, Clerk/Treasurer

Debra A. Brown, Clerk/Treasurer

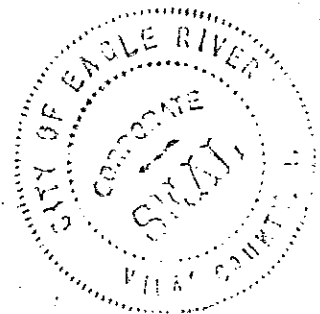

Adopted: 2-12-08
Published: 2-20-08
Effective: 2-20-08

Drafted by Debra A. Brown

"Exhibit A"

Legal Description:

**PARCEL 1 DESCRIPTION – FAVORITE, ANDERSON & MAINES
SURVEYING, S.C. MAP NO. 2005109, DATED 12/05/05, REVISED 01/16/06**

A parcel of land being Parcel 1 of Favorite, Anderson & Maines Surveying, S.C. Map No. 2005109, dated 12/05/05, revised 01/16/06, located in part of the NE ¼ of the SE ¼, Section 30, Township 40 North, Range 10 East, Lincoln Township, Vilas County, Wisconsin, more particularly described as follows:

Commencing at the East 1/4 corner of said Section 30, marked by a Vilas County aluminum capped monument; thence along the east line of said Section 30, South 02 degrees 44 minutes 26 seconds East for a distance of 596.97 feet; thence North 44 degrees 45 minutes 57 seconds West for a distance of 36.97 feet to an iron rebar on the westerly right-of-way line of the town road known as Bolte Road, the **PLACE OF BEGINNING**. Thence along said right-of-way line South 02 degrees 44 minutes 26 seconds East for a distance of 29.04 feet to an iron rebar; thence North 75 degrees 58 minutes 08 seconds West for a distance of 417.28 feet to an iron pipe; thence North 02 degrees 44 minutes 54 seconds West for a distance of 352.02 feet to an iron pipe; thence South 44 degrees 45 minutes 57 seconds East for a distance of 596.87 feet to the **PLACE OF BEGINNING**.

STATE OF WISCONSIN
RECEIVED & FILED

FEB 26 2008

DOUGLAS LA FOLLETT
SECRETARY OF STATE

"Exhibit B"

VOL 1545 PAGE 649

Legal Description:

**PARCEL 2 DESCRIPTION - FAVORITE, ANDERSON & MAINES
SURVEYING, S.C. MAP NO. 2005109, DATED 12/05/05, REVISED 01/16/06**

A parcel of land being Parcel 2 of Favorite, Anderson & Maines Surveying, S.C. Map No. 2005109, dated 12/05/05, revised 01/16/06, located in part of the NE ¼ of the SE ¼, Section 30, Township 40 North, Range 10 East, Lincoln Township, Vilas County, Wisconsin, more particularly described as follows:

Commencing at the East 1/4 corner of said Section 30, marked by a Vilas County aluminum capped monument; thence along the east line of said Section 30, South 02 degrees 44 minutes 26 seconds East for a distance of 888.82 feet; thence South 84 degrees 39 minutes 19 seconds West for a distance of 324.69 feet to an iron pipe, the **PLACE OF BEGINNING**. Thence continuing South 02 degrees 43 minutes 39 seconds East for a distance of 399.99 feet to an iron pipe on the northerly right-of-way line of the town road known as Illinois Road; thence along said right-of-way line South 84 degrees 39 minutes 19 seconds West for a distance of 265.00 feet to an iron pipe; thence North 02 degrees 43 minutes 13 seconds West for a distance of 400.00 feet to an iron pipe; thence North 84 degrees 39 minutes 19 seconds East for a distance of 264.95 feet to the **PLACE OF BEGINNING**.

STATE OF WISCONSIN
RECEIVED & FILED

FEB 26 2008

DURLAN LA FOLLETT
SECRETARY OF STATE

"Exhibit C"

**Legal Description: PARCEL 3 DESCRIPTION - FAVORITE, ANDERSON & MAINES SURVEYING,
S.C. MAP NO. 2005109, DATED 12/05/05, REVISED 01/16/06**

A parcel of land being Parcel 3 of Favorite, Anderson & Maines Surveying, S.C. Map No. 2005109, dated 12/05/05, revised 01/16/06, located in part of Government Lot 6, part of Government Lot 7 and part of the NE 1/4 of the SE 1/4, Section 30, Township 40 North, Range 10 East, Lincoln Township, Vilas County, Wisconsin, more particularly described as follows:

Commencing at the East 1/4 corner of said Section 30, marked by a Vilas County aluminum capped monument; thence along the east line of said Section 30, South 02 degrees 44 minutes 26 seconds East for a distance of 888.82 feet; thence South 84 degrees 39 minutes 19 seconds West for a distance of 24.78 feet to an iron rebar on the westerly right-of-way line of the town road known as Bolte Road, the **PLACE OF BEGINNING**. Thence continuing South 84 degrees 39 minutes 19 seconds West for a distance of 564.86 feet to an iron pipe; thence South 02 degrees 43 minutes 13 seconds East for a distance of 400.00 feet to an iron pipe on the northerly right-of-way line of the town road known as Illinois Road; thence along said right-of-way line South 84 degrees 39 minutes 19 seconds West for a distance of 660.32 feet to an iron pipe; thence North 08 degrees 29 minutes 52 seconds West for a distance of 1261.02 feet to an iron rebar on the east-west 1/4 line of said Section 30; thence along said east-west 1/4 line South 83 degrees 28 minutes 32 seconds West for a distance of 749.56 feet to an iron rebar on the north line of a private easement road; thence North 38 degrees 19 minutes 07 seconds East for a distance of 32.24 feet to an iron pipe; thence North 52 degrees 23 minutes 36 seconds East for a distance of 108.07 feet to an iron pipe; thence North 60 degrees 51 minutes 18 seconds East for a distance of 310.58 feet to an iron pipe; thence North 69 degrees 38 minutes 56 seconds East for a distance of 359.77 feet to an iron pipe; thence North 54 degrees 07 minutes 45 seconds East for a distance of 119.42 feet to a concrete monument; thence North 54 degrees 24 minutes 08 seconds East for a distance of 1525.57 to an iron rebar on the east line of said Section 30; thence along said section line South 03 degrees 18 minutes 34 seconds East for a distance of 389.09 feet to an iron pipe; thence South 45 degrees 13 minutes 27 seconds West for a distance of 860.80 feet to an iron pipe; thence South 44 degrees 45 minutes 57 seconds East for a distance of 331.51 feet to an iron pipe; thence South 02 degrees 44 minutes 54 seconds East for a distance of 352.02 feet to an iron pipe; thence South 75 degrees 58 minutes 08 seconds East for a distance of 417.28 feet to an iron rebar on the westerly right-of-way line of said Bolte Road; thence along said right-of-way line South 02 degrees 44 minutes 26 seconds East for a distance of 291.40 feet to the **PLACE OF BEGINNING**. Subject to a 33' wide easement for road and utility purposes per Volume 11 of Plats, Page 13, as shown on Favorite, Anderson & Maines Surveying, S.C. Map No. 2005109, dated 12/05/05 and revised 01/16/06.

STATE OF WISCONSIN
COUNTY OF VILAS

FEB 26 2008

NOTARY PUBLIC
STATE OF WISCONSIN

**Petition for Direct Annexation by unanimous approval,
pursuant to Section 66.0217 (2) Wisconsin Statutes,
where electors reside in Territory**

We, the undersigned, constituting all of the electors and all of the owners of real property in the following territory of the Town of Lincoln, Vilas County, Wisconsin, lying contiguous to the City of Eagle River petition the (common council) of the City of Eagle River to annex the territory described below and shown on the attached scale map to the City of Eagle River, Vilas County, Wisconsin.

[Legal description of territory proposed to be annexed.]

RECEIVED

DEC 26 2007

CITY OF EAGLE RIVER
DEBRA A. BROWN
CLERK / TREASURER

Description Attached

FEB 26 2008

STATE OF WISCONSIN
CLERK OF COURTS
COUNTY OF EAGLE RIVER

The current population of such territory is - 0 -.

We, the undersigned, elect that this annexation shall take effect to the full extent consistent with outstanding priorities of other annexation, incorporation or consolidation proceedings, if any.

Signature of Petitioner	Date of Signing	Owner *	Elector *	Address or Description of Property
1. <i>Debra A. Brown</i>	<i>12/26/07</i>	Owner	NO	Description Attached
2.				

* If elector, write "elector" in the appropriate box; if owner, write "owner" in the appropriate box.

446969

VOL 1439 PAGE 12

Document Number
WARRANTY DEED

Wisconsin Department of Transportation - Aeronautics

THIS DEED, made by Edgar Bolte* and Jenifer E. Bolte, Husband and Wife, GRANTOR, conveys and warrants the property described below to the City of Eagle River, a municipal corporation organized and existing under the laws of the State of Wisconsin, GRANTEE, for the sum of Two Hundred and Ten Thousand dollars (\$210,000).

* a/k/a Edgar J. Bolte

Other persons having an interest of record in the property: none

This is homestead property.

Legal Description:

PARCEL 2 DESCRIPTION - FAVORITE, ANDERSON & MAINES SURVEYING, S.C. MAP NO. 2005109, DATED 12/05/05, REVISED 01/16/06

A parcel of land being Parcel 2 of Favorite, Anderson & Maines Surveying, S.C. Map No. 2005109, dated 12/05/05, revised 01/16/06, located in part of the NE 1/4 of the SE 1/4, Section 30, Township 40 North, Range 10 East, Lincoln Township, Vilas County; Wisconsin, more particularly described as follows:

Commencing at the East 1/4 corner of said Section 30, marked by a Vilas County aluminum capped monument; thence along the east line of said Section 30, South 02 degrees 44 minutes 26 seconds East for a distance of 888.82 feet; thence South 84 degrees 39 minutes 19 seconds West for a distance of 324.69 feet to an iron pipe, the PLACE OF BEGINNING. Thence continuing South 02 degrees 43 minutes 39 seconds East for a distance of 399.99 feet to an iron pipe on the northerly right-of-way line of the town road known as Illinois Road; thence along said right-of-way line South 84 degrees 39 minutes 19 seconds West for a distance of 265.00 feet to an iron pipe; thence North 02 degrees 43 minutes 13 seconds West for a distance of 400.00 feet to an iron pipe; thence North 84 degrees 39 minutes 19 seconds East for a distance of 264.95 feet to the PLACE OF BEGINNING.

RECORDED

AUG 10 2006

12:00 pm

REGISTER OF DEEDS, VILAS CO., WI

11-Pd

Northern Title & Abstract Corp.
P.O. Box 877
Eagle River WI 54521

This space is reserved for recording
Return to:

Wisconsin Department of Transportation
Bureau of Aeronautics - Real Estate
4802 Sheboygan Avenue - Room 701
PO Box 7914
Madison, WI 53707-7914

30953

Parcel Identification Number/Tax Key Number
13-6, Computer # 14-1489-02
13-4, Computer # 14-1489

TRANSFER
\$ 630.00
FEE \$3/1000

Edgar Bolte
(Signature)

Edgar Bolte

a/k/a Edgar J. Bolte

Jenifer E. Bolte
(Signature)

Jenifer E. Bolte

(Signature)

(Print Name)

(Signature)

(Print Name)

August 9, 2006
(Date)

State of Wisconsin

Vilas County } ss.

On the above date, this instrument was acknowledged before me by the above-named person(s) or officers.

Terr A. Placer
(Signature, Notary Public, State of Wisconsin)

Terr A. Placer
(Print or Type Name, Notary Public, State of Wisconsin)

4-5-09

(Date Commission Expires)

STATE OF WISCONSIN
DEPARTMENT OF REVENUE

FEB 26 2008

STATE OF WISCONSIN
DEPARTMENT OF REVENUE

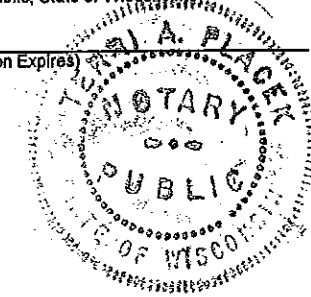

PART OF
GOVERNMENT LOT 6
 AND PART OF
GOVERNMENT LOT 7
 AND PART OF THE
NE 1/4 OF THE SE 1/4
 ALL IN
SECTION 30, T 40 N, R 10 E
 LINCOLN TOWNSHIP
 VILAS COUNTY, WISCONSIN

WISCONSIN RIVER

WISCONSIN RIVER ESTATES
 VOL. 11 OF PLATS PAGE 13

-EDGAR BOLTE, SHERRY PHILLIPS,
 MARGARET YETTER AND LYNDA M. BOLTE-
 VOL. 888, PAGE 831

-MUNICIPAL AIRPORT-
 VOL. 388, PAGE 851
 VOL. 387, PAGES 161-166

-3-
 2,015,900 SQ.FT.
 46.28 ACRES

-EDGAR BOLTE, SHERRY PHILLIPS,
 MARGARET YETTER AND LYNDA M. BOLTE-
 VOL. 818, PAGE 43

-TANNER-
 VOL. 818, PAGE 487

-LYNDA M. BOLTE-
 VOL. 808, PAGE 402
 178 ACRES

-KORANDA-
 VOL. 804,
 PAGE 87

WISCONSIN RIVER

FEB 26 2008

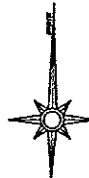

I hereby certify that I have surveyed the property shown
 hereon, that the same represents an accurate survey of
 and property to the best of my knowledge and belief,
 and that I have complied with the applicable requirements
 of the Wisconsin Administrative Code Section A-C-1.
 Note: Any legal descriptions pertaining to this survey have
 been printed on separate sheets.

Jeffrey D. Anderson
 Registered Land Surveyor #1-2817 Date

- LEGEND**
- 3/4" DIA. IRON BENCHMARK
 - 1" DIA. IRON PIPE FOUND
 - 1-1/2" DIA. IRON PIPE FOUND
 - 1-1/2" DIA. IRON PIPE FOUND
 - 4" x 4" CONCRETE MONUMENT FOUND
 - 4" IRON PIPE FOUND
 - COMPUTED POSITION (CORNER NOT SET)
 - () BENCHMARK OR DISTANCE OF RECORD

REFERRED TO BY THE TITLE & ABSTRACT COM. OF
 VILAS COUNTY COMBINED MAPSHEET 30850SP,
 30850P AND 30854P.

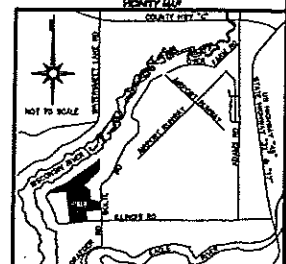

Favorite, Anderson & Malmes
 Surveying, S.C.
 2224 HWY 78 WEST - EAGLE RIVER, WI 53121
 PHONE: (715) 275-2774 - FAX: (715) 275-2724

Survey For:
 Eagle River Airport Commission
 AT THE BOB EGAN
 P.O. BOX 3328
 EAGLE RIVER, WI 53121

MAP NO. 2005/09
 DATE: 11/05/05
 DWG. BY: JDA