

CITY of STURGEON BAY

www.sturgeonbaywi.org



C-16

Stephanie L. Reinhardt, CMC
City Clerk
421 Michigan Street
Sturgeon Bay, WI 54235

920.746.2900
920.746.2905

FAX

ORD - 9403

June 17, 2008

Secretary of State
10th Floor, 30 W Mifflin Street
P O Box 7848
Madison, WI 53707-7848

Dear Sir:

Enclosed you will find a certified copy of an ordinance which annexes territory to the City of Sturgeon Bay, Wisconsin in Door County.

According to State Statutes, I have included the ordinance, a certification, and the site plan of the area.

Please feel free to contact me at 920-746-2900, if you should have any questions.

Very truly yours,

Stephanie L. Reinhardt

Stephanie L. Reinhardt
City Clerk

Encl.

DOUGLAS LA FOLLETTE
SECRETARY OF STATE

JUL 14 2008

STATE OF WISCONSIN
RECEIVED & FILED

ORDINANCE NO. 1205-0608

THE COMMON COUNCIL OF THE CITY OF STURGEON BAY, WISCONSIN DO ORDAIN
AS FOLLOWS:

SECTION 1: Territory Annexed. In accordance with Sec. 66.0217 of the Wisconsin Statutes and the petition for direct annexation filed with city clerk on the 20th day of January, 2008, signed by all of the owners of lands lying within the territory and all of the electors residing in such territory, the following described territory in the Town of Nasewaupée, Door County, Wisconsin, is annexed into the City of Sturgeon Bay, Wisconsin.

A tract of land located in the NE ¼ of the SE ¼, Section 12, Township 27 North, Range 25 East, described as follows: Commencing at the Southeast corner of said NE ¼ of the SE ¼ of said Section 12, (said point also being on the centerline of South Duluth Avenue); thence West a distance of 175 feet to the point of beginning; thence continue West a distance of 50 feet; thence North a distance of 180 feet; thence East a distance of 225 feet to the centerline of South Duluth Avenue; thence South along said centerline of South Duluth Avenue a distance of 120 feet; thence West a distance of 175 feet; thence South a distance of 60 feet to the point of real beginning.

The territory annexed contains 0.69 acre and is currently owned by Jeffrey & Laura Hoffman, parcel #0200112272541G.

SECTION 2: Effect of Annexation. From and after the date of this ordinance, the territory hereinafter described in Section 1 shall be part of the City of Sturgeon Bay, Door County, Wisconsin, for any and all purposes provided by law and all persons coming or residing within such territory shall be subject to all ordinances, rules, and regulations governing the City of Sturgeon Bay.

SECTION 3: Temporary Zoning Classification. Upon recommendation of the Plan Commission of the City of Sturgeon Bay, the territory annexed to the City of Sturgeon Bay by this ordinance is temporarily zoned as Single-Family Residential (R-2) pursuant to Sec. 66.0217(8)(a) of the Wisconsin Statutes.

SECTION 4: Severability. If any provision of this ordinance is invalid or unconstitutional, or if the application of this ordinance to any person or circumstance is invalid or unconstitutional, such invalidity or unconstitutionality shall not affect the other provisions or applications of this ordinance which can be given effect without the invalid or unconstitutional provision or application.

SECTION 5: This ordinance shall take effect on the day after its publication.

DOUGLAS LA FOLLETTE
SECRETARY OF STATE

JUL 14 2008

STATE OF WISCONSIN
RECEIVED & FILED

Approved: Thomas D. Voegele, Mayor
Attest: Stephanie Reinhardt, City Clerk
Date of 1st Reading: 05/20/08
Date of 2nd Reading: 06/03/08
Adoption: 06/03/08
Publication: 06/07/08
Effective Date: 06/08/08

The population is four.

DOUGLAS LA FOLLETTE
SECRETARY OF STATE

JUL 14 2008

STATE OF WISCONSIN
RECEIVED & FILED

Location Map

Annexation of Territory - Hoffman

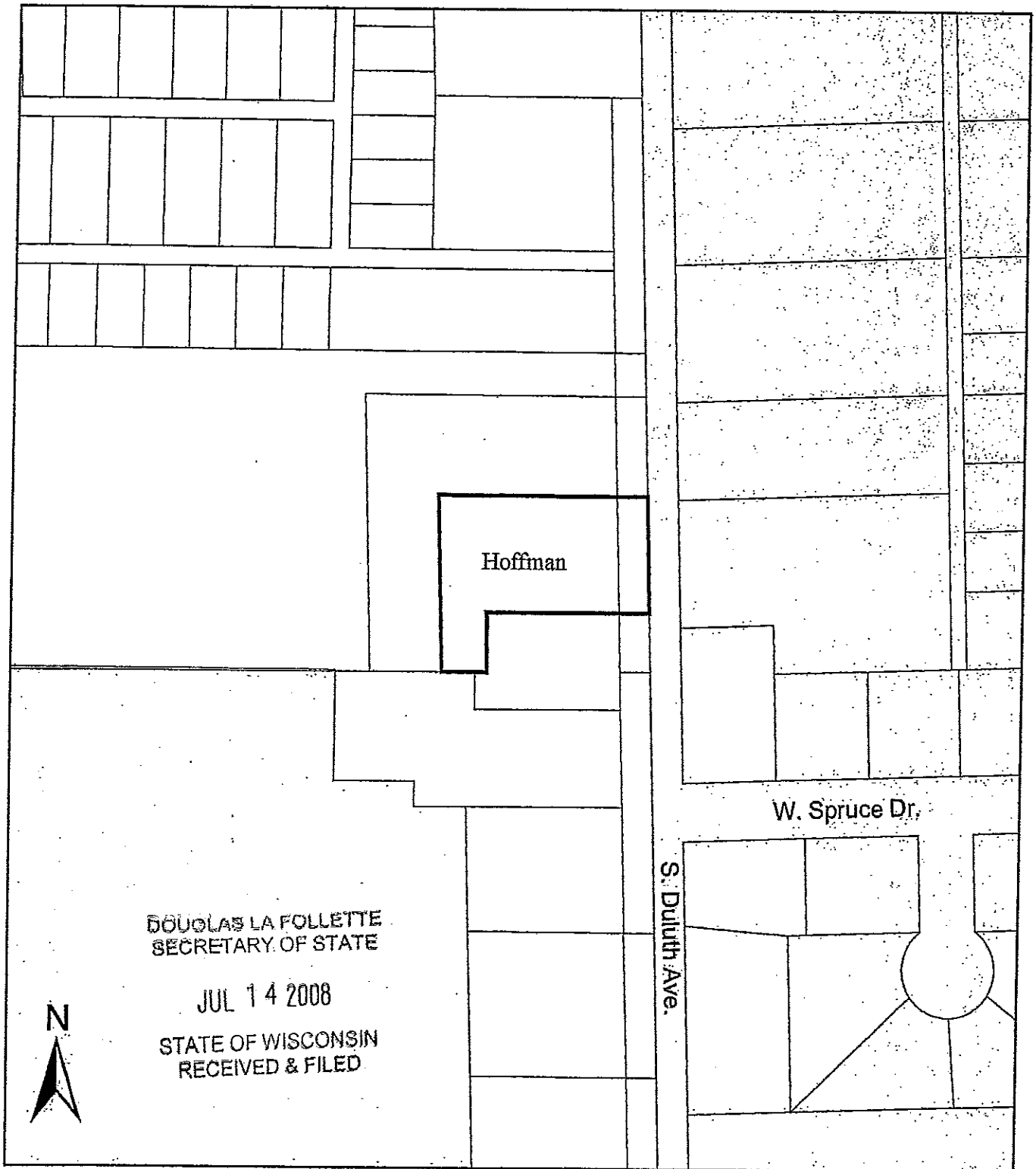

Annexation Area



Existing City Parcels

Map Date: May 15, 2008

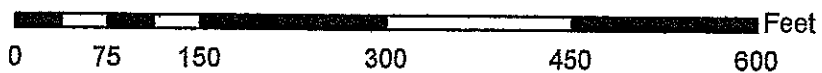

STATE OF WISCONSIN)

COUNTY OF DOOR) SS

I, STEPHANIE L. REINHARDT, duly appointed, qualified and acting City Clerk of the City of Sturgeon Bay, Wisconsin do hereby certify that the foregoing ordinance has been compared by me with an original on file in my office and that it is a true and correct copy of the ordinance duly accepted at a regular Common Council meeting held June 3, 2008.

Dated: June 17, 2008

Stephanie L. Reinhardt
Stephanie L. Reinhardt, City Clerk

(S - E - A - L)

DOUGLAS LA FOLLETTE
SECRETARY OF STATE

JUL 14 2008

STATE OF WISCONSIN
RECEIVED & FILED