

# The State of Wisconsin

## Office of the Secretary of State

C107

Altoona

Eau Claire County

Ordinance 8C-11

Filed September 14, 2011

C107

1303 LYNN AVENUE  
P.O. BOX 8  
ALTOONA, WI 5472

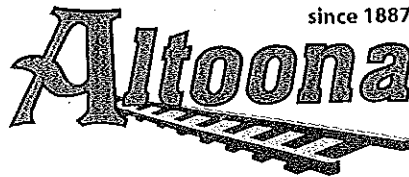

Ph: 715-839-6092  
Fax: 715-839-1800  
www.ci.altoona.wi.us

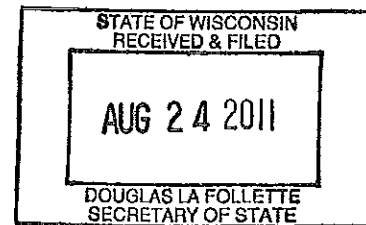

August 19,

Annexation Railroads  
Division of Land Records  
Office of the Secretary of State  
P.O. Box 78  
Madison, WI 53707-7848

MBR #1354

Dear Secretary:

Enclosed please find a certified copy of City of Altoona Ordinance 8C-11 which was adopted by the City of Altoona Common Council on August 11, 2011 to annex property to the City of Altoona pursuant to Direct Annexation Petition (James Overgard, owner, DBA Overgard Pros LLC) and to specify that the current population of the annexed area is one (1).

The City of Altoona is also providing notice of Ordinance 8C-11 to the Clerk of the Altoona School District, the Eau Claire County Clerk, the Eau Claire County Register of Deeds, the City of the Town of Washington, Xcel Energy, Eau Claire Energy Cooperative, Charter Communications.

Please contact our office at (715) 839-6092 if you should have any questions,

Sincerely,

A handwritten signature in cursive script that reads "Cynthia M. Baer".

Cynthia M. Baer  
City Clerk

cc: James Overgard

# The State of Wisconsin

## Office of the Secretary of State

C107

Altoona

Eau Claire County

Ordinance 8C-11

Filed September 14, 2011

0107

1303 LYNN AVENUE  
P.O. BOX 8  
ALTOONA, WI 5472

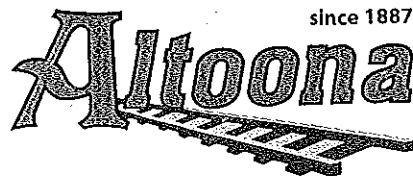

Ph: 715-839-6092  
Fax: 715-839-1800  
www.ci.altoona.wi.us

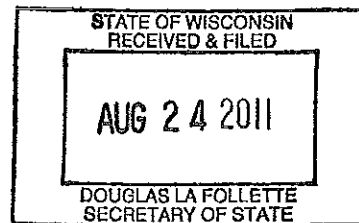

August 19,

Annexation Railroads  
Division of Land Management Records  
Office of the Secretary of State  
P.O. Box 78  
Madison, WI 53707-0078

MBR #1354

Dear Secretary:

Enclosed is a certified copy of City of Altoona Ordinance 8C-11 which was adopted by the City Common Council on August 11, 2011 to annex property to the City of Altoona pursuant to Direct Annexation Petition (James Overgard, owner, DBA Overgard Pros LLC) and to specify that the current population of the annexed area is one (1).

The City of Altoona is also providing notice of Ordinance 8C-11 to the Clerk of the Altoona School District, the Eau Claire County Clerk, the Eau Claire County Register of Deeds, the City of the Town of Washington, Xcel Energy, Eau Claire Energy Cooperative, Charter Communications.

Please contact our office at (715) 839-6092 if you should have any questions,

Sincerely,

Cynthia M. Baer  
City Clerk

cc: James Overgard

ORDINANCE NO. 8C-11

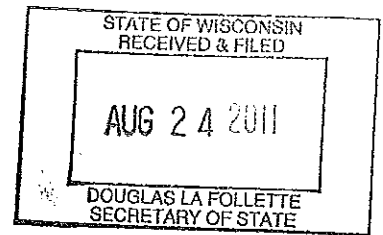

— To Annex Property to the City of Altoona Pursuant to  
Direct Annexation Petition (James Overgard, owner, DBA Overgard Properties LLC) —  
The MBR number for the Secretary of State is MBR number 13549.

The Common Council of the City of Altoona does hereby ordain as follows:

**Section 1:** A petition for direct annexation having been filed with the City Clerk, a copy of which is attached hereto and incorporated herein as Exhibit A, which petition was signed by all the owners of the territory described therein, such owners being electors residing in said territory, and the Department of Administration having performed its review under §66.0217(6), Wis. Stats., and, in accord with §66.0217(6)(a), Wis. Stats., the Common Council having reviewed the advice of the Department before considering this ordinance, said territory, whose description is set forth immediately hereinafter, be and is hereby annexed to and incorporated to the City of Altoona and detached from the Town of Washington pursuant to §66.0217(8), Wis. Stats.:

A parcel of land being located in the SE ¼ of the NE ¼, Section 36, T27N, R9W, City of Altoona, Eau Claire County, Wisconsin being more particularly described as follows:

- Commencing at the East ¼ corner of said Section 36;
- Thence N.89°43'45"W., along the south line of said SE ¼ of the NE ¼, a distance of 577.50 feet to the point of beginning;
- Thence N.00°03'44"W. 247.50 feet to an iron pipe;
- Thence N.89°44'09"W. 423.50 feet;
- Thence S.00°03'44"E. 247.50 feet to said south line;
- Thence S.89°43'45"E., along said south line, 423.50 feet to the point of beginning containing 104,823 square feet more or less and being subject to existing easements and road right of ways.

**Section 2:** That the population of said territory is (1) one.

**Section 3:** That said territory is hereby annexed to Ward 1.

**Section 4:** In accord with §66.0217(8)(a), Wis. Stats., this annexation shall be referred to the Planning Commission for its recommendation as to a temporary or permanent zoning classification and a public hearing will be set before the Common Council.

**Section 5:** That this annexation shall be effective upon adoption of this ordinance.

**Section 6:** That the City Clerk shall file one (1) certified copy of this ordinance with the Office of the Secretary of State, together with one (1) plat map of the territory annexed hereinunder to the City, and shall, additionally, provide a copy of each

company providing utility services in the annexed territory as well as to the  
Clerks of the Altoona School District and shall cause it to be recorded by the Eau  
Claire County Register of Deeds.

**Section 7:** That this ordinance shall not be codified.

Dated this 11 day of August, 2011.

**CITY OF ALTOONA**

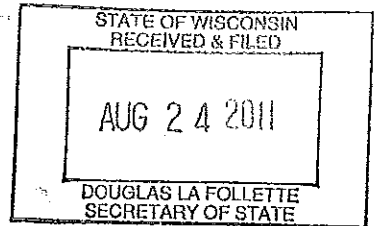

By: \_\_\_\_\_

William J. Spangler, Mayor

ATTEST:

By: \_\_\_\_\_

Cindy Bauer, City Clerk

Approved: 8/11/11  
Published: 8/17/11  
Adopted: 8/11/11



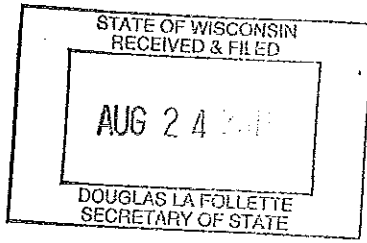

**LEGEND**

- FND. 1" IRON PIPE
- SET 1" O.D. x 18" IRON PIPE
- ( ) RECORDED AS

SCALE: 1" = 100'

BEARINGS REFERENCED TO THE E-W QUARTER LINE, SECTION 36,  
ASSUMED BEARINGS OF N89°43'45"W.

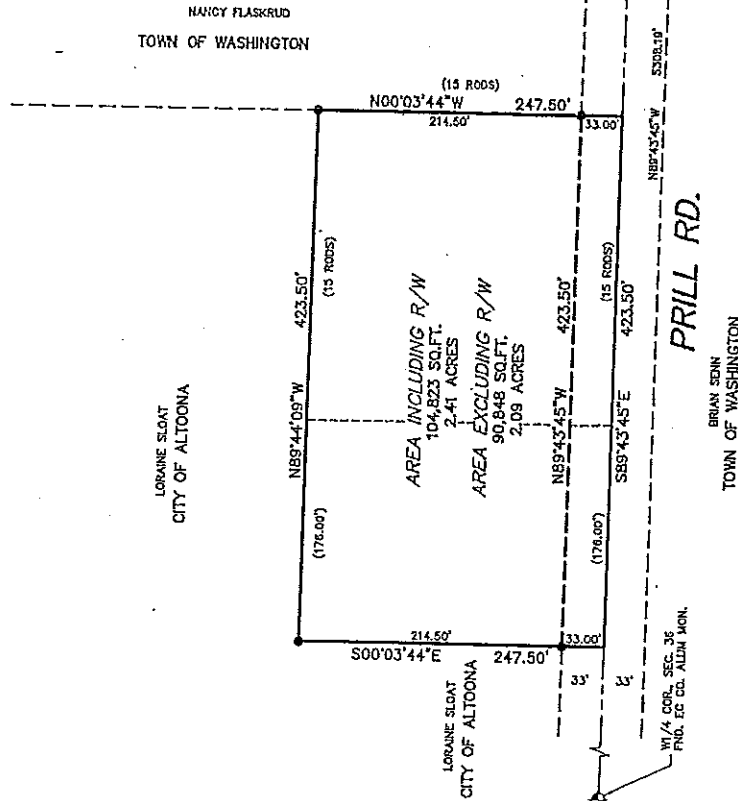

**Legal description for annexation**

A PARCEL OF LAND BEING LOCATED IN THE SE1/4 OF THE NE1/4, SECTION 36, T27N, R9W, CITY OF ALTOONA, EAU CLAIRE COUNTY, WISCONSIN BEING MORE PARTICULARLY DESCRIBED AS FOLLOWS:  
• COMMENCING AT THE EAST 1/4 CORNER OF SAID SECTION 36;  
• THENCE N89°43'45\"/>

SURVEYOR'S CERTIFICATE:  
I, PETER J. GARTMANN, REGISTERED LAND SURVEYOR HEREBY CERTIFY THAT THIS SURVEY IS CORRECT AND ACCURATE TO THE BEST OF MY KNOWLEDGE AND BELIEF.  
PETER J. GARTMANN  
DATED THIS 3<sup>rd</sup> DAY OF June 2011

**REAL LAND SURVEYING**

635 FAIRFAX ST.  
ALTOONA WI 54720  
(715) 514-4116

CADD No. 11063

FOR: JIM OVERGARD

**ANNEXATION MAP**

IN THE SE1/4 OF THE NE1/4, SECTION 36, T27N, R9W,  
TOWN OF WASHINGTON, EAU CLAIRE COUNTY, WISCONSIN

STATE OF WISCONSIN  
RECEIVED & FILED  
AUG 24 2011  
DOUGLAS LA FOLLETTE  
SECRETARY OF STATE

# ANNEXATION LOCATION EXHIBIT

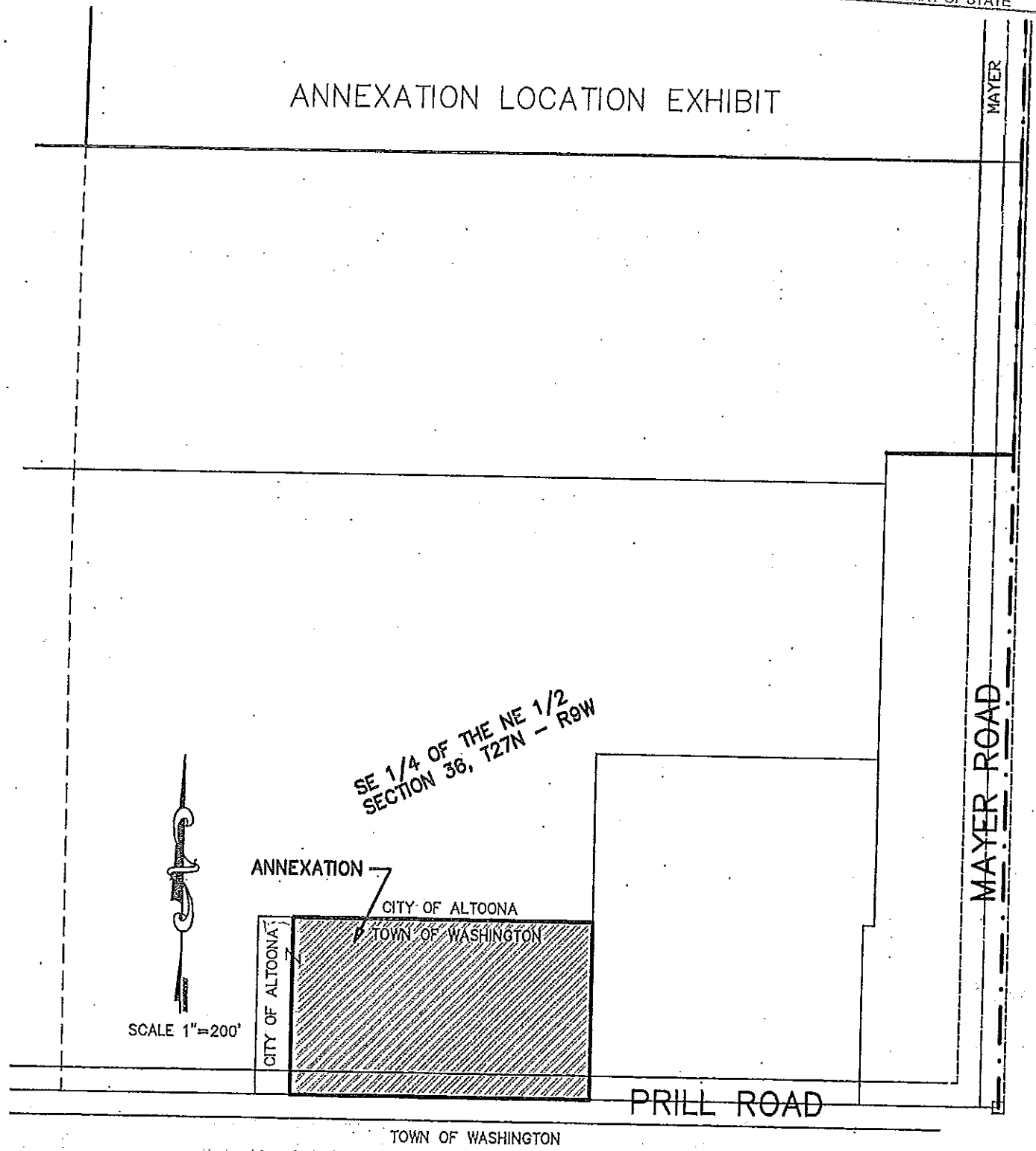

SE 1/4 OF THE NE 1/2  
SECTION 36, T27N - R9W

ANNEXATION

CITY OF ALTOONA

TOWN OF WASHINGTON

CITY OF ALTOONA

SCALE 1"=200'

PRILL ROAD

MAYER ROAD

TOWN OF WASHINGTON



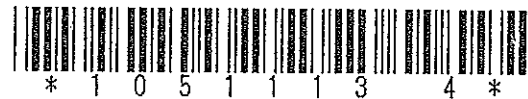
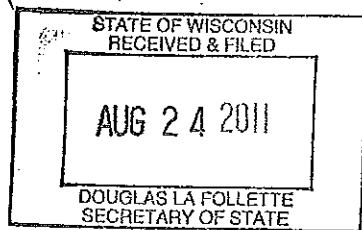

**Ordinance No. 8C-11**  
- To Annex Property to the  
City of Altoona Pursuant to  
Direct Annexation Petition  
(James Overgard, owner,  
DBA Overgard Properties LLC)

**1051113**  
MARY L KAISER  
EAU CLAIRE COUNTY, WI  
REGISTER OF DEEDS

RECORDED ON  
08/16/2011 03:40PM

REC FEE: 30.00  
TRANSFER FEE:  
EXEMPT #  
PAGES: 4

**Document Number**

**Document Title**

**Recording Area**

**Name and Return Address**

City of Altoona  
P.O. Box 8  
Altoona, WI 54720

**Parcel Identification  
Number (PIN)**

Drafted by Michael Golat, Altoona City Administrator

# CERTIFICATION

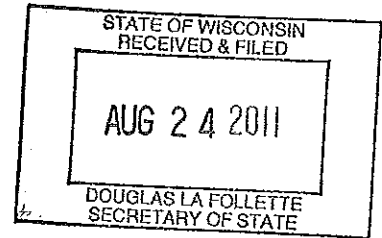

I, Cynthia M. Bauer, City Clerk of the City of Altoona, Eau Claire County, Wisconsin, do hereby certify that the attached is a true and exact copy of Ordinance 8C-11, to Annex property to the City of Altoona pursuant to Direct Annexation Petition (James Overgard, owner, DBA Overgard Properties LLC, duly presented and adopted by the Common Council of the City of Altoona on August 11, 2011.

In witness thereof, I hereby affix my signature and the official seal of the City of Altoona, Wisconsin.

Cynthia M Bauer

Cynthia M. Bauer, City Clerk

