

# The State of Wisconsin

## Office of the Secretary of State

C101

CITY OF WAUPUN

DODGE & FOND DU LAC COUNTY

ANNEXATION ORDINANCE 12-08

Filed AUGUST 30, 2012

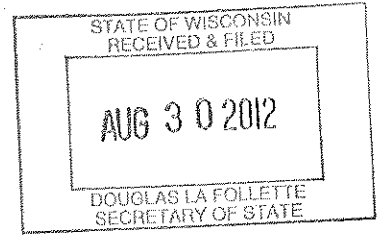

CERTIFICATE

I, Angela J. Hull, DO HEREBY CERTIFY, THAT I AM THE DULY APPOINTED AND QUALIFIED City Clerk of the City of Waupun, a Wisconsin Municipal Corporation, located in Dodge and Fond du Lac Counties, Wisconsin.

I certify that the attached Ordinance #12-08 is a true and correct copy of the original Ordinance passed by the Common Council of the City of Waupun at a special meeting of said Council held on the 28th day of August, 2012.

I further certify that the real estate annexed to the City of Waupun by said Ordinance is occupied and that its associated population is two (2).

I further certify the MBR Number is: 13611

I further certify that the map attached hereto is a true and correct copy of a map attached to the petition for annexation filed with the City of Waupun, identifying the real estate annexed and indicating its location with respect to the corporate limits of the City of Waupun.

Dated at Waupun, Wisconsin, this 29th day of August, 2012.

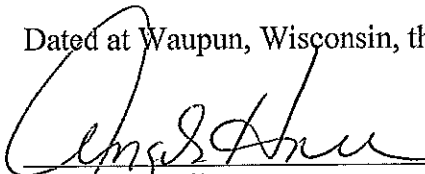
  
\_\_\_\_\_  
Angela J. Hull  
City Clerk

Subscribed and sworn to before me this  
29th day of August, 2012

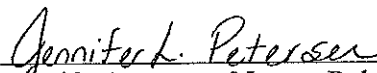
  
\_\_\_\_\_  
Jennifer Petersen, Notary Public

My commission expires May 11, 2014

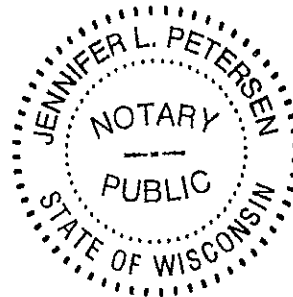

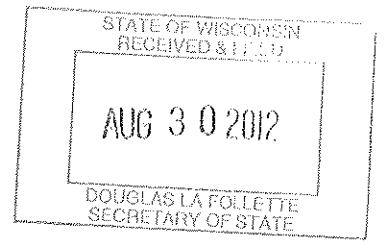

## ORDINANCE NUMBER 12-08

AN ORDINANCE TO ANNEX REAL ESTATE LOCATED IN THE TOWN OF WAUPUN TO THE CITY OF WAUPUN

THE COMMON COUNCIL OF THE CITY OF WAUPUN ORDAINS:

SECTION 1: The following real estate, owned by Jerrold R Neumann and Joann H Neumann is detached from the Township of Waupun and annexed to the City of Waupun:

See attached Exhibit "A".

SECTION 2: The real estate shall be zoned R1 for zoning purposes until the zoning map may otherwise be amended.

SECTION 3: The real estate shall be placed in the 11<sup>th</sup> Ward of the 6<sup>th</sup> Aldermanic District.

Enacted this 28th day of August, 2012.

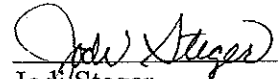
  
\_\_\_\_\_  
Jodi Steger  
Mayor

ATTEST:

  
\_\_\_\_\_  
Angela Hull  
City Clerk

EXHIBIT "A"

LEGAL DESCRIPTION

Jerrold R. and Joann H. Noumann Property  
Town of Waupun, Fond Du Lac County, WI

Lands to be annexed to the City of Waupun:

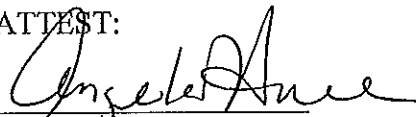
Being a part of the Northeast Quarter of Section 32, Township 14 North, Range 15 East,  
Town of Waupun, Fond Du Lac County, Wisconsin, described as follows:

Commencing 14-4/5 rods south of the Northeast corner of Section 32 in Township 14 North, Range 15 East;  
thence west 80 rods to the center of the highway;  
thence south along the center line of the highway 36 rods, this being the starting point for the description of this  
property;  
starting, therefore, at this point as the place of beginning,  
thence east 275 feet;  
thence north 78 feet;  
thence west 275 feet;  
thence south along the center of the highway 78 feet to the place of beginning.

THIS DESCRIPTION WAS PREPARED BY: GROTHMAN & ASSOCIATES, S.C.  
SCOTT P. HEWITT  
Registered Land Surveyor, No. 2229  
Dated: May 25, 2012  
FID No: 072-209

THIS DESCRIPTION WAS PREPARED FOR: Mr. & Mrs. Jerrold Noumann  
N2338 County Trunk Highway M  
Waupun, WI 53883

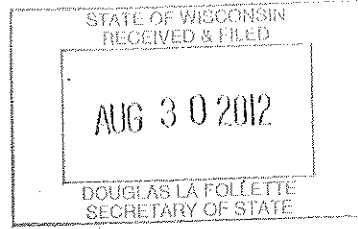

# ANNEXATION EXHIBIT

## GENERAL LOCATION

BEING A PART OF THE NE1/4 OF SECTION 32, T. 14 N., R. 15 E., TOWN OF WAUPUN, FOND DU LAC COUNTY, WISCONSIN

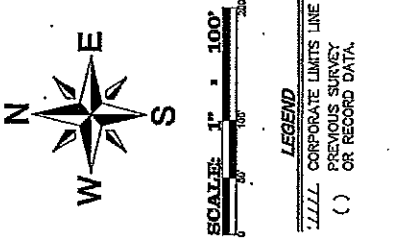

**LEGEND**  
 - - - - - CORPORATE LIMITS LINE  
 ( ) PREVIOUS SURVEY OR RECORD DATA

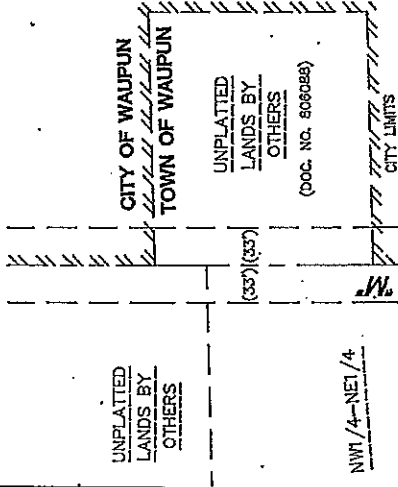

UNPLATTED LANDS BY OTHERS  
 (DOC. NO. 806088)

UNPLATTED LANDS BY OTHERS  
 (C.S.M. NO. 5358)

UNPLATTED LANDS BY OTHERS  
 (C.S.M. NO. 7016)

UNPLATTED LANDS BY OTHERS  
 (C.S.M. NO. 4228)

UNPLATTED LANDS BY OTHERS  
 (C.S.M. NO. 01-008-00)

UNPLATTED LANDS BY OTHERS  
 (C.S.M. NO. 02-001-00)

UNPLATTED LANDS BY OTHERS  
 (C.S.M. NO. 01-007-00)

UNPLATTED LANDS BY OTHERS  
 (C.S.M. NO. 01-008-00)

UNPLATTED LANDS BY OTHERS  
 (C.S.M. NO. 01-010-00)

UNPLATTED LANDS BY OTHERS  
 (C.S.M. NO. 01-008-00)

UNPLATTED LANDS BY OTHERS  
 (C.S.M. NO. 01-010-00)

UNPLATTED LANDS BY OTHERS  
 (C.S.M. NO. 01-008-00)

UNPLATTED LANDS BY OTHERS  
 (C.S.M. NO. 01-010-00)

UNPLATTED LANDS BY OTHERS  
 (C.S.M. NO. 01-008-00)

UNPLATTED LANDS BY OTHERS  
 (C.S.M. NO. 01-010-00)

UNPLATTED LANDS BY OTHERS  
 (C.S.M. NO. 01-008-00)

UNPLATTED LANDS BY OTHERS  
 (C.S.M. NO. 01-010-00)

UNPLATTED LANDS BY OTHERS  
 (C.S.M. NO. 01-008-00)

UNPLATTED LANDS BY OTHERS  
 (C.S.M. NO. 01-010-00)

UNPLATTED LANDS BY OTHERS  
 (C.S.M. NO. 01-008-00)

13611

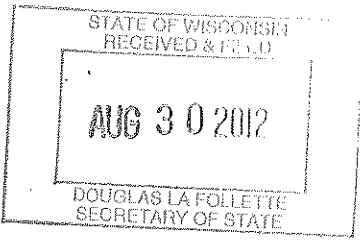

OWNER: JERRELD R. & JEANN H. NEUMANN  
 N2839 C.T.H. M  
 WAUPUN, WI 53963

Prepared by: **CA GROTHMAN & ASSOCIATES S.C.**  
 100 EAST BLAISE STREET, 5TH FLOOR, SUITE 500  
 FOND DU LAC, WISCONSIN 53420  
 PHONE: (920) 745-7788 FAX: (920) 744-8877  
 WWW.CAGROTHMAN.COM

**G & A FILE NO. 512-200**  
 DRAFTED BY: J. BROST  
 CHECKED BY: SPH  
 PROJ. 512-200  
 DWG. 512200

SHEET 1 OF 2