

CORPORATE LIMITS
DECEMBER 1, 2022

COB170

893399

CYNTHIA A. WISINSKI
REGISTER OF DEEDS
PORTAGE COUNTY
STEVENS POINT, WI
RECORDED ON
11/30/2022 08:10 AM

Document Number



15.01 CITY OF STEVENS POINT BOUNDARIES:

That part of Sections 1, 2, 3, 4, 5, 6, 8, 11, and 12, Township 23 North, Range 8 East, that part of Sections 6 and 7, Township 23 North, Range 9 East, and that part of Sections 13, 14, 15, 17, 19, 20, 21, 22, 23, 24, 25, 26, 27, 28, 29, 30, 31, 32, 33, 34, 35 and 36, Township 24 North, Range 8 East, Fourth Principal Meridian, City of Stevens Point, County of Portage, State of Wisconsin described as follows:

REC FEE: 30.00
TRANSFER FEE:
PAGES: 16
FEE EXEMPT:
THIS IS A SWIFT DOCUMENT

Beginning at the southwest corner of Section 6; thence east along the south lines of Section 6 and Section 5 to the southeast corner of the Southwest Quarter of the Southeast Quarter of Section 5; thence south along the west line of the Northeast Quarter of the Northeast Quarter of Section 8 a distance of 724 feet; thence east and parallel with the north line of Section 8 a distance of 439 feet; thence south and parallel with the west line of the Northeast Quarter of the Northeast Quarter of Section 8 a distance of 546 feet to the north right of way line of Sherman Avenue; thence east along said right of way line to the southwesterly right of way line of the Fox Valley and Western Railroad (N/K/A Canadian National Railway); thence northwesterly along said southwesterly right of way line to the north line of the Northeast Quarter of the Northeast Quarter of Section 8; thence east along said north line to the northeasterly right of way line of the Fox Valley and Western Railroad (N/K/A Canadian National Railway); thence southeasterly along said northeasterly right of way line to the east line of the Northeast Quarter of the Northeast Quarter of Section 8; thence north along the east line of said Northeast Quarter of the Northeast Quarter to the southwest corner of Section 4; thence east along the south line of said Section 4 to its intersection with the east shoreline of McDill Pond on the Big Plover River; thence northerly and easterly along the shoreline of said McDill pond to its intersection with the west line of Section 3, Township 23 North, Range 8 East; thence South 00 degree 52 minutes 56 seconds East along said west line 140 feet to the southwest corner of said Section 3; thence South 89 degrees 51 minutes 26 seconds East along the south line of the Southwest Quarter of the Southwest Quarter of said Section 3 a distance of 1309.79 feet to the southwest corner of the Southeast Quarter of the Southwest Quarter of said Section 3; thence South 89 degrees 39 minutes East along the south line of said Southeast Quarter of the Southwest Quarter 1314 feet to the southwest corner of the Southwest Quarter of the Southeast Quarter of said Section 3; thence North 00 degree 29 minutes 40 seconds West along the west line of said Southwest Quarter of the Southeast Quarter 1325.23 feet to its northwest corner; thence North 89 degrees 27 minutes 13 seconds East along the north line of said Southwest Quarter of the Southeast Quarter 1322.77 feet to its northeast corner; thence South 00 degree 07 minutes 22 seconds West along the east line of said Southwest Quarter of the Southeast Quarter 1248.5 feet to the north right of way line of County Road HH; thence North 89 degrees 58 minutes 17 seconds East along said right of way line 12.09 feet; thence continuing South 84 degrees 20 minutes 51 seconds East along said right of way line 149.82 feet; thence continuing North 88 degrees 50 minutes 42 seconds East 41.33 feet; thence continuing North 87 degrees 24 minutes 52 seconds East 200.25 feet; thence continuing South 89 degrees 43 minutes 24 seconds East along said north right of way line 211.66 feet to the northwest corner of County Road HH and Olympia Avenue; thence South 00 degree 14 minutes 07 seconds East along the southerly extension of the west right of way line of Olympia Avenue 10.5 feet to a line 33 feet north of and parallel with the south line of the Southeast Quarter of the Southeast Quarter of said Section 3; thence North 89 degrees 22 minutes 53 seconds East along said parallel line 60 feet to the southerly extension of the east right of way line of Olympia Avenue; thence North 00 degrees 14 minutes 07 seconds West along said southerly extension 9 feet to the northeast corner of said County Road HH and Olympia Avenue; thence continuing South 89 degrees 43 minutes 24 seconds East along said north right of way line of County Road HH 228.34 feet; thence continuing North 84 degrees 33 minutes 58 seconds East 100.50 feet; thence continuing South 89 degrees 43 minutes 24 seconds East

Return to:
City of Stevens Point
City Clerk
1515 Strongs Avenue
Stevens Point WI 54481

200.00 feet to the northwest corner of County Road HH and Hoover Road; thence North 88 degrees 23 minutes 26 seconds East 199.40 feet to the northeast corner of County Road HH and Hoover Road; Thence South 89 degrees 30 minutes 11 seconds East along the north right of way line of County Road HH 300.04 feet; thence continuing South 85 degrees 35 minutes 58 seconds East 200.72 feet; thence continuing North 89 degrees 32 minutes 04 seconds East 211.66 feet; thence North 89 degrees 32 minutes 04 seconds East along said north right of way line of County Road HH 812.6 feet; thence continuing North 85 degrees 37 minutes 47 seconds East along said right of way line 910.63 feet to the west right of way line of U.S. Highway 51; thence South 00 degree 11 minutes East along the southerly extension of said west right of way line 69 feet to the south line of said Section 2; thence North 89 degrees 35 minutes 24 seconds East along said south line a distance of 98.27 feet to the north-south quarter line of Section 11, Township 23 North, Range 8 East; thence South 01 degree 13 minutes 15 seconds East along said quarter line 167.17 feet; thence North 89 degrees 40 minutes 09 seconds East a distance of 378.52 feet to the south right of way line of County Road HH; thence continuing North 72 degrees 09 minutes 06 seconds East along said right of way line 91.69 feet; thence continuing North 87 degrees 12 minutes 54 seconds East along said right of way line 700.64 feet; thence continuing South 88 degrees 50 minutes 27 seconds East along said right of way line 370.31 feet; thence continuing North 86 degrees 06 minutes 50 seconds East along said right of way line 1,031.86 feet; thence North 89 degrees 33 minutes 31 seconds East along said right of way line 89.40 feet; thence South 81 degrees 26 minutes 14 seconds East 56.72 feet to the south right of way line of County Road HH; thence continuing North 89 degrees 36 minutes 33 seconds East along said south right of way line 151.13 feet to a point of curve; thence northeasterly 131.29 feet along the arc of a 3,323.48 foot radius curve, the center to the north, the chord bears North 88 degrees 28 minutes 39 seconds East 131.28 feet; thence South 79 degrees 40 minutes 07 seconds East 73.00 feet, said line not tangent with the last described course; thence North 66 degrees 30 minutes 36 seconds East and continuing along said right of way line 70.21; thence North 87 degrees 20 minutes 45 seconds East along said right of way line 771.72 feet to the east line of said Northwest Quarter of the Northwest Quarter of Section 12; thence North 00 degree 24 minutes 22 seconds West along said east line 73.23 feet to the southeast corner of the Southwest Quarter of the Southwest Quarter of Section 1, Township 23 North, Range 8 East; thence North 1 degree 28 minutes 41 seconds West along said east line of the Southwest Quarter of the Southwest Quarter 1,317.82 feet to its northeast corner; thence South 87 degrees 15 minutes 47 seconds West along the north line of said Southwest Quarter of the Southwest Quarter 1,256.18 feet to the southwest corner of Lot 1 of Portage County Certified Survey Map Number 1668, Volume 6, page 126; thence North 01 degree 50 minutes 48 seconds West along the east right of way line of Brilowski Road 1,317.57 feet to the south line of the Northwest Quarter of said Section 1; thence North 87 degrees 16 minutes 05 seconds East along said south line of the Northwest Quarter of Section 1 a distance of 1,298.98 feet to the northwest corner of the Northeast Quarter of the Southwest Quarter of said Section 1; thence South 01 degree 27 minutes 25 seconds East along the west line of said Northeast Quarter of the Southwest Quarter 1,302.70 feet to a line 15.00 feet north of and parallel with the south line of said Northeast Quarter of the Southwest Quarter; thence North 87 degrees 15 minutes 38 seconds East along said parallel line 15.00 feet; thence South 01 degree 28 minutes 41 seconds East on a line 15 feet east of and parallel with said west line of the Southeast Quarter of the Southwest Quarter of Section 1 and its southerly extension 1,362.80 feet to the center line of the traveled way (centerline of pavement April 4, 2012) of County Trunk Highway HH (C.T.H. HH); thence North 86 degrees 37 minutes 31 seconds East along said traveled way 805.88 feet; thence continuing North 86 degrees 53 minutes 40 seconds East along said traveled way 1,740.56 feet to its intersection with the southerly extension of the west line of Lot 1 of Portage County Certified Survey Map Number 8344-33-24; thence North 00 degree 37 minutes 32 seconds West along said west line 562.48 feet to the northwest corner of said Lot 1; thence North 87 degrees 12 minutes 38 seconds East along the north line of said Lot 1 a distance of 165.12 feet; thence South 00 degree 37 minutes 32 seconds East along the east line of said Lot 1 and its southerly extension 561.56 feet to its intersection with said center line of the traveled way of C.T.H. HH; thence North 86 degrees 53 minutes 40 seconds East along said traveled way 1,066.92 feet; thence continuing South 84 degrees 54 minutes 16 seconds East along said traveled way 1,380.69 feet; thence continuing South 84 degrees 30 minutes 58 seconds East along said traveled way 880.32 feet to its intersection with the southerly extension of the west line of the east 726 feet of Government Lot 26 of said Section 6, Township 23 North, Range 9 East; thence North 00 degree 30 minutes 29 seconds East along said west line 267.17 feet to its intersection with the north line of the south 240 feet of said Government Lot 26; thence South 85 degrees 07 minutes 22 seconds East along said north line 728.12 feet to its intersection with the east line of Government Lot 26, Township 23 North, Range 9 East; thence North 00 degree 30 minutes 29 seconds East along said east line and the east line of Government Lots 23, 10 and 7 in said township and range 5,047.56 feet to its intersection with the north right of way line of the Wisconsin Central Limited Railway (part of the Canadian National Railway); thence North 88 degrees 59 minutes 57 seconds West along said north right of way line 6,950.86 feet to its intersection with the west line of the Northeast Fractional Quarter of the Northwest Quarter of Section 1, Township 23 North, Range 8 East; thence continuing North 88 degrees 58 minutes 05 seconds West along said north right of way line 1,187.80 feet to the east right of way line of Brilowski Road; thence northwesterly along said east right of way line 220.74 feet along the arc of a 9,711.27 foot radius

curve, not tangent with the last described course, center to the east, the chord bears North 00 degree 55 minutes 33 seconds West 220.73 feet; thence continuing North 06 degrees 59 minutes 53 seconds West along said right of way line 560.47 feet; thence continuing North 00 degree 16 minutes 29 seconds West along said right of way line 628.37 feet to the south line of the Northwest Quarter of the Southwest Quarter of Section 36, Township 24 North, Range 8 East; thence North 89 degrees 32 minutes 20 seconds East along said south line 447.52 feet to the southwesterly right of way line of Old Highway 18; thence South 69 degrees 31 minutes 33 seconds East along said right of way line 10.29 feet to the east line and its southerly extension of Lot 3 of Hunter Oaks Subdivision located in said Section 36; thence North 00 degree 32 minutes 07 seconds West along the east line of said Lot 3 and its extension 294.66 feet to the south line of Lot 5 of said Hunter Oaks Subdivision; thence North 89 degrees 16 minutes 34 seconds East along the south line of said Lot 5 and the south line of Lots 6,7 and 8 a distance of 451.63 feet to the west line of Lot 9 of said Hunter Oaks Subdivision; thence South 00 degree 34 minutes 10 seconds East along the west line of said Lot 9 a distance of 5.00 feet to its southwest corner; thence North 89 degrees 16 minutes 34 seconds East along the south line of said Lot 9 and the south line of Lots 10 and 11 a distance of 349.53 feet to the southeast corner of said Lot 11, which corner is on the east line of said Northwest Quarter of the Southwest Quarter; thence North 00 degree 34 minutes 10 seconds West along said east line to a line 10 feet south of and parallel with the north line of said Northwest Quarter of the Southwest Quarter 1,026.47 feet; thence South 89 degrees 14 minutes 05 seconds West along said parallel line 1,027.27 feet to the west right of way line of Schiller Drive and the northeast corner of Outlot 2 of Hunter Oaks Subdivision Second Addition; thence continuing South 89 degrees 14 minutes 05 seconds West along said parallel line and the north line of said Outlot 2 a distance of 243.96 feet to a line 10 feet east of and parallel with the east right of way line of Brilowski Road and the northwest corner of said Outlot 2; thence South 00 degree 38 minutes 24 seconds East along said parallel line, the west line of said Outlot 2, and the east line of Outlot 3 of said Hunter Oaks Subdivision Second Addition 233.00 feet to the south line of said Outlot 3; thence South 89 degrees 14 minutes 05 seconds West along said south line 10.00 feet to said east right of way line of Brilowski Road and the west line of Lot 47 of said Hunter Oaks Subdivision Second Addition; thence South 00 degree 38 minutes 24 seconds East along said east right of way line and the west line of said Lot 47 a distance of 140.29 feet to the southwest corner of said Lot 47; thence South 89 degrees 12 minutes 14 seconds West on the westerly extension of the south line of said Lot 47 a distance of 77.10 feet to the west right of way line of said Brilowski Road; thence South 00 degree 38 minutes 24 seconds East along said right of way line 600.74 feet; thence South 55 degrees 11 minutes 32 seconds West 60.95 feet to the north right of way line of Old Highway 18; thence North 69 degrees 20 minutes 07 seconds West along said right of way line 1,303.30 feet to the west line of the Northeast Quarter of the Southeast Quarter of Section 35; thence South 00 degree 15 minutes 45 seconds West along said west line and the west line of the Southeast Quarter of the Southeast Quarter of said Section 35 a distance of 2,087.77 feet to the north line of Section 2, Township 23 North, Range 8 East; thence South 89 degrees 20 minutes 15 seconds West along the north line of said Section 2 a distance of 1,177.30 feet to the westerly right of way line of U. S. Highway 51 (A/K/A Interstate 39); thence northerly along the westerly right of way line of U.S. Highway 51 (A/K/A Interstate 39) to the northerly line of Lot A of Portage County Certified Survey Map Number 2158, as recorded in Volume 8 of 'Certified Surveys', page 16, located in Section 35, Township 24 North, Range 8 East; thence westerly along said northerly line to the easterly right of way line of Mary's Drive (N/K/A Woodward Drive); thence northerly along said easterly right of way line to the north right of way line of Carol's Lane; thence west along said north right of way line of Carol's Lane to the east right of way line of Country Club Drive; thence North 00 degrees 13 minutes 58 seconds East along said east right of way line 80.07 feet; thence North 89 degrees 46 minutes 06 seconds West 66.00 feet to the west right of way line of said Country Club Drive; thence South 26 degrees 17 minutes 41 seconds West along said west right of way line 15.67 feet; thence continuing South 03 degrees 01 minute 40 seconds West along said west right of way line 397.08 feet; thence continuing South 07 degrees 06 minutes 01 second West along said west right of way line 193.17 feet; thence continuing South 02 degrees 52 minutes 15 seconds East along said west right of way line 145.61 feet; thence continuing South 08 degrees 37 minutes 21 seconds East along said west right of way line 269.31 feet; thence continuing south along said west right of way line to the north right of way line of the Wisconsin Central Limited Railroad (N/K/A Canadian National Railway); thence west along said north right of way line to a point 2,275.00 feet west of the east line of Section 34, said right of way line being 50 feet north of (measured at right angles) and parallel with the main track centerline; thence north 40 feet; thence west along the north right of way of the Wisconsin Central Limited Railroad (N/K/A Canadian National Railway) to the main channel of the Big Plover River, said right of way line being 90 feet north of (measured at right angles) and parallel with the main track centerline; thence northerly in the main channel of said river to the north line of the Southeast Quarter of the Southwest Quarter; thence east along the north line of said Southeast Quarter of the Southwest Quarter to the northeast corner thereof; thence north along the east line of the Northeast Quarter of the Southwest Quarter of Section 34 to the west bank of the main channel of the Big Plover River;

thence northeasterly along the west bank of the main channel of the Big Plover River to the south line of the Southwest Quarter of the Northeast Quarter of Section 34; thence east along said south line of the Southwest Quarter of the Northeast Quarter of Section 34 to the southeast corner thereof; thence east along the south line of the Southeast Quarter of the Northeast Quarter of Section 34 to a point 250 feet east of the west line of said Southeast Quarter of the Northeast Quarter; thence north and parallel with the west line of said Southeast Quarter of the Northeast Quarter to its intersection with a line 220.00 feet south and parallel with the north line of said Southeast Quarter of the Northeast Quarter of said Section 34; thence east along said parallel line to its intersection with the easterly line and its southwesterly extension of Lot One of Portage County Certified Survey Map number 2878, as recorded in Volume 10 of 'Certified Surveys', page 136; thence continuing east along said parallel line approximately 83.8 feet; thence southeasterly at right angles with the last described course 18 feet; thence northeasterly 181.39 feet; thence southeasterly 68.61 feet to the east line and its southeasterly extension of lands conveyed to the Stevens Point Country Club, as recorded in Volume 429 of 'Quit Claim Deeds', page 136, Portage County Register of Deeds; thence northwesterly along said east line to the centerline of Old Highway 18 (now abandoned); thence southeasterly along the centerline of said Old Highway 18 to the east right of way line of Country Club Drive; thence north along said east right of way line (now relocated) to its intersection with a line 50 feet south and parallel with the north line of the Southwest Quarter of the Northwest Quarter of Section 35; thence west along said parallel line to the west line of said Southwest Quarter of the Northwest Quarter; thence north along said west line of the Southwest Quarter of the Northwest Quarter and the west line of the Northwest Quarter of the Northwest Quarter a distance of 150 feet to the north right of way line of U.S. Highway 10 (measured 100 feet north of the centerline); thence east along said north right of way line to the northerly extension of the east right of way line of U.S. Highway 51 (A/K/A Interstate 39); thence South 00 degrees 02 minutes 18 seconds East along said northerly extension 229.99 feet to the south right of way line of said U.S. Highway 10; thence continuing South 00 degrees 02 minutes 18 seconds East along the east right of way line of said U.S. Highway 51 (A/K/A Interstate 39) a distance of 197.64 feet to the northwest corner of Lot One of Portage County Certified Survey Map Number 9138 as recorded in Volume 38 of 'Certified Surveys', page 68; thence continuing South 00 degrees 02 minutes 34 seconds West along said east right of way line and the west line of said Lot One a distance of 241.66 feet; thence continuing South 35 degrees 09 minutes 35 seconds East along said east right of way line and said west line of Lot One a distance of 348.20 feet; thence South 69 degrees 25 minutes 16 seconds East 43.96 feet to the west right of way line of Old Highway 18; thence East at a right angle to the west right of way line of Old Highway 18 a distance of 66.00 feet to the east right of way line of said Old Highway 18; thence North along said east right of way line 343.46 feet to the southwest corner of Lot 2 of Portage County Certified Survey Map Number 5600 as recorded in Volume 20 of 'Certified surveys', page 171, document number 481944; thence east along the south line of said Lot 2 to the southeast corner of said Lot 2; thence north along the east line of said Lot 2 to its intersection with the south line of Lot 4 of Portage County Certified Survey Map number 5274 as recorded in Volume 19 of 'Certified Surveys', page 84A; thence east along said south line and the north line of Outlot 4 of said survey to its northeast corner; thence south along the east line of said Outlot 4 to its intersection with the northerly right of way line of Nick's Road; thence easterly and southerly along the circumference of a circle (Nick's Road cul-de-sac), having a radius of 66 feet, to the south line of Lot 1 of Portage County Certified Survey Map number 5281 as recorded on Volume 19 of 'Certified Surveys', page 91 and 91A; thence east along said south line to the east line of said Lot 1 and the west line of lands conveyed to Wisconsin Telephone Company as recorded in Volume 444 of 'Warranty Deeds', page 1104, Portage County Register of Deeds; thence south along said west line to the north line of the plat of Pine-Oaks Estates Subdivision, as recorded in Book D of 'Plats', page 39, Portage County Register of Deeds; thence South 89 degrees 59 minutes 00 seconds East along the north line of said plat 595.27 feet to the west line of the Southwest Quarter of the Northeast Quarter of Section 35; thence North 00 degree 01 minutes 55 seconds West a distance of 163.56 feet to the southwest corner of Lot 1 of Portage County Certified Survey Map Number 11001 as recorded in Volume 50 of 'Certified surveys', page 131, document number 832095; thence North 89 degrees 48 minutes 50 seconds East along the south line of said Lot 1 a distance of 257.00 feet to the southeast corner thereof; thence continuing North 89 degrees 48 minutes 50 seconds East along the south line of Lot 2 of said Portage County Certified Survey Map Number 11001 as recorded in Volume 50 of 'Certified surveys', page 131, document number 832095 a distance of 143.00 feet to the southwest corner of Lot One of Portage County Certified Survey Map Number 1441, as recorded in Volume 5 of 'Certified Surveys', page 199; thence east along the south line of said Certified Survey to the west line of the Southeast Quarter of the Northeast Quarter of Section 35; thence north along said west line to the northwest corner of Lot 5 of Block 1 of Treder's Woodland Park Subdivision; thence east along the north line of said Lot 5 and the north line of Lot 4 of said Block 1 to the southwest corner of Lot 2 in said Block 1; thence north along the west line of said Lot 2 to the southwest corner of Lot 1 of said Block 1; thence east along the south line of said Lot One and its easterly extension and along the south line of Lot 7, Block 2, of Treder's Woodland Park Subdivision to the

southeast corner of said Lot 7, said corner also being on the west line of lands described in Volume 339 of 'Warranty Deeds' Page 79, Portage County Register of Deeds; thence south along said west line to its southwest corner; thence east along the south line of said land described and the south line of lands described in Volume 275 of 'Records', page 161 and the south line of Lot 1 of Treder's Woodland Park Subdivision to the west right of way line of Brilowski Road; thence south along said west right of way line to its intersection with the east-west Quarter line of Section 36; thence North 89 degrees 48 minutes 15 seconds West along said east-west Quarter line 8.01 feet to the northerly extension of the west right of way line of said Brilowski Road; thence South 00 degree 08 minutes 00 seconds West along said northerly extension 36.00 feet to the northeast corner of Lot 12 of Heritage Estates Subdivision and the south right of way line of Jefferson Street; thence North 89 degrees 48 minutes 15 seconds West along said south right of way line 146.99 feet to the northwest corner of said Lot 12; thence South 00 degree 11 minutes 45 seconds West along the west line of said Lot 12 a distance of 200.00 feet to the southwest corner of said Lot 12; thence South 89 degrees 48 minutes 15 seconds East along the south line of said Lot 12 a distance of 147.21 feet to the southeast corner of said Lot 12 and the west right of way line of said Brilowski Road; thence continuing South 89 degrees 48 minutes 15 seconds East along the easterly extension of the south line of said Lot 12 a distance of 77.10 feet to the east right of way line of said Brilowski Road; thence North 00 degree 08 minutes 00 seconds East along said east right of way line 236.00 feet to its intersection with the east-west Quarter line of said Section 36; thence North 89 degrees 14 minutes 05 seconds East along said east-west Quarter line to the southeast corner of the Southwest Quarter of the Northwest Quarter of said Section 36; thence North 00 degree 35 minutes 34 seconds West along the east line of said Southwest Quarter of the Northwest Quarter to the southwest corner of Lot 1 of Portage County Certified Survey Map Number 10738 as recorded in volume 49 of 'Certified Surveys', page 18; thence North 89 degrees 07 minutes 59 seconds East along the south line of said Lot 1 a distance of 243.71 feet; thence continuing North 89 degrees 02 minutes 32 seconds East along said south line 283.72 feet to the southeast corner thereof; thence North 00 degrees 12 minutes 39 seconds West along the east line of said Lot 1 a distance of 494.80 feet to the south right of way line of U.S. Highway 10; thence North 89 degrees 19 minutes 50 seconds East along said south right of way line 824.37 feet to the east line of the west 33 feet of the Northwest Quarter of the Northeast Quarter of said Section 36, Township 24 North, Range 8 East; thence continuing North 89 degrees 00 minutes 02 seconds East along said south right of way line 952.38 feet to the southerly extension of the east line of Lot 1 of Portage County Certified Survey Map Number 8701 as recorded in Volume 35 of 'Certified Surveys', Page 81; thence North 00 degree 23 minutes 15 seconds West along said southerly extension 127.01 feet to the north right of way line of said U.S. Highway 10 and the southeast corner of said Lot 1; thence North 89 degrees 07 minutes 19 seconds East along said north right of way line 216.18 feet; thence North 49 degrees 19 minutes 21 seconds East along said north right of way line 23.43 feet; thence North 89 degrees 07 minutes 41 seconds East along said north right of way line 40.00 feet; thence South 50 degrees 59 minutes 46 seconds East along said north right of way line 23.50 feet; thence North 89 degrees 02 minutes 40 seconds East along said north right of way line 40.72 feet; thence North 89 degrees 01 minutes 25 seconds East along said north right of way line 407.77 feet; thence North 00 degrees 58 minutes 35 seconds West along said north right of way line 40.18 feet; thence easterly along said north right of way line along the arc of a 7,737.85 foot radius curve, not tangent to the last described course, center to the south, the chord bears South 89 degrees 18 minutes 21 seconds East 452.43 feet; thence South 02 degrees 22 minutes 10 seconds West along said north right of way line 10.00 feet; thence southeasterly along said north right of way line along the arc of a 7,727.85 foot radius curve, not tangent to the last described course, center to the south, to the northwesterly line of lands recorded with the Portage County Register of Deeds in Warranty Deed Volume 273, Page 695, as platted on unrecorded survey dated July 29, 1968; thence North 10 degrees 04 minutes 18 seconds East along said northwesterly line to the northeasterly line of said lands; thence South 80 degrees 42 minutes 48 seconds East along said northeasterly line 315.00 feet to the east line of the Northeast Quarter of the Northeast Quarter of said Section 36; thence north along said east line to the southeast corner of the Southeast Quarter of the Southeast Quarter of Section 25; thence north along the east line of said Southeast Quarter of the Southeast Quarter of Section 25 to the northeast corner thereof; thence west along the north line of said Southeast Quarter of the Southeast Quarter of Section 25 to the northeast corner of Outlot 2 of Portage County Certified Survey Map Number 11289-52-119; thence South 00 degrees 32 minutes 42 seconds East along the east line of said Outlot 2 a distance of 662.57 feet to the southeast corner thereof; thence South 89 degrees 40 minutes 47 seconds West along the south line of said Outlot 2 a distance of 658.82 feet to the southwest corner thereof and the east line of Outlot 1 of Portage County Certified Survey Map Number 7894-30-24; thence North 00 degrees 16 minutes 33 seconds West along said east line 612.29 feet to the northeast corner thereof; thence South 89 degrees 50 minutes 11 seconds West and parallel with the north line of said Southwest Quarter of the Southeast 1,219.35 feet; thence South 00 degree 14 minutes 52 seconds East 240.21 feet; thence South 89 degrees 59 minutes 02 seconds West 100.00 feet to the west line of said Southwest Quarter of the Southeast Quarter; thence South 89 degrees 59 minutes 02 seconds West 2,659.85 feet to the west right of

way line of Brilowski Road; thence South 00 degree 13 minutes 33 seconds West 1,021.37 feet to the north right of way line of Walter Street; thence west along said north right of way line to the east line of lands conveyed to the City of Stevens Point (Bannach School) in Volume 277 of 'Warranty Deeds' pages 501 and 502 as recorded in the Portage County Register of Deeds; thence north along said east line, said line being parallel with the west line of the Southwest Quarter of the Southeast Quarter of Section 26, to a line 1,160.00 feet north of and parallel with the south line of said Southwest Quarter of the Southeast Quarter; thence North 89 degrees 58 minutes 20 seconds West along said parallel line 91.05 feet to the southeast corner of Lot One-A of Portage County Certified Survey Map Number 1010 as recorded in Volume 4 of 'Certified Surveys', page 68; thence North 00 degree 11 minutes 50 seconds West along the east line of said Lot One-A and its northerly extension 490.85 feet to the northwesterly right of way line of Golla Road; thence South 75 degrees 28 minutes 25 seconds West along said right of way line 320.60 feet; thence continuing South 48 degrees 14 minutes 00 seconds West along said right of way line 212.56 feet to the westerly line of said Lot One-A and its northwesterly extension; thence South 41 degrees 46 minutes 00 seconds East along said line and its extension 261.42 feet; thence South 00 degree 01 minutes 40 seconds West a distance of 73.72 feet to the southwest corner of said Lot One-A; thence South 81 degrees 32 minutes 16 seconds West along the south line of Outlot 1 of Portage County Certified Survey Map Number 6609 as recorded in Volume 24 of 'Certified Surveys', Page 132 and its southwesterly extension to its intersection with the west right of way line of Golla Road/Sandy Lane; thence South 00 degree 04 minutes 00 seconds East along said right of way line to a line 240 feet north of and parallel with the south line of Section 26; thence west along said line a distance of 247.83 feet; thence south and parallel with said east line of the Southeast Quarter of the Southwest Quarter of said Section 26 a distance of 37.93 feet; thence west and parallel with said south line a distance of 122 feet; thence south and parallel with said east line a distance of 201.20 feet to the south line of Section 26; thence east along said south line to the west line of Lot 3A of Portage County Certified Survey Map Number 1012 as recorded in Volume 4 of 'Certified Surveys', page 70; thence south along said west line of said Lot 3A to its southwest corner; thence east along the south line of said Lot 3A to the west right of way line of Sandy Lane; thence south along said west right of way line to the north line of Lot 7 of Treder's Woodland Park West Subdivision located in the Northeast Quarter of the Northwest Quarter of Section 35; thence west along said north line of Lot 7 to its northwest corner; thence south along the west line of said Lot 7 to its southwest corner; thence east along the south line of said Lot 7 to the west right of way line of Sandy Lane; thence south along said west right of way line of Sandy Lane to the westerly extension of the north line of Lot 1 of Portage County Certified Survey Map number 748 as recorded in Volume 3 of 'Certified Surveys', page 106; thence east along said westerly extension to the west line of the Northwest Quarter of the Northeast Quarter of said Section 35; thence south along said west line to the westerly extension of the north line of Lot 2 of said Portage County Certified Survey Map number 748 as recorded in Volume 3 of 'Certified Surveys', page 106; thence east along said westerly extension of said Lot 2 and the south right of way line of Windy Drive to the northeast corner of said Lot 2; thence south along the east line of said Lot 2 to the southeast corner thereof; thence west along the south line of said Lot 2 to the east right of way line of Sandy Lane; thence westerly to the southeast corner of Lot B-2 of Portage County Certified Survey Map number 1402, as recorded in Volume 5 of 'Certified Surveys', page 160; thence north along the east line of said Lot B-2 to the northeast corner of said Lot B-2; thence west along the north line of said Lot B-2 to the northwest corner of said Lot B-2; thence north along the east line of Lot B-3 of said Certified Survey Map number 1402 to the northeast corner of said Lot B-3, said corner also being the southeast corner of Treder's Woodland Park West Subdivision located in said Section 35; thence west along the south line of said subdivision to the east line of Lot 12 of said Treder's Woodland Park West Subdivision; thence north along the east line of said Lot 12 to a line 80 feet north of and parallel with the south line of said Treder's Woodland Park West Subdivision; thence west along said parallel line to the east line of Lot 14 of said Treder's Woodland Park West Subdivision; thence north along the east line of said Lot 14 and its northerly extension to the north right of way line of Woodland Circle; thence west along said north right of way line to the east right of way line of Maple Bluff Road; thence north along said east right of way line to the northwesterly right of way line of Golla Road; thence southwesterly along said northwesterly right of way line to a line 100 feet west of and parallel with the west right of way line of Maple Bluff Road; thence south along said parallel line to the southeasterly right of way line of Golla Road; thence southwesterly along said southeasterly right of way line to the north right of way line of U.S. Highway 51 (A/K/A Interstate 39); thence westerly along said right of way line of U.S. Highway 51 (A/K/A Interstate 39) to the east line of Section 34; thence north along said east line to the northeast corner of said Section 34; thence continuing north along the east line of Section 27 to the southeast corner of Lot 39 of Virginia's Addition to Plover Terrace Estates; thence West along the south line of said Lot 39 to the southeasterly right of way line of Barbara's Lane; thence southwesterly along the southeasterly right of way line of Barbara's Lane 444.61 feet along the arc of a 316.00 foot radius curve, center to the northwest, central angle = 80 degrees 36 minutes 53 seconds ; thence west along the south right of way line of said Barbara's Lane to the west right of way line

of Hofmeister Drive; thence south along said west right of way line to the south line of Lot 35 of said Virginia's Addition to the Plover Terrace Estates; thence west along said Lot 35 to the northeasterly right of way line of U.S. Highway 51 (A/K/A Interstate 39); thence westerly across said right of way to the intersection of the southwesterly right of way line of U.S. Highway 51 (A/K/A Interstate 39) and the west line of the Southeast Quarter of the Southeast Quarter of Section 27; thence south along said west line to the north line of Section 34; thence east along said north line to the east line of land conveyed to Leo N. Gullikson as recorded in Volume 211, of 'Deeds', page 114, Portage County Register of Deeds; thence south along said east line to the north right of way line of U.S. Highway 10; thence west along said north right of way line 379.5 feet, said right of way line being 50 feet northerly of (measured at right angles) and parallel with the reference line of Right of Way Plat Project T 05-3(22); thence north at right angles to said north right of way line 45 feet; thence west along said north right of way line to its intersection with the west bank of the Big Plover River (prior to the channel change of 1969); thence northerly along the west bank of the Big Plover River (prior to channel change of 1969) 403 feet to the south line of Outlot 1 of Portage County Certified Survey Map Number 6868 as recorded in Volume 25 of 'Certified Surveys', page 91; thence east along said south line to the west bank of the Big Plover River; thence northerly along said west bank to the north line of said Outlot 1; thence west along said north line to the west line of the Northwest Quarter of the Northeast Quarter; thence north along said west line of the Northwest Quarter of the Northeast Quarter of Section 34 to its northwest corner; thence east along the south line of the Southwest Quarter of the Southeast Quarter of Section 27 to the east line of the west one-half of said Southwest Quarter of the Southeast Quarter; thence north along said east line to the north line of the south 660 feet; thence west 8 rods (132 feet); thence north and parallel with the west line of said Southwest Quarter of the Southeast Quarter to the north line thereof; thence east along the north line of the Southwest Quarter of the Southeast Quarter 132.5 feet; thence north and parallel with the west line of the Northwest Quarter of the Southeast Quarter of Section 27 to the north line thereof; thence east along the south line of the Southwest Quarter of the Northeast Quarter of Section 27 to the southeast corner thereof; thence north along the east line of the Southwest Quarter of the Northeast Quarter of Section 27 a distance of 24.75 feet; thence east and parallel with the south line of the Southeast Quarter of the Northeast Quarter of Section 27 to the east line thereof; thence south along the east line of said Southeast Quarter of the Northeast Quarter of Section 27 a distance of 24.75 feet to the southeast corner thereof; thence east along the south line of the Southwest Quarter of the Northwest Quarter of Section 26 to its southeast corner thereof; thence north along the east line of the Southwest Quarter of the Northwest Quarter of Section 26 to its northeast corner thereof; thence east along the south line of the Northeast Quarter of the Northwest Quarter and the Northwest Fractional Quarter of the Northeast Quarter of Section 26 to the Big Plover River; thence northerly along the Big Plover River to its intersection with the east line of the west one-half of the Northwest Fractional Quarter of the Northeast Quarter of Section 26; thence north along the east line of the west one-half of said Northwest Fractional Quarter of the Northeast Quarter to the south line of the north one-half of said Northwest Fractional Quarter of the Northeast Quarter; thence east along said south line to the west line of the Northeast Quarter of the Northeast Quarter of said Section 26; thence south along said west line to the north line of the south 10 rods (165 feet) of said Northeast Quarter of the Northeast Quarter; thence east along said north line to the east line of Section 26; thence north along the east line of Section 26 to the southwest corner of Section 24; thence North 00 degrees 36 minutes 25 seconds West along the west line of Section 24 a distance of 290.00 feet to the northwest corner of Lot One of Portage County Certified Survey Map number 1561 as recorded in Volume 6 of 'Certified Surveys', page 19; thence North 89 degrees 39 minutes 10 seconds East along the north line of said Lot One and its easterly extension and along the north line of Lot One of Portage County Certified Survey Map number 2030 as recorded in Volume 7 of 'Certified Surveys', page 188 and its easterly extension to its intersection with the east right of way line of Brilowski Road North; thence north along said east right of way line to the north right of way line of Brilowski Road North; thence west along said north right of way line to its intersection with the east line of the Northwest Quarter of the Northwest Quarter of Section 24; thence north along said east line and the east line of the Southwest Fractional Quarter of the Southwest Quarter and the east line of the Northwest Fractional Quarter of the Southwest Quarter of Section 13 to the northeast corner of said Northwest Fractional Quarter of the Southwest Quarter; thence west along the north line of said Northwest Fractional Quarter of the Southwest Quarter to its northwest corner thereof; thence south along the east line of the Northeast Quarter of the Southeast Quarter of Section 14 to its intersection with the north line of the south 32 rods (528 feet); thence west along said north line to the east right of way line of Plover Heights Road; thence south along said right of way line to the north line of the Southeast Fractional Quarter of the Southeast Quarter of said Section 14; thence South 00 degree 12 minutes 40 seconds East along the east right of way line of Plover Heights Road as laid out in Portage County Certified Survey Map number 920, as recorded in Volume 3 of 'Certified Surveys', page 278 a distance of 150.00 feet; thence southeasterly 29.58 feet along the arc of a 50.00 foot radius curve, center to the east (central angle = 33 degrees 54 minutes 05 seconds), the chord bears South 17 degrees 09 minutes

42.5 seconds East a distance of 29.15 feet; thence southerly, westerly and northerly 216.25 feet along the arc of a 50.00 foot radius cul-de-sac, center to the north, (central angle = 247 degrees 48 minutes 10 seconds) the chord bears South 89 degrees 47 minutes 20 seconds West a distance of 82.99 feet; thence northeasterly 29.58 feet along the arc of a 50.00 foot radius curve, center to the west (central angle = 33 degrees 54 minutes 05 seconds), the chord bears North 16 degrees 44 minutes 22.5 seconds East a distance of 29.15 feet to the south line of the north 150 feet of the Southwest Quarter of the Southeast Quarter of Section 14; thence west along said south line to its intersection with the west line of the east 290 feet of said Southwest Quarter of the Southeast Quarter; thence north along said west line to the south line of the Northwest Quarter of the Southeast Quarter of Section 14; thence east along said south line to the west right of way line of Plover Heights Road; thence north along said west right of way line to the north line of said Northwest Quarter of the Southeast Quarter; thence west along said north line to the southeasterly right of way line of State Trunk Highway 66; thence southwesterly along said southeasterly right of way line to point 22 rods (363 feet) northeasterly as measured along said right of way line from the west line of said Northwest Quarter of the Southeast Quarter of Section 14; thence southeasterly along the northeasterly line of lands described in Volume 208 of 'Warranty Deeds', page 199, Portage County Register of Deeds to its northeasterly corner; thence south along the east line of said lands described to the northeasterly corner of Lot One of Portage County Certified Survey Map number 742 as recorded in Volume 3 of 'Certified Surveys', page 100; thence South 01 degree 03 minutes 16 seconds East a distance of 594.17 feet along the east line of said Lot One to its southeast corner thereof; thence South 88 degrees 35 minutes 30 seconds West a distance of 330.00 feet along the south line of said Lot One to its southwest corner thereof; thence south along the east line of the Northeast Quarter of the Southwest Quarter of Section 14 to its southeast corner thereof; thence west along the south line of said Northeast Quarter of the Southwest Quarter to its intersection with the northwesterly right of way line of State Trunk Highway 66; thence northeasterly along said northwesterly right of way line to the southwesterly corner of lands described in Volume 382 of 'Warranty Deeds', page 581 Portage County Register of Deeds; thence northwesterly at right angles to said right of way line 250 feet; thence northeasterly and parallel with said northwesterly right of way line of State Trunk Highway 66 to the southwesterly right of way line of Somerset Drive; thence northwesterly along said southwesterly right of way line to the north line of the Northeast Quarter of the Southwest Quarter of Section 14; thence west along said north line and the north line of the Northwest Quarter of the Southwest Quarter of said Section 14 to the east right of way line of Torun Road; thence North 00 degree 21 minutes 14 seconds East a distance of 757.4 feet along said east right of way line; thence North 89 degrees 40 minutes 59 seconds West a distance of 727.2 feet; thence North 00 degree 21 minutes 14 seconds East a distance of 568.00 feet to the north line of the Southeast Quarter of the Northeast Quarter of Section 15; thence North 89 degrees 40 minutes 59 seconds West a distance of 593.28 feet along said north line to its northwest corner; thence South 00 degree 16 minutes 45 seconds West a distance of 618.40 feet along the west line of said Southeast Quarter of the Northeast Quarter; thence North 89 degrees 32 minutes 55 seconds West a distance of 61.25 feet; thence South 00 degree 16 minutes 45 seconds West and parallel with said west line 348.00 feet; thence South 89 degrees 32 minutes 55 seconds East a distance of 61.25 feet to said west line; thence South 00 degree 16 minutes 45 seconds West along said west line 104.00 feet; thence South 89 degrees 32 minutes 55 seconds East a distance of 157.42 feet; thence South 60 degrees 02 minutes 22 seconds East a distance of 444.84 feet to the north right of way line of Wojcik Memorial Drive; thence south at right angles to said north right of way line to the south right of way line of said Wojcik Memorial Drive; thence west along said south right of way line and its extension to the west line of the east two rods (33 feet) of the Northeast Quarter of the Southwest Quarter of Section 15; thence south along said west line to the north line of said Southeast Quarter of the Southwest Quarter; thence west along said north line to the northwest corner thereof; thence south along the west line of said Southeast Quarter of the Southwest Quarter of Section 15 and the west line of the Northeast Quarter of the Northwest Quarter of Section 22 to its southwest corner thereof; thence east along the south line of said Northeast Quarter of the Northwest Quarter to its southeast corner thereof; thence north along the east line of said Northeast Quarter of the Northwest Quarter to the south right of way line of Norway Pine Drive; thence South 89 degrees 25 minutes East along said south right of way line to its intersection with the west line of Lot 3, Block 1 of Airport Park Addition to the Town of Hull, located in the Northeast Quarter of Section 22; thence South 00 degree 21 minutes West 185 feet to the southwest corner of said Lot 3; thence South 89 degrees 25 minutes East 150 feet to its southeast corner; thence North 00 degree 21 minutes East 185 feet to its northeast corner , said corner on the south right of way line of Norway Pine Drive; thence east along said right of way line to the east right of way line of Torun Road; thence north along said east right of way line to a point 101.95 feet south of the southwest corner of Lot 1 of PCCSMN 1188-4-246; thence South 89 degrees 25 minutes 37 seconds East 484.91 feet; thence North 40 degrees 03 minutes 45 seconds East 129.44 feet to the northwest corner of Outlot 1 of PCCSMN 6162-22-235 and a point on the south line of Lot 2 of said PCCSMN 1188-4-246; thence North 89 degrees 13 minutes 32 seconds West along said south line and the south line of said Lot 1 of PCCSMN 1188-4-246 a distance of 570.51

feet to said east right of way line of Torun Road; thence north along said east right of way line to the south line of the north 8 rods (132 feet) of the Southwest Quarter of the Southwest Quarter of Section 14, T24N, R8E; thence east along said south line to the east line of the west 40 rods (660 feet) of said Southwest Quarter of the Southwest Quarter; thence north along said east line to the north line of the south 4 rods (66 feet) of said north 8 rods (132 feet); thence west along said north line to the east right of way line of Torun Road; thence north along said east right of way line to the north line of said Southwest Quarter of the Southwest Quarter of Section 14; thence east along said north line to the northeast corner thereof; thence south along the east line of said Southwest Quarter of the Southwest Quarter to the southeasterly right of way line of State Trunk Highway 66, said point also the most northerly corner of Lot 4-A of Portage County Certified Survey Map number 949 as recorded in Volume 4 of 'Certified Surveys', page 7; thence South 41 degrees 47 minutes 28 seconds West along said right of way line a distance of 32.49 feet to its most westerly corner of said Lot 4-A; thence South 48 degrees 12 minutes 32 seconds East a distance of 27.80 feet to the east line of said Southwest Quarter of the Southwest Quarter of Section 14; thence South 1 degrees 14 minutes 11 seconds West along said east line 204.99 feet to the most northerly corner of Lot 4-C of said Certified Survey Map; thence South 24 degrees 49 minutes 10 seconds West along the westerly line of said Lot 4-C and the westerly line of Lot 3-B and 2-B of Portage County Certified Map number 948 as recorded in Volume 4 of 'Certified Survey', page 6 and the westerly line of Lot 1-B of Portage County Certified Survey Map number 947 as recorded in Volume 4 of 'Certified Surveys', page 5, a distance of 457.82 feet to the north line of the Northwest Quarter of the Northwest Quarter of Section 23; thence west along said north line to its intersection with a line parallel with and 750 feet northwesterly of (measured at right angles) the centerline and its northeasterly extension of Stevens Point Municipal Airport runway 3-21; thence South 33 degrees 21 minutes West along said line parallel with runway 3-21 to the north line of Parcel D of Portage County Certified Survey Map number 552 as recorded in Volume 2 of 'Certified Surveys', page 212; thence North 89 degrees 08 minutes 10 seconds West along said north line to the northeasterly corner of Parcel C of said Certified Survey Map; thence South 48 degrees 45 minutes 00 seconds West along the easterly line of said Parcel C a distance of 198.99 feet; thence South 38 degrees 21 minutes 17 seconds West along the easterly line of Parcel B of said Certified Survey Map 187.14 feet; thence South 15 degrees 21 minutes 59 seconds West along the easterly line of Parcel A of said Certified Survey Map 112.35 feet; thence South 48 degrees 39 minutes 11 seconds East a distance of 215.00 feet; thence South 41 degrees 44 minutes 46 seconds West a distance of 400.00 feet to the south line of the Northwest Quarter of the Northwest Quarter of Section 23; thence west along said south line of the Northwest Quarter of the Northwest Quarter of Section 23 to the southwest corner thereof; thence north along the west line of said Northwest Quarter of the Northwest Quarter to the north right of way line of Walton Road; thence South 89 degrees 49 minutes 46 seconds West along said north right of way line 396.17 feet to the southeasterly right of way line of State Trunk Highway 66; thence South 40 degrees 27 minutes 00 seconds West along said southeasterly right of way line 132.61 feet; thence South 57 degrees 57 minutes 12 seconds East along the southwesterly line of Lot 2 of Portage County Certified Survey Map Number 3571 as recorded in Volume 12 of 'Certified Surveys', page 229 a distance of 278.63 feet; thence South 21 degrees 29 minutes 40 seconds West along the westerly line of Lot 1 of said certified survey a distance of 205.25 feet; thence North 49 degrees 33 minutes 00 seconds West along the southerly line of Lot 3 of said certified survey 342.31 feet to the southeasterly right of way line of State Trunk Highway 66; thence South 40 degrees 27 minutes 00 seconds West along said southeasterly right of way line 100 feet; thence continuing South 40 degrees 23 minutes 54 seconds West along said southeasterly right of way line 100.00 feet; thence South 49 degrees 36 minutes 06 seconds East and parallel with said southerly line of said Lot 3 a distance of 551.57 feet to the northwesterly line of Lot 1 of Portage County Certified Survey Map Number 10340 as recorded in Volume 46 of 'Certified Surveys', page 70; thence southwesterly along said northwesterly line of said Lot 1 to a point on the south line of the Southeast Quarter of the Northeast Quarter of said Section 22, said point being 800 feet west of the southeast corner thereof; thence west along said south line of the Southeast Quarter of the Northeast Quarter of Section 22 to the southwest corner thereof; thence north along the west line of said Southeast Quarter of the Northeast Quarter of Section 22 to the southeasterly right of way line of State Highway 66; thence southwesterly along said right of way line to the north line of the Northwest Quarter of the Southeast Quarter of Section 22; thence west along the north line of said Northwest Quarter of the Southeast Quarter and the north line of the Northeast Quarter of the Southwest Quarter of Section 22 to the west line of the Northeast Quarter of the Southwest Quarter of Section 22; thence south along said west line to the south line of the north one-half of the south one-half of said Northeast Quarter of the Southwest Quarter; thence east along said south line and the south line of the north one-half of the south one-half of the Northwest Quarter of the Southeast Quarter to the southeasterly right of way line of State Trunk Highway 66; thence southwesterly along said right of way line to its intersection with the northeasterly line and its southeasterly extension of Lot One of Portage County Certified Survey Map number 513 as recorded in Volume 2 of 'Certified Surveys', page 173; thence northwesterly along said southeasterly extension of Lot One to the northwesterly

right of way line of said State Trunk Highway 66; thence continuing northwesterly along said northeasterly line of Lot One a distance of 792.85 feet; thence South 89 degrees 39 minutes 39 seconds West along the northerly line of said Lot One a distance of 97.12 feet to the northeasterly line of Lot One of Portage County Certified Survey Map Number 9607-41-87; thence North 40 degrees 25 minutes 13 seconds West along said northeasterly line 156.75 feet; thence North 89 degrees 32 minutes 37 seconds West along the north line of said Lot One a distance of 128.15 feet; thence South 47 degrees 37 minutes 34 seconds West along the northwesterly line of said Lot One a distance of 638.12 feet to the northeasterly right of way line of U.S. Highway 51 (A/K/A Interstate 39); thence southeasterly along said northeasterly right of way line to a line 600 feet north of and parallel with the south line of the Southwest Quarter of the Southwest Quarter of Section 22; thence west along said parallel line to its intersection with the southwesterly right of way line of said U.S. Highway 51 (A/K/A Interstate 39); thence North 32 degrees 38 minutes 23 seconds West along said southwesterly right of way line to its intersection with the centerline of Moses Creek; thence South 48 degrees 21 minutes 48 seconds West along the center line of said Moses Creek to a line 30 feet easterly of and parallel with the east right of way line of Wilshire Boulevard North; thence South 08 degrees 02 minutes 34 seconds West along said parallel line 308.12 feet to the north right of way line of North Point Drive; thence South 00 degree 18 minutes 26 seconds East 66.00 feet to the south right of way line of said North Point Drive; thence North 89 degrees 41 minutes 34 seconds East along the south right of way line to its intersection with the east line of the west 312.25 feet of the Northwest Quarter of the Northwest Quarter of Section 27; thence south along said east line to the south line of the north 223.8 feet of said Northwest Quarter of the Northwest Quarter; thence west along said north line and its westerly extension to the west right of way line of Wilshire Boulevard North; thence south along said right of way line to the northeast corner of Lot 4 of Block 1 of Walter Carl Przybylski Subdivision located in the Northeast Quarter of the Northeast Quarter of Section 28; thence west along the north line of said Lot 4 to the northwest corner thereof; thence south along the west line of said Lot 4 and the west line of Lots 5, 6, 7, 8, 9, 10, 11 and 12 of said Block 1 and its southerly extension to the south right of way line of Fourth Avenue; thence east along said right of way line to the southwest corner of Fourth Avenue and Wilshire Boulevard North; thence south along the west right of way line of Wilshire Boulevard North to the northwest corner of Wilshire Boulevard North and Stanley Street; thence southeasterly to the southwest corner of Wilshire Boulevard North and Stanley Street; thence south along the west right of way line of Wilshire Boulevard North to the south right of way line of East Maria Drive; thence east along said south right of way line of East Maria Drive to the east right of way line of Wilshire Boulevard North; thence north along said east right of way line to its intersection with a line 345 feet north of the south line of the Southwest Quarter of the Northwest Quarter; thence east along said line to the west line of Lot 4 of Portage County Certified Survey Map Number 5297 as recorded in Volume 19 of 'certified surveys', page 107; thence South 00 degrees 01 minutes 23 seconds West along said west line to the southwest corner of said Lot 4; thence North 89 degrees 50 minutes 02 seconds East along the south line of said Lot 4 to its intersection with a line 200 feet west of the west right of way line of Green Avenue North; thence south and parallel with said west right of way line to its intersection with the north right of way line of East Maria Drive; thence South 89 degrees 50 minutes 02 seconds West along said right of way line to its intersection with the west line of Lot One of Portage County Certified Survey Map Number 6539 as recorded in Volume 24 of 'Certified Surveys', page 62 and its northerly extension; thence South 00 degree 52 minutes 19 seconds East along said west line 297.18 feet to its intersection with a line 10 feet north of and parallel with the south line of Lot Three of said survey; thence North 89 degrees 28 minutes 06 seconds East along said parallel line 260.27 feet to the west right of way line of Green Avenue; thence North 00 degree 11 minutes 36 seconds West along said west right of way line to the south line of the north 205½ feet of the Northwest Quarter of the Southwest Quarter of said Section 27; thence east along said south line and the south line of the north 205½ feet of the Northeast Quarter of the Southwest Quarter of said Section 27 to the east line of the west 216.5 feet of said Northeast Quarter of the Southwest Quarter; thence north along said east line to the south right of way line of East Maria Drive; thence east along said south right of way line to a point 298.05 feet east of the southeast corner of Green Avenue and East Maria Drive; thence north 43 feet; thence east on a line 10 feet northerly of and parallel with the centerline of East Maria Drive 250.95 feet; thence north 260 feet; thence west to the east line of the west 200 feet of the Southeast Quarter of the Northwest Quarter of Section 27; thence north along said east line to the south right of way line of Doolittle Drive; thence west along said south right of way line to the east right of way line of Green Avenue North; thence north along said east right of way line to its intersection with the south line of the north 40 rods (660 feet) of the Southeast Quarter of the Northwest Quarter of said Section 27; thence east along said south line to the east line of the west 16 rods (264 feet) of said Southeast Quarter of the Northwest Quarter; thence north along said east line to the south right of way line of Kennedy Drive; thence North 88 degrees 42 minutes 40 seconds East along said right of way line to the west line of the east 860.8 feet of said Southeast Quarter of the Northwest Quarter; thence North 00 degree 38 minutes 20 seconds West along said west line to the south right of way line of Mitchell Drive; thence east along said south right of

way line to the southwesterly right of way line of U.S. Highway 51 (A/K/A Interstate 39); thence northwesterly along said southwesterly right of way line to the south line of the Northeast Quarter of the Northwest Quarter of said Section 27; thence east along said south line of the Northeast Quarter of the Northwest Quarter to a point 238 feet west of the southeast corner thereof; thence south 495 feet; thence west 108.8 feet; thence south 305 feet to the north right of way line of Doolittle Drive; thence east 346.80 feet; thence south 50 feet to the south right of way line of said Doolittle Drive; thence west along the south right of way line 513.55 feet; thence south 200 feet; thence west 208 feet; thence south 276.40 feet to the north line of the Northeast Quarter of the Southwest Quarter of Section 27; thence west along said north line to a point 977.20 feet west of the center of Section 27; thence south 365.50 feet; thence West 125 feet; thence South to a point on the north line of the south 950 feet of said Northeast Quarter of the Southwest Quarter; thence west along said north line to the west right of way line of Green Avenue; thence north along said west right of way line to the north line of the south 1,056 feet of the Northwest Quarter of the Southwest Quarter; thence west and parallel with the south line of said Northwest Quarter of the Southwest Quarter to a line 330 feet west of and parallel with the east line of said Northwest Quarter of the Southwest Quarter; thence south along said parallel line 132 feet; thence east and parallel with said south line to the west right of way line of Green Avenue; thence south along said west right of way line to a line 792 feet north of and parallel with the south line of the Northwest Quarter of the Southwest Quarter of said Section 27; thence west along said parallel line to its intersection with a line 330 feet west of and parallel with the east line of said Northwest Quarter of the Southwest Quarter; thence south along said parallel line 267 feet to the southwest corner of Lot One of Portage County Certified Survey Map Number 6570 as recorded in Volume 24 of 'Certified Surveys', page 93; thence North 89 degrees 28 minutes 00 seconds East along the south line of said Lot One 300.00 feet to the northeast corner of Lot Two of said Portage County Certified Survey Map Number 6570 and the west right of way line of Green Avenue; thence South 00 degrees 20 minutes 45 seconds West along the east line of said Lot Two and the east line of Lot Three of Portage County Certified Survey Map Number 3001 as recorded in Volume 10 of 'Certified Surveys', page 259 and said west right of way line 260.03 feet to the southeast corner of said Lot Three; thence South 89 degrees 15 minutes 45 seconds West along the south line of said Lot Three 300.00 feet; thence South 00 degrees 28 minutes 16 seconds East 131.73 feet; thence South 89 degrees 09 minutes 19 seconds West 130.00 feet; thence South 00 degrees 28 minutes 16 seconds East 132.26 feet to the southwest corner of Oultlot Two of Portage County Certified Survey Map Number 10739 as recorded in Volume 49 of 'Certified Surveys', page 19 and the south line of the Northwest Quarter of the Southwest Quarter of Section 27; thence west along said south line of the Northwest Quarter of the Southwest Quarter to the east right of way line of Weir Boulevard; thence northerly along said east right of way line to the north line and its easterly extension of lands conveyed to Eugene A. and D. Weir as described in Volume 332 of 'Deeds', page 501, Portage County Register of Deeds; thence west along said north line to the east line of the west 30 feet of the Northwest Quarter of the Southwest Quarter of Section 27; thence north along said east line to the north right of way line of Harmony Lane and its easterly extension; thence west along said north right of way line to the east line of lands conveyed to S.P.E.B.S.O.S.A.. Inc. as recorded in Volume 406 of Micro-Records, page 143, Portage County Register of Deeds; thence north along said east line 125 feet; thence west on a line parallel with the north line of the Northeast Quarter of the Southeast Quarter of Section 28, Township 24 North, Range 8 East, a distance of 105 feet to the east line of land conveyed to S.P.E.B.S.O.S.A., Inc. as recorded in Portage County Register of Deeds, Volume 370 of Records, Page 473; thence north along said east line to the south right of way line of East Maria Drive; thence west along said south right of way line 120 feet; thence south and parallel with the east line of said Northeast Quarter of the Southeast Quarter to a point 125 feet north of the north right of way line of Harmony Lane; thence west 35 feet; thence south and parallel with said east line 125 feet to the north right of way line of said Harmony Lane; thence west along said north right of way line to the west line of Lot 2 of Portage County Certified Survey Map Number 4274 as recorded in Volume 15 of 'Certified Surveys', pages 69, 69A, and 69B; thence North 00 degrees 04 minutes 34 seconds East along said west line of Lot 2 a distance of 241.56 feet to the south right of way line of East Maria Drive; thence North 88 degrees 46 minutes 10 seconds East along said right of way line to the southerly extension of the east line of Lot 1 of Portage County Certified Map number 4101 as recorded in Volume 14 of 'Certified Surveys', page 156; thence North 00 degree 01 minutes 15 seconds East 60.01 feet to the north right of way line of East Maria Drive; thence South 89 degrees 59 minutes 13 seconds East along said right of way line 37.73 feet; thence North 00 degrees 01 minutes 15 seconds East along the perimeter of said Lot 1 of Portage County Certified Map number 6350 as recorded in Volume 23, page 173 a distance of 41.87 feet; thence continuing North 45 degrees 40 minutes 05 seconds East along said perimeter 500.40 feet; thence continuing North 44 degrees 20 minutes 00 seconds West along said perimeter 206.73 feet to the southeasterly right of way line of Stanley Street; thence northeasterly along said southeasterly right of way line to a point 371.83 feet measured southwesterly along said southeasterly right of way line of Stanley Street from its intersection with the east line of said Southeast Quarter of the Northeast Quarter of Section 28; thence southeasterly at right angles to said

Stanley Street a distance of 264 feet; thence northeasterly and parallel with said Stanley Street a distance of 165 feet; thence northwesterly at right angles to said Stanley Street a distance of 117.87 feet to the Southwest corner of Lot 1 of PCCSMN 2776-10-34; thence North 89 degrees 02 minutes 55 seconds East along the south line of said Lot 1 a distance of 174.45 feet; thence North 00 degree 04 minutes 18 seconds West on a line 10 feet west of and parallel with the west right of way line of Wilshire Boulevard North 371.25 feet to said southeasterly right of way line of Stanley Street; thence South 45 degrees 40 minutes 42 seconds West along said southeasterly right of way line to its intersection with the northeasterly property line and its southeasterly extension of land conveyed to James M. and Carolyn J. Nitka as recorded in Volume 534 of 'Deeds', page 1041, Portage County Register of Deeds; thence northwesterly along said northeasterly property line and its extension and the northeasterly property line of land conveyed to Warren M. and Mary A. Waite as recorded in Volume 222 of 'Deeds', page 315, Portage County Register of Deeds to the southeasterly right of way line of Fourth Avenue; thence northeasterly along said southeasterly right of way line to the southeast corner of Fourth Avenue and Wood Lane; thence east along the south right of way line of Fourth Avenue to its intersection with the southerly extension of a line 10 feet west of the east line of Lot 13, Block 1 of Walter Carl Przybylski Subdivision located in said Section 28; thence north along said line to the north line of Lot 16, Block 1; thence west along said north line of Lot 16 to the east right-of-way line of said Wood Lane; thence continuing west along the westerly extension of said north line of Lot 16 a distance of 40.00 feet; thence North on a line 20 feet east of and parallel with the west right-of-way line of said Wood Lane 355.00 feet to the easterly extension of the south right of way line of Birch Street; thence West along said easterly extension 20.00 feet to said west right of way line and the northeast corner of Lot 1 of Block 2 of said Walter Carl Przybylski Subdivision; thence continuing West along said south right of way line of Birch Street 73.97 feet to the northwest corner of said Lot 1; thence South 42 degrees 20 minutes West along the southeasterly right of way line of said Birch Street 153.95 feet to the most western corner of said Lot 1; thence South 47 degrees 50 minutes East along the southwesterly line of said Lot 1 a distance of 61.5 feet to the northwest corner of Lot 2 of said Block 2; thence East along the south line of said Lot 1 a distance of 132.00 feet to the southeast corner of said Lot 1 and said west right of way line of Wood Lane; thence south along said west right of way line to the northeast corner of Lot 3, of said Block 2; thence west along the north line of said Lot 3 to its northwest corner; thence south along the west line of said Lot 3 to its southwest corner; thence east along the south line of said Lot 3 to its southeast corner and the west right of way line of said Wood Lane; thence south along said west right of way line to the northeast corner of Lot 5 of said Block 2; thence west along the north line of said Lot 5 to its northwest corner; thence south along the west line of said Lot 5 to the northeast corner of Lot 14 of said Block 2; thence west along the north line of said Lot 14 and its westerly extension to the westerly right of way line of Vine Street; thence southerly along said right of way line to the southeasterly corner of Lot 3 in Block 4 of said Walter Carl Przybylski Subdivision; thence northwesterly along the northeasterly property line of said Lot 3 to its most northerly corner; thence southwesterly along the northwesterly property line of said Lot 3 and the northwesterly property line of Lots 4, 5, 6 and 7, in said Block 4 to the most easterly corner of Lot 12 of said Block 4; thence North 47 degrees 40 minutes West along the northeasterly line of said Lot 12 to its northeast corner; thence northwesterly to the north right of way line of Birch Street, 57.01 feet South 89 degrees 55 minutes East of the northeast corner of Birch Street and Indiana Avenue North; thence North 89 degrees 55 minutes West along the north right of way line of Birch Street and its westerly extension to the west right of way line of Indiana Avenue North; thence south along said west right of way line to a line 8 feet south of and parallel with the north line of said Southwest Quarter of the Northeast Quarter and the north line of Outlot 1 of PCCSMN 9165-38-95; thence South 88 degrees 46 minutes 36 seconds West along said parallel line 175.05 feet to the west line of said Outlot 1; thence South 00 degree 04 minutes 45 seconds West along said west line 7.00 feet to the southwest corner of said Outlot 1 and a line 15 feet south of and parallel with the north line of said Southwest Quarter of the Northeast Quarter; thence South 88 degrees 46 minutes 36 seconds West along said parallel line 785.80 feet to a line 15 feet east of and parallel with the west line of Outlot 1 of PCCSMN 6237-23-60; thence South 00 degree 04 minutes 45 seconds West along said parallel line 1,303.53 feet to a line 15 feet north of the south line of said Outlot 1; thence North 88 degrees 46 minutes 25 seconds East along said parallel line 63.00 feet to the west line of Lot 2 of PCCSMN 9164-38-94; thence North 88 degrees 33 minutes 12 seconds East 15 feet north of and parallel with the south line of said Lot 2 a distance of 224.47 feet; thence North 88 degrees 46 minutes 25 seconds East 15 feet north of and parallel with said south line 415.46 feet; thence South 01 degrees 13 minutes 35 seconds East 15.00 feet to the south line of said Southwest Quarter of the Northeast Quarter; and the Northeast corner of Lot 2 of PCCSMN 8891-36-121; thence South 88 degrees 49 minutes 51 seconds West along the north line of said Lot 2 a distance of 53.00 feet to the Northwest corner of said Lot 2; thence South 00 degree 07 minutes 54 seconds West along the west line of said Lot 2 a distance of 314.60 feet to the Southwest corner of said Lot 2 and the northwesterly right of way line of Stanley Street; thence South 59 degrees 59 minutes 00 seconds West along said northwesterly right of way line 61.28 feet to the Southwest corner of Lot 1 of said PCCSMN 8891-36-121 and the west line of the east 390.5 feet of said Northwest Quarter of the Southeast Quarter; thence north along said west line to the north line of said Northwest Quarter of the Southeast Quarter; thence west along said north line to a point

700.5 feet west of the northeast corner of said Northwest Quarter of the Southeast Quarter; thence South 00 degree 00 minutes 55 seconds West 517.5 feet to the northwesterly right of way line of Stanley Street; thence South 59 degrees 56 minutes 00 seconds West along the southeasterly right of way line of Stanley Street 67 feet to its intersection with a line measured 191.05 feet northeasterly along said right of way line from a line 925.98 feet (14.03 chains) west of and parallel with the east line of said Northwest Quarter of the Southeast Quarter; thence North 328 feet; thence southwesterly 191.05 feet to a point 414.42 feet south of the north line of said Northwest Quarter of the Southeast Quarter; thence north and parallel with said east line to its intersection with the south line of the Southwest Quarter of the Northeast Quarter; thence west along said south line to a point 1,003.98 feet west of the southeast corner of said Southwest Quarter of the Northeast Quarter; thence north and parallel with the east line of said Southwest Quarter of the Northeast Quarter to the north line thereof; thence east along said north line to a line 50 feet west of and parallel with the west right of way line of Indiana Avenue North; thence North 00 degree 20 minutes 12 seconds West along said parallel line 78.63 feet to a line 50 feet north of and parallel with the north right of way line of Birch Street; thence North 89 degrees 53 minutes 40 seconds East 212.63 feet along said parallel line to its intersection with the northwesterly right of way line of Birch Street; thence North 42 degrees 08 minutes 40 seconds East along said northwesterly right of way line 1,093.31 feet; thence North 89 degrees 48 minutes 40 seconds East 100.49 feet along the north right of way line of Birch Street to the west right of way line of Wood Lane; thence North 00 degree 11 minutes 20 seconds West along said right of way line 436.76 feet to the south right of way line of North Point Drive; thence North 88 degrees 33 minutes 40 seconds East along said south right of way line to the east line of Section 28, Township 24 North, Range 8 East; thence north along the east line of said Section 28 and the east line of Section 21 to its intersection with the northeasterly right of way line of U.S. Highway 51 (A/K/A Interstate 39); thence northwesterly along said northeasterly right of way line to its intersection with the north line of the Southeast Quarter of said Section 21; thence west along the north line of said Southeast Quarter to the southeast corner of the Northwest Quarter of said Section 21; thence north along the east line of said Northwest Quarter to its northeast corner thereof; thence west along the north line of said Northwest Quarter of Section 21 to the east right of way line of Reserve Street North; thence south along said east right of way line to a point 50.00 feet south of the north line of Lot 1 of Portage County Certified Survey Map Number 4209 as recorded in Volume 15 of 'Certified Surveys', page 4; thence North 88 degrees 29 minutes 28 seconds East 50.00 feet south of and parallel with said north line of Lot 1 a distance of 400.00 feet; thence South 00 degrees 00 minutes 45 seconds West 395.00 feet to its southeast corner thereof; thence South 88 degrees 29 minutes 28 seconds West along the south line of said Lot 1 and its extension to the west right of way line of Reserve Street North; thence south along said west right of way line to the north right of way line of DuBay Avenue; thence west along said north right of way line to a line 300 feet west of and parallel with the east line of the Northeast Quarter of the Northeast Quarter of Section 20; thence north along said line to the north line of the south one-half of said Northeast Quarter of the Northeast Quarter; thence west along said north line to the west line of the Northeast Quarter of the Northeast Quarter; thence south along said west line and the east line of the Southwest Quarter of the Northeast Quarter to the north line of the south one-half of said Southwest Quarter of the Northeast Quarter; thence west along said north line to the west line of said Southwest Quarter of the Northeast Quarter; thence north along the east line of the Southeast Quarter of the Northwest Quarter to the north right of way line of DuBay Avenue; thence North 87 degrees 24 minutes 51 seconds West along said north right of way line 119.68 feet to a point of curve; thence northwesterly along said right of way 558.06 feet along the arc of a 417.46 foot radius curve, said curve not tangent with the last described course, center to the north, the chord bears North 51 degrees 55 minutes 55 seconds West 517.43 feet; thence continuing North 12 degrees 36 minutes 01 seconds West along said right of way line, said line not tangent with the last described course, 471.94 feet to a point of curve; thence continuing northwesterly along said right of way line and the arc of a 239.05 foot curve, tangent with the last described course, center to the west, the chord bears North 26 degrees 53 minutes 48 seconds West 118.06 feet; thence North 41 degrees 11 minutes 55 seconds West along said right of way line 213.85 feet and tangent with the last described curve to the northeasterly right of way line of Second Street North; thence continuing North 26 degrees 29 minutes 49 seconds West along said northeasterly right of way line 230.65 feet to the north line of said Northeast Quarter of the Northwest Quarter; thence continuing North 26 degrees 58 minutes 07 seconds West along said northeasterly right of way line 85.70 feet; thence continuing northwesterly along said northeasterly right of way 477.90 feet along the arc of a 1,492.39 foot radius curve, not tangent with the last described course, center to the southwest, the chord bears North 34 degrees 58 minutes 16 seconds West 475.86 feet; thence continuing North 44 degrees 08 minutes 42 seconds West along said northeasterly right of way line 113.19 feet to the west line of the Southeast Quarter of the Southwest Quarter of Section 17; thence South 00 degrees 19 minutes 45 seconds East along said west line 158.88 feet to the southwesterly right of way line of said Second Street North and the most northerly corner of Lot 1 of Portage County Certified Survey Map Number 10525 as recorded in volume 47 of 'Certified Surveys', page 105; thence continuing South 00 degrees 19 minutes

45 seconds East along said west line of the Southeast Quarter of the Southwest Quarter of Section 17 and the west line of said Lot 1 a distance of 389.01 feet to the southwest corner thereof; thence North 89 degrees 57 minutes 03 seconds East along the south line of said Southeast Quarter of the Southwest Quarter of Section 17, and the south line of said Lot 1 a distance of 243.29 feet to the westerly right of way line of Second Street North (County Road X); thence South 18 degrees 38 minutes 32 seconds East along said westerly right of way line 165.38 feet; thence continuing South 04 degrees 17 minutes 40 seconds East along said westerly right of way line 347.56 feet; thence continuing southwesterly along the arc of a 1,322.39 foot radius curve, tangent with the last described course, center to the west, the chord bears South 05 degrees 26 minutes 25 seconds West 324.33 feet to the northeasterly right of way line of U.S. Highway 51 (A.K.A. Interstate 39); thence South 19 degrees 17 minutes 05 seconds West and not tangent with the last described curve 493.86 feet to a point on the south line of said Northeast Quarter of the Northwest Quarter 16 rods east of the center line of Johnson Drive (F/K/A Second Street North); thence west along said south line and the south line of the Northwest Quarter of the Northwest Quarter of said Section 20 to the west right of way line of Johnson Drive (F/K/A Second Street North); thence north along said west right of way line to the north right of way line of DuBay Avenue; thence west along said north right of way line of DuBay Avenue to a line parallel with and 290 feet east of the west line of Section 20; thence south along said parallel line to a line parallel with and 300 feet south of the north line of said Southwest Quarter of the Northwest Quarter of said Section 20; thence west along said parallel line to the west line of Section 20; thence south along said west line to the southwest corner of the Northwest Quarter of the Southwest Quarter of said Section 20; thence west along the north line of the Southeast Quarter of the Southeast Quarter and the Southwest Quarter of the Southeast Quarter of Section 19 to the east right of way line of Old Wausau Road; thence south along said east right of way line to the south line of the north one-half of said Southwest Quarter of the Southeast Quarter; thence east along said south line and the south line of the north one-half of said Southeast Quarter of the Southeast Quarter to the east line of said Southeast Quarter of the Southeast Quarter of Section 19; thence south along the east line of said Southeast Quarter of the Southeast Quarter to the southeast corner of said Section 19; thence South 88 degrees 06 minutes 41 seconds West along the south line of said Section 19 a distance of 700.24 feet to the east line of Lot 1 of Portage County Certified Survey Map Number 7820-29-100, Document Number 597948 and its southerly extension; thence North 00 degree 09 minutes 08 seconds East along said east line and its extension 332.90 feet to the northeast corner of said Lot 1; thence South 89 degrees 16 minutes 59 seconds West along the north line of said Lot 1 a distance of 220.10 feet to its northwest corner; thence South 00 degree 09 minutes 08 seconds West 337.40 feet along the west line of said Lot 1 and its southerly extension to the north line of the Northeast Quarter of the Northeast Quarter of Section 30; thence west along said north line of said Northeast Quarter of the Northeast Quarter of Section 30 to a point 1,020.36 feet west of the northeast corner of said Northeast Quarter of the Northeast Quarter said point being on the southerly extension of the east line of Lot 1 of Portage County Certified Survey Map Number 8205 as recorded in Volume 32 of 'Certified Surveys', page 35; thence North 00 degrees 01 minutes 15 seconds West along said east line and its extension 220.05 feet to the northeast corner of said Lot 1; thence South 89 degrees 06 minutes 44 seconds West along the north line of said Lot 1 a distance of 130.00 feet to its northwest corner; thence South 00 degree 01 minutes 15 seconds East 223.50 feet along the west line of said Lot 1 and its southerly extension to the north line of the Northeast Quarter of the Northeast Quarter of said Section 30; thence west along said north line of said Northeast Quarter of the Northeast Quarter to its west line thereof; thence south along said west line to a point 57.72 feet north of the northeast corner of the Southwest Quarter of the Northeast Quarter of said Section 30; thence South 45 degrees 00 minutes 00 seconds West a distance of 5.52 feet to a point of curvature; thence southwesterly 141.37 feet along the arc of a curve (center of curve to the north, radius = 180.00 feet, central angle = 45 degrees 00 minutes 00 seconds, long chord = 137.77 feet) to a point of tangency, said point being on the north line of the Southwest Quarter of the Northeast Quarter of said Section 30; thence west along the north line of the Southwest Quarter of the Northeast Quarter of said Section 30 to the centerline of Old Wausau Road; thence southeasterly along the centerline of Old Wausau Road to its intersection with a line parallel with and 148.0 feet south of the north line of the Southwest Quarter of the Northeast Quarter of said Section 30; thence west parallel with said north line to the west line of said Southwest Quarter of the Northeast Quarter; thence south along said west line 50 feet; thence west parallel with the north line of Government Lot 1 of Section 30 a distance of 148.50 feet; thence north parallel with the east line of Government Lot 1 a distance of 198.00 feet to the north line of said Government Lot 1; thence west along the north line of said Government Lot 1 to a point 506.88 feet west of the northeast corner of said Government Lot 1; thence south and parallel with the east line of said Government Lot 1 a distance of 282.80 feet; thence North 84 degrees 34 minutes 00 seconds East a distance of 229.80 feet; thence South 0 degree 00 minutes 00 seconds East a distance of 45.20 feet; thence North 84 degrees 34 minutes 00 seconds East a distance of 420.95 feet; thence North 5 degrees 26 minutes 00 seconds West a distance of 5.00 feet; thence North 84 degrees 34 minutes 00 seconds East a distance of 98.42 feet to the centerline of Old Wausau Road; thence southeasterly

along the centerline of the Old Wausau Road to its intersection with a line parallel with and 395 feet south of the north line of the Southwest Quarter of the Northeast Quarter of said Section 30; thence easterly along said parallel line to its intersection with the east line of said Southwest Quarter of the Northeast Quarter; thence south along said east line to the east-west quarter line of Section 30; thence westerly along said east-west quarter line to the center of Section 30; thence north 495 feet; thence East 445.5 feet along the north boundary line of the old Frank Gilinski property to the centerline of Old Wausau Road; thence North 23 degrees 45 minutes West along said centerline to a point 60 feet north of said north boundary line; thence West parallel with said north boundary line 926.38 feet; thence south 505 feet to the north line of the south 50 feet of Government Lot 1 in said Section 30; thence west along said north line to the west line of the east 528 feet of said Government Lot 1; thence south 50 feet to the south line of said Government Lot 1, also the east-west quarter line of said Section 30; thence west along said quarter line to the Range line between Ranges 7 and 8; thence southerly along said Range line to the point of beginning and there terminating.

EXCEPTING THEREFROM THE FOLLOWING PARCELS:

That part of Sections 33 and 34, Township 24 North, Range 8 East, Fourth Principal Meridian, **Village of Park Ridge**, County of Portage, State of Wisconsin described as follows:

Beginning at the east quarter corner of said Section 33; thence north along the east line of the Northeast Quarter of Section 33 to the south right of way line of U.S. Highway 10; thence west along the south right of way line of U. S. Highway 10 to its intersection with the westerly line of Outlot 2 extended southerly of Point Manors Subdivision in the City of Stevens Point; thence northerly along said westerly line 693 feet; thence east and parallel to U.S. Highway 10 to the east right of way line of Green Avenue; thence southerly along the east right of way line of Green Avenue to the south right of way line of U.S. Highway 10; thence easterly along the south right of way line of U.S. Highway 10 to a point 632.1 feet west of the east line of the Southeast Quarter of the Northwest Quarter of Section 34; thence south along the east line of property conveyed to Dorothy Mary Pieckert by deed recorded in Volume 52 of 'Deeds' on page 234 of Portage County Register of Deeds, a distance of 250 feet; thence west along the south line of said Dorothy Mary Pieckert property a distance of 157.9 feet to a point 496.7 feet east of the west line and 283 feet south of the north line of said Southeast Quarter of the Northwest Quarter of said Section 34 which point is located on the top of the ridge on the west side of the Big Plover River Basin; thence South 01 degree 18 minutes East a distance of 165.4 feet; thence South 12 degrees 08 minutes East along the top of said ridge 281 feet to a point on a line which would intersect the centerline of Algoma Street, (N/K/A Ferndale Drive) if extended, and 572.1 feet east from the west line of said Southeast Quarter of the Northwest Quarter; thence west along the centerline of Algoma Street, (N/K/A Ferndale Drive) if extended, a distance of 100 feet; thence south and parallel with the west line of the Southeast Quarter of the Northwest Quarter and the Northeast Quarter of the Southwest Quarter of Section 34 a distance of 1,315.5 feet to the centerline of Center Street, (N/K/A Maplewood Drive) if extended, which point is also the top of the west ridge of the Big Plover River basin, 472.1 feet east of the west line of said Northeast Quarter of the Southwest Quarter; thence southwest along the top of said ridge 570.3 feet to the north line of McCulloch Street, (N/K/A Hazelwood Drive) if extended, which point is 30 feet east of the west line of the Northeast Quarter of the Southwest Quarter of Section 34; thence south and parallel with the west line of said Northeast Quarter of the Southwest Quarter to the south line of the Northeast Quarter of the Southwest Quarter of Section 34; thence east on the south line of said Northeast Quarter of the Southwest Quarter 225 feet to the northeast corner of land conveyed to Hugo D. Marple and wife by deed recorded in Book 218 of 'Deeds', page 410 of Portage County Register of Deeds; thence south along the east line of said land 431 feet to the southeast corner thereof; thence west 225 feet to the west line of the Southeast Quarter of the Southwest Quarter of Section 34; thence westerly along the north line of lands owned by the Soo Line Railroad (N/K/A Canadian National Railway) as recorded in Volume 195 of 'Deeds', page 11, Portage County Register of Deeds to east line of the Southeast Quarter of said Section 33; thence north along said east line to the point of beginning and there terminating.

That part of the Northeast Quarter of the Southeast Quarter of Section 28, Township 24 North, Range 8 East, Fourth Principal Meridian, **Town of Hull**, County of Portage, State of Wisconsin described as follows:

Commencing at the east quarter corner of said Section 28; thence South 88 degrees 59 minutes 16 seconds West along the north line of said Northeast Quarter of the Southeast Quarter of Section 28 a distance of 815.21 feet to a point on the south right of way line of East Maria Drive, the west boundary line of Parcel 1 of lands conveyed to John J. Mallick as recorded in document number 721049, Portage County Register of Deeds, and the Point of Beginning; thence South 00 degrees 17 minutes 57 seconds West along said west boundary line 124.97 feet to the north boundary line of Parcel 2 of lands conveyed to John J. Mallick as recorded in said document number 721049, thence South 89 degrees 15 minutes 09 seconds West along said north boundary line 37.01 feet to the west boundary line thereof; thence South 00 degrees 17 minutes 57 seconds West along said west boundary line 114.96 feet to the north right of way line of Harmony Lane; thence east along said north right of way line to the northerly extension of the east line of lands conveyed to Ellis Stone and Construction Company as described in Volume 213 of 'Deeds', page 291, Portage County Register of Deeds; thence south along said northerly extension and east line of lands conveyed to Ellis Stone and Construction Company to the north right of way line of Regent Street; thence west along said north right of way line and its westerly extension to a point on the west line of said Northeast Quarter of the Southeast Quarter, said point being 666 feet north of the southwest corner thereof; thence north along the west line of said Northeast Quarter of the Southeast Quarter to the southwesterly extension of the southeasterly right of way line of Stanley Street; thence northeasterly along said southwesterly extension and the southeasterly right of way line of Stanley Street to the south right of way line of said East Maria Drive; thence North 88 degrees 59 minutes 16 seconds East along said south right of way line to the point of beginning and there terminating.

Said Corporate Boundary description contains approximately 18.5737 square miles.

THIS INSTRUMENT DRAFTED BY:
Patrick J. Fuehrer. PLS-2973
City Surveyor
City of Stevens Point

CITY OF STEVENS POINT WISCONSIN

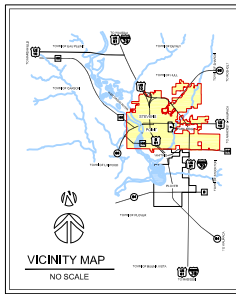

PREPARED BY
CITY OF STEVENS POINT
ENGINEERING DEPARTMENT
UPDATED:
12/1/2022



LOT #	LOT NAME
1	...
2	...
3	...
4	...
5	...
6	...
7	...
8	...
9	...
10	...
11	...
12	...
13	...

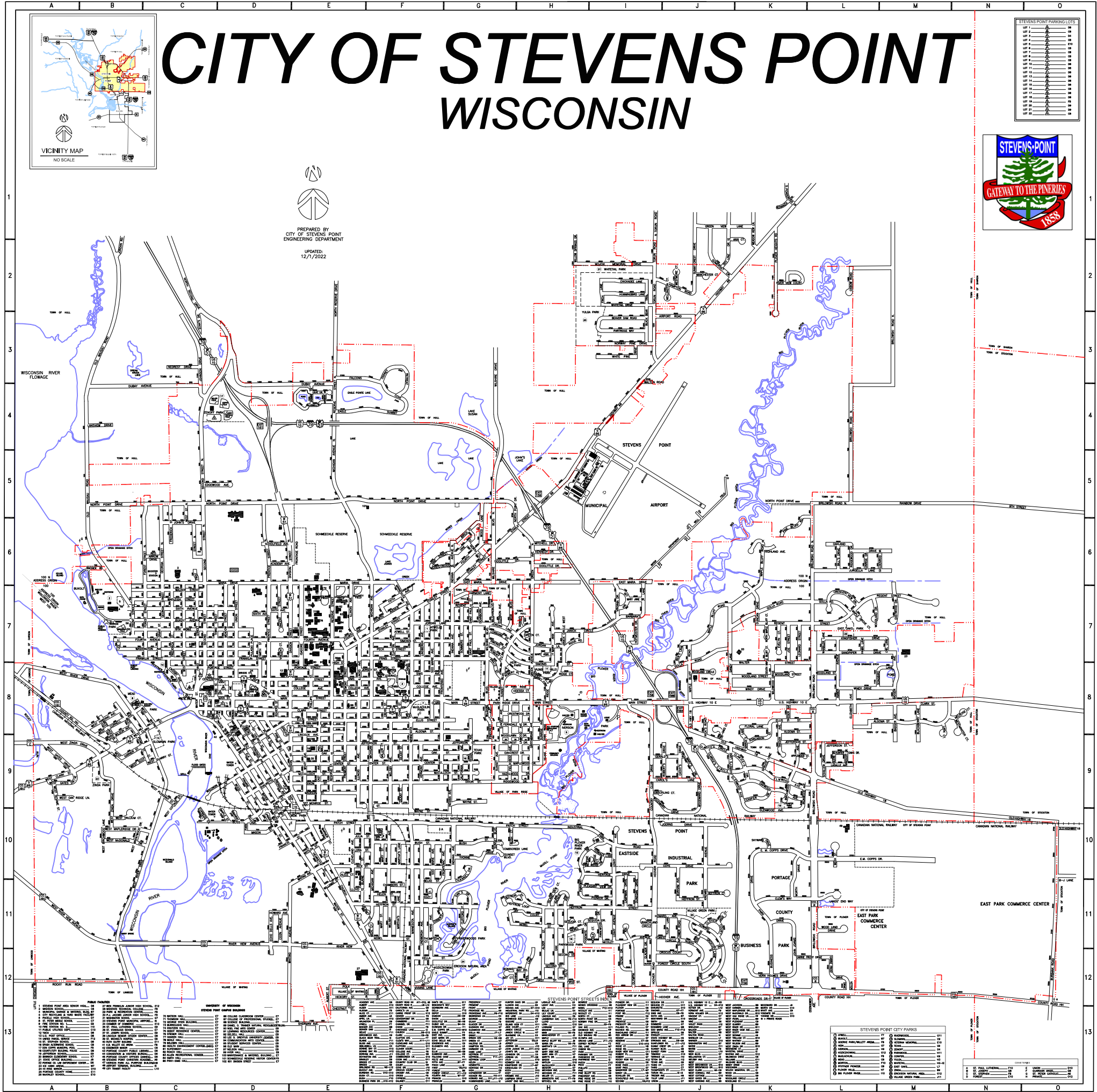

1	...
2	...
3	...
4	...
5	...
6	...
7	...
8	...
9	...
10	...
11	...
12	...
13	...

1	...
2	...
3	...
4	...
5	...
6	...
7	...
8	...
9	...
10	...
11	...
12	...
13	...

1	...
2	...
3	...
4	...
5	...
6	...
7	...
8	...
9	...
10	...
11	...
12	...
13	...

1	...
2	...
3	...
4	...
5	...
6	...
7	...
8	...
9	...
10	...
11	...
12	...
13	...

1" = 100'
1" = 200'
1" = 300'
1" = 400'
1" = 500'