



CITY OF EAU CLAIRE

COMMUNITY DEVELOPMENT

Economic Development: (715) 839-4914
Inspections: (715) 839-4947
Planning: (715) 839-4914
Fax: (715) 839-4939

July 7, 2017

Wisconsin Department of Administration
Municipal Boundary Review
PO Box 1645
Madison, WI 53701-1645

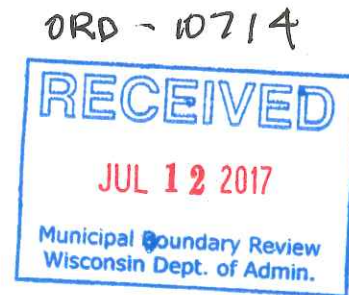

RE: MBR #14019

I have enclosed the Certificate of Annexation and plat attached thereto, of territory annexed to the City of Eau Claire, from the Town of Washington, pursuant to Section 66.0217, Wisconsin Statutes.

Sincerely,

Donna A. Austad
City Clerk

aks

Enclosures

CERTIFICATE OF ANNEXATION

STATE OF WISCONSIN)
COUNTY OF CHIPPEWA)
COUNTY OF EAU CLAIRE)

I, Donna Austad, City Clerk of the City of Eau Claire, Counties of Chippewa and Eau Claire, Wisconsin, DO HEREBY CERTIFY that the following described territory was detached from the Town of Washington, Eau Claire County, by an ordinance passed by the Common Council of the City of Eau Claire, at a regular meeting held on the 27th day of June, 2017.



Donna A. Austad, City Clerk

Dated,
July 5, 2017

The population is zero (0).

STATE OF WISCONSIN)

COUNTY OF CHIPPEWA)

COUNTY OF EAU CLAIRE)

I, Donna Austad, City Clerk of the City of Eau Claire, Counties of Chippewa and Eau Claire, State of Wisconsin, do hereby certify that the attached is a true and correct copy of a certain ordinance passed by the City Council of the City of Eau Claire at a regular session thereof held on the 27th day of June, 2017.

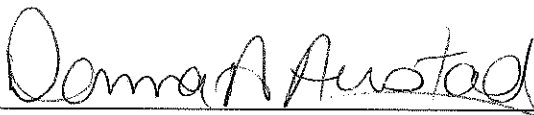

Donna A. Austad, City Clerk

Dated,
July 5, 2017

ORDINANCE NO. 7232

ORDINANCE ANNEXING TERRITORY TO THE CITY OF EAU CLAIRE

THE CITY COUNCIL OF THE CITY OF EAU CLAIRE DO ORDAIN AS FOLLOWS:

Section 1. Territory Annexed. In accordance with Section 66.0217 of the Wisconsin Statutes, the following described territory in the Town of Washington, Eau Claire County, Wisconsin, is annexed to the City of Eau Claire, Wisconsin.

ECE, LLC MEGA CO-OP ANNEXATION (MBR #14019)
Town of Washington

Part of Parcel F of Certified Survey Map Number 42, recorded in Volume 1 of Certified Survey Maps, Pages 41 through 48, and also part of State Highway 93 right of way, part of Old Town Hall Road right of way and part of Interstate Highway 94 right of way, all being in part of the Northeast Quarter of the Southwest Quarter, the Southeast Quarter of the Northwest Quarter, the Southwest Quarter of the Northeast Quarter, the Southeast Quarter of the Northeast Quarter and the Northwest Quarter of the Southeast Quarter, Section 3, Township 26 North, Range 9 West, Town of Washington, Eau Claire County Wisconsin being further described as follows:

*Beginning at the East Quarter corner of said Section 3;
Thence N03°11'14"E along the east line of said Southeast Quarter of the Northeast Quarter, 136.79 feet to the southeast corner of Lot 1 of Certified Survey Map No. 1679, recorded in Volume 9 of CSM's, Pages 107-108;
Thence N76°29'30"W, 79.48 feet along the southwesterly line of said Lot 1, also being the northeasterly right of way of said Old Town Hall Road;
Thence N54°02'45"W, 288.09 feet continuing along said northeasterly right of way and said southwesterly line of Lot 1;
Thence N46°33'17"W continuing along said northeasterly right of way and along said southwesterly line of Lot 1, a distance of 481.68 feet to the westerly corner of said Lot 1;
Thence N01°38'22"E, 113.92 feet to the intersection with the Reference Line of Interstate Highway 94;
Thence N88°21'38"W along said Reference Line, 642.22 feet to the east line of said Southwest Quarter of the Northeast Quarter;
Thence S03°03'07"W along said east line, 91.38 feet;
Thence N89°32'23"W, 338.60 feet;
thence westerly, 561.26 feet along a tangent curve to the left, having a radius of 1298.13 feet, the chord of said curve bears S78°04'27"W, 556.90 feet;
Thence S65°41'16"W, 594.58 feet;
Thence S02°45'45"E, 150.47 feet;
thence southerly, 543.30 feet along a tangent curve to the left, having a radius of 2799.79 feet, the chord of said curve bears S08°19'18"E, 542.44 feet;
Thence S13°52'51"E, 259.93 feet to the intersection with the westerly extension of the south line of said Parcel F of Certified Survey Map Number 42;
Thence S88°20'40"E along said westerly extension and along said south line of Lot F, 1205.97 feet to a southeast corner of said Lot F;
Thence N03°07'01"E along an east line of said Lot F, 668.43 feet to a corner of said Lot F and said corner also being the northwest corner of Lot 8 of Brynwood to the Town of Washington Subdivision;
Thence S88°35'51"E along a south line of said Lot F, 1253.92 feet to the southeast corner thereof;*

Thence continuing S88°35'51"E, 78.03 feet to the Point of Beginning;

Said parcel contains 54.15 acres, more or less.

Section 2. Effect of Annexation. From and after the date of this ordinance, the territory described in Section 1 shall be part of the City of Eau Claire for any and all purposes provided by law and all persons coming or residing within such territory shall be subject to all ordinances, rules and regulations governing the City of Eau Claire.

Section 3. Temporary Zoning Classification. The territory annexed to the City of Eau Claire by this ordinance is temporarily designated to be R-1A -- Non-Sewered One-Family Dwelling District for zoning purposes and subject to all provisions of the zoning ordinance of the City of Eau Claire relating to such district classification and to zoning in the city.

Section 4. Ward Designation. The territory described in Section 1 of this ordinance is hereby made a part of the 15th Assessment Ward and the 2nd Aldermanic District of the City of Eau Claire, subject to all ordinances, rules and regulations of the city governing wards and districts.

Section 5. Severability. If any provision of this ordinance is invalid or unconstitutional, or if the application of this ordinance to any person or circumstance is invalid or unconstitutional, such invalidity or unconstitutionality shall not affect the other provisions or application of this ordinance which can be given effect without the invalid or unconstitutional provisions or applications.

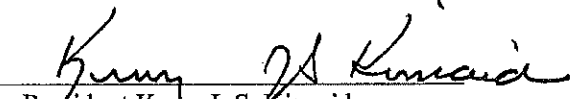
(SEAL) 
President Kerry J. S. Kincaid

(SEAL) 
City Manager Dale Peters

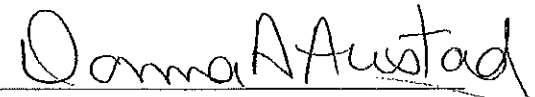
(ATTESTED) 
City Clerk Donna A. Austad

First Reading	June 13, 2017
Final Reading	June 27, 2017
Adopted	June 27, 2017
Published	July 2, 2017

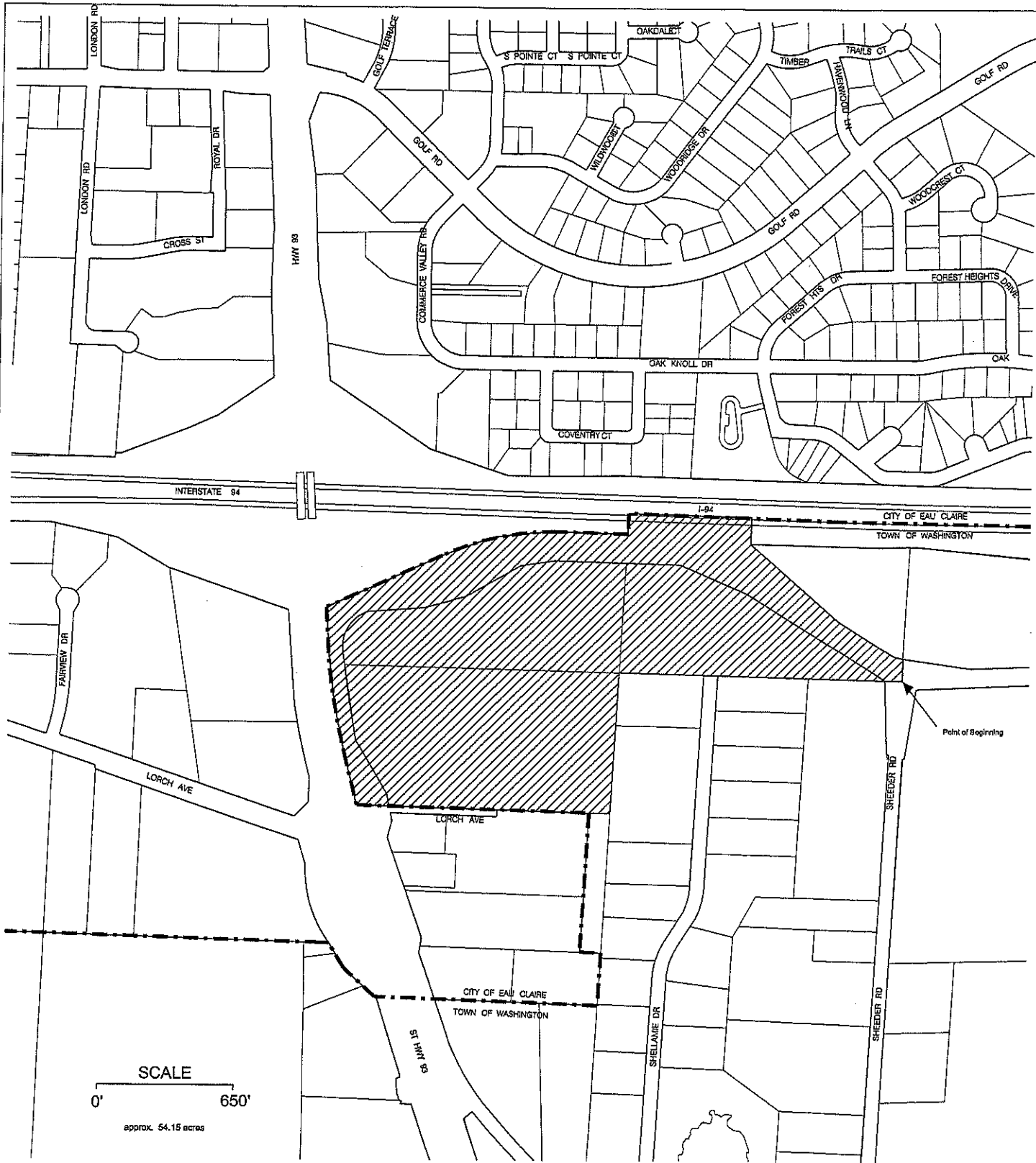

DEPARTMENT OF COMMUNITY DEVELOPMENT
CITY OF EAU CLAIRE, WI

DATE
MAY 10, 2017

ANNEXATION FILE #
2017-2A

LOCATION

THESE LANDS LOCATED IN
SECTION 03-26-09,
TOWN OF WASHINGTON,
EAU CLAIRE COUNTY



SCALE
1" = 650'