

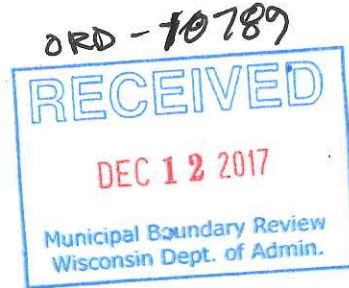

Administration
Village of Little Chute
108 West Main Street
Little Chute, WI 54140
(920) 423-3852



December 7, 2017

Municipal Boundary Review
PO Box 1645
Madison, WI 53701

RE: ANNEXATION –KENNETH TESSEN ANNEXATION
MBR # 14066

Pursuant to State Statutes 66.0217 (9)(a), enclosed is a certified signed copy of an Annexation Ordinance with the attached Certification and Exhibit. Ordinance No. 9, Series of 2017 was adopted December 6, 2017.

Sincerely,

Laurie Decker
Clerk

KENNETH TESSEN ANNEXATION

PETITION FOR DIRECT ANNEXATION BY UNANIMOUS APPROVAL PURSUANT TO SECTION 66.0217(2) WISCONSIN STATUTES WHERE ELECTORS RESIDE IN THE TERRITORY

We, the undersigned, constituting all of the residents and owners of real property in the following territory of the Town of Vandenbroek, Outagamie County, Wisconsin, lying contiguous to the Village of Little Chute, petition the Village Board of the Village of Little Chute to annex the territory described below and shown on the attached scale map to the Village of Little Chute, Outagamie County, Wisconsin:

Described as: Commencing at the Northeast corner of the Northwest Northeast quarter Section 16 T21N R18E, West 120 feet to the Point of Beginning, Thence South 181.5 feet to the Village limit, Thence West 240 feet, Thence North 181.5 feet to the North line of Section 16, Thence East along the Section line 240 feet to the Point of Beginning, Described area being part NW NE Sec16 T21N R18E, Described area containing 1.0 Acres M/L

The current population of such territory is one.

We, the undersigned, elect that this annexation shall take effect to the full extent consistent with outstanding priorities of other annexation, incorporation or consolidation proceedings, if any.

*Check each that applies.

Signature of Petitioners Date of Signing Owner* Elector* Address or Description of Property

Kenneth Tessen 11/13/17 X W2621 Evergreen Drive

MAP ON REVERSE SIDE OF PETITION



Annexation

W2621 W Evergreen Dr
Parcel 200031000

November 2017

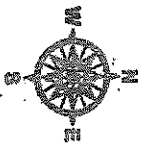

1 inch = 300 feet
0 50 100 200 300 Feet

- Annexation
- Parcel
- Municipal Boundary
- PLSS Section Boundary

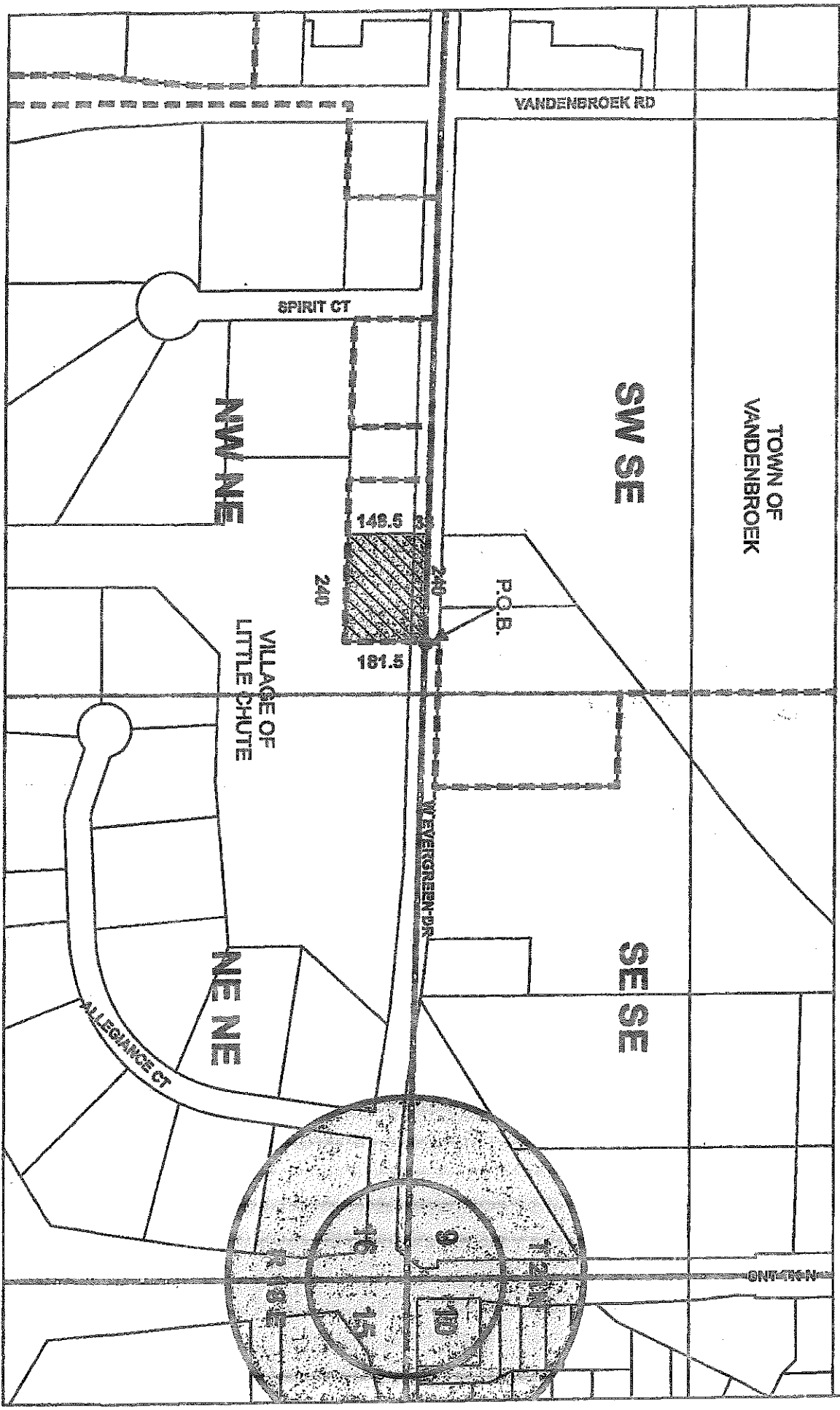

CERTIFICATE OF AUTHENTICITY

STATE OF WISCONSIN)
) ss.
COUNTY OF OUTAGAMIE)

The undersigned, being first duly sworn on oath certifies that he is the Village Clerk of the Village of Little Chute; that the foregoing ordinance was adopted by said Village on the date aforementioned; that the foregoing is a true and correct copy, in all aspects of said Ordinance, that said Ordinance remains in full force and effect.

Laurie Decker, Clerk

Subscribed and sworn to before me
This 7th day of December 2017

Molly Derricks
Notary Public, Outagamie County
State of Wisconsin
My Commission expires: 1-28-2018

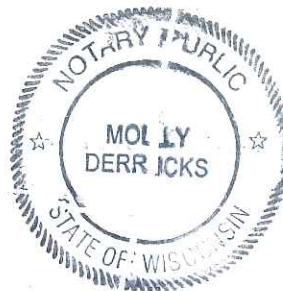

VILLAGE OF LITTLE CHUTE

KENNETH TESSEN ANNEXATION ORDINANCE

ORDINANCE NO. 9, SERIES OF 2017

AN ANNEXATION ORDINANCE ADOPTED BY THE VILLAGE BOARD OF TRUSTEES OF THE VILLAGE OF LITTLE CHUTE PURSUANT TO SECTION 66.0217 OF THE WISCONSIN STATUTES, ANNEXING TERRITORY FROM THE TOWN OF VANDENBROEK.

WHEREAS, a Petition for Direct Annexation (Outagamie County) has been presented to the Village of Little Chute under statutory authority 66.0217(2), Wisconsin Statutes as amended; and,

WHEREAS, the petition was signed by all owners and electors of the property within the proposed area for annexation; and,

WHEREAS, said Petition for Annexation and Notice contains a legal description of the territory proposed to be annexed sufficiently accurate to determine its location, designates the area to be annexed to the Village of Little Chute and designates the area as being proposed to be detached from the Town of Vandebroek as located in Outagamie County; and,

WHEREAS, the Village of Little Chute Board of Trustees has determined that the proposed annexation is in the best interests of the Village of Little Chute and the owners of real estate in the proposed annexation area; and,

WHEREAS, the Village of Little Chute Plan Commission has reviewed and recommended in favor of the proposed annexation; and,

WHEREAS, the Wisconsin Department of Administration has reviewed annexation petition #14066 and found it to be in the public interest; and,

WHEREAS, the Village Board has reviewed advice received from the Wisconsin Department of Administration; and,

WHEREAS, an Annexation Ordinance of the proposed territory by the Village of Little Chute requires a two-thirds vote of the governing body (Board of Trustees) of the Village of Little Chute;

NOW THEREFORE BE IT ORDAINED by the Village Board of Trustees of the Village of Little Chute as located in Outagamie County, State of Wisconsin as follows:

1. That the real estate described as: Commencing at the Northeast corner of Section 16 T21N R18E , Thence West to the Northeast corner of the Northwest Northeast quarter Section 16 T21N R18E, Thence West 120 feet to the Point of Beginning, Thence South 181.5 feet to the Village limit, Thence West 240 feet, Thence North 181.5 feet to the North line of Section 16, Thence East along the Section line 240 feet to the Point of Beginning, Described area being part NW NE Sec16 T21N R18E, Described area containing 1.0 Acres M/L, which is the same real estate as set forth in the Annexation Petition, be hereby annexed to the Village of Little Chute as located in Outagamie County, State of Wisconsin.

2. The territory is annexed to the Village for zoning purposes as follows: Parcel #200031000 is zoned RC Residential Conventional Single Family District,

3. The territory is annexed to the Village for voting purposes is designated and attached to WARD 13,

4. That a scale map of the area, showing the boundaries of annexation territory and its relationship to the boundaries of the Village of Little Chute, is hereby adopted by reference.

5. The current population of the territory being annexed is one (1) person, determined in accordance with the definition under Section 66.0217(3), Wisconsin Statutes.

6. This Annexation Ordinance shall be effective upon its enactment by a two-thirds vote of the Village Board of Trustees of the Village of Little Chute.

7. The Village Clerk of the Village of Little Chute shall file with the Wisconsin Secretary of State a certified copy of this Annexation Ordinance and with each company providing utility services in the area annexed. One original copy of this Annexation Ordinance shall be provided to the Outagamie County Register of Deeds for recording/filing purposes, and one certified copy shall be filed with the Clerk of each affected school district and township.

8. The Finance Director of the Village shall pay to the Town Clerk the amount of \$834.45 which represents total reimbursement of town portion of the property tax of the area annexed over a five year period.

Date introduced: December 6, 2017

Approved and adopted: December 6, 2017

VILLAGE OF LITTLE CHUTE

By:

Michael P. Vander Berg
Michael Vander Berg, Village President

Attest:

Laurie Decker
Laurie Decker, Village Clerk

NUMBER VOTED FOR:

6

NUMBER VOTED AGAINST:

0

State of Wisconsin)

) ss

Outagamie County)

Personally appeared before me on the 6 day of Dec, 2017, the above named officers, to me known to be the persons who executed the foregoing instrument and acknowledge the same.

Molly Derrick

Notary Public, State of Wisconsin

My Commission expires:

1-28-2018

