

ORD11379

RECEIVED

09/30/2021

Municipal Boundary Review
WI Dept. of Administration

419586¹

RECORDS

VOL

149 PAGE 342

ORDINANCE NO. A 61

ORDINANCE OF DIRECT ANNEXATION BY UNANIMOUS APPROVAL

THE VILLAGE BOARD OF THE VILLAGE OF CASHTON, MONROE COUNTY, WISCONSIN, DO
ORDAIN AS FOLLOWS:

Section 1. Pursuant to Section 66.021(12), Wis. Stats., a petition for direct annexation signed by all of the electors residing in and the owners of all real property in the territory described below has been filed with the Village Clerk and with the Town Clerk of the town of Portland in which such territory is located, together with a scale map and description of the property to be annexed showing boundaries of such territory and the relationship of the territory to the municipalities, and a copy of such petition, map and description of the territory was mailed to the Department of Development within five days after filing, the advice of the department having been reviewed by the Village Board.

Section 2. The following described territory located in Monroe County, Wisconsin is hereby annexed to the Village of Cashton, Monroe County, Wisconsin, to-wit:

Said property is described on Exhibit A which by references is incorporated herein.

Section 3. The territory annexed by this ordinance shall be temporarily designated as industrial for zoning purposes under the Village of Cashton zoning code.

Section 4. The Village Clerk shall file immediately with the Secretary of State a certified copy of this ordinance, and a copy with the Register of Deeds, signed by the City Clerk, describing the territory which was annexed, all pursuant to Section 66.021(8), Wis. Stats.

Section 5. This ordinance shall be in full force and effect following its enactment by a two-thirds vote of the elected members of the governing body of the Village of Cashton.

Dated this 2nd day of September, 1992.

REGISTER'S OFFICE
County of Monroe, Wis.
Received for record this 15
day of Sept A.D., 19 92
at 3:00 o'clock P M.
Wally D. Nutter Registers
1800
Ed Rice & Abbott
file

OFFERED BY:

Steven Trescher
Supervisor

PASSED this 2nd day of September, 1992.

Lucy Schmitz
Village Clerk

APPROVED this 2nd day of Sept., 1992.

Richard L. Weschke
Village President

INDEXED

AUGUST 21, 1992

VILLAGE OF CASHTON
ANNEXATION

A parcel of land located in the Northeast One-Quarter of the Northeast One-Quarter (NE $\frac{1}{4}$ -NE $\frac{1}{4}$) and the Northwest One-Quarter of the Northeast One-Quarter (NW $\frac{1}{4}$ -NE $\frac{1}{4}$) of Section Thirty Six (36) Township Fifteen North (T 15 N) Range Four West (R 4 W) Town of Portland, Monroe County, Wisconsin described as follows:

Beginning at the Northeast corner of said Section Thirty Six (36) , thence North 89° 40' 23" West along the North line of said Section Thirty Six (36) 1,237.50 feet to the Easterly Right-of-Way of the former C.M.ST. P.& P. Railroad; thence Southwesterly along said Right-of-Way 587.00 feet more or less to the Northerly Right-of-Way of Eureka Avenue; thence Northwesterly along the Northerly Right-of-Way of Eureka Avenue to the Easterly Right-of-Way of S.T.H. " 27 " ; thence Westerly to a point on the Westerly Right-of-Way of S.T.H. " 27 " at the Southwest corner of that land described in Volume 84 of Misc, Page 116; thence Northerly along the West Line of that land described in Volume 84 of Misc. Page 116 to the North line of said Section Thirty Six (36); thence North 89° 40' 23" West along said North line 802.90 feet to the North One-Quarter corner of said Section Thirty Six (36); thence South 0° 19' 13" West along the East line of the Northwest One-Quarter of the Northeast One-Quarter (NW $\frac{1}{4}$ -NE $\frac{1}{4}$) of said Section Thirty Six (36) 1,124.90 feet; thence East 422.51 feet to the Westerly Right-of-Way of S.T.H. " 27 " ; thence North 40° 07' 34" East along said Right-of-Way 292.42 feet; thence North 55° 26' West 157.00 feet; thence North 34° 34' East 177.00 feet; thence South 55° 26' East 157.00 feet to the Westerly Right-of-Way of S.T.H. " 27 " ; thence North Easterly along said Right-of-Way to the center line of Eureka Avenue extended West; thence Easterly along said center line to the East line of said Section Thirty Six (36); thence North along said East line to the point of beginning.

Parcel contains Forty Seven (47) acres more or less.

E.T.C. INC
La Crosse, Wisconsin

Exhibit A

RECORDS
VOL

149 PAGE 344

CERTIFICATE

The undersigned Village Clerk of the Village of Cashton, Monroe County, Wisconsin hereby certifies that the Village Board did adopt the attached Annexation Ordinance and the the attached is a true copy of the Ordinance, the original which is on file with the Village Clerk for the Village of Cashton, Monroe County, Wisconsin.

WITNESS OF MY HAND AND SEAL OF THE VILLAGE OF CASHTON THIS 2nd DAY OF September, 1992.

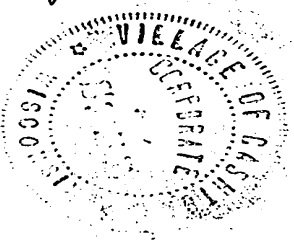

Lucy Schmitz
Lucy Schmitz, Village Clerk
Village of Cashton, Monroe County,
Wisconsin.

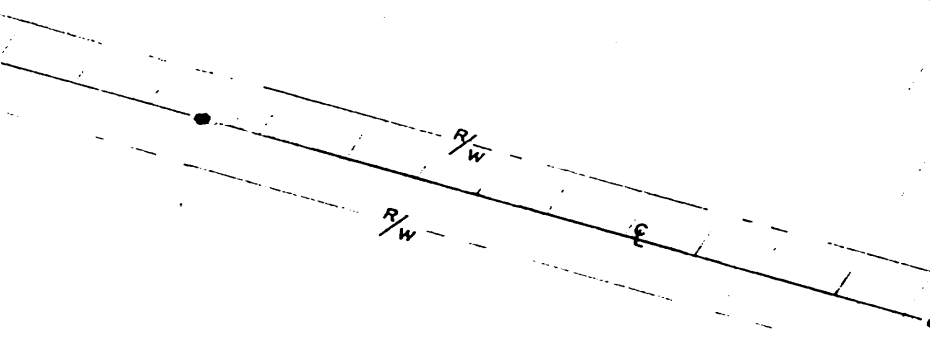

PROPOSED ANNEXATION
INDUSTRIAL PARK
VILLAGE OF CASHTON
MONROE COUNTY WISCONSIN

PART OF THE N 1/2 - NE 1/4, SEC. 36, T. 15N., R. 4W.

DRAWN BY	E. T. C., INC. MUNICIPAL & INDUSTRIAL ENGINEERS LA CROSSE — WISCONSIN	SCALE 1" = 100'
CHECKED BY		REVISED
APPROVED BY		SHEET NO. / OF /
DATE 8-20-92 JOB NO. E-202		



Connelly

RECORDS
 419586 VOL 149 PAGE 345

MONUMENT FOUND
NORTH 1/4 CORNER
SEC. 36, T 15N, R 4W.

N 89° 40' 23" W 80

CAVADINI
VOL. 84 MISC., PG. 116

802.90

FORMER C.M. ST. P. & P. RAILROAD

587' ±

R/W

N 89° 40' 23" W

N 89° 40' 23" W 1,237.50'

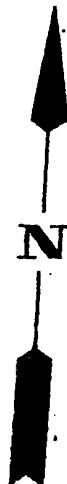

SCALE 1" = 100'

MONUMENT FOUND
N.E. COR. SEC. 36, T. 5 N., R. 4 W.



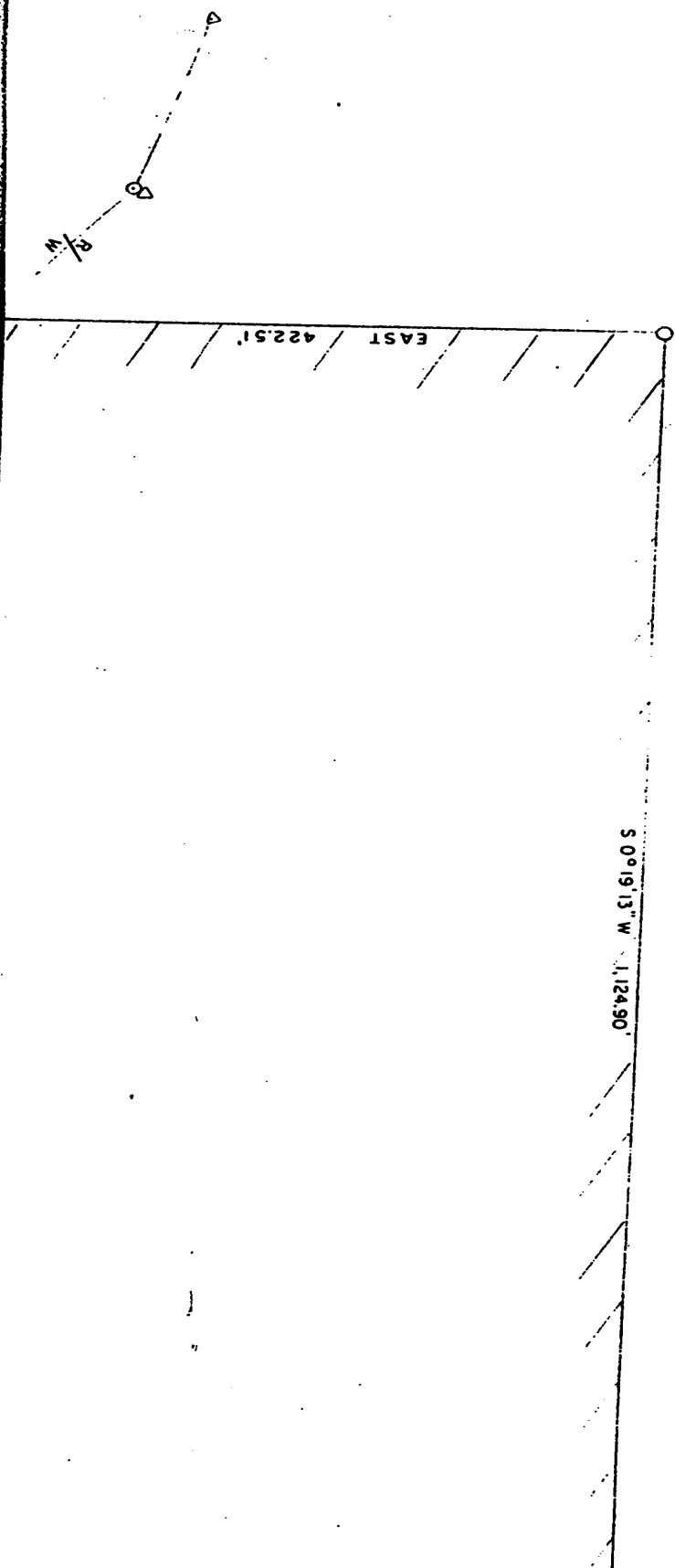

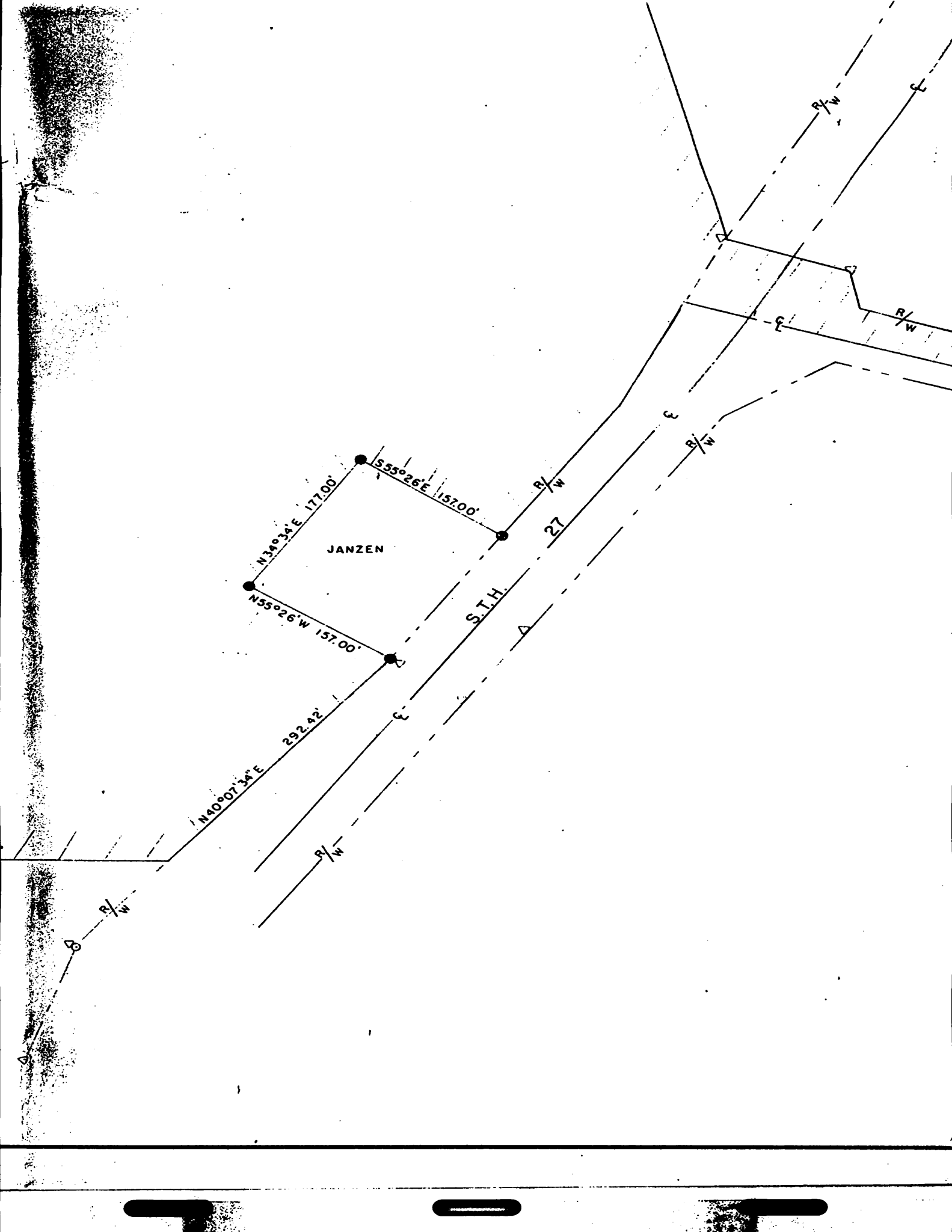

AVE.

EUREKA

R/W

R/W

FORMER C.M. & ST. P. & R. RAILROAD

587' ±

AVE

R/W

R/W



Chapman

PROPOSED
INDUSTRIAL
VILLAGE OF
MONROE COUN

PART OF THE N 1/2-NE

DRAWN BY
CHECKED BY
APPROVED BY

E. T. C MUNICIPAL & ENGIN LA CROSSE
DATE 8-20-9
JOB NO. E-202