



CITY OF MANITOWOC

WISCONSIN, USA

www.manitowoc.org

ORD11431

December 13, 2021

Wisconsin Department of Administration
Municipal Boundary Review
PO Box 1645
Madison, WI 53701-1645

RECEIVED
December 17, 2021
Municipal Boundary Review
Wisconsin Dept. of Admin.

To Whom It May Concern:

RE: South 15th St. #2 Annexation Map
Petition File No. 14454

Gentlemen:

On November 15, 2021, the Common Council of the City of Manitowoc adopted an annexation ordinance as follows:

Ordinance to annex territory from the Town of Manitowoc to the City of Manitowoc as part of the 7th Aldermanic District and the 37th Ward of the City.

In accordance with Section 66.0217(9)(a) of the Wisconsin Statutes, I am enclosing a certified copy of the ordinance, certificate and plat.

This ordinance was published in the Herald-Times-Reporter on Monday, November 22, 2021, and will be in full force and effect the day after publication.

In compliance with the Wisconsin Statutes, this is to certify that the total population of the above annexed area is two (2).

Very truly yours,

Mackenzie Reed-Kadow
City Clerk

MRK:ab

Enclosures

cc: ANR Pipeline Company
Wisconsin Public Service Corporation
Nathan M. Prodell, A T & T Wisconsin
Manitowoc Public Utilities

CERTIFICATE OF ANNEXATION

I, Mackenzie Reed-Kadow, City Clerk of the City of Manitowoc, County of Manitowoc, State of Wisconsin, DO HEREBY CERTIFY that the following described territory was detached from the Town of Manitowoc, County of Manitowoc, and was annexed to the City of Manitowoc, and to the 7th Aldermanic District and the 37th Ward of said City, pursuant to Section 66.0217 of the Wisconsin Statutes, by an ordinance adopted by the Common Council at a regular meeting held on Monday, November 15, 2021:

DESCRIPTION

A tract of land located in Lots 12 and 15 of the Subdivision of the East ½ of Section 6 T.18N, R.24E., Town of Manitowoc, Manitowoc County, Wisconsin described as follows:

Commencing at the North ¼ corner of said Section 6, thence S89°51'20"E along the section line 659.58 feet to the centerline of So. 15th Street, thence S00°11'20"W (recorded as South) along said centerline 588.60 feet to the point of real beginning, thence continue S00°11'20"W (recorded as South) along said centerline 136.00 feet, thence S89°51'20"E 662.69 feet (recorded as S89°59'57"E, 662.71 feet), thence N00°05'22"E 66.00 feet, thence N89°51'20"W 496.08 feet, thence N00°11'20"E 70.00 feet, thence N89°51'20"W 166.50 feet to the point of real beginning.

Said tract contains 1.27 acres (55,388 square feet).
(County parcel #009-510-006-012.04, 009-510-006-015.02)

Effective November 23, 2021.

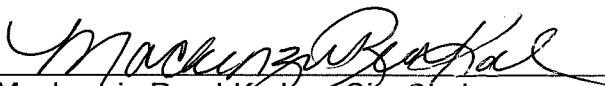

Mackenzie Reed-Kadow, City Clerk



Aldermanic District #7

Ward 37

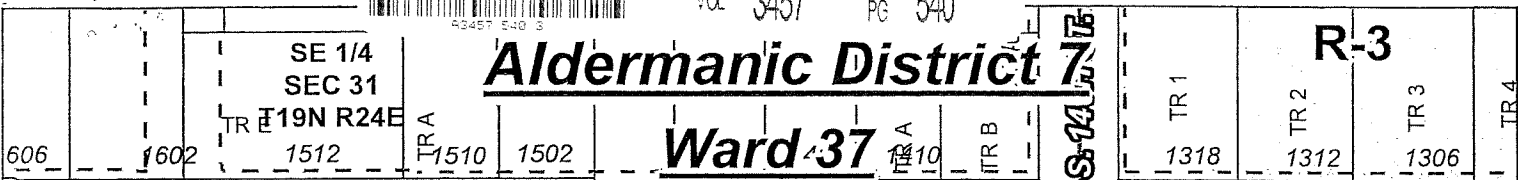
R-3



Section Line

VIEBAHN ST

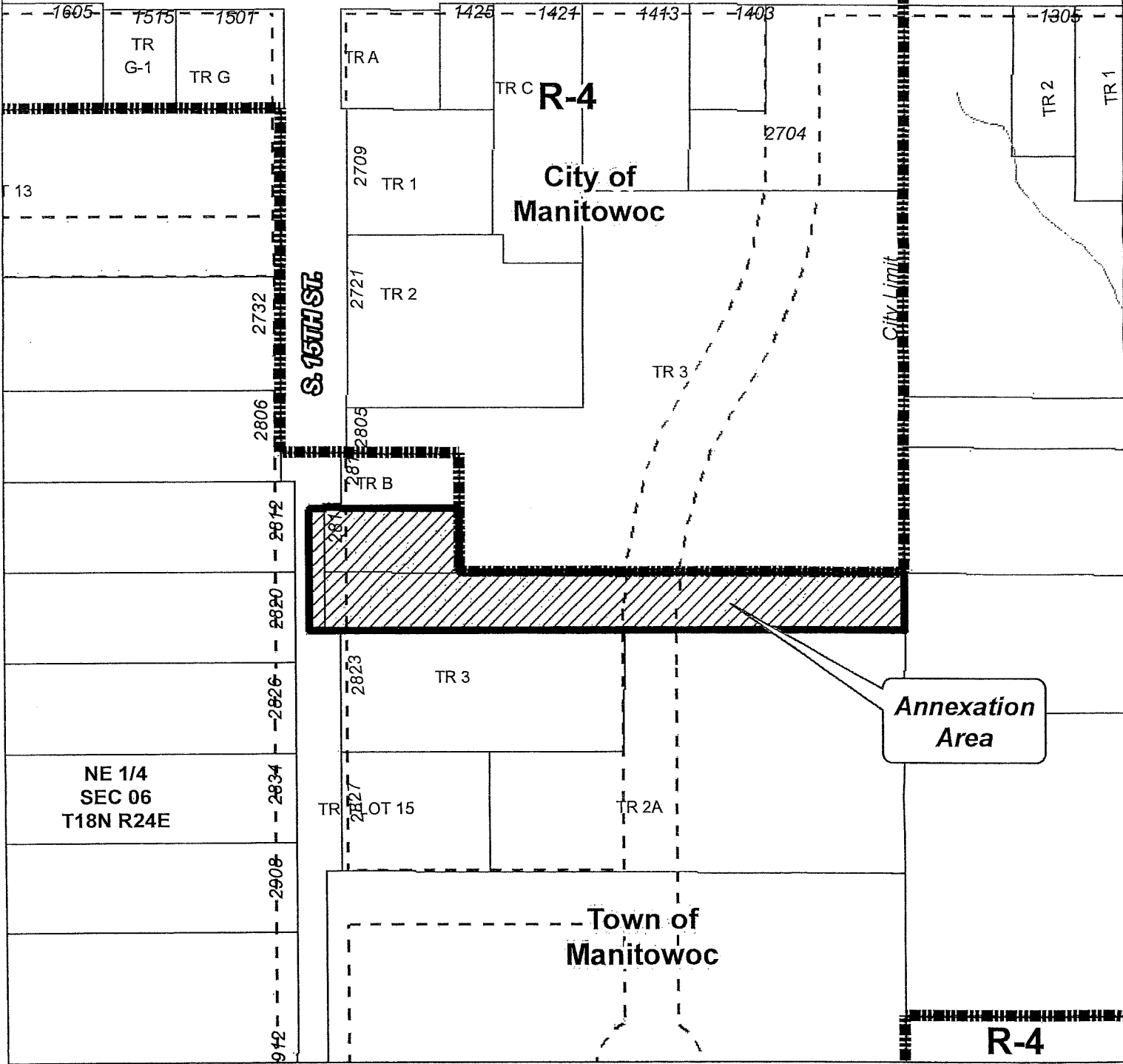

Annexation Area

S. 15th St. #2

City of Manitowoc, WI

Aldermanic District #7

Ward 37

Population: 2

PC 40-2021
2815 S. 15th St.

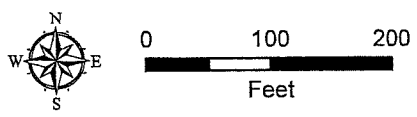

Legend

- Annexation Area
- Official Map Street
- Corporate Limits

DISCLAIMER: Maps and associated data are believed to be accurate, but are not warranted. This information is not intended for legal, survey, or other related uses. Please obtain the original recorded documents for legal or survey information.

CERTIFICATE

STATE OF WISCONSIN:

: ss

CITY OF MANITOWOC :

I, Mackenzie Reed-Kadow, City Clerk of and for the City of Manitowoc of the State of Wisconsin, do hereby certify that I have compared the attached ordinance with the original of said ordinance on file in my office, and that the said copy is a true and correct copy of such original ordinance duly and regularly adopted, by the Common Council of the City of Manitowoc, Wisconsin, at a meeting held on Monday, November 15, 2021.

WITNESS MY HAND, and seal this 13th day of December, 2021.

Mackenzie Reed-Kadow, City Clerk



Ordinance to annex territory (South 15th St. #2) from Town of Manitowoc as part of the 7th Aldermanic District and the 37th Ward of the City

STATE OF WI - MTWC CO
KRISTI TUESBURG REG/DEEDS
RECEIVED FOR RECORD
11/30/2021 10:55:01 AM

Recording Area

5cha

Name and Return Address

Manitowoc City Clerk
900 Quay Street
Manitowoc, WI 54220

This information must be completed by submitter: document title, name & return address, and PIN (if required). Other information such as the granting clauses, legal description, etc. may be placed on this page of the document or may be placed on additional pages of the document. NOTE: Use of this cover page adds one page to your document and \$2.00 to the recording fee. Wisconsin Statutes, 59.43(2m)



ORDINANCE

An Ordinance to annex certain territory from the Town of Manitowoc to the City of Manitowoc as part of the 7th Aldermanic District and the 37th Ward of the City.

WHEREAS, a petition to annex the territory (S. 15th Street #2) described below has been filed with the City of Manitowoc and meets the requirements of Wis. Stat. § 66.0217(2); and

WHEREAS, the Common Council has determined that the City has reasonable need for the property and it is in the best interest of the petitioners, the residents and owners of property in the area to be annexed and the City of Manitowoc to annex the property after reviewing the recommendations of the Wisconsin Department of Administration pursuant to Wis. Stat. § 66.0217(6)(a).

NOW, THEREFORE, BE IT RESOLVED by the Mayor and Common Council of the City of Manitowoc do ordain as follows:

SECTION 1. Pursuant to Wis. Stat. § 66.0217(8), the following described territory in the Town of Manitowoc, Manitowoc County, Wisconsin is annexed to the City of Manitowoc:

A tract of land located in Lots 12 and 15 of the Subdivision of the East 1/2 of Section 6, T.18N, R.24E., Town of Manitowoc, Manitowoc County, Wisconsin described as follows:

Commencing at the North 1/4 corner of said Section 6, thence S89°51'20"E along the section line 659.58 feet to the centerline of So. 15th Street, thence S00°11'20"W (recorded as South) along said centerline 588.60 feet to the point of real beginning, thence continue S. 00° 11' 20 " W (recorded as South) along said centerline 136.00 feet, thence S89°51'20"E 662.69 feet (recorded as S89°59'57"E, 662.71 feet), thence N00°05'22"E 66.00 feet, thence N89°51'20"W 496.08 feet, thence N00°11'20"E 70.00 feet, thence N89°51'20"W 166.50 feet to the point of real beginning. Said tract contains 1.27 acres (55,388 square feet).

SECTION 2. The territory herein described has a population of two (2) and is made part of the 7th Aldermanic District and 37th Ward of the City of Manitowoc.

SECTION 3. The temporary zoning classification is R-1 Residential – Agricultural. The territory's proposed permanent zoning classification will be "R-4" Single and Two Family Residential, all according to the attached map.

SECTION 4. The annexed property will be in the SD-10 General Residential Sign District.

SECTION 5. The Wisconsin DOA Municipal Boundary Review Number is 14454.

SECTION 6. This Ordinance shall take effect on the day after its publication.

INTRODUCED NOV 15 2021 ADOPTED NOV 15 2021

Justin M. Nickels APPROVED 11/16/21
Justin M. Nickels, Mayor

This Ordinance was drafted by Paul Braun, City Planner

Fiscal Impact: Anticipated neutral, publication costs offset with fee to resident for rezone
Funding Source: 2021 approved budget publication line item and fee revenue line item
Finance Director Approval: /SMA
Approved as to form: /kmm

Aldermanic District #7

R-3

Ward 37

SE 1/4
SEC 31

TR 19N R24E

606

1602

1512

1510

1502

1410

TR 1
1318

TR 2
1312

TR 3
1306

TR 4

Section Line

VIEBAHN ST

S 14th St

S 15th St

City Limit

R-4

City of Manitowoc

Annexation Area

Town of Manitowoc

R-4

S. 15th St. #2

City of Manitowoc, WI

Aldermanic District #7

Ward 37

Population: 2

PC 40-2021
2815 S. 15th St.

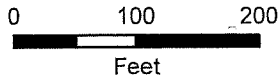

DISCLAIMER: Maps and associated data are believed to be accurate, but are not warranted. This information is not intended for legal, survey, or other related uses. Please obtain the original recorded documents for legal or survey information.

Prepared by City of Manitowoc
Community Development Department
www.manitowoc.org
Map Plotted: 10/18/2021

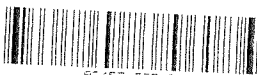

VOL 3457

PG 535

Legend

- Annexation Area
- Official Map Street
- Corporate Limits

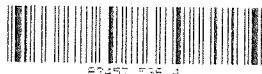

HTR media

A GANNETT COMPANY

STATE OF WISCONSIN BROWN COUNTY

CITY OF MANITOWOC

City Clerk
900 QUAY ST.
900 QUAY ST

MANITOWOC WI 54220 542204543

I, being duly sworn, doth depose and say I am an authorized representative of the Herald Times Reporter, a newspaper at Manitowoc Wisconsin and that an advertisement of which the annexed is a true copy, taken from said paper, which published therein on:

Account Number: GWM-306675
Order Number: 0005012222
Total Ad Cost: \$55.73
Published Dates: 11/22/2021

Legal Clerk

State of Wisconsin
County of Brown
Subscribed and sworn to before on November 22, 2021

Notary Public State of Wisconsin, County of Brown

5.15.23

My Commission Expires

of Affidavits 1
This is not an invoice

NANCY HEYRMAN
Notary Public
State of Wisconsin

ORDINANCE

An Ordinance to annex certain territory from the Town of Manitowoc to the City of Manitowoc as part of the 7th Aldermanic District and the 37th Ward of the City.

WHEREAS, a petition to annex the territory (S. 15th Street #2) described below has been filed with the City of Manitowoc and meets the requirements of Wis. Stat. § 66.0217(2); and

WHEREAS, the Common Council has determined that the City has reasonable need for the property and it is in the best interest of the petitioners, the residents and owners of property in the area to be annexed and the City of Manitowoc to annex the property after reviewing the recommendations of the Wisconsin Department of Administration pursuant to Wis. Stat. § 66.0217(5)(a).

NOW, THEREFORE, BE IT RESOLVED by the Mayor and Common Council of the City of Manitowoc do ordain as follows:

SECTION 1. Pursuant to Wis. Stat. § 66.0217(8), the following described territory in the Town of Manitowoc, Manitowoc County, Wisconsin is annexed to the City of Manitowoc:

A tract of land located in Lots 12 and 15 of the Subdivision of the East 1/2 of Section 6, T.18N, R.24E., Town of Manitowoc, Manitowoc County, Wisconsin described as follows:

Commencing at the North 1/4 corner of said Section 6, thence S88°51'20"E along the section line 659.58 feet to the centerline of So. 15th Street, thence S80°11'20"W (recorded as South) along said centerline 588.60 feet to the point of real beginning, thence continue S. 00°11'20"W (recorded as South) along said centerline 136.00 feet, thence S89°51'20"E 662.69 feet (recorded as S89°59'57"E, 662.71 feet), thence N00°05'22"E 66.00 feet, thence N89°51'20"W 498.08 feet, thence N00°11'20"E 70.00 feet, thence N89°51'20"W 188.50 feet to the point of real beginning. Said tract contains 1.27 acres (55,388 square feet).

SECTION 2. The territory herein described has a population of two (2) and is made part of the 7th Aldermanic District and 37th Ward of the City of Manitowoc.

SECTION 3. The temporary zoning classification is R-4 Residential - Agricultural. The territory's proposed permanent zoning classification will be "R-4" Single and Two Family Residential, all according to the attached map.

SECTION 4. The annexed property will be in the SD-10 General Residential Sign District.

SECTION 5. The Wisconsin DOA Municipal Boundary Review Number is 14454.

SECTION 6. This Ordinance shall take effect on the day after its publication. Introduced November 15, 2021 Adopted November 15, 2021

CITY OF MANITOWOC
Re: 21-1135

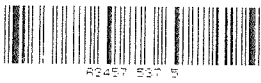

Approved November 16, 2021
(Signed) Justin M. Nickels, Mayor
Attest:
(Signed) MACKENZIE REED-
KADOW, City Clerk
I hereby certify that the above ordinance
was duly adopted by the Common
Council on Monday, November 15, 2021,
Published November 22, 2021
(Signed) Mackenzie Reed-Kadow, City
Clerk
RUN: Nov 22 WNAJLP

CITY OF MANITOWOC
Re: 21-1135