



"...meeting community needs...enhancing quality of life."

ORD11504

RECEIVED
06/23/2022

Municipal Boundary Review
WI Dept. of Administration

CERTIFICATION OF CLERK

I, KAMI LYNCH, the duly qualified City Clerk of the City of Appleton, Wisconsin, do hereby certify that the attached Ordinance is a true and compared copy of Ordinance #2-21 adopted by the Mayor and Common Council of the City of Appleton, Outagamie/Calumet/Winnebago Counties, at a regular meeting held January 20, 2021.

Dated at Appleton, Wisconsin, this 28th day of January 2021.

KAMI LYNCH
CITY CLERK

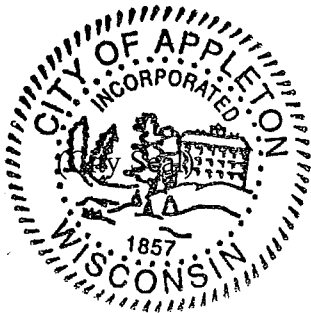

ADOPTED: January 20, 2021
PUBLISHED: January 26, 2021
Office of the City Clerk

2-21

**AN ORDINANCE ANNEXING TERRITORY
TO THE CITY OF APPLETON, WISCONSIN.**

(Cain (675 E. Edgewood Drive) Annexation)
MBR No. 14362

The Common Council of the City of Appleton does ordain as follows:

Section 1. Territory Annexed. In accordance with §66.0217 of the Wisconsin Statutes for 2017 – 2018 and the *Unanimous Petition for Direct Annexation* filed with the City Clerk on December 9, 2020, the following described territory in the Town of Grand Chute, Outagamie County, Wisconsin, lying contiguous to the City of Appleton, is hereby annexed to the City of Appleton, Wisconsin:

A part of the West One-half (W ½) of the Northeast Quarter (NE ¼) of the Northeast Quarter (NE ¼) of Section Eleven (11), Township Twenty-one (21) North, Range Seventeen (17) East, Town of Grand Chute, Outagamie County, Wisconsin, and being further described as follows:

*Commencing at the Northeast corner of said Section 11;
Thence South 88°40'17" West 659.12 feet coincident with the North line of the Northeast ¼ of said Section 11;
Thence South 00°30'17" East 50.00 feet to the point of beginning;
Thence continue South 00°30'17" East 167.80 feet;
Thence South 88°40'17" West 200.00 feet;
Thence North 00°30'17" West 167.80 feet;
Thence North 88°40'17" East 200.00 feet to the point of beginning.*

PARCEL: 101038801

The current population of such territory is 5 people.

Section 2. Effect of Annexation. From and after the date of this ordinance, the territory described in Section 1 shall be a part of the City of Appleton for any and all purposes provided

by law and all persons coming or residing within such territory shall be subject to all ordinances, rules and regulations governing the City of Appleton.

Section 3. Ward Designation. The territory described in Section 1 of this ordinance is hereby made a part of the Twentieth (20th) Ward, attached to the Seventh (7th) Aldermanic District of the City of Appleton, Outagamie County, subject to the ordinances, rules and regulations of the City governing wards.

Section 4. Zoning Classification. The territory described in Section 1 is hereby zoned as follows, pursuant to §66.0217(7)(a), Stats., and §23-65(e), Appleton Municipal Code:

Temporary AG District (Temporary Agricultural District)

Section 5. Severability. If any provision of this ordinance is invalid or unconstitutional, or if the application of this ordinance to any person or circumstances is invalid or unconstitutional, such invalidity or unconstitutionality shall not affect the other provisions or applications of this ordinance, which can be given without the invalid or unconstitutional provision or application.

Section 6. Effective Date. This ordinance shall take effect upon passage and publication.

Dated: January 20, 2021

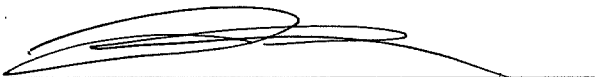

Jacob A. Woodford, Mayor
City Law A20-0711/21-0028



Kami Lynch, City Clerk

ANNEXATION EXHIBIT

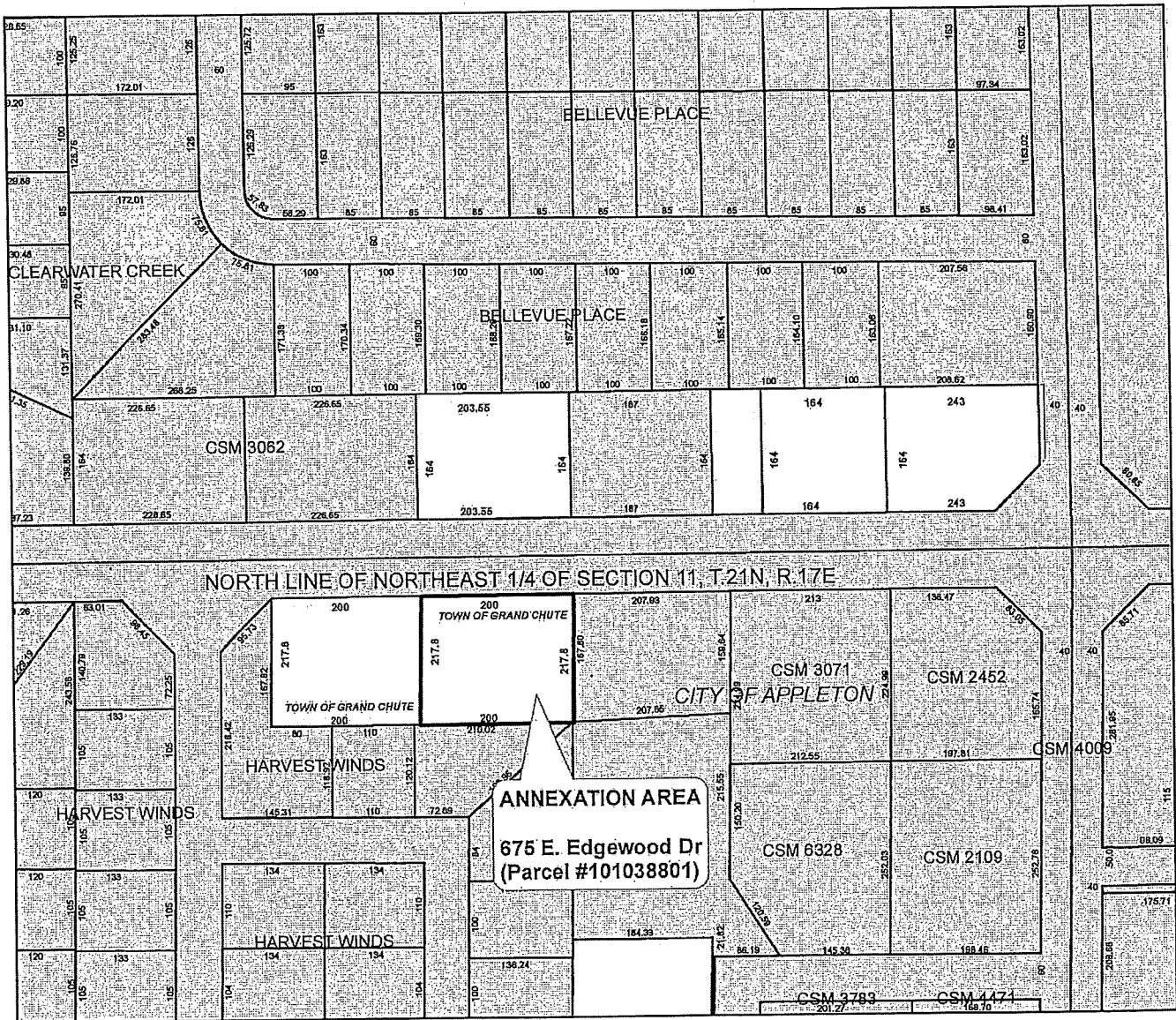
The East 200 feet of the North 217.8 feet of the West One-half (W ½) of the Northeast Quarter (NE ¼) of the Northeast Quarter (NE ¼) of Section Eleven (11), Township Twenty-one (21) North, Range Seventeen (17) East, Town of Grand Chute, Outagamie County, Wisconsin, less that part reserved for highway purposes, containing 0.77 Acres of land m/l.

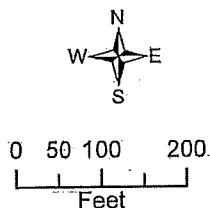

BEARINGS ARE REFERENCED TO THE
WISCONSIN COUNTY COORDINATE SYSTEM
OUTAGAMIE COUNTY, NORTH LINE OF
NORTHEAST 1/4 OF SECTION 11, T.21N, R.17E
Recorded to bear S89,14'49"E



CITY OF APPLETON
DEPT OF COMMUNITY
AND ECONOMIC DEVELOPMENT
GIS DIVISION
100 NORTH APPLETON STREET
APPLETON WI 54911
920-832-6468
MAPPED BY J SCHNEIDER
LEGAL DESC BY T KROMM
Date: 12/3/2020

**CERTIFICATE OF ANNEXATION
City of Appleton**Document #: **2223918**Date: **02-16-2021** Time: **2:18 PM**Pages: **6** Fee: **\$30.00**County: **OUTAGAMIE COUNTY** State: **WI**

I, KAMI LYNCH, the duly qualified City Clerk of the City of Appleton, County of Outagamie, State of Wisconsin, DO HEREBY CERTIFY, that the following described territory was detached from the Town of Grand Chute and was annexed to said City of Appleton pursuant to 66.0217 of the Wisconsin Statutes of 2017-2018, by an Ordinance adopted by the Common Council at a regular meeting held January 20, 2021.

2-21**AN ORDINANCE ANNEXING TERRITORY
TO THE CITY OF APPLETON, WISCONSIN.**

(Cain (675 E. Edgewood Drive) Annexation)
MBR No. 14362

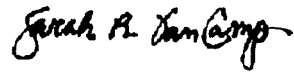
SARAH R VAN CAMP, REGISTER OF DEEDS
Return via MAIL (REGULAR)
APPLETON, CITY OF

Record and return to:
City of Appleton
City Clerk's Office
100 N. Appleton Street
Appleton, WI 54911



The Common Council of the City of Appleton does ordain as follows:

Section 1. Territory Annexed. In accordance with §66.0217 of the Wisconsin Statutes for 2017 – 2018 and the *Unanimous Petition for Direct Annexation* filed with the City Clerk on December 9, 2020, the following described territory in the Town of Grand Chute, Outagamie County, Wisconsin, lying contiguous to the City of Appleton, is hereby annexed to the City of Appleton, Wisconsin:

A part of the West One-half (W ½) of the Northeast Quarter (NE ¼) of the Northeast Quarter (NE ¼) of Section Eleven (11), Township Twenty-one (21) North, Range Seventeen (17) East, Town of Grand Chute, Outagamie County, Wisconsin, and being further described as follows:

*Commencing at the Northeast corner of said Section 11;
Thence South 88°40'17" West 659.12 feet coincident with the North line of the Northeast ¼ of said Section 11;
Thence South 00°30'17" East 50.00 feet to the point of beginning;
Thence continue South 00°30'17" East 167.80 feet;
Thence South 88°40'17" West 200.00 feet;
Thence North 00°30'17" West 167.80 feet;
Thence North 88°40'17" East 200.00 feet to the point of beginning.*

PARCEL: 101038801

The current population of such territory is 5 people.

Section 2. Effect of Annexation. From and after the date of this ordinance, the territory described in Section 1 shall be a part of the City of Appleton for any and all purposes provided by law and all persons coming or residing within such territory shall be subject to all ordinances, rules and regulations governing the City of Appleton.

Section 3. Ward Designation. The territory described in Section 1 of this ordinance is hereby made a part of the Twentieth (20th) Ward, attached to the Seventh (7th) Aldermanic District of the City of Appleton, Outagamie County, subject to the ordinances, rules and regulations of the City governing wards.

Section 4. Zoning Classification. The territory described in Section 1 is hereby zoned as follows, pursuant to §66.0217(7)(a), Stats., and §23-65(e), Appleton Municipal Code:

Temporary AG District (Temporary Agricultural District)

Section 5. Severability. If any provision of this ordinance is invalid or unconstitutional, or if the application of this ordinance to any person or circumstances is invalid or unconstitutional, such invalidity or unconstitutionality shall not affect the other provisions or applications of this ordinance, which can be given without the invalid or unconstitutional provision or application.

Section 6. Effective Date. This ordinance shall take effect upon passage and publication.

The Common Council of the City of Appleton does ordain as follows:

Dated: January 26, 2021

KAMI LYNCH CITY CLERK

