



639 S. Second Street  
Medford, WI 54451  
715-748-1184  
Fax (715-748-2339)

ORD11564

RECEIVED

10/17/2022

Municipal Boundary Review  
Wisconsin Dept. of Admin.

CERTIFIED MAIL

October 13, 2022

Wisconsin Department of Administration  
Municipal Boundary Review  
PO Box 1645  
Madison, WI 53701-1645

RE: Notification of Annexation for property located at 957 S Park Ave

Dear Sirs:

In accordance with § 66.0217(9), "Filing Requirements," Wisconsin Statutes, please find enclosed the following documentation reflecting the recent annexation of property located in the Town of Medford, being Part of the Northwest 1/4, of the Southwest 1/4 of Section 34, Township 31 North, Range 1 East, Town of Medford, Taylor County, Wisconsin, and more particularly described as follows:

**ANNEXATION LEGAL DESCRIPTION**

That part of the Northwest 1/4 of the Southwest 1/4 of Section 34, Township 31N Range 1E described as follows: Beginning at the Southeast corner of Parcel 2 of Certified Survey Map No. 440 as recorded in Volume 2 of Surveys, page 440 as Document No. 229451; thence N17°36'47"E, 340.08 feet; thence North 73°16'07" West, 138.60 feet; thence North N17°36'47"E, 237.60 feet; thence South 73°16'07" East, thence continuing South 73°16'07" East, 1 rod; thence South 17°36'47" West, to the South line of said forty, thence West on the South line of said Forty, to the point of beginning containing 0.80 acres, more or less to the City of Medford.

Attached to this letter are the following documents:

- A. ANNEXATION CERTIFICATE
- B. ANNEXATION ORDINANCE
- C. ANNEXATION PETITION
- D. ANNEXATION MAP(S)

This annexation was accomplished in accordance with § 66.0217, "Annexation of Territory," Wisconsin Statutes, annexation by Unanimous Approval. The effective date of the annexation is July 5, 2022.

Should you have any questions and/or comments concerning this matter, please contact me, 715-748-1184, at your earliest opportunity.

Sincerely,

Robert Christensen,  
City Planner  
Enclosures

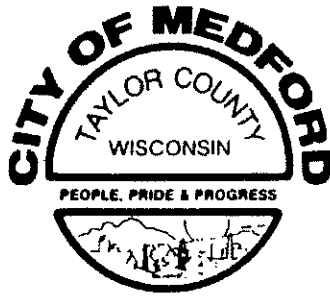

639 S. Second Street  
Medford, WI 54451  
715-748-4321  
Fax (715-748-2339)

## ANNEXATION CERTIFICATE

I, Ashley Lemke, City Clerk for the City of Medford, County of Taylor, Wisconsin, do hereby certify that the following described territory was detached from the Town of Medford, County of Taylor, Wisconsin, and was annexed to the City of Medford, pursuant to § 66.0217, Wisconsin Statutes, by Ordinance #1075 adopted by the City of Medford Common Council at their regular meeting held on August 16, 2022.

### *LEGAL DESCRIPTION FOR ANNEXATION*

ANNEXATION LEGAL DESCRIPTION- That part of the Northwest  $\frac{1}{4}$  of the Southwest  $\frac{1}{4}$  of Section 34, Township 31N Range 1E described as follows:  
Beginning at the Southwest corner of Section 34. T31 N.R1 E,  
thence North on the West line of Section 34 bearing N  $3^{\circ}12'32''$  W 1228.90 feet, to a point on the South line of the NW  $\frac{1}{4}$  of the SW  $\frac{1}{4}$  of said Section 34,  
thence N  $84^{\circ}34'59''$  E 861.52' to the point of beginning,  
thence N  $17^{\circ}36'47''$  E, 340.08 feet,  
thence N  $73^{\circ}16'07''$  W, 138.60 feet,  
thence N  $17^{\circ}36'47''$  E, 237.60 feet,  
thence S  $73^{\circ}16'07''$  E 155.10 feet,  
thence S  $17^{\circ}36'47''$  W, 570.92 feet the South line of said forty,  
thence S  $84^{\circ}34'59''$  W 17.93 feet on the South line of said Forty, to the point of beginning containing 0.97 acres, to the City of Medford.

I further certify that on the date of the adoption of this ordinance, the population of the territory annexed, by number, is two (2).

Dated this 6th day of September 2022.

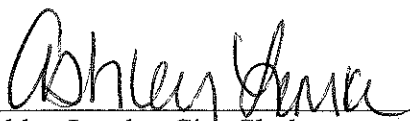
  
\_\_\_\_\_  
Ashley Lemke, City Clerk

**Ordinance #1075**

THE COMMON COUNCIL OF THE CITY OF MEDFORD, TAYLOR COUNTY, WISCONSIN, DO HEREBY ORDAIN AS FOLLOWS:  
ORDINANCE #1074 IS HEREBY RESCINDED AND REISSUED AS FOLLOWS

SECTION 1: **Territory Annexed.** In accordance with Wisconsin State Statute §66.0217(2), the following described territory in the Town of Medford, Taylor County, Wisconsin, is annexed to the City of Medford, Wisconsin:

That part of the Northwest  $\frac{1}{4}$  of the Southwest  $\frac{1}{4}$  of Section 34, Township 31N Range 1E described as follows:

Beginning at the Southwest corner of Section 34. T31 N.R1 E, thence North on the West line of Section 34 bearing N 3°12'32" W 1228.90 feet, to a point on the South line of the NW  $\frac{1}{4}$  of the SW  $\frac{1}{4}$  of said Section 34, thence N 84°34'59" E 861.52' to the point of beginning, thence N 17°36'47" E, 340.08 feet, thence N 73°16'07" W, 138.60 feet, thence N 17°36'47" E, 237.60 feet, thence S 73°16'07" E 155.10 feet, thence S 17°36'47" W, 570.92 feet the South line of said forty, thence S 84°34'59" W 17.93 feet on the South line of said Forty, to the point of beginning containing 0.97 acres, to the City of Medford.

SECTION 2: **Effect of Annexation.** From and after the date of this ordinance, subject to the Department of Administration review under Section §66.0217(2), the territory described in Section 1 shall be part of the City of Medford for any and all purposes provided by law and persons coming or residing within such territory shall be subject to all ordinances, rules and regulations governing the City of Medford.

SECTION 3: **Zoning Classification.** The territory annexed to the City of Medford by this ordinance is designated as follows:

R-1, Single-family Residential Zoning District.

SECTION 4: **Ward Designation.** The territory described in Section 1 of this ordinance is hereby made a part of Ward 4, Aldermanic District #2 of the City of Medford, subject to the ordinances, rules and regulations of the City governing wards.

SECTION 5: **Severability.** If any provision of this ordinance is invalid or unconstitutional, or if the application of this ordinance to any person or circumstance is invalid or unconstitutional, such invalidity or unconstitutionality shall not affect the other provisions or applications of this ordinance which can be given effect without the invalid or unconstitutional provision or application.

SECTION 6: **Effective Date.** This ordinance shall take effect upon passage and publication as provided by law.

**Ordinance #1075**

Page Two

SUBMITTED BY: Plan Commission

VOTE TAKEN AND DATE: August 16, 2022 (7 Yes; 0 No; 1 Absent)

Dave Brandner - Yes	Laura Holmes - Yes
Greg Knight - Yes	Ken Coyer - Absent
Christine Weix - Yes	David Roiger - Yes
Michael Bub - Yes	Clem Johnson - Yes

Mayor's Signature, if Approved:

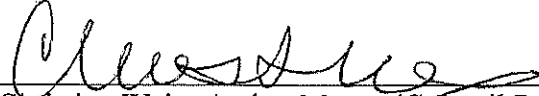
  
 Christine Weix, Acting Mayor (Council President)

ATTEST:

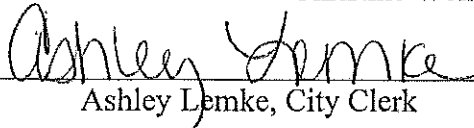
  
 Ashley Lemke, City Clerk

**ACKNOWLEDGMENT**

STATE OF WISCONSIN     )  
   ) ss.  
 Taylor County             )

Personally, came before me this 16th day of August 2022 the above named person(s) to me known to be the person(s) who executed the foregoing instrument and acknowledged the same.

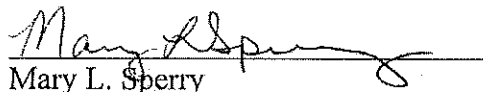
  
 Mary L. Sperry  
 Notary Public, State of Wisconsin  
 My Commission expires: May 4, 2024

This document drafted by:  
 Robert Christensen, City Planner  
 City of Medford  
 639 S Second Street  
 Medford, WI 54451

**PETITION FOR DIRECT ANNEXATION BY UNANIMOUS  
APPROVAL  
PURSUANT TO WISCONSIN STATE STATUTE 66.021(12)**

We, the undersigned, constituting all of the electors and all of the owners of real property in the following territory in the Town of Medford Taylor County, Wisconsin, lying contiguous to the City of Medford, petition the Mayor and Common Council to annex the territory described below and shown on the attached survey map to the City of Medford, Taylor County, Wisconsin:

See attached

The current population of the territory to be annexed is two (2) and shown by actual count.

We, the undersigned, elected that this annexation shall take effect to the full extent consistent with outstanding priorities of other annexation, incorporation or consolidated proceedings, if any.

We, the undersigned, request the property be located in the R-1 Zoning District.

Dated this 19th day of January 2022.

/s/   
Michael S. Brandner

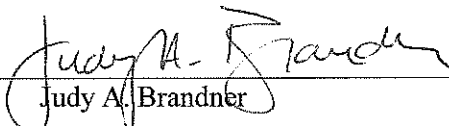
/s/   
Judy A. Brandner

\*\*\*\*\*

ELECTORS RESIDING ON SAID PROPERTY TO BE ANNEXED: Two (2)

\*\*\*\*\*

Date Filed with City Clerk's Office: JANUARY 25, 2022

Signature: 

Date Filed with Clerk of Town of Medford FEBRUARY 3, 2022

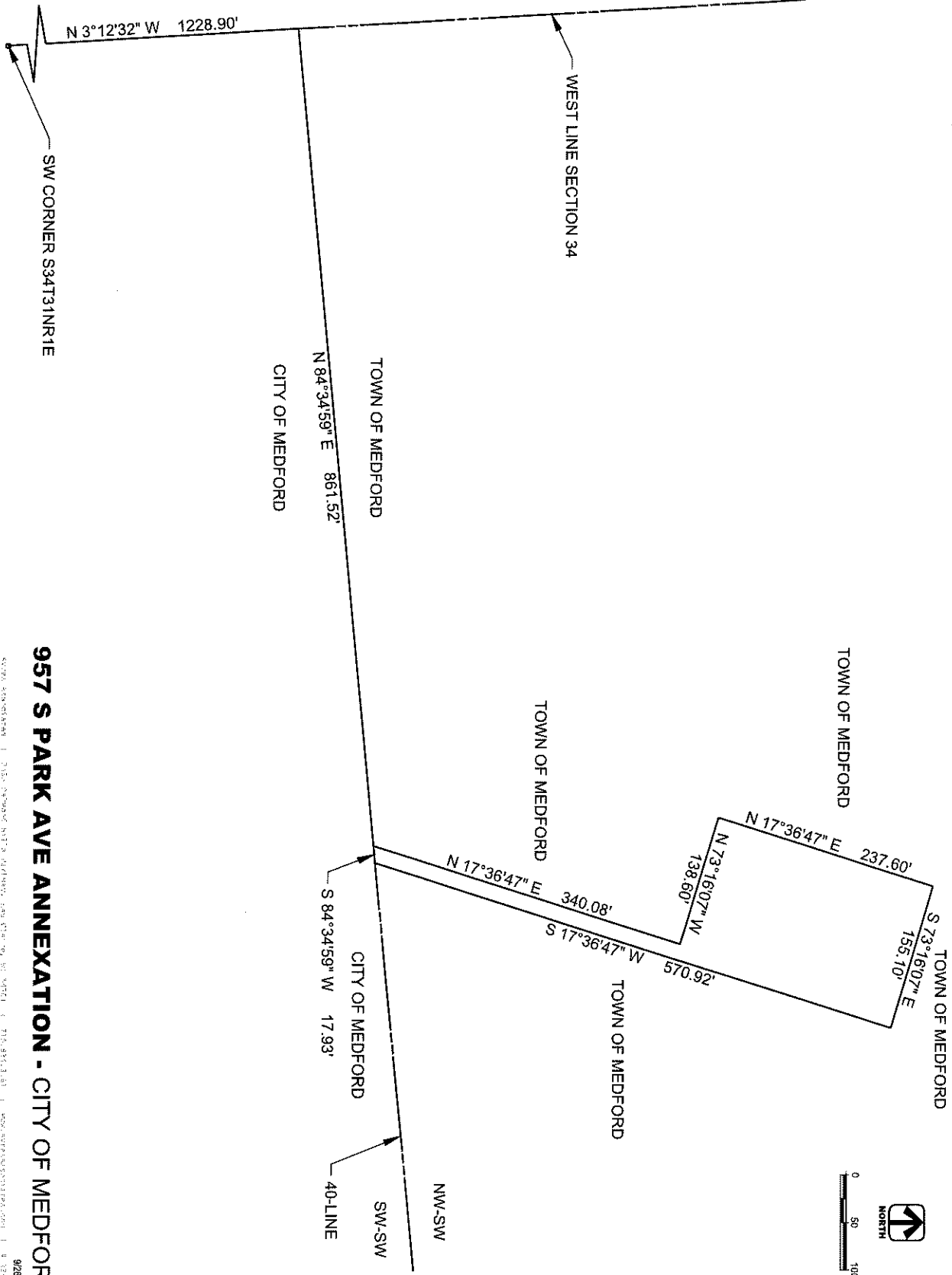

### 957 S PARK AVE ANNEXATION - CITY OF MEDFORD

AVRES ENGINEERING | 2150 COLUMBIA STREET, SUITE 100, MEDFORD, MA 02155 | TEL: 978.681.1111 | FAX: 978.681.1112 | WWW.AVRESENGINEERING.COM | E: 10/16/2012

251019310155  
25101390003  
251019310154

251019310610

251019310601

251019310607

251019310620  
251019310609

251019310604  
33  
251019310603  
251019310602

S GIBSON ST

251019330050 MEDFORD 032011560000

251019540000

251019550100

251019550506

251019590204



0 200 400 600ft

DISCLAIMER: This map is not guaranteed to be accurate, correct, current, or complete and conclusions drawn are the responsibility of the user.

3

LITTLE BLACK

026000790000

COUNTY HIGHWAY ROW

251017344200

2

251017340900

COUNTY RD 0

LITTLE BLACK  
026000680000

251019590205

TOWN OF MEDFORD BOUNDARY  
SHOWN IN GREEN (032)

MEDFORD

CITY STREET  
JENSEN DR

251019530200

251019530202

032011690003

032011650000

251019530105

251019530103

251019590101

032011680000

34

251019530101

251019550501

251019550500

251019590202

AREA OF  
ANNEXATION

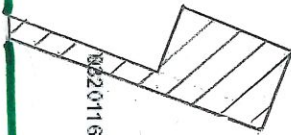

CITY STREET  
INDUS TRIAL DR

WHELEN AVE



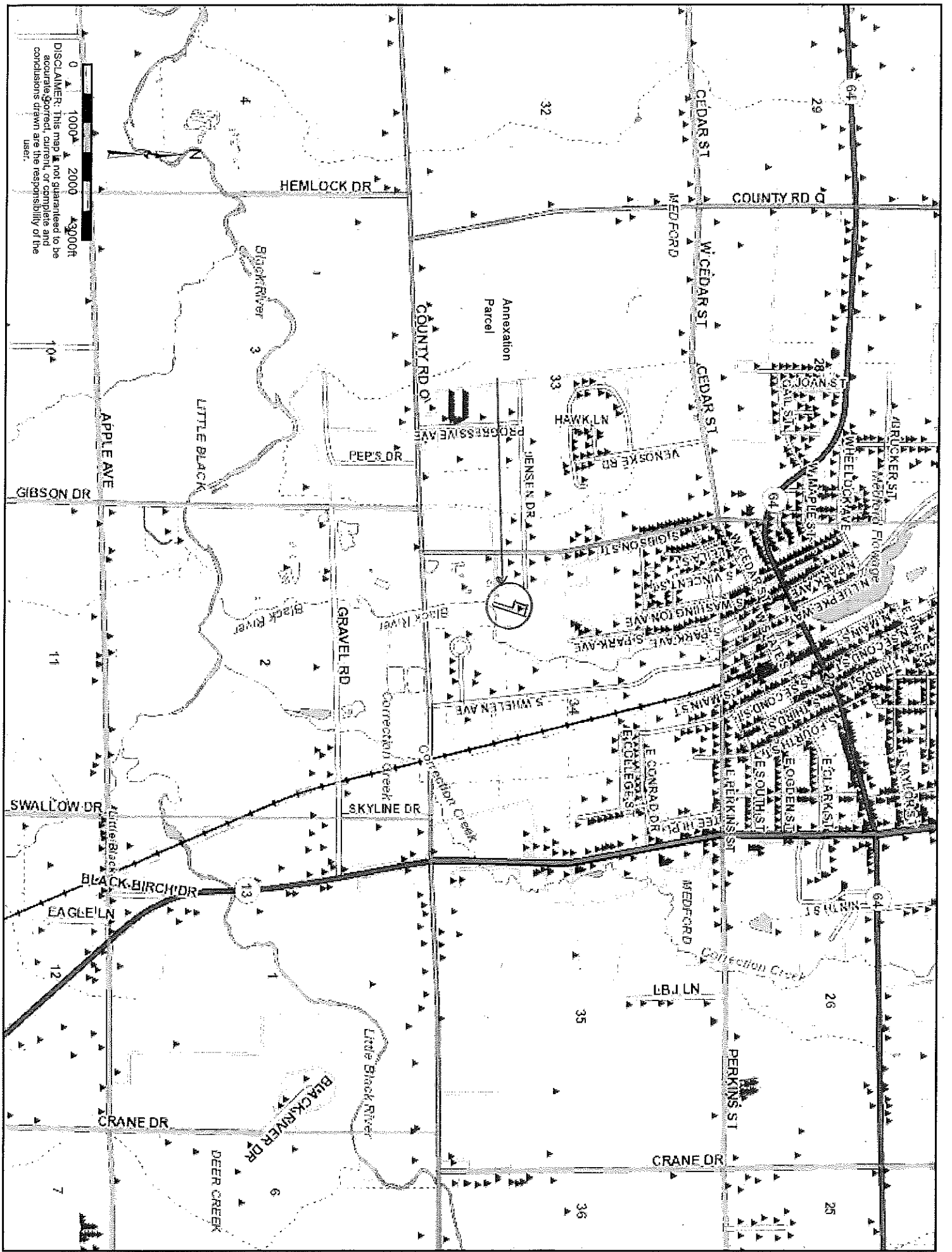

DISCLAIMER: This map is not guaranteed to be accurate, correct, current, or complete and conclusions drawn are the responsibility of the user.



Annexation Parcel