

Request for Annexation Review

RECEIVED
AT
DHIR

Division of Intergovernmental Relations
Municipal Boundary Review
101 E. Wilson Street, 10th Floor
Madison, WI 53702-0001

Wisconsin Department of Administration **DEC - 1 06**

608-266-0683 Fax: 608-267-6917
George.Hall@doa.state.wi.us

Petitioner's Name and Address

Craig J. Hein
S92 W27720 Edgewood Ave.
Mukwonago, WI 53149

Office use only:

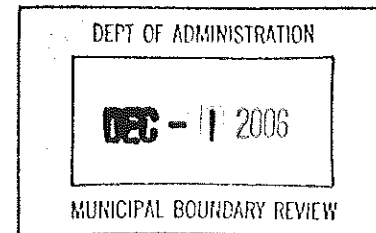

1. Town where property is located. **Town of Vernon**
2. Petitioned City or Village. **Village of Mukwonago**
3. County where property is located. **Waukesha**
4. Population of the territory to be annexed. **0 - Vacant Land**
5. Area (in acres) of the territory to be annexed **17.72 acres**
6. Tax parcel number(s) of territory to be annexed **VNT 2091-999-008**
(if the territory is part or all of an existing parcel)

262-442-5364
Petitioner's phone #

262-662-2039
Town Clerk's phone #

262-363-6420
City/Village Clerk's phone #

Contact Information if different than petitioner:

Representative's Name and Address:

JS Development LLC
James D. Schilling P.E.
1130 Schneider Lane
Burlington, WI 53105

Phone **262-514-2741**

E-mail **jsdevelopment@tds.net**

Surveyor or Engineering Firm's Name and Address:

Degen-Foat Surveying, Inc.
100 South Second Street
Waterford, WI 53185

Phone **262-534-5404**

E-mail _____

Required Items to be provided with submission (to be completed by petitioner):

1. Legal Description meeting the requirements of s.66.0217 (c)..... ☒
2. Map meeting the requirements of s. 66.0217 (g)
 - Includes delineating boundary of the annexing city or village on the map..... ☒
 - Territory is contiguous to city or village..... ☒
3. Petition or Notice of Intent to Circulate..... ☒
4. Statutory method used?
 - Unanimous s. 66.0217 (2), or,..... ☒
 - Direct by one-half approval s. 66.0217 (3)..... ☐
5. Check or money order covering Department of Administration annexation fee..... ☒

Annexation Review Fee Schedule

A Guide for Calculating the Fee Required by ss.16.53 (4) and 66.0217, Wis. Stats.

Required Fees

There is an initial filing fee and a variable acreage fee

Initial Filing Fee* \$200 **\$ 200.00**

*NOTE: The \$200 initial filing fee is required with the first submittal of the petition, only.

Acreage Fee..... **\$ 300.00**

Less than 2 acres..... \$200

2.01 to 10 acres..... \$300

10.01 to 50 acres..... \$400

50.01 to 100 acres..... \$500

100.01 to 200 acres..... \$700

200.01 to 500 acres..... \$1000

Over 500 acres..... \$2000

TOTAL FEE DUE (Add the Filing Fee to the Acreage Fee)..... \$ 500.00

\$ 600.00

Attach check or money order here, payable to: Department of Administration

**THE DEPARTMENT IS PROHIBITED FROM PROCESSING
AN ANNEXATION PETITION THAT IS NOT ACCOMPANIED
BY THE REQUIRED FEE.**

Office use only:

Date that petition and fee was received _____ Amount \$ _____

Time limit expires _____ Assigned file number _____

BY:	Questionnaire sent to:
	Town of _____ City/Village of _____
	County Notification _____ DATE _____

PETITION FOR ANNEXATION

The undersigned, constituting 100 percent of the owners of the following described territory located in the Town of Vernon, Waukesha County, Wisconsin, lying contiguous to the Village of Mukwonago, petition the Village board of said Village to annex the territory described below and shown on the attached map, as permitted by Chapter 66 of the Wisconsin Statutes, to the Village of Mukwonago, Waukesha County, Wisconsin.

LEGAL DESCRIPTION:

Part of Lot 1, Waukesha County Certified Survey Map No. 8142. Being a part of the Southeast $\frac{1}{4}$ and the Southwest $\frac{1}{4}$ of Section 19, Town 5 North, Range 19 East, Town of Vernon, Waukesha County, Wisconsin. Commence at the South $\frac{1}{4}$ Corner of Section 19; Thence N $01^{\circ}30'48''$ W, along the west line of the southeast $\frac{1}{4}$ of said section, 1198.10 feet to the point of beginning; thence S $72^{\circ}00'22''$ W, 668.89 feet; thence N $26^{\circ}40'38''$ W, 200.00 feet; thence N $57^{\circ}38'00''$ E, 111.50 feet; thence N $39^{\circ}15'00''$ E, 68.04 feet; thence 76.89 feet along an arc of a curve to the right, having a radius of 183.00 feet and a chord that bears N $38^{\circ}42'49''$ W, 76.32 feet; thence 276.73 feet along an arc of a curve to the right, having a radius of 60.00 feet and a chord that bears N $21^{\circ}11'32.5''$ E, 88.99 feet; thence S $26^{\circ}40'38''$ E, 27.28 feet; thence N $63^{\circ}19'22''$ E, 150.00 feet; thence N $26^{\circ}40'38''$ W, 60.00 feet; thence N $50^{\circ}35'42''$ E, 210.00 feet; thence N $17^{\circ}24'38''$ E, 210.00 feet; thence N $01^{\circ}30'48''$ W, parallel to the west line of the southwest $\frac{1}{4}$ of said section, 180.00 feet; thence N $50^{\circ}00'00''$ E, 150.00 feet; thence N $88^{\circ}29'12''$ E, 125.00 feet; thence S $01^{\circ}30'48''$ E along the west line of the southwest $\frac{1}{4}$ of said section, 307.59 feet; thence S $25^{\circ}28'51''$ E, 130.07 feet; thence N $77^{\circ}52'12''$ E, 134.91 feet; thence N $81^{\circ}19'56''$ E, 134.91 feet; thence N $84^{\circ}59'24''$ E, 150.15 feet; thence S $60^{\circ}27'58''$ E, 77.20 feet; thence N $88^{\circ}16'52''$ E, 200.00 feet; thence S $01^{\circ}43'08''$ E, 404.35 feet; thence N $88^{\circ}54'57''$ W, 292.78 feet; thence S $72^{\circ}00'22''$ W, 463.32 feet to the point of beginning.

Said parcel contains 17.72 acres.

There are no persons residing in this territory.

Dated this 22 day of NOVEMBER, 2006

Craig Hein
Owner:
Craig J. Hein
S92 W27720 Edgewood Ave.
Mukwonago, WI 53149

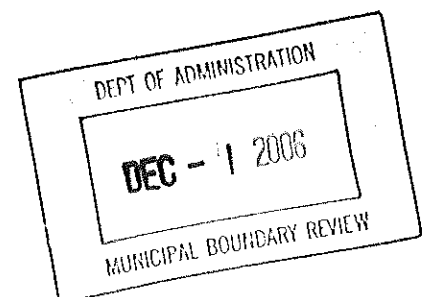

ANNEXATION MAP

SEE SHEET 2 FOR LEGAL DESCRIPTION

DEPT. OF ADMINISTRATION

DEC 11 2006

MUNICIPAL BOUNDARY REVIEW

KAORU HIRATA
UNPLATTED LANDS
TAX NO. 2092-998

TOWN OF VERNON

DEGEN - FOAT SURVEYING, INC.

100 SOUTH SECOND STREET
WATERFORD, WISCONSIN 53185
(262)534-5404 (FAX)534-2022

060114\060114P1.DWG

THIS INSTRUMENT DRAFTED BY: GARY B. FOAT

PART OF LOT 1, C.S.M. 8142
OWNED BY SUBDIVIDER
TAX NO. 2091-999-008

PART OF LOT 1, C.S.M. 8142
OWNED BY SUBDIVIDER
TAX NO. 2091-999-008

SOUTH 1/4 CORNER
SECTION 19-5-19

N 88°29'12" E 125.00

S 01°30'48" E 307.59

N 50°00'00" E 150.00
N 01°30'48" W 180.00

PART OF LOT 1, C.S.M. 8142
OWNED BY SUBDIVIDER
TAX NO. 2091-999-008

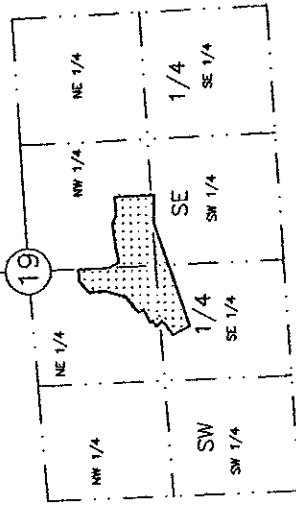

VICINITY MAP

SOUTH 1/2 SEC. 19-5-19
SCALE: 1" = 2000'

S 26°40'38" E 27.28
CH = N 21°1'32.5" E 88.99
R = 60.00 ARC = 276.73

N 63°19'22" E 150.00

CH = N 38°42'49" W 76.32
R = 183.00 ARC = 76.89

N 39°15'00" E 68.04

OF 668.89

OF 10.090

LOT 2, C.S.M. 10,090
EDGEWOOD MEADOWS DEL.

LOT 1, C.S.M. 10,090
HARMONY HOMES

TOWN

VILLAGE

OF

OF

OF

OF

OF

OF

OF

OF

SCALE: 1" = 200'



ANNEXATION DESCRIPTION

PART OF LOT 1, WAUKESHA COUNTY CERTIFIED SURVEY MAP NO. 8142, BEING A PART OF THE SOUTHEAST 1/4 AND THE SOUTHWEST 1/4 OF SECTION 19, TOWN 5 NORTH, RANGE 19 EAST, TOWN OF VERNON, WAUKESHA COUNTY, WISCONSIN. COMMENCE AT THE SOUTH 1/4 CORNER OF SECTION 19; THENCE N 01°30'48" W, ALONG THE WEST LINE OF THE SOUTHEAST 1/4 OF SAID SECTION, 1198.10 TO THE POINT OF BEGINNING; THENCE S 72°00'22" W, 668.89 FEET; THENCE N 26°40'38" W, 200.00 FEET; THENCE N 57°38'00" E, 111.50 FEET; THENCE N 39°15'00" E, 68.04 FEET; THENCE 76.89 FEET ALONG AN ARC OF A CURVE TO THE RIGHT, HAVING A RADIUS OF 183.00 FEET AND A CHORD THAT BEARS N 38°42'49" W, 76.32 FEET; THENCE 276.73 FEET ALONG AN ARC OF A CURVE TO THE RIGHT, HAVING A RADIUS OF 60.00 FEET AND A CHORD THAT BEARS N 21°11'32.5" E, 88.99 FEET; THENCE S 26°40'38" E, 27.28 FEET; THENCE N 63°19'22" E, 150.00 FEET; THENCE N 26°40'38" W, 60.00 FEET; THENCE N 50°35'42" E, 210.00 FEET; THENCE N 17°24'38" E, 210.00 FEET; THENCE N 01°30'48" W, PARALLEL TO THE WEST LINE OF THE SOUTHEAST 1/4 OF SAID SECTION, 180.00 FEET; THENCE N 50°00'00" E, 150.00 FEET; THENCE N 88°29'12" E, 125.00 FEET; THENCE S 01°30'48" E ALONG THE WEST LINE OF THE SOUTHEAST 1/4 OF SAID SECTION, 307.59 FEET; THENCE S 25°28'51" E, 130.07 FEET; THENCE N 77°52'12" E, 134.91 FEET; THENCE N 81°19'56" E, 134.91 FEET; THENCE N 84°59'24" E, 150.15 FEET; THENCE S 60°27'58" E, 77.20 FEET; THENCE N 88°16'52" E, 200.00 FEET; THENCE S 01°43'08" E, 404.35 FEET; THENCE N 88°54'57" W, 292.78 FEET; THENCE S 72°00'22" W, 463.32 FEET TO THE POINT OF BEGINNING. CONTAINING 17.72 ACRES OF LAND.

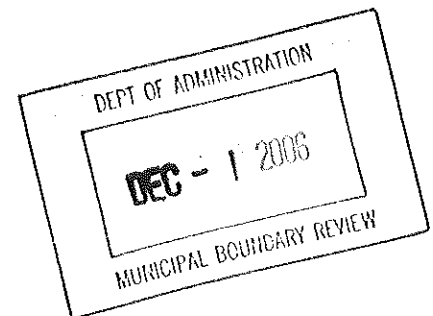

DEGEN -- FOAT SURVEYING, INC.

100 SOUTH SECOND STREET
WATERFORD, WISCONSIN 53185
(262)534-5404 (FAX)534-2022

080114\080114P1.DWG

THIS INSTRUMENT DRAFTED BY: GARY B. FOAT

SHEET 2 OF 2



JIM DOYLE
GOVERNOR

STEPHEN BABLITCH
SECRETARY

Division of Intergovernmental Relations
101 E. Wilson Street, 10th Floor
Madison, WI 53702-0001
(608) 264-6102, Fax (608) 267-6917
<http://www.doa.wi.gov/>

December 6, 2006

PETITION FILE NO. 12988

BERNARD W KAHL, CLERK
VILLAGE OF MUKWONAGO
PO BOX 206
MUKWONAGO, WI 53149

GINA GRESCH, CMC, CLERK
TOWN OF VERNON
PO BOX 309
BIG BEND, WI 53103

Subject: HEIN ANNEXATION

Section 66.0217 (6), Wis. Stats., provides that the annexation of lands to cities and villages within a county having a population of 50,000 or more shall be reviewed by the Department of Administration in order to determine if the proposed annexation is in the public interest or against the public interest. The proposed annexation from the Town of VERNON to the Village of MUKWONAGO (see attached description) must be reviewed pursuant to the statute.

To assist us in making this determination, we urge that you promptly supply the data requested on the enclosed questionnaire (where possible) and return the questionnaire to the department.

The purpose of this questionnaire is to assist the department in determining "Whether the governmental services, including zoning, to be supplied to the territory could clearly be better supplied by the town...." The statute further stipulates that the department shall study the "shape of the proposed annexation and the homogeneity of the territory with the annexing municipality." In addition, we would appreciate receiving from you any comments or information bearing on governmental services or shape and homogeneity that would indicate whether the annexation is in or against the public interest.

Our reply must be prepared within a very limited statutory deadline. Please return the questionnaire no later than December 18, 2006 so that the information can be reviewed prior to the department's statutory deadline of December 21, 2006. Direct any questions and comments to Erich Schmidtke at (608) 264-6102 or George Hall at (608) 266-0683. Thank you for your cooperation.

For additional information on annexation or other land use issues, visit our web site at www.doa.wi.gov and type 'annexation' in the search box.

Sincerely,

Erich Schmidtke

Enclosures



WISCONSIN DEPARTMENT OF
ADMINISTRATION

JIM DOYLE
GOVERNOR

STEPHEN BABLITCH
SECRETARY

Division of Intergovernmental Relations
Municipal Boundary Review
101 E. Wilson Street, 10th Floor
Madison, WI 53702-0001
(608) 264-6102, Fax (608) 267-6917
<http://www.doa.wi.gov/>

December 22, 2006

DOA PETITION FILE NO. 12988

BERNARD W KAHL, CLERK
VILLAGE OF MUKWONAGO
PO BOX 206
MUKWONAGO, WI 53149

GINA GRESCH, CMC, CLERK
TOWN OF VERNON
PO BOX 309
BIG BEND, WI 53103

Subject: HEIN ANNEXATION

The proposed annexation submitted to our office on December 1, 2006, has been reviewed and found to be in the public interest.

The subject petition is for territory that is reasonably shaped and contiguous to the Village of MUKWONAGO. We received no response to our annexation questionnaires from either municipality.

The Department reminds clerks of annexing municipalities of the requirements of s. 66.0217 (9)(a), Wis. Stats., which states:

"The clerk of a city or village which has annexed shall file immediately with the secretary of state a certified copy of the ordinance, certificate and plat, and shall send one copy to each company that provides any utility service in the area that is annexed. The clerk shall record the ordinance with the register of deeds and file a signed copy of the ordinance with the clerk of any affected school district..."

State and federal aids based on population and equalized value may be significantly affected through failure to file with the Secretary of State. Please file a copy of your annexing ordinance, including a statement certifying the population of the annexed territory. **Please also include the MBR number with your ordinance as this assists with record keeping. Your MBR number is: 12988**

The address of the Office of the Secretary of State is:

Annexations and Railroads
Division of Government Records
Office of the Secretary of State
P.O. Box 7848
Madison, WI 53707-7848

Please call me at (608) 266-0683, should you have any questions concerning this annexation review letter. I am enclosing a copy of Act 317, as this legislation may affect the passage of any annexation ordinance.

Sincerely,



George Hall
Municipal Boundary Review

Cc: James D. Schilling, P.E.