

14038

Carl & Susan Benck

14038	Date Sent	Reply	Status
Town Quest	7/24		
Muni Quest	7/24	7-31	
Prop. Lister			

TOWN OF FOUNTAIN PRAIRIE  
VILLAGE OF FALL RIVER  
08/14/2017

OK COMMENTS 8/14/17

# Request for Annexation Review

Wisconsin Department of Administration

WI Dept. of Administration  
Municipal Boundary Review  
101 E. Wilson Street, 9<sup>th</sup> Floor  
Madison WI 53703  
608-264-6102 Fax: 608-264-6104  
[wimunicipalboundaryreview@wi.gov](mailto:wimunicipalboundaryreview@wi.gov)  
<http://doa.wi.gov/municipalboundaryreview/>

14038

## Petitioner Information

Name: Carl T. + Susan M. Benck

Address: W1250 Cty Rd Z

Fall River WI. 53932

Email: cbenck@centurytel.net

Office use only:

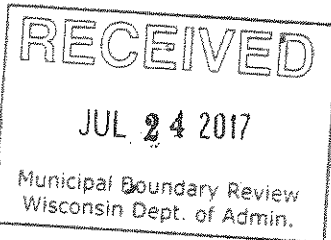

1. Town where property is located: Fountain Prairie

2. Petitioned City or Village: Fall River

3. County where property is located: Columbia

4. Population of the territory to be annexed: 2

5. Area (in acres) of the territory to be annexed: 38

6. Tax parcel number(s) of territory to be annexed  
(if the territory is part or all of an existing parcel): 505, 506.2

Petitioners phone:

920-484-3943

Town clerk's phone:

920-484-3396

City/Village clerk's phone:

920-484-3525

## Contact Information if different than petitioner:

Representative's Name and Address:

\_\_\_\_\_  
\_\_\_\_\_  
\_\_\_\_\_  
\_\_\_\_\_

Phone: \_\_\_\_\_

E-mail: \_\_\_\_\_

Surveyor or Engineering Firm's Name & Address:

Robert Roth  
Roth Professional Solutions  
W8678 Co Rd F  
Portage WI 53901

Phone: 608 687-5857

E-mail: robert@rps-professionalsolutions.com

## Required Items to be provided with submission (to be completed by petitioner):

1. ☒ Legal Description meeting the requirements of s.66.0217 (1) (c) [see attached annexation guide]
2. ☒ Map meeting the requirements of s. 66.0217 (1) (g) [see attached annexation guide]
3. ☒ Signed Petition or Notice of Intent to Circulate is included
4. Indicate Statutory annexation method used:
  - ☒ Unanimous per s. 66.0217 (2), or,
  - OR
  - ☐ Direct by one-half approval per s. 66.0217 (3)
5. ☒ Check or money order covering review fee [see next page for fee calculation]

# Annexation Review Fee Schedule

A Guide for Calculating the Fee Required by ss. 16.53 (4) and 66.0217, Wis. Stats.

14038

## Required Fees

There is an initial filing fee and a variable review fee

\$ 350 **Initial Filing Fee** (required with the first submittal of all petitions)  
\$200 – 2 acres or less  
\$350 – 2.01 acres or more

\$ 800 **Review Fee** (required with all annexation submittals except those that consist ONLY of road right-of-way)  
\$200 – 2 acres or less  
\$600 – 2.01 to 10 acres  
\$800 – 10.01 to 50 acres  
\$1,000 – 50.01 to 100 acres  
\$1,400 – 100.01 to 200 acres  
\$2,000 – 200.01 to 500 acres  
\$4,000 – Over 500 acres

\$ 1150 **TOTAL FEE DUE** (Add the Filing Fee to the Review Fee)

**Attach** check or money order here, payable to: **Department of Administration**

**THE DEPARTMENT WILL NOT PROCESS  
AN ANNEXATION PETITION THAT IS NOT ACCOMPANIED  
BY THE REQUIRED FEE.**

**THE DEPARTMENT'S 20-DAY STATUTORY REVIEW PERIOD  
COMMENCES UPON RECEIPT OF THE PETITION AND REVIEW FEE**

Shaded Area for Office Use Only

Date fee received: 7/24

Payee: BENCE FARMS

Check Number: 10518

Check Date: 7/19

Amount: 1,150

14038

ANNEXATION PETITION

Unanimous Petition of the Property Owners for Direct Annexation  
Pursuant to Section 66.0217(2), Wisconsin Statutes

We, the undersigned, constituting 100% of the owners of the real property and there being no electors in the following territory of the Town of Fountain Prairie, Columbia County, Wisconsin, lying contiguous to the Village of Fall River, petition the Fall River Village Board to annex the territory described and shown in the following documents.

This annexation contains 38.010 acres of real estate.

There are no persons residing in this territory.

Dated this 19<sup>th</sup> day of July, 2017



Carl T. Benck



Susan M. Benck

Address of both Petitioners:

W1250 County Road Z

Fall River, WI. 53932



**SFR DEVELOPMENT OPTION A**  
CARL BENCK PROPERTY  
VILLAGE OF FALL RIVER  
COLUMBIA COUNTY, WI  
83041

CONCEPT  
PLAN

7/17/2017

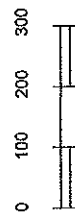

2017-107(A)

**A**

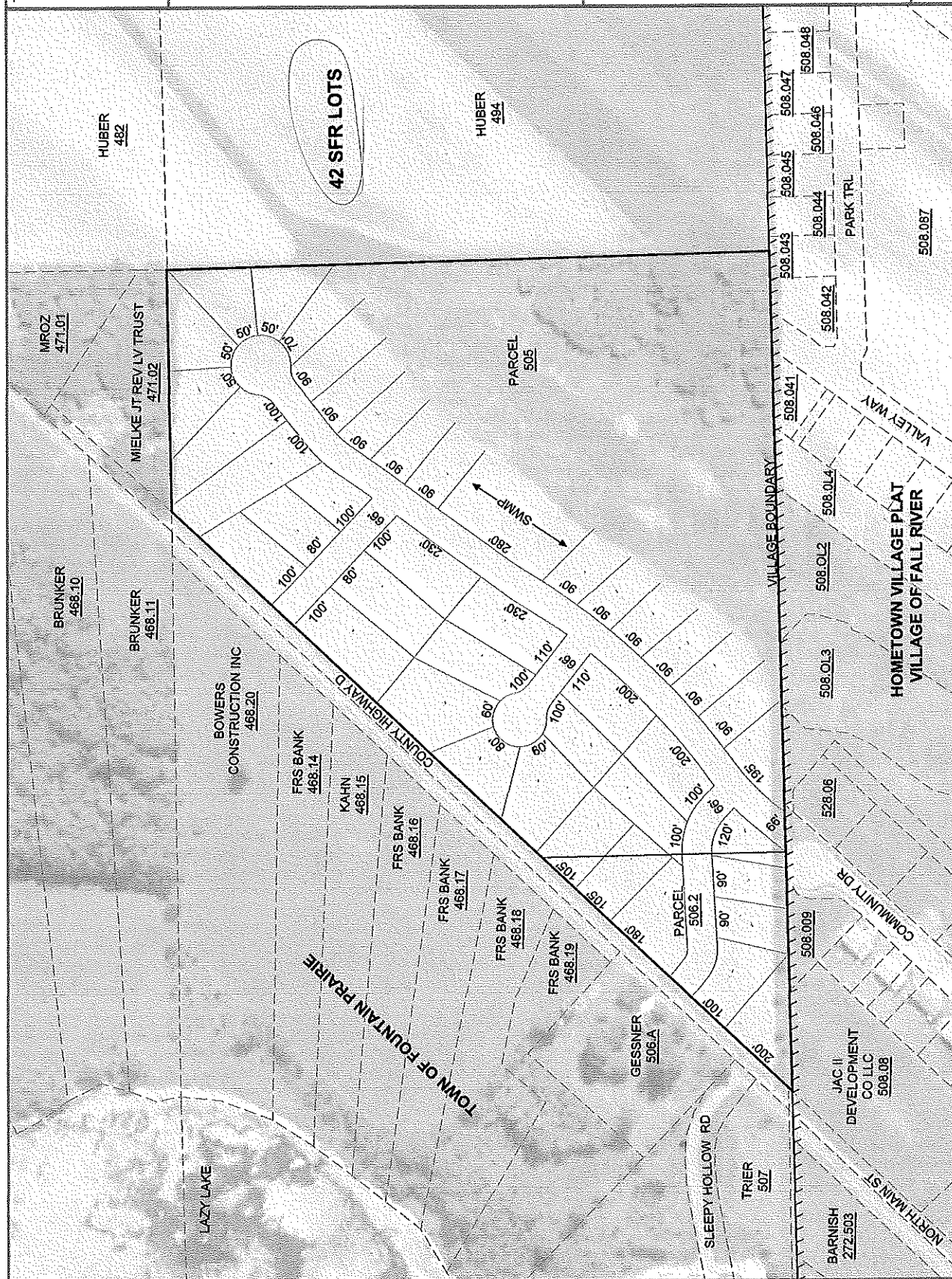

# Tax Parcel Map

Exhibit A

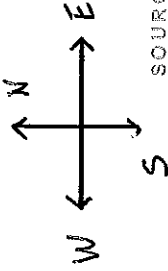

MAP SCALE 1:5,269

SOURCE Columbia County Land Information  
www.co.columbia.wi.us/ColumbiaCounty/LandInformation

DATE July 19, 2017

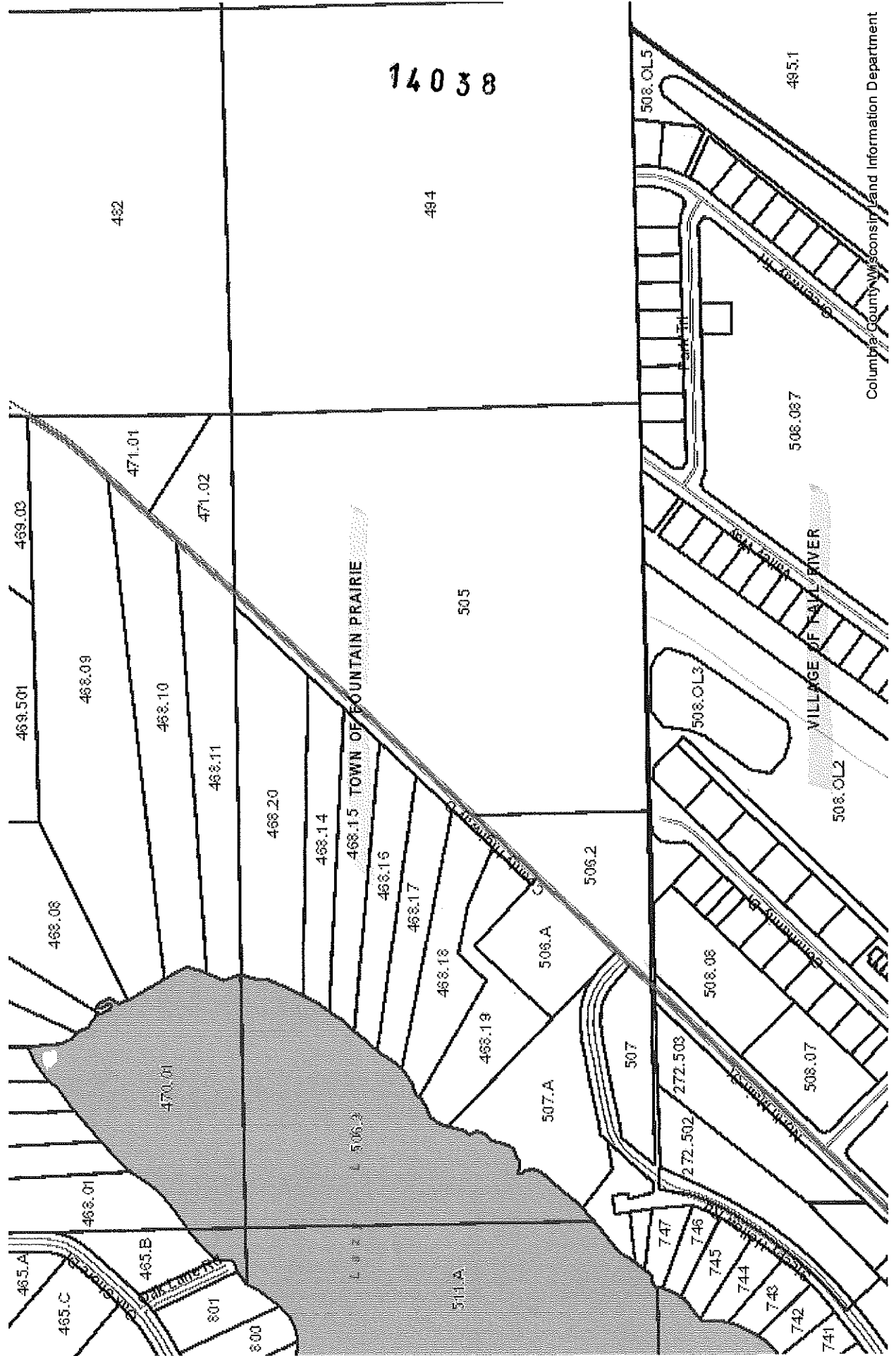
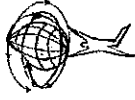

Exhibit A

14038

Legal description Parcel number 505 and 506.2, approximately 38 acres.

All that part of the North  $\frac{1}{2}$  of the Northeast  $\frac{1}{4}$  of Section 26, Township 11  
North, Range 12 East, Town of Fountain Prairie, Columbia County,  
Wisconsin, lying Southeasterly of the centerline of County Highway D.

TOWN OF FOUNTAIN PRAIRIE  
C/O LINDA HENNING, TREAS  
P O BOX 16  
FALL RIVER, WI 53932

STATE OF WISCONSIN  
**2016 Real Estate Tax Bill**  
Town of Fountain Prairie  
Columbia County

Benck, Carl T  
Benck, Susan M

Parcel Number: 11014 505  
Bill Number: 810950



14038

**Full Payment of:** \$ **251.37**  
**Or First Installment of:** \$ **125.69**  
**Due on or Before:** **January 31, 2017**  
**Make Check Payable to:** **Town of Fountain Prairie**

Please Write in the  
Amount Enclosed

\$

810950/11014 505  
CARL T BENCK  
BENCK, SUSAN M  
W1250 COUNTY ROAD Z  
FALL RIVER WI 53932

Please inform Treasurer of address changes

Tear at Perforation: Return Top Portion With Payment

2016 Real Property Tax Bill

Town of Fountain Prairie

Parcel #11014 505

Assessed Value Land 12,600	Assessed Value Improvements 0	Total Assessed Value 12,600	Ave. Assmt Ratio 0.978560884	Net. Assessed Value Ratio (Does NOT Reflect Credits) 0.01995051		
Est. Fair Mkt. Land See Reverse, Use Value Assessment	Est. Fair Mkt. Improvements See Reverse, Use Value Assessment	Est. Fair Mkt See Reverse, Use Value Assessment	<input type="checkbox"/> A star in this box means unpaid prior years taxes	Schools taxes reduced by school levy tax credit 19.28		
Taxing Jurisdiction		2015 Est. State Aids Allocated Tax District	2016 Est. State Aids Allocated Tax District	2015 Net Tax	2016 Net Tax	% Tax Change
State of Wisconsin		0	0	2.11	2.17	2.8%
Columbia County		74,847	73,941	65.31	66.93	2.5%
Town of Fountain Prairie		117,265	116,929	59.76	60.43	1.1%
Fall River School		1,269,933	1,334,123	100.02	109.49	9.5%
MATC		96,649	88,006	11.53	12.35	7.1%
<b>Total</b>		<b>1,558,694</b>	<b>1,612,999</b>	<b>238.73</b>	<b>251.37</b>	<b>5.3%</b>
			First Dollar Credit	0.00	0.00	0.0%
			Lottery and Gaming Credit	0.00	0.00	0.0%
			Net Property Tax	238.73	251.37	5.3%
When paying on or before January 31, 2017 Make Check Payable to: TOWN OF FOUNTAIN PRAIRIE C/O LINDA HENNING, TREAS P O BOX 16 FALL RIVER, WI 53932	Full Payment Due On or Before January 31, 2017 <b>\$251.37</b>		O T H E R			
	First Installment Due On or Before January 31, 2017 <b>\$125.69</b>					
When paying after January 31, 2017 Make Check Payable to: Columbia County Treasurer PO Box 198 Portage, WI 53901	Second Installment Due On or Before July 31, 2017 <b>\$125.68</b>					
		Payments after 1/31 can be made to Columbia County Using: <a href="http://www.co.columbia.wi.us">www.co.columbia.wi.us</a> <small>There will be a nominal fee charged for this service</small>		<b>TOTAL DUE FOR FULL PAYMENT</b> <b>PAY BY January 31, 2017</b> <b>\$251.37</b>		

IMPORTANT: For recorded legal description contact the Register of Deeds. See reverse side for more information.

Sec. 26, T11N, R12E 34.000 ac  
NE 1/4 OF NE 1/4 EXC LAKE DISTRICT LOC NW OF HWY  
D

Warning: If not paid by due date, installment option is lost and total  
tax is delinquent and subject to interest & penalty (See Reverse).

Bill Number: 810950



FOR INFORMATION PURPOSES ONLY • Voter Approved Temporary Tax Increases

Taxing Jurisdiction	Total Additional Taxes	Total Additional Taxes Applied to Property	Year Increase Ends	Taxing Jurisdiction	Total Additional Taxes	Total Additional Taxes Applied to Property	Year Increase Ends
---------------------	---------------------------	---	-----------------------	---------------------	---------------------------	---	-----------------------



TOWN OF FOUNTAIN PRAIRIE  
C/O LINDA HENNING, TREAS  
P O BOX 16  
FALL RIVER, WI 53932

STATE OF WISCONSIN  
**2016 Real Estate Tax Bill**  
Town of Fountain Prairie  
Columbia County

Benck, Carl T  
Benck, Susan M

Parcel Number: 11014 506.2  
Bill Number: 810952

**COPY**



14038

**Full Payment of:** \$ **21.95**  
**Or First Installment of:** \$ 21.95  
**Due on or Before:** January 31, 2017  
**Make Check Payable to:** Town of Fountain Prairie

Please Write in the  
Amount Enclosed

\$

810952/11014 506.2  
CARL T BENCK  
BENCK, SUSAN M  
W1250 COUNTY ROAD Z  
FALL RIVER WI 53932

Please inform Treasurer of address changes

Tear at Perforation: Return Top Portion With Payment

**2016 Real Property Tax Bill**

Town of Fountain Prairie

Parcel #11014 506.2

Assessed Value Land 1,100	Assessed Value Improvements 0	Total Assessed Value 1,100	Ave. Assmt Ratio 0.978560884	Net. Assessed Value Ratio (Does NOT Reflect Credits) 0.01995051		
Est. Fair Mkt. Land See Reverse, Use Value Assessment	Est. Fair Mkt. Improvements	Est. Fair Mkt	<input type="checkbox"/> A star in this box means unpaid prior years taxes	Schools taxes reduced by school levy tax credit 1.68		
Taxing Jurisdiction		2015 Est. State Aids Allocated Tax District	2016 Est. State Aids Allocated Tax District	2015 Net Tax	2016 Net Tax	% Tax Change
State of Wisconsin		0	0	0.17	0.19	11.8%
Columbia County		74,847	73,941	5.18	5.84	12.7%
Town of Fountain Prairie		117,265	116,929	4.74	5.28	11.4%
Fall River School		1,269,933	1,334,123	7.94	9.56	20.4%
MATC		96,649	88,006	0.92	1.08	17.4%
<b>Total</b>		<b>1,558,694</b>	<b>1,612,999</b>	<b>18.95</b>	<b>21.95</b>	<b>15.8%</b>
			First Dollar Credit	0.00	0.00	0.0%
			Lottery and Gaming Credit	0.00	0.00	0.0%
			Net Property Tax	18.95	21.95	15.8%
When paying on or before January 31, 2017 Make Check Payable to: TOWN OF FOUNTAIN PRAIRIE C/O LINDA HENNING, TREAS P O BOX 16 FALL RIVER, WI 53932		Full Payment Due On or Before January 31, 2017 <b>\$21.95</b>		O T H E R		
		Full Payment Due On or Before January 31, 2017 <b>\$21.95</b>				
When paying after January 31, 2017 Make Check Payable to: Columbia County Treasurer PO Box 198 Portage, WI 53901		Payments after 1/31 can be made to Columbia County Using: <a href="http://www.co.columbia.wi.us">www.co.columbia.wi.us</a> <small>There will be a nominal fee charged for this service</small>				
				<b>TOTAL DUE FOR FULL PAYMENT</b> PAY BY January 31, 2017 <b>\$21.95</b>		

IMPORTANT: For recorded legal description contact the Register of Deeds. See reverse side for more information.

Sec. 26, T11N, R12E 4.010 ac  
NW1/4 NE1/4 SOUTH OF RD EXC 6.7 A V224-430 EXC  
CS1010

Warning: If not paid by due date, installment option is lost and total  
tax is delinquent and subject to interest & penalty (See Reverse).

Bill Number: 810952



**FOR INFORMATION PURPOSES ONLY - Voter Approved Temporary Tax Increases**

Taxing Jurisdiction	Total Additional Taxes	Total Additional Taxes Applied to Property	Year Increase Ends	Taxing Jurisdiction	Total Additional Taxes	Total Additional Taxes Applied to Property	Year Increase Ends
---------------------	---------------------------	---	-----------------------	---------------------	---------------------------	---	-----------------------

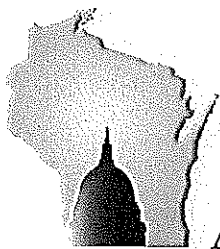

**WISCONSIN DEPARTMENT OF  
ADMINISTRATION**

**SCOTT WALKER**

GOVERNOR

**SCOTT A. NEITZEL**

SECRETARY

**Municipal Boundary Review**

PO Box 1645, Madison WI 53701

Voice (608) 264-6102 Fax (608) 264-6104

Email: [wimunicipalboundaryreview@wi.gov](mailto:wimunicipalboundaryreview@wi.gov)

Web: <http://doa.wi.gov/municipalboundaryreview/>

July 24, 2017

PETITION FILE NO. 14038

MARIE ABEGGLEN, CLERK  
VILLAGE OF FALL RIVER  
PO BOX 37  
FALL RIVER, WI 53932-0035

LINDA HENNING, CLERK  
TOWN OF FOUNTAIN PRAIRIE  
PO BOX 16  
FALL RIVER, WI 53932

Subject: CARL & SUSAN BENCK ANNEXATION

Section 66.0217 (6), Wis. Stats., provides that the annexation of lands to cities and villages within a county having a population of 50,000 or more shall be reviewed by the Department of Administration in order to determine if the proposed annexation is in the public interest or against the public interest. The proposed annexation from the TOWN OF FOUNTAIN PRAIRIE to the VILLAGE OF FALL RIVER (see attached description) must be reviewed pursuant to the statute.

To assist us in making this determination, we urge that you promptly supply the data requested on the enclosed questionnaire (where possible) and return the questionnaire to the department.

The purpose of this questionnaire is to assist the department in determining "Whether the governmental services, including zoning, to be supplied to the territory could clearly be better supplied by the town...." The statute further stipulates that the department shall study the "shape of the proposed annexation and the homogeneity of the territory with the annexing municipality." In addition, we would appreciate receiving from you any comments or information bearing on governmental services or shape and homogeneity that would indicate whether the annexation is in or against the public interest.

Please return the questionnaire as soon as possible so that the information can be reviewed prior to the department's statutory deadline of August 14, 2017. Direct any questions and comments to Erich Schmidtke at (608) 264-6102. Thank you for your cooperation.

For additional information on annexation or other land use issues, visit our web site at <http://doa.wi.gov/municipalboundaryreview/>.

Sincerely,

Erich Schmidtke

Enclosures

# Annexation Review Questionnaire

Wisconsin Department of Administration

WI Dept. of Administration  
Municipal Boundary Review  
101 E. Wilson Street, 9th Floor  
Madison WI 53703  
608-264-6102 Fax: 608-264-6104  
[wimunicipalboundaryreview@wi.gov](mailto:wimunicipalboundaryreview@wi.gov)  
<http://doa.wi.gov/municipalboundaryreview/>

Petitioner: **Carl & Susan Benck**

Petition Number: **14038**

1. Territory to be annexed: From **TOWN OF FOUNTAIN PRAIRIE** To **VILLAGE OF FALL RIVER**

2. Area (Acres): **38.01**

3. Pick one: ☒ Property Tax Payments

OR ☐ Boundary Agreement

a. Annual town property tax on territory to be annexed:

\$ **465.71**

a. Title of boundary agreement \_\_\_\_\_

b. Year adopted \_\_\_\_\_

b. Total that will be paid to Town

(annual tax multiplied by 5 years): **328.55**

c. Participating jurisdictions \_\_\_\_\_

d. Statutory authority (pick one)

c. Paid by: ☐ Petitioner ☐ City ☒ Village

☐ s.66.0307 ☐ s.66.0225 ☐ s.66.0301

☐ Other: \_\_\_\_\_

4. Resident Population: Electors: \_\_\_\_\_ Total: **None**

5. Approximate **present land use** of territory:

Residential: \_\_\_\_\_% Recreational: \_\_\_\_\_% Commercial: \_\_\_\_\_% Industrial: \_\_\_\_\_%

Undeveloped: \_\_\_\_\_% **Agriculture - 75%**

6. If territory is undeveloped, what is the **anticipated use**?

Residential: \_\_\_\_\_% Recreational: \_\_\_\_\_% Commercial: \_\_\_\_\_% Industrial: \_\_\_\_\_%

Other: **25% Wetlands - Unuseable**

Comments: \_\_\_\_\_

7. Has a ☐ preliminary or ☐ final plat been submitted to the Plan Commission: ☐ Yes ☒ No

Plat Name: \_\_\_\_\_

8. What is the **nature of land use adjacent** to this territory in the city or village?

**Residential - Condominiums & assisted living facility**

In the town?: **Agriculture**

9. What are the **basic service needs** that precipitated the request for annexation?

☐ Sanitary sewer ☐ Water supply ☐ Storm sewers

☐ Police/Fire protection ☐ EMS ☒ Zoning

Other: \_\_\_\_\_

RECEIVED

AUG - 4 2017

Municipal Boundary Review  
Wisconsin Dept. of Admin.

10. Is the city/village or town capable of providing needed utility services?

City/Village ☒ Yes ☐ No

Town ☐ Yes ☒ No

If yes, approximate timetable for providing service:

Sanitary Sewers immediately

or, write in number of years.

City/Village

☒ 3

Town

☐

Water Supply immediately

or, write in number of years.

☒ 3

☐

Will provision of sanitary sewers and/or water supply to the territory proposed for annexation require capital expenditures (i.e. treatment plant expansion, new lift stations, interceptor sewers, wells, water storage facilities)?

☒ Yes ☐ No

If yes, identify the nature of the anticipated improvements and their probable costs: \_\_\_\_\_

11. Planning:

a. Do you have a comprehensive plan for the City/Village/Town? ☒ Yes ☐ No

Is this annexation consistent with your comprehensive plan? ☐ Yes ☒ No

Describe: Comprehensive Plan does not designate this area for multiple homes. The land use is agriculture

b. Annual appropriation for planning? \$ \_\_\_\_\_

c. How is the annexation territory now zoned? A-1 Agriculture

d. How will the land be zoned and used if annexed? Residential

12. Other relevant information and comments bearing upon the public interest in the annexation:

Annexation of this property for residential homes, would add to deficiency for producing foods, crops, etc for animals raised for food.

Prepared by: ☒ Town ☐ City ☐ Village

Name: Linda Henning

Email: ltp@prairietown@centurytel.net

Phone: (920) 484-3707

Date: 8/1/2017

Please RETURN PROMPTLY to:

wimunicipalboundaryreview@wi.gov

Municipal Boundary Review

PO Box 1645, Madison WI 53701

Fax: (608) 264-6104

# Annexation Review Questionnaire

Wisconsin Department of Administration

WI Dept. of Administration  
Municipal Boundary Review  
101 E. Wilson Street, 9<sup>th</sup> Floor  
Madison WI 53703  
608-264-6102 Fax: 608-264-6104  
wimunicipalboundaryreview@wi.gov  
http://doa.wi.gov/municipalboundaryreview/

14038

Petitioner:

Carl T. + Susan M. Benck

Petition Number:

1. Territory to be annexed:

From Town of:

To City/Village of:

Pn. 505 + 506.2

Fountain Prairie

Fall River

2. Area (Acres): 38

3. Pick one: ☒ Property Tax Payments

OR

☐ Boundary Agreement

a. Annual town property tax on territory to be annexed:

\$ 273.32

a. Title of boundary agreement \_\_\_\_\_

b. Year adopted \_\_\_\_\_

b. Total that will be paid to Town

(annual tax multiplied by 5 years): 1,366.60

c. Participating jurisdictions

c. Paid by: ☒ Petitioner ☐ City ☐ Village

d. Statutory authority (pick one)

☐ s. 66.0307

☐ s. 66.0225

☐ s. 66.0301

☐ Other:

4. Resident Population: Electors: Total: 0

5. Approximate present land use of territory:

Residential: \_\_\_\_\_%

Recreational: \_\_\_\_\_%

Commercial: \_\_\_\_\_%

Industrial: \_\_\_\_\_%

Undeveloped: 100%

6. If territory is undeveloped, what is the anticipated use?

Residential: 100%  
81%

Recreational: \_\_\_\_\_%

Commercial: \_\_\_\_\_%

Industrial: \_\_\_\_\_%

Other: R1 Single Family

Comments:

7. Has a ☐ preliminary or ☐ final plat been submitted to the Plan Commission: ☐ Yes ☒ No

Plat Name: \_\_\_\_\_

8. What is the nature of land use adjacent to this territory in the city or village? Residential

In the town?: Residential + Farm

9. What are the basic service needs that precipitated the request for annexation?

☒ Sanitary sewer

☒ Water supply

☒ Storm sewers

☒ Police/Fire protection

☒ EMS

☒ Zoning

Other:

# Annexation Review Questionnaire

Wisconsin Department of Administration

WI Dept. of Administration  
Municipal Boundary Review  
101 E. Wilson Street, 9th Floor  
Madison WI 53703  
608-264-6102 Fax: 608-264-6104  
[wimunicipalboundaryreview@wi.gov](mailto:wimunicipalboundaryreview@wi.gov)  
<http://doa.wi.gov/municipalboundaryreview/>

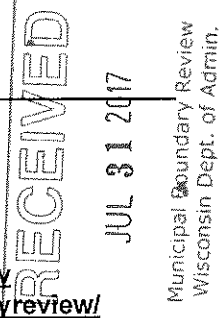

Petitioner: **Carl & Susan Benck**

Petition Number: **14038**

1. Territory to be annexed: From **TOWN OF FOUNTAIN PRAIRIE** To **VILLAGE OF FALL RIVER**

2. Area (Acres): **38.010**

3. Pick one: ☒ Property Tax Payments

OR ☐ Boundary Agreement

a. Annual town property tax on territory to be annexed:

\$ **273.32**

a. Title of boundary agreement \_\_\_\_\_

b. Total that will be paid to Town

(annual tax multiplied by 5 years): **1,366.60**

b. Year adopted \_\_\_\_\_

c. Participating jurisdictions \_\_\_\_\_

c. Paid by: ☒ Petitioner ☐ City ☐ Village

d. Statutory authority (pick one)

☐ Other: \_\_\_\_\_

☐ s.66.0307 ☐ s.66.0225 ☐ s.66.0301

4. Resident Population: Electors: **0** Total: **0**

5. Approximate **present land use** of territory:

Residential: \_\_\_\_\_% Recreational: \_\_\_\_\_% Commercial: \_\_\_\_\_% Industrial: \_\_\_\_\_%

Undeveloped: **100** %

6. If territory is undeveloped, what is the **anticipated use**?

Residential: **100** % Recreational: \_\_\_\_\_% Commercial: \_\_\_\_\_% Industrial: \_\_\_\_\_%

Other: \_\_\_\_\_%

Comments: \_\_\_\_\_

7. Has a ☐ preliminary or ☐ final plat been submitted to the Plan Commission: ☐ Yes ☒ No

Plat Name: \_\_\_\_\_

8. What is the **nature of land use adjacent** to this territory in the city or village?

**Residential**

In the town?: **Agricultural and Residential**

9. What are the **basic service needs** that precipitated the request for annexation?

☒ Sanitary sewer

☒ Water supply

☒ Storm sewers

☒ Police/Fire protection

☒ EMS

☒ Zoning

Other \_\_\_\_\_

10. Is the city/village or town capable of providing needed utility services?

City/Village ☒ Yes ☐ No

Town ☐ Yes ☒ No

If yes, approximate timetable for providing service:

City/Village

Town

Sanitary Sewers immediately

☒

☐

or, write in number of years.

1-2

\_\_\_\_\_

Water Supply immediately

☒

☐

or, write in number of years.

1-2

\_\_\_\_\_

Will provision of sanitary sewers and/or water supply to the territory proposed for annexation require capital expenditures (i.e. treatment plant expansion, new lift stations, interceptor sewers, wells, water storage facilities)?

☐ Yes ☒ No

If yes, identify the nature of the anticipated improvements and their probable costs: \_\_\_\_\_

11. Planning:

a. Do you have a comprehensive plan for the City/Village/Town? ☒ Yes ☐ No

Is this annexation consistent with your comprehensive plan? ☒ Yes ☐ No

Describe: The future use for the area to be annexed is: Mixed Residential

b. Annual appropriation for planning? \$ \_\_\_\_\_

c. How is the annexation territory now zoned? Agriculture

d. How will the land be zoned and used if annexed? Residential

12. Other relevant information and comments bearing upon the public interest in the annexation:

Prepared by: ☐ Town ☐ City ☒ Village

Name: Marie Abegglen

Email: marie@ulgfallriver.com

Phone: 920-484-3525

Date: 07-26-2017

Please **RETURN PROMPTLY** to:

wimunicipalboundaryreview@wi.gov

Municipal Boundary Review

PO Box 1645, Madison WI 53701

Fax: (608) 264-6104



N<sup>o</sup> XI

Range N<sup>o</sup> XII E. 4<sup>th</sup>

Mer. Wis.





# FOUNTAIN PRAIRIE

T.11N.-R.12E.

SEE PAGE 42

Refer to page 66 for keyed parcels

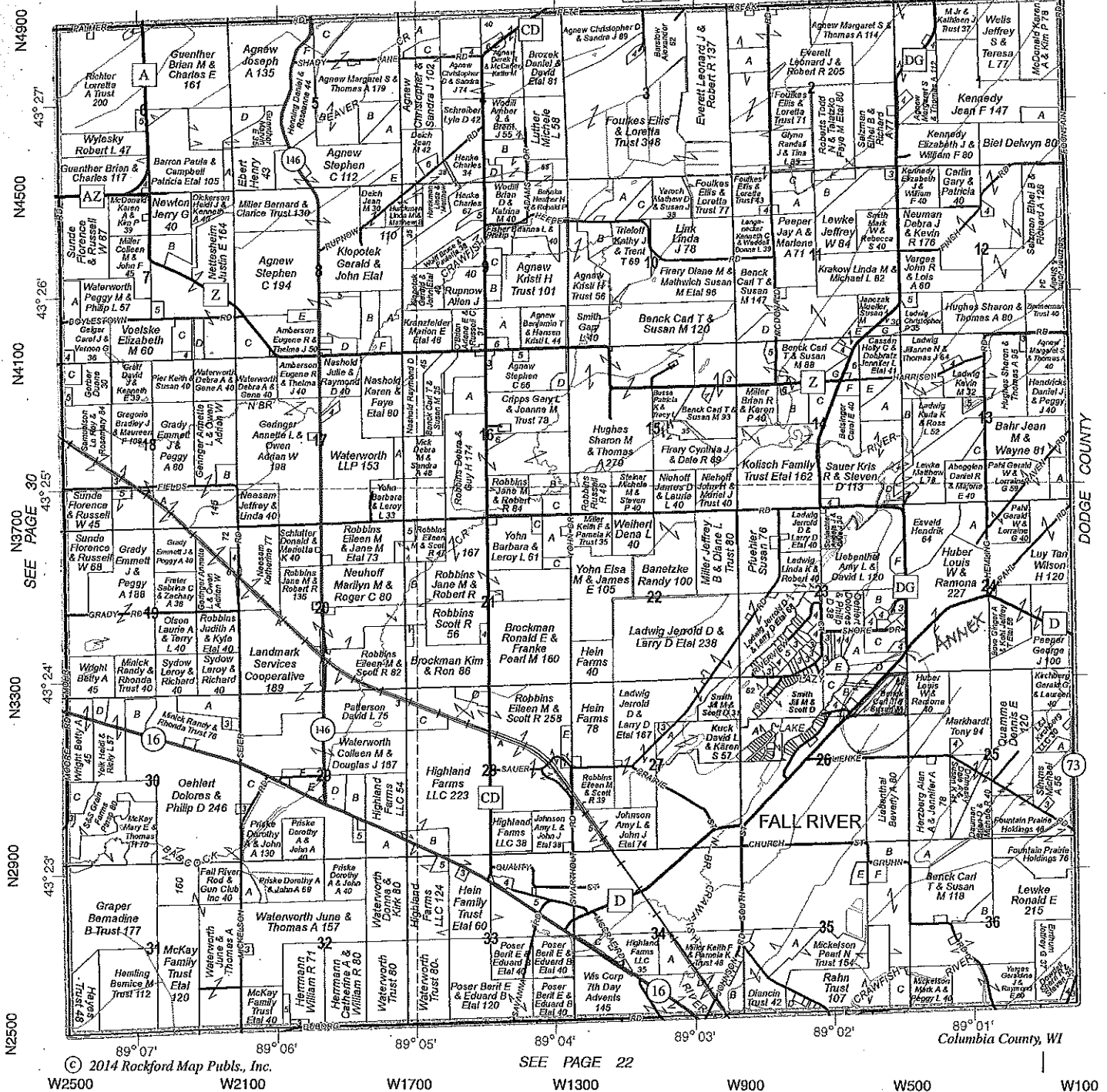

© 2014 Rockford Map Pubs., Inc.  
W2500 W2100

SEE PAGE 22

W1700

W1300

W900

W500

W100

## Roberts - Hill Insurance

JOHN — JIM

AUTO — FARM — BUSINESS — HOME — LIFE — HEALTH  
CROP INSURANCE

Rio, Wisconsin 53960

Phone: (920) 992-3333 or (608) 429-2438



PROFESSIONAL  
INSURANCE  
AGENT

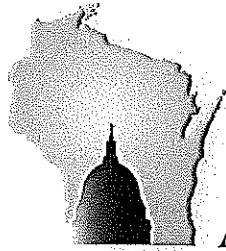

**WISCONSIN DEPARTMENT OF  
ADMINISTRATION**

SCOTT WALKER  
GOVERNOR  
SCOTT A. NEITZEL  
SECRETARY

**Municipal Boundary Review**  
PO Box 1645, Madison WI 53701  
Voice (608) 264-6102 Fax (608) 264-6104  
Email: [wimunicipalboundaryreview@wi.gov](mailto:wimunicipalboundaryreview@wi.gov)  
Web: <http://doa.wi.gov/municipalboundaryreview/>

August 14, 2017

PETITION FILE NO. 14038

MARIE ABEGGLEN, CLERK  
VILLAGE OF FALL RIVER  
PO BOX 37  
FALL RIVER, WI 53932-0035

LINDA HENNING, CLERK  
TOWN OF FOUNTAIN PRAIRIE  
PO BOX 16  
FALL RIVER, WI 53932

Subject: CARL & SUSAN BENCK ANNEXATION

The proposed annexation submitted to our office on July 24, 2017, has been reviewed and found to be in the public interest. In determining whether an annexation is in the public interest, s. 66.0217 (6), Wis. Stats. requires the Department to examine "[t]he shape of the proposed annexation and the homogeneity of the territory with the annexing village or city...." so as, to ensure the resulting boundaries are rational and compact. The statute also requires the Department to consider whether the annexing city or village can provide needed municipal services to the territory. The subject petition is for territory that is reasonably shaped and contiguous to the **VILLAGE OF FALL RIVER**, which is able to provide needed municipal services.

Note: The territory being annexed must be further described in the annexation ordinance by metes and bounds, commencing from a monumented corner of a 1/4 section in which the territory lies (ref: s. 66.0217 (1) (c), Wis. Stats.).

The Department reminds clerks of annexing municipalities of the requirements of s. 66.0217 (9)(a), Wis. Stats., which states:

"The clerk of a city or village which has annexed shall file immediately with the secretary of administration a certified copy of the ordinance, certificate and plat, and shall send one copy to each company that provides any utility service in the area that is annexed. The clerk shall record the ordinance with the register of deeds and file a signed copy of the ordinance with the clerk of any affected school district..."

State and federal aids based on population and equalized value may be significantly affected through failure to file with the Department of Administration. Please file a copy of your annexing ordinance, including a statement certifying the population of the annexed territory. **Please include your MBR number 14038 with your ordinance.** Ordinance filing checklist available at <http://mds.wi.gov/>, click on "Help on How to Submit Municipal Records". Email scanned copy of required materials (color scan maps with color) to [mds@wi.gov](mailto:mds@wi.gov) or mail to: Wisconsin Department of Administration, Municipal Boundary Review, PO Box 1645, Madison WI 53701-1645.

The petition file is available for viewing at: <http://mds.wi.gov/View/Petition?ID=2109>  
Please call me at (608) 264-6102, should you have any questions concerning this annexation review.

Sincerely,

Erich Schmidtke, Municipal Boundary Review

cc: petitioner