

14062

Gritt/Turcick

14062	Date Sent	Reply	Status
Town Quest	11/6		
Muni Quest	11/6	11/6	
Prop. Lister	11/6	11/10	

TOWN OF PLYMOUTH
CITY OF PLYMOUTH
11/27/2017

OK - COMMENTS 11/22/17

Request for Annexation Review

14062

Wisconsin Department of Administration

WI Dept. of Administration
Municipal Boundary Review
101 E. Wilson Street, 9th Floor
Madison WI 53703
608-264-6102 Fax: 608-264-6104
wimunicipalboundaryreview@wi.gov
<http://doa.wi.gov/municipalboundaryreview/>

Petitioner Information

Name: **MATTHEW J. GRITT, ROBERT J. TURICIK, &
JEAN E. TURICIK**

Address: **1004 OLLIE LANE, PLYMOUTH, WI 53073**

&

1019 OLLIE LANE, PLYMOUTH, WI 53073

Email: **MATTGRITT@GMAIL.COM**

Office use only:

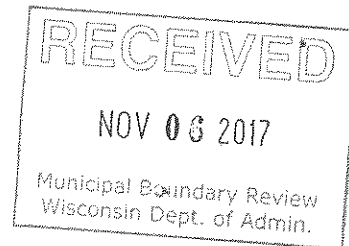

1. Town where property is located: **PLYMOUTH**

2. Petitioned City or Village: **PLYMOUTH**

3. County where property is located: **SHEBOYGAN**

4. Population of the territory to be annexed: **0**

5. Area (in acres) of the territory to be annexed: **0.45**

6. Tax parcel number(s) of territory to be annexed

(if the territory is part or all of an existing parcel): **PART OF PIN:**

59016-220130 (PARCEL A), PIN: 59016-622120 (PARCEL 1)

& PART OF PIN: 59271-822990 (PARCEL 2)

Petitioners phone:

920-254-1759

Town clerk's phone:

920-893-5713

City/Village clerk's phone:

920-893-1271

Contact Information if different than petitioner:

Representative's Name and Address:
ATTORNEY CRYSTAL H. FIEBER

HOPP NEUMANN HUMKE LLP
2124 KOHLER MEMORIAL DRIVE, SUITE
310

SHEBOYGAN, WI 53081

Phone: **920-457-8400**

E-mail: **CRYSTAL.FIEBER@HOPPLAW**

Surveyor or Engineering Firm's Name & Address:
MICHAEL L. KOBER

W6200 HILLTOP ROAD

PLYMOUTH, WI 53073

Phone: **920-892-4441**

E-mail: **KOBER.MIKE@GMAIL.COM**

Required Items to be provided with submission (to be completed by petitioner):

1. ☒ Legal Description meeting the requirements of s.66.0217 (1) (c) [see attached annexation guide]
2. ☒ Map meeting the requirements of s. 66.0217 (1) (g) [see attached annexation guide]
3. ☒ Signed Petition or Notice of Intent to Circulate is included
4. Indicate Statutory annexation method used:
 - ☒ Unanimous per s. 66.0217 (2), or,
 - OR
 - ☐ Direct by one-half approval per s. 66.0217 (3)
5. ☒ Check or money order covering review fee [see next page for fee calculation]

Annexation Review Fee Schedule

A Guide for Calculating the Fee Required by ss.16.53 (4) and 66.0217, Wis. Stats.

Required Fees

There is an initial filing fee and a variable review fee

\$200 Initial Filing Fee (required with the first submittal of all petitions)

\$200 – 2 acres or less

\$350 – 2.01 acres or more

\$200 Review Fee (required with all annexation submittals except those that consist ONLY of road right-of-way)

\$200 – 2 acres or less

\$600 – 2.01 to 10 acres

\$800 – 10.01 to 50 acres

\$1,000 – 50.01 to 100 acres

\$1,400 – 100.01 to 200 acres

\$2,000 – 200.01 to 500 acres

\$4,000 – Over 500 acres

\$400 TOTAL FEE DUE (Add the Filing Fee to the Review Fee)

Attach check or money order here, payable to: Department of Administration

THE DEPARTMENT WILL NOT PROCESS
AN ANNEXATION PETITION THAT IS NOT ACCOMPANIED
BY THE REQUIRED FEE.

THE DEPARTMENT'S 20-DAY STATUTORY REVIEW PERIOD
COMMENCES UPON RECEIPT OF THE PETITION AND REVIEW FEE

Shaded Area for Office Use Only

Date fee received: 11/6

Payee: MATT GRITT

Check Number: 1261

Check Date: 10/26

Amount: 450

ANNEXATION SUBMITTAL GUIDE

s. 66.0217 (5) THE PETITION

- ☐ State the purpose of the petition:
- Direct annexation by unanimous approval; OR
 - Direct annexation by one-half approval; OR
 - Annexation by referendum.
- ☐ Petition must be signed by:
- All owners and electors, if by unanimous approval.
 - See 66.0217 (3) (a), if by one-half approval.
 - See 66.0217 (3) (b), if by referendum.
- ☐ State the population of the land to be annexed.

14062

[It is beneficial to include Parcel ID or Tax numbers, the parcel area, and identify the annexee (Town) and annexor (Village or City) in the petition.]

s. 66.0217 (1) (c) THE DESCRIPTION

- ☐ The annexation petition must include a legal description of the land to be annexed. The land must be described by reference to the government lot, private claim, quarter-section, section, town and range in which the land lies. The land must be further described by metes and bounds commencing from a monumented corner of the section or quarter-section, or the monumented end of a private claim or federal reservation, in which the land lies; OR
- ☐ If the land is wholly and entirely within a lot or lots, or all of a block or blocks of a recorded subdivision plat or certified survey map, it must be described by reference to the lot (s) and/or block (s) therein, along with the name of the plat or the number, volume, page, and County of the certified survey map.
- ☐ The land may NOT be described only by:
- Aliquot part;
 - Reference to any other document (plat of survey, deed, etc.);
 - Exception or Inclusion;
 - Parcel ID or tax number.

s. 66.0217 (1) (g) THE MAP

- ☐ The map shall be an **accurate reflection** of the legal description of the parcel being annexed. As such, it must show:
- A tie line from the parcel to the monumented corner of the section or quarter-section, or the monumented end of a private claim or federal reservation, in which the parcel lies. The corner and monument must be identified.
 - Bearings and distances along all parcel boundaries as described.
 - All adjoining as referenced in the description.
- ☐ The map must include a **graphic scale**.
- ☐ The map must show and identify the existing municipal boundary, in relation to the parcel being annexed.

[It is beneficial to include a North arrow, and identify adjacent streets and parcels on the map.]

s. 66.0217 FILING

- ☐ The petition must be filed with the Clerk of the annexing City or Village and with the Clerk of the Town in which the land is located.
- ☐ If the annexation is by one-half approval, or by referendum, the petitioner must post notice of the proposed annexation as required by s. 66.0217 (4).
- ☐ If the lands being annexed are within a County of 50,000 or greater population, the petition must also be filed with the Department of Administration for review

[Note that no municipality within a County of 50,000 or greater population may enact an annexation ordinance prior to receiving a review determination from the Department of Administration.]



HOPP NEUMANN HUMKE^{LLP}

14062

November 3, 2017

Wisconsin Department of Administration
Municipal Boundary Review
101 East Wilson Street, 9th Floor
Madison, WI 53703

Re: Town of Plymouth/City of Plymouth Request for Annexation Review
Petitioners: Matthew J. Gritt and Robert J. & Jean E. Turicik

Ladies or Gentlemen:

Our office is assisting the City of Plymouth with an annexation request from property owners in the Town of Plymouth. Please find the following items enclosed for your review:

1. Request for Annexation Review.
2. Legal description and map meeting the requirements of Wis. Stat. §§ 66.0217(1)(c) and 66.0217(1)(g).
3. Signed Petition for direct annexation by unanimous approval.
4. Check in the amount of \$400.00.

If you have any questions or require additional information, please feel free to contact me.

Very truly yours,

A handwritten signature in black ink, appearing to read 'Crystal H. Fieber'.

Crystal H. Fieber
e-mail: crystal.fieber@hopplaw.com

CHF/ak

Enclosures

c: Matthew J. Gritt
Robert J & Jean E. Turicik
ec: Patricia Huberty, City of Plymouth Clerk/Treasurer

R:\CLIENT\12788\00001\00116866.DOC

www.hopplaw.com

Carl K. Buesing · Michael J. Bauer · J. Phil Mueller · Herbert C. Humke III · Paul A. Dirkse · Crystal H. Fieber · Oliver M. Bauer
OF COUNSEL Roland M. Neumann · William W. Moir III RETIRED Alex Hopp
H. C. Humke, 1963-2009

14062

PETITION FOR DIRECT ANNEXATION BY UNANIMOUS APPROVAL
PURSUANT TO WISCONSIN STATUTE § 66.0217(2)

We, the undersigned, constituting all of the owners of real property in the following territory of the Town of Plymouth, Sheboygan County, Wisconsin, lying contiguous to the City of Plymouth, petition the Common Council of the City of Plymouth to annex the territory as described on the attached **Exhibit A** (map and legal descriptions) to the City of Plymouth, Sheboygan County, Wisconsin:

The territory contains a population of zero (0). There are no electors residing in the territory.

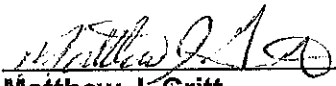
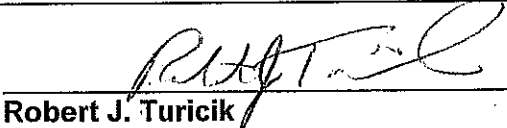
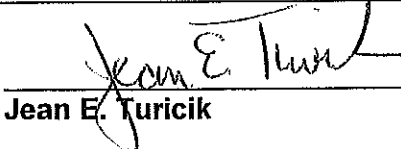
Signature of Petitioner	Date of Signing	Mark an "X" if Owner	Address or Description of Property
 Matthew J. Gritt	10/24/17	X	See Parcel A (PART of PIN: 59016-220130) and Parcel 1 (59016-622120) on the attached Exhibit A.
 Robert J. Turicik	10-26-17	X	See Parcel 2 (PART of PIN: 59271-822990) on the attached Exhibit A.
 Jean E. Turicik	10-26-17	X	See Parcel 2 (PART of PIN: 59271-822990) on the attached Exhibit A.

PARCEL 1 (R/W VACATION/DISCONTINUANCE)

Part of Olie Lane located in the SE1/4 of the SW1/4 of Section 26, Town of Plymouth, Sheboygan County, Wisconsin and described as follows:

Commence at the SW Corner of Lot 1 of a Certified Survey Map as recorded in Volume 6 at Page 189; thence N 89°52'18" E, 403.60 feet (recorded as: West, 403.61 feet) to the SE Corner of said Lot 1 and a point on the westerly right of way of Olie Lane; thence N 04°15'54" W, 50.47 feet (recorded as: N 04°08'12" West, 50.47 feet) along said westerly line to the point of beginning; thence N 04°15'54" W, 17.23 feet to a point on a curve concaved to the southeast whose radius is 75.00 feet and a chord bearing N 26°43'54" E, 77.25 feet; thence northeasterly 81.15 feet along the arc of said curve to a point on a curve concaved to the northwest whose radius is 15.00 feet and a chord bearing N 29°13'43" E, 14.31 feet; thence northeasterly 14.92 feet along the arc of said curve to a point on a curve concaved to the southeast whose radius is 50.25 feet and a chord bearing N 23°45'44" E, 39.31 feet; thence northeasterly 40.39 feet along the arc of said curve to a point on a curve concaved to the southwest whose radius is 60.00 feet and a chord bearing N 67°45'55" W, 34.70 feet; thence northwesterly 35.21 feet along the arc of said curve; thence S 89°49'30" W, 11.71 feet to a point on a curve concaved to the southeast whose radius is 60.00 feet and a chord bearing S 32°16'37" W, 94.49 feet; thence southwesterly 108.80 feet along the arc of said curve to a point on a curve concaved to the northeast whose radius is 60.00 feet and a chord bearing S 29°15'06" E, 77.75 feet; thence southeasterly 84.60 feet along the arc of said curve to the point of beginning.

PARCEL 2 (R/W VACATION/DISCONTINUANCE)

Part of Olie Lane located in the SE1/4 of the SW1/4 of Section 26, Town 15 North, Range 21 East, Town of Plymouth, Sheboygan County, Wisconsin described as follows:

Commence at the SW Corner of Lot 1 of a Certified Survey Map as recorded in Volume 6 at Page 189; thence N 89°52'18" E, 403.60 feet (recorded as: West, 403.61 feet) to the SE Corner of said Lot 1 and a point on the westerly right of way of Olie Lane; thence N 04°15'54" W, 50.47 feet (recorded as: N 04°08'12" West, 50.47 feet) along said westerly line; thence N 85°44'10" E, 50.00 feet to the point of beginning and a point on the easterly right of way line of Olie Lane and a curve concaved to the northwest whose radius is 60.00 feet and a chord bearing N 34°36'25" E, 53.56 feet; thence northeasterly 55.52 feet along the arc of said curve and right of way; thence S 89°52'18" W, 6.83 feet to a point on a curve concave to the southeast whose radius is 25.00 feet and a chord bearing S 42°48'02" W, 36.60 feet; thence southwesterly 41.06 feet along the arc of said curve; thence S 04°15'54" E, 17.24 feet to the point of beginning.

PARCEL A (MERGER AREA)

Part of the SE1/4 of the SW1/4, Section 26, Town 15 North, Range 21 East, Town of Plymouth, Sheboygan County, Wisconsin described as follows:

Commence at the SW Corner of said Section 26; thence N 89°52'18" E, 1,310.42 feet along the south line of the SW1/4 of said Section 26; thence N 00°00'38" E, 469.77 feet to the NW Corner of Lot 1 of a Certified Survey Map as recorded in Volume 6 at Page 189 and the point of beginning; thence N 00°00'38" E, 22.21 feet; thence N 89°49'30" E, 490.28 feet; thence S 00°10'54" E, 22.21 feet to a point on the northerly line of said Lot 1; thence S 89°49'30" W (recorded as: N 89°56'48" E), 490.36 feet to the point of beginning.

PARCEL B (MERGER AREA)

Part of the SE1/4 of the SW1/4, Section 26, Town 15 North, Range 21 East, Town of Plymouth, Sheboygan County, Wisconsin described as follows:

Commence at the SW Corner of said Section 26; thence N 89°52'18" E, 1,310.42 feet along the south line of the SW1/4 of said Section 26; thence N 00°00'38" E, 469.77 feet to the NW Corner of Lot 1 of a Certified Survey Map as recorded in Volume 6 at Page 189; thence N 89°49'30" E Recorded as: (N 89°56'48" E), 510.74 feet to the point of beginning; thence N 89°49'30" E (recorded as: N 89°56'48" E), 56.09 feet; thence S 00°22'39" W (recorded as: N 00°29'56" E, 100.54 feet), 100.22 feet; thence S 89°52'18" W (recorded as: East), 59.10 feet to a point on a curve concaved to the west whose radius is 50.24 and a chord bearing N 02°05'40" E, 100.25 feet; thence northerly 150.96 feet along the arc of said curve to the point of beginning.

PLAT OF SURVEY

PART OF LOT 1 OF A CERTIFIED SURVEY MAP AS RECORDED IN VOLUME 6 AT PAGE 189, AND PART OF OLLIE LANE, AND PART OF THE SE1/4 OF SECTION 26, TOWN 15 NORTH, RANGE 21 EAST, TOWN AND CITY OF PLYMOUTH, SHEBOYGAN COUNTY, WI.

UNPLATTED LANDS

UNPLATTED LANDS

S 89°49'30" W 490.28'

PARCEL A (MERGER)

10889 SQ. FT. 0.25 ACRES

412.28'

S 89°49'30" W 490.36'

S 89°49'30" W 510.74'

491.98'

22.21'

197.72'

469.77'

272.06'

1310.42'

1310.39'

2620.81'

N 89°52'18" E 89°52'18" E 403.60'

265.60'

N 89°52'18" E 89°52'18" E 403.60'

265.60'

N 89°52'18" E 89°52'18" E 403.60'

265.60'

N 89°52'18" E 89°52'18" E 403.60'

265.60'

N 89°52'18" E 89°52'18" E 403.60'

265.60'

N 89°52'18" E 89°52'18" E 403.60'

265.60'

N 89°52'18" E 89°52'18" E 403.60'

265.60'

N 89°52'18" E 89°52'18" E 403.60'

265.60'

N 89°52'18" E 89°52'18" E 403.60'

265.60'

N 89°52'18" E 89°52'18" E 403.60'

265.60'

N 89°52'18" E 89°52'18" E 403.60'

265.60'

N 89°52'18" E 89°52'18" E 403.60'

265.60'

N 89°52'18" E 89°52'18" E 403.60'

265.60'

N 89°52'18" E 89°52'18" E 403.60'

265.60'

14062

TRACT 2

C.S.M. V.3, P.243



BEARINGS ARE REFERENCED TO THE SOUTH LINE OF THE SW1/4 OF SECTION 26-15-21 WHICH BEARS: N 89°52'15" E

I hereby certify that I have made such survey and map, and that the Plat shown herein is a true and correct representation of the survey made under my responsible direction, and performed on March 8, 2017, that such survey is in accordance with the minimum standards for property surveys as identified in Chapter AE7 of the Wisconsin Administrative Code.

LEGEND:
 [Symbol] GOVERNMENT MONUMENT
 [Symbol] 1" IRON PIPE FOUND
 [Symbol] PK NAIL FOUND
 [Symbol] 1" X 18" IRON PIPE SET
 [Symbol] WEIGHING 1.13 LBS./L.F.

Michael L. Kober
 Michael L. Kober
 W6200 Hilltop Road
 Plymouth, WI 53073
 (920) 862-4441

REVISIONS:

10/06-17 A&B LEAD-IN DISTANCES
 10/06-17 F-G BEARING REVERSAL

10-6-17
 Date

SHEET 1 OF 2

LINE	BEARING	DISTANCE
L A-B	N 04°15'54" W 82.74'	15.04'
L B-C	S 04°15'54" E 286.74'	50.47'
L C-D	N 04°15'54" W 82.74'	15.04'
L D-E	S 04°15'54" E 286.74'	50.47'
L E-F	N 04°15'54" W 82.74'	15.04'
L F-G	S 04°15'54" E 286.74'	50.47'
L G-H	N 04°15'54" W 82.74'	15.04'
L H-I	S 04°15'54" E 286.74'	50.47'
L I-J	N 04°15'54" W 82.74'	15.04'
L J-K	S 04°15'54" E 286.74'	50.47'
L K-L	N 04°15'54" W 82.74'	15.04'
L L-M	S 04°15'54" E 286.74'	50.47'
L M-N	N 04°15'54" W 82.74'	15.04'
L N-O	S 04°15'54" E 286.74'	50.47'

CURVE	ARC LENGTH	RADIUS	DELTA ANGLE	CHORD BEARING	CHORD LENGTH
C B-C	81.75'	175.00'	81°59'42"	N 26°43'54" E	77.25'
C C-D	14.97'	15.00'	89°49'30"	N 29°13'43" E	14.31'
C D-E	172.73'	30.25'	82°53'47"	N 42°11'59" E	66.55'
C E-F	140.39'	50.25'	145°03'18"	N 23°45'44" E	39.31'
C F-G	150.96'	50.24'	177°09'45"	S 02°05'40" W	100.25'
C G-H	41.06'	25.00'	94°06'02"	S 42°48'02" W	36.60'
C H-I	55.92'	60.00'	53°01'15"	N 34°36'25" E	53.56'
C I-J	39.21'	60.00'	33°37'15"	N 87°45'55" W	34.70'
C J-K	106.90'	60.00'	103°53'50"	S 32°15'37" W	94.49'
C K-L	184.60'	60.00'	180°47'12"	S 25°15'06" E	77.76'



**WISCONSIN DEPARTMENT OF
ADMINISTRATION**

SCOTT WALKER

GOVERNOR

SCOTT A. NEITZEL

SECRETARY

Municipal Boundary Review

PO Box 1645, Madison WI 53701

Voice (608) 264-6102 Fax (608) 264-6104

Email: wimunicipalboundaryreview@wi.gov

Web: <http://doa.wi.gov/municipalboundaryreview/>

November 06, 2017

PETITION FILE NO. 14062

PATRICIA HUBERTY, CLERK
CITY OF PLYMOUTH
PO BOX 107
PLYMOUTH, WI 53073-0107

LAURA S RAEDER, CLERK
TOWN OF PLYMOUTH
N6152 RIVERVIEW RD
PLYMOUTH, WI 53073-3502

Subject: GRITT/TURICIK ANNEXATION

Section 66.0217 (6), Wis. Stats., provides that the annexation of lands to cities and villages within a county having a population of 50,000 or more shall be reviewed by the Department of Administration in order to determine if the proposed annexation is in the public interest or against the public interest. The proposed annexation from the TOWN OF PLYMOUTH to the CITY OF PLYMOUTH (see attached description) must be reviewed pursuant to the statute.

To assist us in making this determination, we urge that you promptly supply the data requested on the enclosed questionnaire (where possible) and return the questionnaire to the department.

The purpose of this questionnaire is to assist the department in determining "Whether the governmental services, including zoning, to be supplied to the territory could clearly be better supplied by the town...." The statute further stipulates that the department shall study the "shape of the proposed annexation and the homogeneity of the territory with the annexing municipality." In addition, we would appreciate receiving from you any comments or information bearing on governmental services or shape and homogeneity that would indicate whether the annexation is in or against the public interest.

Please return the questionnaire as soon as possible so that the information can be reviewed prior to the department's statutory deadline of November 27, 2017. Direct any questions and comments to Erich Schmidtke at (608) 264-6102. Thank you for your cooperation.

For additional information on annexation or other land use issues, visit our web site at <http://doa.wi.gov/municipalboundaryreview/>.

Sincerely,

Erich Schmidtke

Enclosures

Annexation Review Questionnaire

Wisconsin Department of Administration

WI Dept. of Administration
Municipal Boundary Review
101 E. Wilson Street, 9th Floor
Madison WI 53703
608-264-6102 Fax: 608-264-6104
wimunicipalboundaryreview@wi.gov
<http://doa.wi.gov/municipalboundaryreview/>

Petitioner: Griff/Turick

Petition Number: 14062

1. Territory to be annexed: From TOWN OF PLYMOUTH To CITY OF PLYMOUTH

2. Area (Acres): .45

3. Pick one: ☒ Property Tax Payments

OR ☐ Boundary Agreement

a. Annual town property tax on territory to be annexed:

\$ 1.46

a. Title of boundary agreement _____

b. Year adopted _____

b. Total that will be paid to Town

(annual tax multiplied by 5 years): \$7.30

c. Participating jurisdictions _____

d. Statutory authority (pick one)

c. Paid by: ☐ Petitioner ☒ City ☐ Village

☐ s.66.0307 ☐ s.66.0225 ☐ s.66.0301

☐ Other: _____

4. Resident Population: Electors: 0 Total: 0

5. Approximate present land use of territory:

Residential: 100 % Recreational: _____ % Commercial: _____ % Industrial: _____ %

Undeveloped: _____ %

6. If territory is undeveloped, what is the anticipated use?

Residential: 100 % Recreational: _____ % Commercial: _____ % Industrial: _____ %

Other: _____ %

Comments: _____

7. Has a ☐ preliminary or ☐ final plat been submitted to the Plan Commission: ☐ Yes ☒ No

Plat Name: _____

8. What is the nature of land use adjacent to this territory in the city or village?

Residential

In the town?: _____

9. What are the basic service needs that precipitated the request for annexation?

☒ Sanitary sewer ☒ Water supply ☐ Storm sewers

☐ Police/Fire protection ☐ EMS ☐ Zoning

Other: _____

10. Is the city/village or town capable of providing needed utility services?

City/Village ☒ Yes ☐ No

Town ☐ Yes ☒ No

If yes, approximate timetable for providing service:

City/Village

Town

Sanitary Sewers immediately

☒

☐

or, write in number of years. _____

Water Supply immediately

☒

☐

or, write in number of years. _____

Will provision of sanitary sewers and/or water supply to the territory proposed for annexation require capital expenditures (i.e. treatment plant expansion, new lift stations, interceptor sewers, wells, water storage facilities)?

☐ Yes ☒ No

If yes, identify the nature of the anticipated improvements and their probable costs: _____

11. Planning:

a. Do you have a comprehensive plan for the City/Village/Town?

☒ Yes ☐ No

Is this annexation consistent with your comprehensive plan?

☒ Yes ☐ No

Describe: _____

b. Annual appropriation for planning? \$ 4,000.00

c. How is the annexation territory now zoned? Right of Way - No Zoning for parcels 1 & 2. R-1 Single & Two Family Residence District for Parcel A

d. How will the land be zoned and used if annexed? residential - rural

12. Other relevant information and comments bearing upon the public interest in the annexation: _____

Prepared by: ☐ Town ☒ City ☐ Village

Name: Patricia Huberty

Email: phuberty@plymouthgov.com

Phone: 920-893-3739

Date: 11-15-2017

Please **RETURN PROMPTLY** to:

wimunicipalboundaryreview@wi.gov

Municipal Boundary Review

PO Box 1645, Madison WI 53701

Fax: (608) 264-6104

Petition # 14062

REAL PROPERTY LISTERS ANNEXATION REVIEW

1. Territory to be annexed: <u>parcel 1 & parcel A (Griff)</u> <u>parcel 2 (Turicik)</u>	From Town of: <u>Plymouth</u>	To City Village of: <u>Plymouth</u>
--	----------------------------------	---

2. Checklist: (Y) Yes; (N) No; (NA) Not applicable; (NC) Not checked

Location and Position

- Y (1) Location description by government lot, recorded private claim, 1/4 - 1/4 section, section, township, range and county
- Y (2) Contiguous with existing village/city boundaries
- N (3) Creates an island area in Township (completely surrounded by city)
- N (4) Creates an island area in City (completely surrounded by town)

Petition and Map Information

- Y (1) Identify owner(s) of annexed land
- Y (2) Identify parcel ID numbers included in annexation
- Y (3) Identify parcel ID numbers being split by annexation
- Y (4) North arrow
- Y (5) Graphic scale
- Y (6) Streets and Highways shown and identified
- Y (7) Legend
- Y (8) Total area/acreage of annexation

3. Other relevant information and comments:

Prepared by:
Title:
Phone:
Date:

Peggy Armstrong
CDT III
920.459.3015
11.10.17

Please RETURN PROMPTLY to:
Municipal Boundary Review
101 E. Wilson Street, 9th Floor
Madison, WI 53702-0001
(608) 264-6102 (608) 267-6917 FAX
wimunicipalboundaryreview@wi.gov

N^o XV. Range N^o XII E. 4th Mer. Wis.

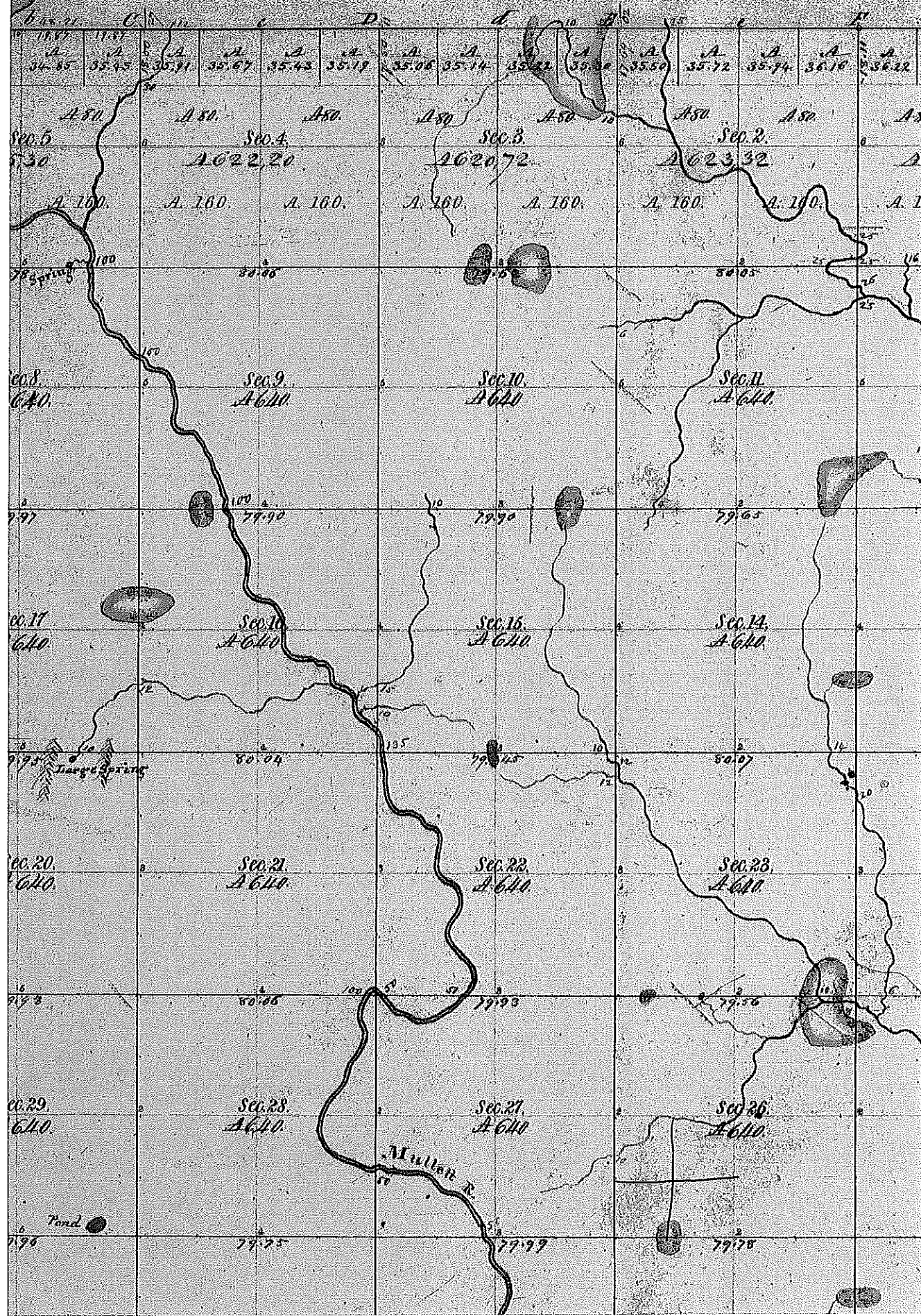

59016220130

59016220110

59271822986

59016220120

Section 26

Olie Ln

59271822990

59271821039

59016220150

59271822985

59271822984

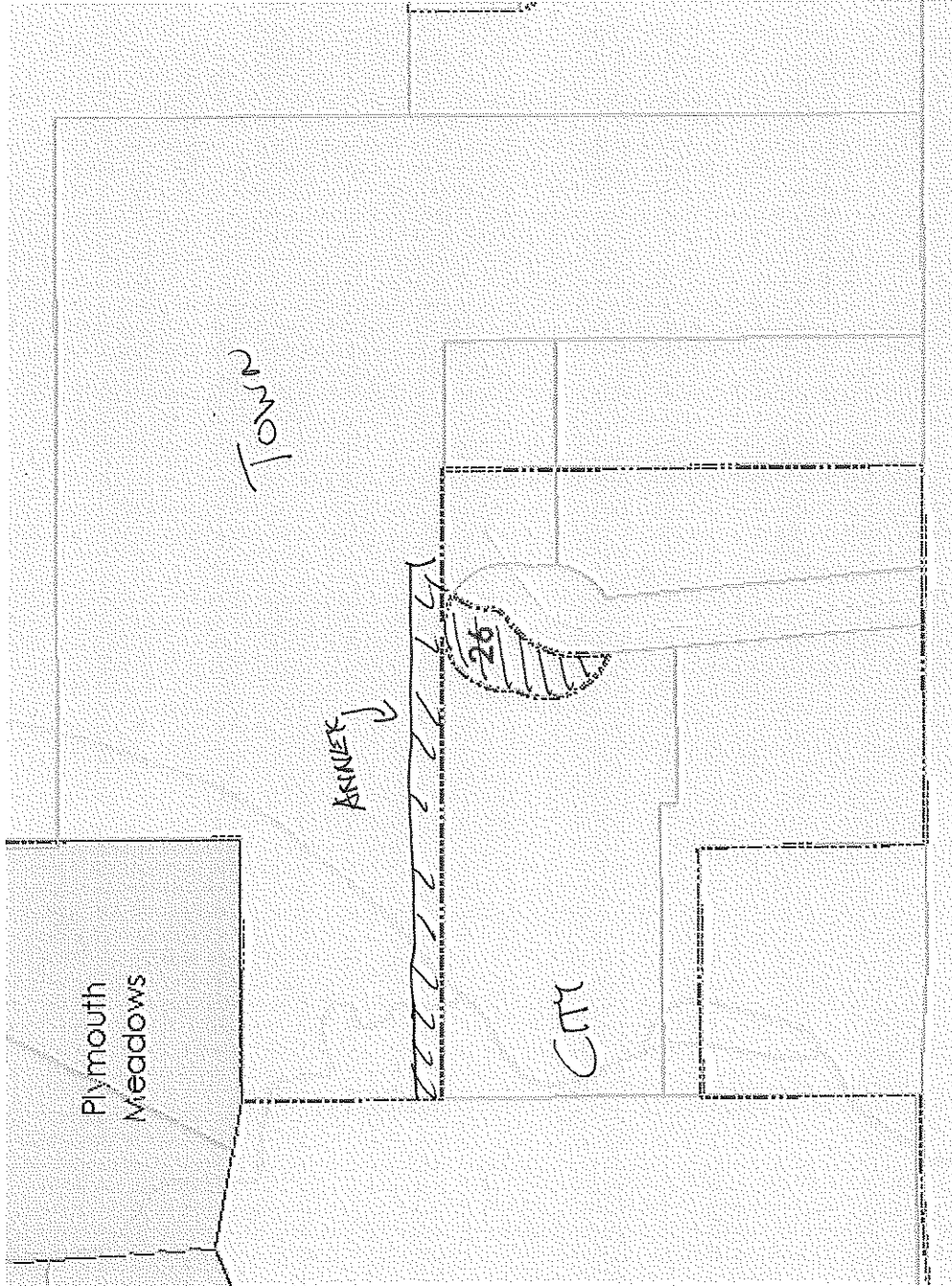

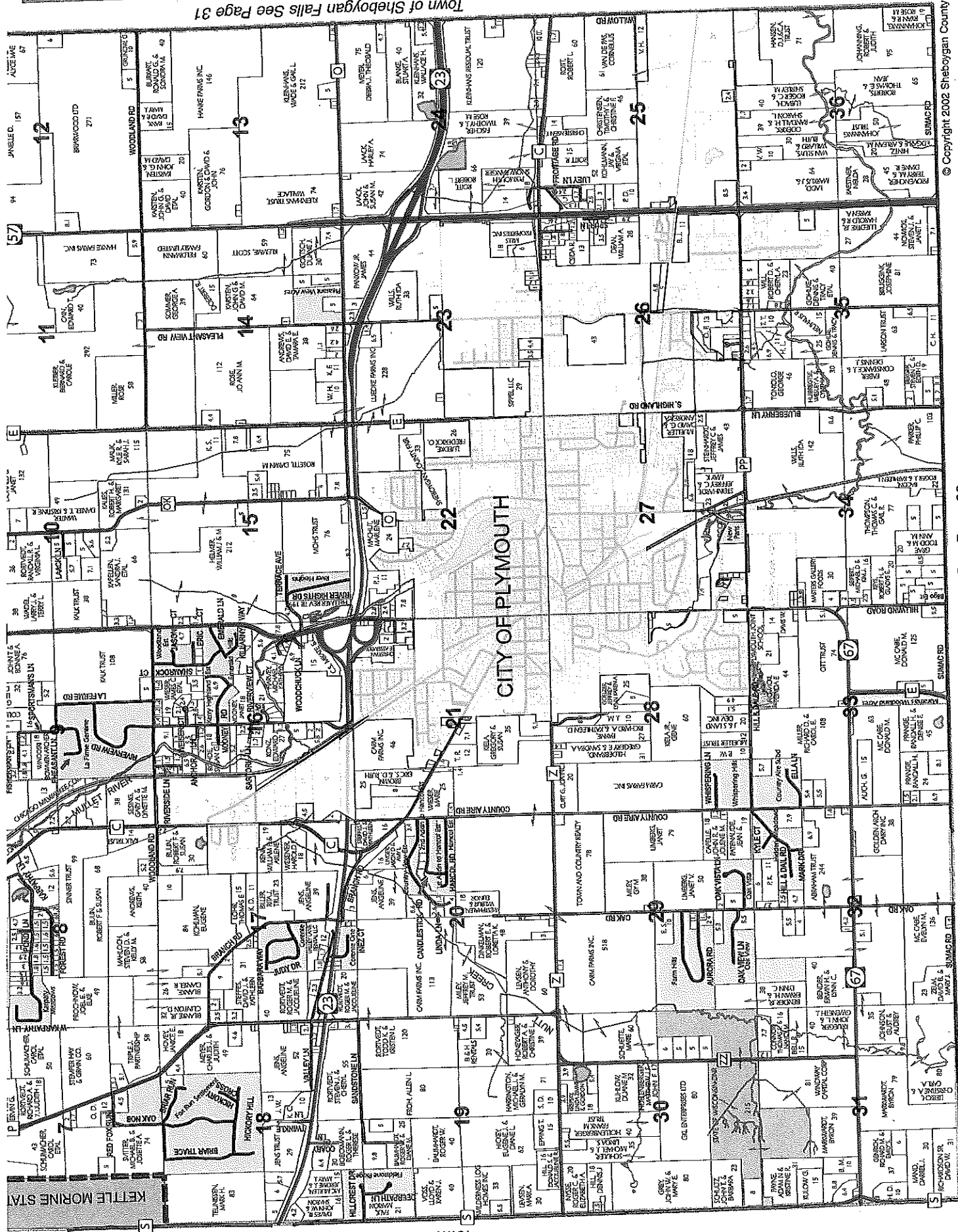



**WISCONSIN DEPARTMENT OF
ADMINISTRATION**

SCOTT WALKER

GOVERNOR

SCOTT A. NEITZEL

SECRETARY

Municipal Boundary Review

PO Box 1645, Madison WI 53701

Voice (608) 264-6102 Fax (608) 264-6104

Email: wimunicipalboundaryreview@wi.gov

Web: <http://doa.wi.gov/municipalboundaryreview/>

November 27, 2017

PETITION FILE NO. 14062

PATRICIA HUBERTY, CLERK
CITY OF PLYMOUTH
PO BOX 107
PLYMOUTH, WI 53073-0107

LAURA S RAEDER, CLERK
TOWN OF PLYMOUTH
N6152 RIVERVIEW RD
PLYMOUTH, WI 53073-3502

Subject: GRITT/TURICIK ANNEXATION

The proposed annexation submitted to our office on November 06, 2017, has been reviewed and found to be in the public interest. In determining whether an annexation is in the public interest, s. 66.0217 (6), Wis. Stats. requires the Department to examine "[t]he shape of the proposed annexation and the homogeneity of the territory with the annexing village or city..." so as, to ensure the resulting boundaries are rational and compact. The statute also requires the Department to consider whether the annexing city or village can provide needed municipal services to the territory. The subject petition is for territory that is reasonably shaped and contiguous to the **CITY OF PLYMOUTH**, which is able to provide needed municipal services.

Note: The scale map included with the annexation ordinance must clearly identify the territory being annexed and the municipal boundary as it exists prior to the annexation (ref: s. 66.0217 (1) (g), Wis. Stats.).

The Department reminds clerks of annexing municipalities of the requirements of s. 66.0217 (9)(a), Wis. Stats., which states:

"The clerk of a city or village which has annexed shall file immediately with the secretary of administration a certified copy of the ordinance, certificate and plat, and shall send one copy to each company that provides any utility service in the area that is annexed. The clerk shall record the ordinance with the register of deeds and file a signed copy of the ordinance with the clerk of any affected school district..."

State and federal aids based on population and equalized value may be significantly affected through failure to file with the Department of Administration. Please file a copy of your annexing ordinance, including a statement certifying the population of the annexed territory. **Please include your MBR number 14062 with your ordinance.** Ordinance filing checklist available at <http://mds.wi.gov/>, click on "Help on How to Submit Municipal Records". Email scanned copy of required materials (color scan maps with color) to mds@wi.gov or mail to: Wisconsin Department of Administration, Municipal Boundary Review, PO Box 1645, Madison WI 53701-1645.

The petition file is available for viewing at: <http://mds.wi.gov/View/Petition?ID=2133>
Please call me at (608) 264-6102, should you have any questions concerning this annexation review.

Sincerely,

Erich Schmidtke, Municipal Boundary Review

cc: petitioner