

# Request for Annexation Review

Wisconsin Department of Administration

WI Dept. of Administration  
Municipal Boundary Review  
101 E. Wilson Street, 9<sup>th</sup> Floor  
Madison WI 53703  
608-264-6102 Fax: 608-264-6104  
[wimunicipalboundaryreview@wi.gov](mailto:wimunicipalboundaryreview@wi.gov)  
<http://doa.wi.gov/municipalboundaryreview/>

## Petitioner Information

Name: LEVI & RACHELLE KRUIT

Address: 4012 LA SALLE ST  
Eau Claire, WI 54703

Email: rkb9548@gmail.com

Office use only:

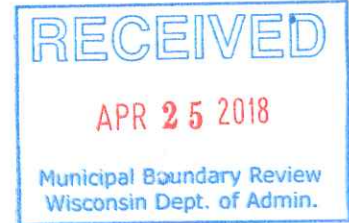

1. Town where property is located: SEYMOUR
2. Petitioned City or Village: SEYMOUR / EAU CLAIRE
3. County where property is located: EAU CLAIRE
4. Population of the territory to be annexed: 0
5. Area (in acres) of the territory to be annexed: 2 ACRES
6. Tax parcel number(s) of territory to be annexed  
(if the territory is part or all of an existing parcel):

Petitioners phone:

Town clerk's phone:

City/Village clerk's phone:

## Contact Information if different than petitioner:

Representative's Name and Address:

LEVI & RACHELLE KRUIT  
4733 TOWER DR.  
EAU CLAIRE, WI 54703

Phone: 715/551/9548

E-mail:

Surveyor or Engineering Firm's Name & Address:

Phone:

E-mail:

## Required Items to be provided with submission (to be completed by petitioner):

1. ☐ Legal Description meeting the requirements of s. 66.0217 (1) (c) [see attached annexation guide]
2. ☐ Map meeting the requirements of s. 66.0217 (1) (g) [see attached annexation guide]
3. ☐ Signed Petition or Notice of Intent to Circulate is included
4. Indicate Statutory annexation method used:
  - ☐ Unanimous per s. 66.0217 (2), or,
  - OR
  - ☐ Direct by one-half approval per s. 66.0217 (3)
5. ☐ Check or money order covering review fee [see next page for fee calculation]

# Annexation Review Fee Schedule

A Guide for Calculating the Fee Required by ss.16.53 (4) and 66.0217, Wis. Stats.

## Required Fees

There is an initial filing fee and a variable review fee

\$ 200 **Initial Filing Fee** (required with the first submittal of all petitions)  
\$200 – 2 acres or less  
\$350 – 2.01 acres or more

\$ 200 **Review Fee** (required with all annexation submittals except those that consist ONLY of road right-of-way)  
\$200 – 2 acres or less  
\$600 – 2.01 to 10 acres  
\$800 – 10.01 to 50 acres  
\$1,000 – 50.01 to 100 acres  
\$1,400 – 100.01 to 200 acres  
\$2,000 – 200.01 to 500 acres  
\$4,000 – Over 500 acres

\$ 400 **TOTAL FEE DUE** (Add the Filing Fee to the Review Fee)

Attach check or money order here, payable to: Department of Administration

THE DEPARTMENT WILL NOT PROCESS  
AN ANNEXATION PETITION THAT IS NOT ACCOMPANIED  
BY THE REQUIRED FEE.

THE DEPARTMENT'S 20-DAY STATUTORY REVIEW PERIOD  
COMMENCES UPON RECEIPT OF THE PETITION AND REVIEW FEE

Shaded Area for Office Use Only

Date fee received: \_\_\_\_\_

Payee: \_\_\_\_\_

Check Number: \_\_\_\_\_

Check Date: \_\_\_\_\_

Amount: \_\_\_\_\_

## ANNEXATION SUBMITTAL GUIDE

### s. 66.0217 (5) THE PETITION

- ☐ State the purpose of the petition:
  - Direct annexation by unanimous approval; OR
  - Direct annexation by one-half approval; OR
  - Annexation by referendum.
- ☐ Petition must be signed by:
  - All owners and electors, if by unanimous approval.
  - See 66.0217 (3) (a), if by one-half approval.
  - See 66.0217 (3) (b), if by referendum.
- ☐ State the population of the land to be annexed.

*[It is beneficial to include Parcel ID or Tax numbers, the parcel area, and identify the annexee (Town) and annexor (Village or City) in the petition.]*

### s. 66.0217 (1) (c) THE DESCRIPTION

- ☐ The annexation petition must include a legal description of the land to be annexed. The land must be described by reference to the government lot, private claim, quarter-section, section, town and range in which the land lies. The land must be further described by metes and bounds commencing from a monumented corner of the section or quarter-section, or the monumented end of a private claim or federal reservation, in which the land lies; OR
- ☐ If the land is wholly and entirely within a lot or lots, or all of a block or blocks of a recorded subdivision plat or certified survey map, it must be described by reference to the lot (s) and/or block (s) therein, along with the name of the plat or the number, volume, page, and County of the certified survey map.
- ☐ The land may NOT be described by:
  - Aliquot part;
  - Reference to any other document (plat of survey, deed, etc.);
  - Exception or Inclusion;
  - Parcel ID or tax number.

### s. 66.0217 (1) (g) THE MAP

- ☐ The map shall be an **accurate reflection** of the legal description of the parcel being annexed. As such, it must show:
  - A tie line from the parcel to the monumented corner of the section or quarter-section, or the monumented end of a private claim or federal reservation, in which the parcel lies. The corner and monument must be identified.
  - Bearings and distances along all parcel boundaries as described.
  - All adjoining as referenced in the description.
- ☐ The map must include a **graphic scale**.
- ☐ The map must show and identify the existing municipal boundary, in relation to the parcel being annexed.

*[It is beneficial to include a North arrow, and identify adjacent streets and parcels on the map.]*

### s. 66.0217 FILING

- ☐ The petition must be filed with the Clerk of the annexing City or Village and with the Clerk of the Town in which the land is located.
- ☐ If the annexation is by one-half approval, or by referendum, the petitioner must post notice of the proposed annexation as required by s. 66.0217 (4).
- ☐ If the lands being annexed are within a County of 50,000 or greater population, the petition must also be filed with the Department of Administration for review

*[Note that no municipality within a County of 50,000 or greater population may enact an annexation ordinance prior to receiving a review determination from the Department of Administration.]*

**PETITION BY PROPERTY OWNER(S) FOR  
DIRECT ANNEXATION**

**TO THE HONORABLE CITY COUNCIL OF THE CITY OF EAU CLAIRE:**

The undersigned property owner(s), owning one hundred percent (100%) in area of the lands hereinafter described, and there being zero (0) resident elector(s) in said area, and said undersigned being also the owner(s) of one hundred percent (100%) of the real property and assessed valuation in said area in the following territory of the Town of Seymour lying contiguous to the City of Eau Claire, petition the Honorable Council of the City of Eau Claire to annex the territory described below and shown on the attached scale map to the City of Eau Claire, Eau Claire County, Wisconsin.

**KRUIT ANNEXATION  
4012 LaSalle Street  
Town of Seymour**

Part of the NW 1/4 of the NW 1/4 of Section 11, Township 27 North, Range 9 West, Town of Seymour, Eau Claire County, Wisconsin, described as follows:

Beginning at a point on the South line of said forty acre tract 10 rods East of the Southwest corner thereof;

thence East 10 rods;

thence North 32 rods;

thence West 10 rods;

thence South 32 rods to the point of beginning.

Parcel contains 87119.8 square feet or 2 acres.

Current population of such territory is zero (0).

<u>Signature of Petitioner</u>	<u>Address</u>	<u>Date of Signing</u>
<i>Leri K</i>	4733 TOWER DR. E.C., WI	4-13-18
<i>Rachelle K</i>	54703 "	4/13/18

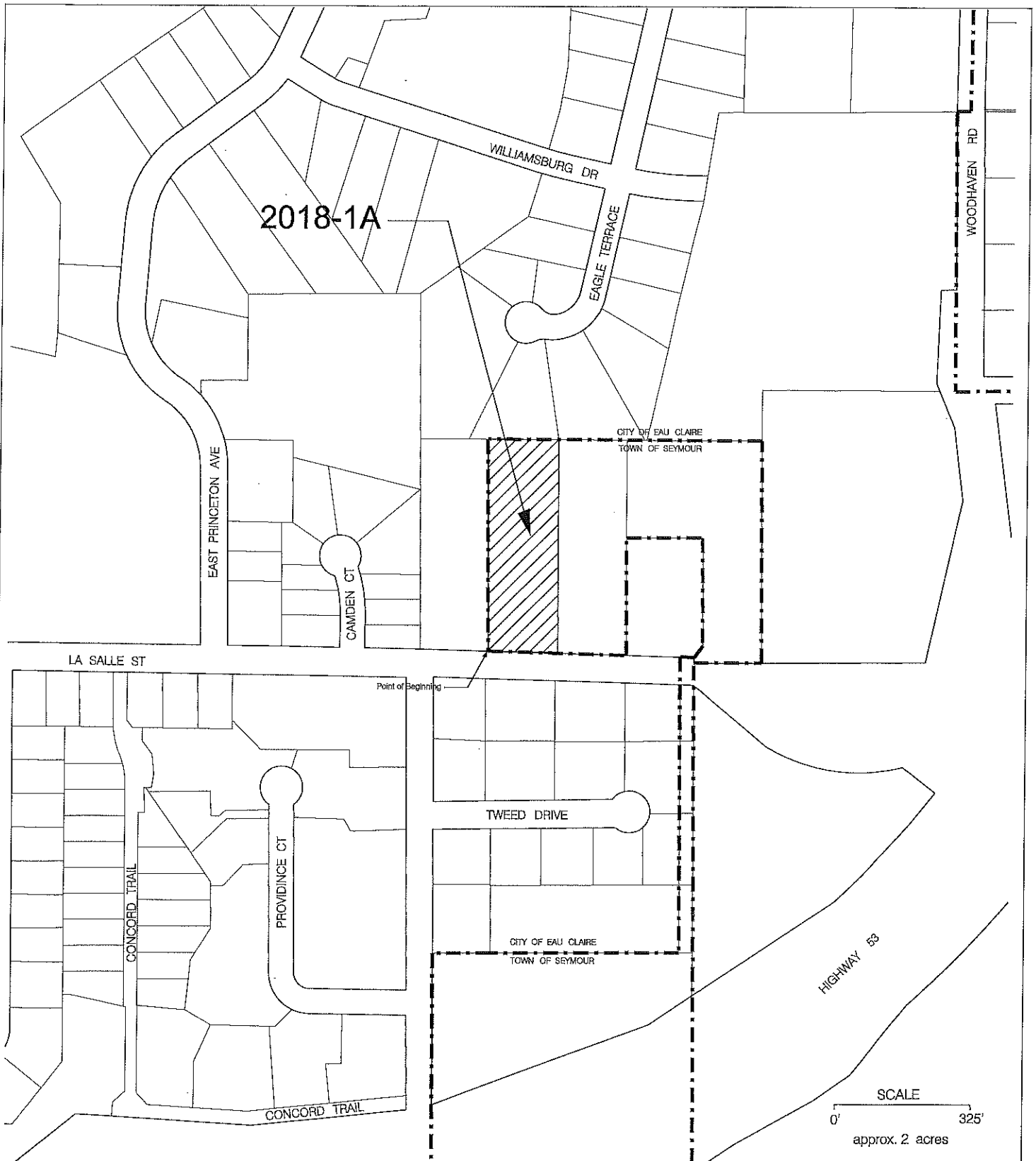

**DEPARTMENT OF COMMUNITY DEVELOPMENT  
CITY OF EAU CLAIRE, WI**

**DATE**  
**APRIL 20, 2018**

**ANNEXATION FILE #**  
**2018-1A**

**LOCATION**

THESE LANDS LOCATED IN THE  
NW 1 / 4 OF THE NW 1 / 4  
OF SECTION 11-27-09,  
TOWN OF SEYMOUR,  
EAU CLAIRE COUNTY



**SCALE**  
**1" = 325'**



SCOTT WALKER  
GOVERNOR  
ELLEN NOWAK  
SECRETARY

**Municipal Boundary Review**  
PO Box 1645, Madison WI 53701  
Voice (608) 264-6102 Fax (608) 264-6104  
Email: [wimunicipalboundaryreview@wi.gov](mailto:wimunicipalboundaryreview@wi.gov)  
Web: <http://doa.wi.gov/municipalboundaryreview>

---

April 27, 2018

PETITION FILE NO. 14114

CARRIE RIEPL, CLERK  
CITY OF EAU CLAIRE  
PO BOX 5148  
EAU CLAIRE, WI 54702-5148

SUSAN LARSON, CLERK  
TOWN OF SEYMOUR  
6500 TOWER DR  
EAU CLAIRE, WI 54703-9722

Subject: KRUIT ANNEXATION

Section 66.0217 (6), Wis. Stats., provides that the annexation of lands to cities and villages within a county having a population of 50,000 or more shall be reviewed by the Department of Administration in order to determine if the proposed annexation is in the public interest or against the public interest. The proposed annexation from the TOWN OF SEYMOUR to the CITY OF EAU CLAIRE (see attached description) must be reviewed pursuant to the statute.

To assist us in making this determination, we urge that you promptly supply the data requested on the enclosed questionnaire (where possible) and return the questionnaire to the department.

The purpose of this questionnaire is to assist the department in determining "Whether the governmental services, including zoning, to be supplied to the territory could clearly be better supplied by the town...." The statute further stipulates that the department shall study the "shape of the proposed annexation and the homogeneity of the territory with the annexing municipality." In addition, we would appreciate receiving from you any comments or information bearing on governmental services or shape and homogeneity that would indicate whether the annexation is in or against the public interest.

Please return the questionnaire as soon as possible so that the information can be reviewed prior to the department's statutory deadline of May 15, 2018. Direct any questions and comments to Erich Schmidtke at (608) 264-6102. Thank you for your cooperation.

For additional information on annexation or other land use issues, visit our web site at <http://doa.wi.gov/municipalboundaryreview/>.

Sincerely,

Erich Schmidtke

Enclosures

# Annexation Review Questionnaire

Wisconsin Department of Administration

WI Dept. of Administration  
Municipal Boundary Review  
PO Box 1645  
Madison WI 53701  
608-264-6102 Fax: 608-264-6104  
[wimunicipalboundaryreview@wi.gov](mailto:wimunicipalboundaryreview@wi.gov)  
<http://doa.wi.gov/municipalboundaryreview>

Petitioner: Kruit

Petition Number: 14114

1. Territory to be annexed: From TOWN OF SEYMOUR To CITY OF EAU CLAIRE

2. Area (Acres): 2

3. Pick one: ☐ Property Tax Payments

OR ☐ Boundary Agreement

a. Annual town property tax on territory to be annexed:

\$

a. Title of boundary agreement

b. Year adopted

b. Total that will be paid to Town

(annual tax multiplied by 5 years):

c. Participating jurisdictions

d. Statutory authority (pick one)

c. Paid by: ☐ Petitioner ☒ City ☐ Village

☐ s.66.0307 ☐ s.66.0225 ☐ s.66.0301

☐ Other:

4. Resident Population: Electors: 0 Total: 0

5. Approximate present land use of territory:

Residential: 50 % Recreational: % Commercial: % Industrial: %

Undeveloped: 50 %

6. If territory is undeveloped, what is the anticipated use?

Residential: 50 % Recreational: % Commercial: % Industrial: %

Other: 50 %

Comments:

7. Has a ☐ preliminary or ☐ final plat been submitted to the Plan Commission: ☐ Yes ☒ No

Plat Name:

8. What is the nature of land use adjacent to this territory in the city or village?

Residential

In the town?:

9. What are the basic service needs that precipitated the request for annexation?

☒ Sanitary sewer ☒ Water supply ☒ Storm sewers

☒ Police/Fire protection ☒ EMS ☒ Zoning

Other:

10. Is the city/village or town capable of providing needed utility services?

City/Village ☒ Yes ☐ No Town ☐ Yes ☐ No

If yes, approximate timetable for providing service: City/Village Town

Sanitary Sewers immediately ☒ ☐  
or, write in number of years. \_\_\_\_\_

Water Supply immediately ☒ ☐  
or, write in number of years. \_\_\_\_\_

Will provision of sanitary sewers and/or water supply to the territory proposed for annexation require capital expenditures (i.e. treatment plant expansion, new lift stations, interceptor sewers, wells, water storage facilities)?

☐ Yes ☒ No

If yes, identify the nature of the anticipated improvements and their probable costs: \_\_\_\_\_

11. Planning & Zoning:

a. Do you have a comprehensive plan for the City/Village/Town? ☒ Yes ☐ No

Is this annexation consistent with your comprehensive plan? ☒ Yes ☐ No

b. How is the annexation territory now zoned? R-1L

c. How will the land be zoned and used if annexed? R-1

12. Elections: ☒ New ward or ☐ Existing ward? Will the annexation create a new ward or join an existing ward? For more information, please contact the Wisconsin Election Commission at (608) 266-8005, [elections@wi.gov](mailto:elections@wi.gov) or see their annexation checklist here: <http://elections.wi.gov/forms/el-100>

13. Other relevant information and comments bearing upon the public interest in the annexation:

Prepared by: ☐ Town ☒ City ☐ Village

Name: Ryan Petre

Email: Ryan.Petre@eauclairewi.gov

Phone: 715-839-4914

Date: 5/1/18

(March 2018)

Please **RETURN PROMPTLY** to:

[wimunicipalboundaryreview@wi.gov](mailto:wimunicipalboundaryreview@wi.gov)

Municipal Boundary Review

PO Box 1645, Madison WI 53701

Fax: (608) 264-6104



# Annexation Review Questionnaire

Wisconsin Department of Administration

WI Dept. of Administration  
Municipal Boundary Review  
PO Box 1645  
Madison WI 53701  
608-264-6102 Fax: 608-264-6104  
[wimunicipalboundaryreview@wi.gov](mailto:wimunicipalboundaryreview@wi.gov)  
<http://doa.wi.gov/municipalboundaryreview>

Petitioner: **Kruit**

Petition Number: **14114**

1. Territory to be annexed: From **TOWN OF SEYMOUR** To **CITY OF EAU CLAIRE**

2. Area (Acres): 2 acres

3. Pick one: ☒ Property Tax Payments

OR ☐ Boundary Agreement

a. Annual town property tax on territory to be annexed:

\$ 169.79

a. Title of boundary agreement \_\_\_\_\_

b. Year adopted \_\_\_\_\_

b. Total that will be paid to Town

(annual tax multiplied by 5 years): 848.95

c. Participating jurisdictions \_\_\_\_\_

d. Statutory authority (pick one)

c. Paid by: ☐ Petitioner ☒ City ☐ Village

☐ s.66.0307 ☐ s.66.0225 ☐ s.66.0301

☐ Other: \_\_\_\_\_

4. Resident Population: \_\_\_\_\_ Electors: \_\_\_\_\_ Total: \_\_\_\_\_

5. Approximate **present land use** of territory:

Residential: 100 % Recreational: \_\_\_\_\_ % Commercial: \_\_\_\_\_ % Industrial: \_\_\_\_\_ %

Undeveloped: \_\_\_\_\_ %

6. If territory is undeveloped, what is the **anticipated use**?

Residential: \_\_\_\_\_ % Recreational: \_\_\_\_\_ % Commercial: \_\_\_\_\_ % Industrial: \_\_\_\_\_ %

Other: \_\_\_\_\_ %

Comments: \_\_\_\_\_

7. Has a ☐ preliminary or ☐ final plat been submitted to the Plan Commission: ☐ Yes ☐ No

Plat Name: \_\_\_\_\_

8. What is the **nature of land use adjacent** to this territory in the city or village?

Residential

In the town?: Residential

9. What are the **basic service needs** that precipitated the request for annexation?

☒ Sanitary sewer

☒ Water supply

☐ Storm sewers

☐ Police/Fire protection

☐ EMS

☐ Zoning

Other \_\_\_\_\_

*I'm assuming this is  
what precipitated the  
request - not stated  
anywhere*

10. Is the city/village or town capable of providing needed utility services?

City/Village ☐ Yes ☐ No Town ☐ Yes ☒ No

If yes, approximate timetable for providing service: City/Village Town

Sanitary Sewers immediately ☐ ☐  
or, write in number of years. \_\_\_\_\_

Water Supply immediately ☐ ☐  
or, write in number of years. \_\_\_\_\_

Will provision of sanitary sewers and/or water supply to the territory proposed for annexation require capital expenditures (i.e. treatment plant expansion, new lift stations, interceptor sewers, wells, water storage facilities)?

☐ Yes ☐ No

If yes, identify the nature of the anticipated improvements and their probable costs: \_\_\_\_\_

11. Planning & Zoning:

a. Do you have a comprehensive plan for the City/Village/Town? ☒ Yes ☐ No

Is this annexation consistent with your comprehensive plan? ☒ Yes ☐ No

b. How is the annexation territory now zoned? RL - Residential - Large Lot

c. How will the land be zoned and used if annexed? \_\_\_\_\_

12. Elections: ☐ New ward or ☐ Existing ward? Will the annexation create a new ward or join an existing ward? For more information, please contact the Wisconsin Election Commission at (608) 266-8005, [elections@wi.gov](mailto:elections@wi.gov) or see their annexation checklist here: <http://elections.wi.gov/forms/el-100>

13. Other relevant information and comments bearing upon the public interest in the annexation:

Prepared by: ☒ Town ☐ City ☐ Village

Name: SUSAN LARSON

Email: seymour.town@att.net

Phone: 715-834-4999

Date: 5-1-18

Please **RETURN PROMPTLY** to:

[wimunicipalboundaryreview@wi.gov](mailto:wimunicipalboundaryreview@wi.gov)

Municipal Boundary Review

PO Box 1645, Madison WI 53701

Fax: (608) 264-6104

(March 2018)



SCOTT WALKER

GOVERNOR

ELLEN NOWAK

SECRETARY

**Municipal Boundary Review**

PO Box 1645, Madison WI 53701

Voice (608) 264-6102 Fax (608) 264-6104

Email: [wimunicipalboundaryreview@wi.gov](mailto:wimunicipalboundaryreview@wi.gov)

Web: <http://doa.wi.gov/municipalboundaryreview>

May 16, 2018

PETITION FILE NO. 14114

CARRIE RIEPL, CLERK  
CITY OF EAU CLAIRE  
PO BOX 5148  
EAU CLAIRE, WI 54702-5148

SUSAN LARSON, CLERK  
TOWN OF SEYMOUR  
6500 TOWER DR  
EAU CLAIRE, WI 54703-9722

Subject: KRUIT ANNEXATION

The proposed annexation submitted to our office on April 25, 2018, has been reviewed and found to be in the public interest. In determining whether an annexation is in the public interest, s. 66.0217 (6), Wis. Stats. requires the Department to examine "[t]he shape of the proposed annexation and the homogeneity of the territory with the annexing village or city...." so as, to ensure the resulting boundaries are rational and compact. The statute also requires the Department to consider whether the annexing city or village can provide needed municipal services to the territory. The subject petition is for territory that is reasonably shaped and contiguous to the **CITY OF EAU CLAIRE**, which is able to provide needed municipal services.

The Department reminds clerks of annexing municipalities of the requirements of s. 66.0217 (9)(a), Wis. Stats., which states:

"The clerk of a city or village which has annexed shall file immediately with the secretary of administration a certified copy of the ordinance, certificate and plat, and shall send one copy to each company that provides any utility service in the area that is annexed. The clerk shall record the ordinance with the register of deeds and file a signed copy of the ordinance with the clerk of any affected school district..."

State and federal aids based on population and equalized value may be significantly affected through failure to file with the Department of Administration. Please file a copy of your annexing ordinance, including a statement certifying the population of the annexed territory. **Please include your MBR number 14114 with your ordinance.** Ordinance filing checklist available at <http://mds.wi.gov/>, click on "Help on How to Submit Municipal Records". Email scanned copy of required materials (color scan maps with color) to [mds@wi.gov](mailto:mds@wi.gov) or mail to: Wisconsin Department of Administration, Municipal Boundary Review, PO Box 1645, Madison WI 53701-1645.

The petition file is available for viewing at: <http://mds.wi.gov/View/Petition?ID=2187>

Please call me at (608) 264-6102, should you have any questions concerning this annexation review.

Sincerely,

Erich Schmidtke, Municipal Boundary Review

cc: petitioner