

# Request for Annexation Review

Wisconsin Department of Administration

WI Dept. of Administration  
Municipal Boundary Review  
PO Box 1645, Madison WI 53701  
608-264-6102 Fax: 608-264-6104  
[wimunicipalboundaryreview@wi.gov](mailto:wimunicipalboundaryreview@wi.gov)  
<http://doa.wi.gov/municipalboundaryreview>

## Petitioner Information

Name: Kevin & Elizabeth Schippers

Address: S 10535 Hemlock Rd  
Mondovi, WI 54755

Email: hunterschippers@gmail.com

Office use only:

Received  
4-9-2021

1. Town where property is located: Union

2. Petitioned City or Village: Eau Claire

3. County where property is located: Eau Claire

4. Population of the territory to be annexed: Single family .4

5. Area (in acres) of the territory to be annexed: .5

6. Tax parcel number(s) of territory to be annexed  
(if the territory is part or all of an existing parcel) 1902222710132200001

Petitioners phone:

715 829 0565

Town clerk's phone:

715 874 6123

City/Village clerk's phone:

John McLaughlin

## Contact Information if different than petitioner:

Representative's Name and Address:

Phone:

E-mail:

Surveyor or Engineering Firm's Name & Address:

Phone:

E-mail:

## Required Items to be provided with submission (to be completed by petitioner):

1. ☒ Legal Description meeting the requirements of s.66.0217 (1) (c) [see attached annexation guide]
2. ☒ Map meeting the requirements of s. 66.0217 (1) (g) [see attached annexation guide]
3. ☒ Signed Petition or Notice of Intent to Circulate is included
4. Indicate Statutory annexation method used:
  - ☒ Unanimous per s. 66.0217 (2), or,
  - OR
  - ☐ Direct by one-half approval per s. 66.0217 (3)
5. ☒ Check or money order covering review fee [see next page for fee calculation]

# Annexation Review Fee Schedule

A Guide for Calculating the Fee Required by ss.16.53 (4) and 66.0217, Wis. Stats.

## Required Fees

There is an initial filing fee and a variable review fee

\$200 - **Initial Filing Fee** (required with the first submittal of all petitions)

\$200 – 2 acres or less

\$350 – 2.01 acres or more

\$200 - **Review Fee** (required with all annexation submittals except those that consist ONLY of road right-of-way)

\$200 – 2 acres or less

\$600 – 2.01 to 10 acres

\$800 – 10.01 to 50 acres

\$1,000 – 50.01 to 100 acres

\$1,400 – 100.01 to 200 acres

\$2,000 – 200.01 to 500 acres

\$4,000 – Over 500 acres

\$400 - **TOTAL FEE DUE** (Add the Filing Fee to the Review Fee)

**Attach** check or money order here, payable to: **Department of Administration**

**THE DEPARTMENT WILL NOT PROCESS  
AN ANNEXATION PETITION THAT IS NOT ACCOMPANIED  
BY THE REQUIRED FEE.**

**THE DEPARTMENT'S 20-DAY STATUTORY REVIEW PERIOD  
COMMENCES UPON RECEIPT OF THE PETITION AND REVIEW FEE**

Shaded Area for Office Use Only

Date fee received: 4-9-2021

Payee: ELIZABETH SCHIPPERS

Check Number: 1034

Check Date: 3-15-21

Amount: 400<sup>00</sup>

**SCHIPPERS ANNEXATION**  
**Town of Union**

A parcel of land located in the NW1/4 of the NW1/4 of Section 13, Township 27 North, Range 10 West, Town of Union, Eau Claire County, Wisconsin, more particularly described as:

Commencing at the Northwest corner of said Section 13;  
thence South along the west line of said NW1/4, 29 Rods 5 1/2 feet (484 feet) to the point of beginning;  
thence continuing South along said west line, 8 Rods (132 feet);  
thence East 10 Rods (165 feet);  
thence North 8 Rods (132 feet);  
thence West 10 Rods (165 feet) to the point of beginning.

Parcel contains 0.5 acres more or less

City of Eau Claire  
Attention: Planning  
P O Box 5148  
Eau Claire, WI 54702-5148

March 15, 2021

Petition for Annexation of Parcel #1802222710132200001/022103801000  
Sec. 13, T27N, R10W  
PRT NW-NW THE S 132' OF N 616' OF W 165' THEREOF  
0.05000 ACRES

This petition is for a single family property located at 2623 Preston Road, Eau Claire, WI 54703.  
The owners, Kevin D. and Elizabeth H. Schippers request that this parcel be annexed to the City of Eau Claire for use of the city water and sanitary systems.

Kevin D. Schippers

  
kdschippers@gmail.com

Elizabeth H. Schippers

  
hunterschippers@gmail.com

Mailing address:  
S10535 Hemlock Rd.  
Mondovi, WI 54755  
715-829-0565

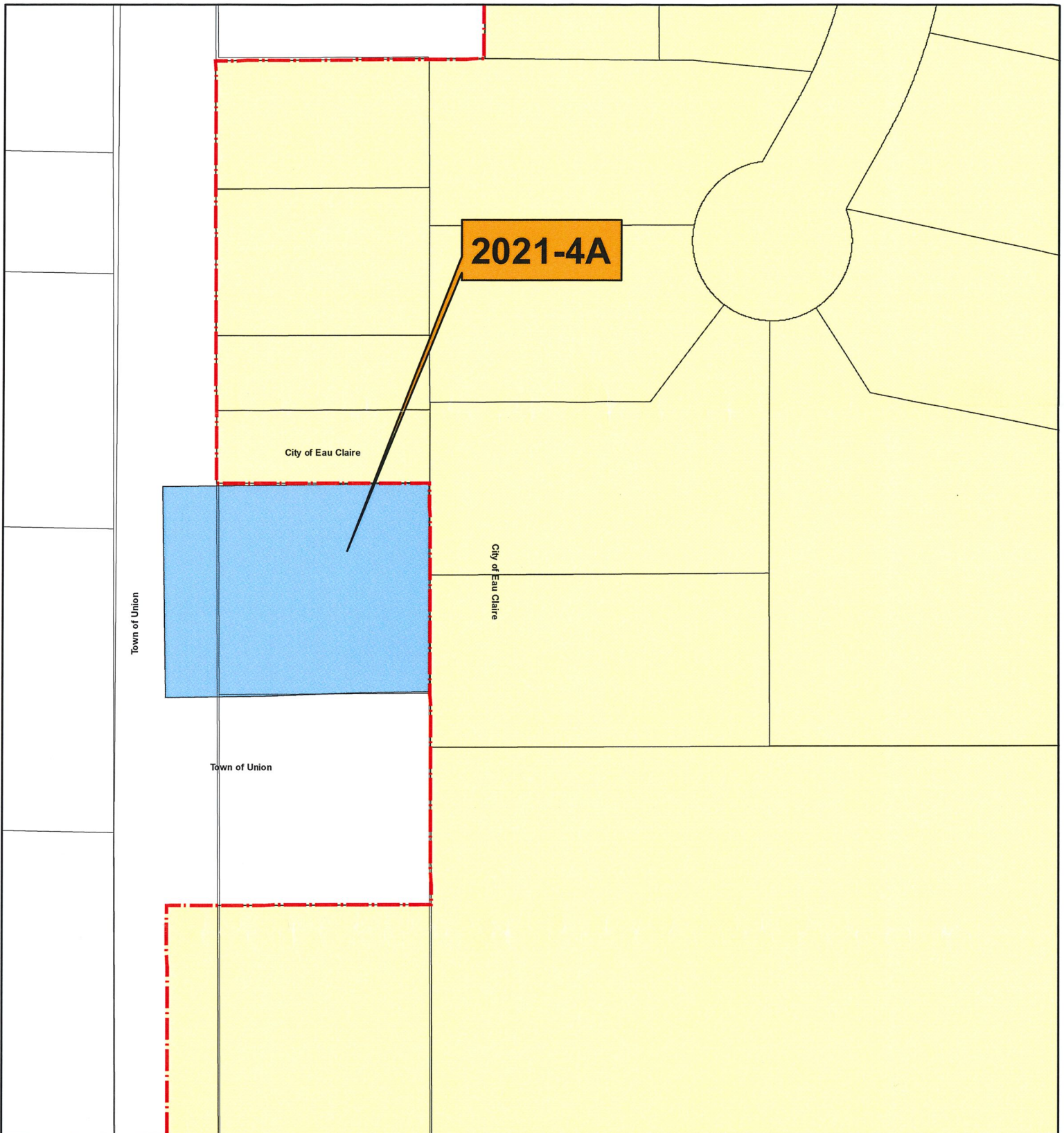

CITY OF  
**EAU  
CLAIRE**

**ANNEXATION FILE #**  
**2021-4A**

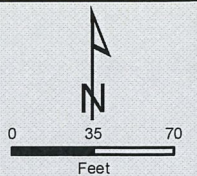

**DATE**  
**4-1-21**

Lands located in Town of Union  
Eau Claire County

# Annexation Review Questionnaire

Wisconsin Department of Administration

WI Dept. of Administration  
Municipal Boundary Review  
PO Box 1645  
Madison WI 53701  
608-264-6102 Fax: 608-264-6104  
[wimunicipalboundaryreview@wi.gov](mailto:wimunicipalboundaryreview@wi.gov)  
<http://doa.wi.gov/municipalboundaryreview>

Petitioner: **Schippers**

Petition Number: **14383**

1. Territory to be annexed: From **TOWN OF UNION**

To **CITY OF EAU CLAIRE**

2. Area (Acres): 0.5

3. Pick one: ☐ Property Tax Payments

OR

☐ Boundary Agreement

a. Annual town property tax on territory to be annexed:

\$ \_\_\_\_\_

b. Total that will be paid to Town

(annual tax multiplied by 5 years): \_\_\_\_\_

c. Paid by: ☐ Petitioner ☐ City ☐ Village

☐ Other: \_\_\_\_\_

a. Title of boundary agreement \_\_\_\_\_

b. Year adopted \_\_\_\_\_

c. Participating jurisdictions \_\_\_\_\_

d. Statutory authority (pick one)

☐ s.66.0307 ☐ s.66.0225 ☐ s.66.0301

4. Resident Population: \_\_\_\_\_ Electors: 2 Total: 4

5. Approximate **present land use** of territory:

Residential: 50 % Recreational: \_\_\_\_\_ % Commercial: \_\_\_\_\_ % Industrial: \_\_\_\_\_ %

Undeveloped: 50 %

6. If territory is undeveloped, what is the **anticipated use**?

Residential: 100 % Recreational: \_\_\_\_\_ % Commercial: \_\_\_\_\_ % Industrial: \_\_\_\_\_ %

Other: \_\_\_\_\_ %

Comments: \_\_\_\_\_

7. Has a ☐ preliminary or ☐ final plat been submitted to the Plan Commission: ☐ Yes ☐ No

Plat Name: \_\_\_\_\_

8. What is the **nature of land use adjacent** to this territory in the city or village?

Residential/Vacant

In the town?: \_\_\_\_\_

9. What are the **basic service needs** that precipitated the request for annexation?

☒ Sanitary sewer

☒ Water supply

☒ Storm sewers

☒ Police/Fire protection

☒ EMS

☒ Zoning

Other \_\_\_\_\_

10. Is the city/village or town capable of providing needed utility services?

City/Village ☒ Yes ☐ No

Town ☐ Yes ☐ No

If yes, approximate timetable for providing service:

City/Village Town

Sanitary Sewers immediately

☒

☐

or, write in number of years. \_\_\_\_\_

\_\_\_\_\_

\_\_\_\_\_

Water Supply immediately

☒

☐

or, write in number of years. \_\_\_\_\_

\_\_\_\_\_

\_\_\_\_\_

Will provision of sanitary sewers and/or water supply to the territory proposed for annexation require capital expenditures (i.e. treatment plant expansion, new lift stations, interceptor sewers, wells, water storage facilities)?

☐ Yes ☐ No

If yes, identify the nature of the anticipated improvements and their probable costs: \_\_\_\_\_

11. Planning & Zoning:

a. Do you have a comprehensive plan for the City/Village/Town? ☒ Yes ☐ No

Is this annexation consistent with your comprehensive plan? ☒ Yes ☐ No

b. How is the annexation territory now zoned? \_\_\_\_\_

c. How will the land be zoned and used if annexed? R-2

12. Elections: ☐ New ward or ☐ Existing ward? Will the annexation create a new ward or join an existing ward? For more information, please contact the Wisconsin Election Commission at (608) 266-8005, [elections@wi.gov](mailto:elections@wi.gov) or see their annexation checklist here: <http://elections.wi.gov/forms/el-100>

13. Other relevant information and comments bearing upon the public interest in the annexation:

Prepared by: ☐ Town ☒ City ☐ Village

Name: Ryan Petrie

Email: Ryan.Petrie@brocktonwi.gov

Phone: 715-839-4914

Date: 4-19-21

(March 2018)

Please **RETURN PROMPTLY** to:

[wimunicipalboundaryreview@wi.gov](mailto:wimunicipalboundaryreview@wi.gov)

Municipal Boundary Review

PO Box 1645, Madison WI 53701

Fax: (608) 264-6104





# Surface Water Data Viewer Map

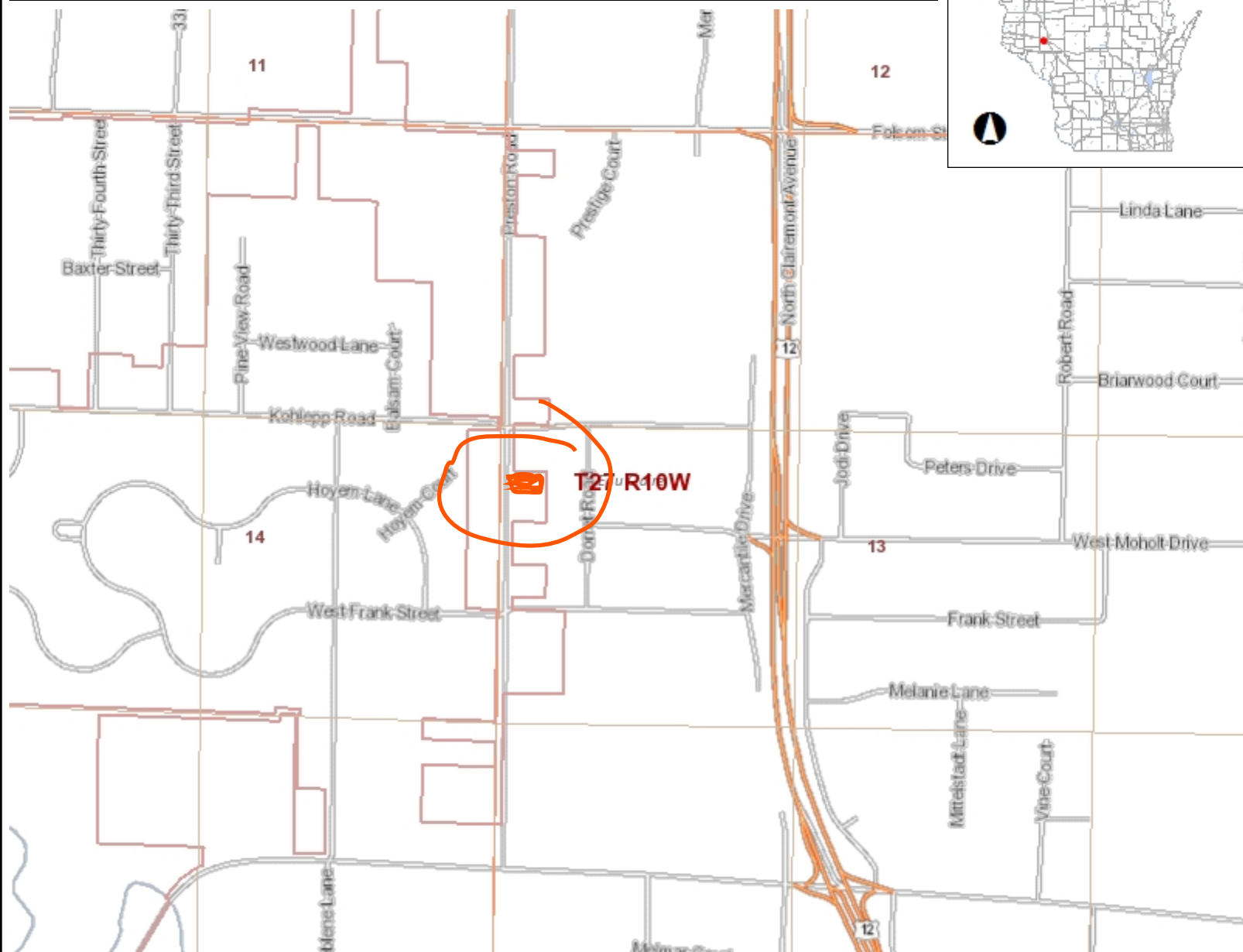

## Legend

- Township
- Section
- Quarter-Quarter
- County Boundary
- Cities, Towns & Villages
  - City
  - Village
  - Civil Town
- Municipality
- State Boundaries
- County Boundaries
- Major Roads
  - Interstate Highway
  - State Highway
  - US Highway
- County and Local Roads
  - County HWY
  - Local Road
- Railroads
- Tribal Lands
- Rivers and Streams
- Intermittent Streams
- Lakes and Open water

0.3 0 0.13 0.3 Miles

NAD\_1983\_HARN\_Wisconsin\_TM

1: 7,920

DISCLAIMER: The information shown on these maps has been obtained from various sources, and are of varying age, reliability and resolution. These maps are not intended to be used for navigation, nor are these maps an authoritative source of information about legal land ownership or public access. No warranty, expressed or implied, is made regarding accuracy, applicability for a particular use, completeness, or legality of the information depicted on this map. For more information, see the DNR Legal Notices web page: <http://dnr.wi.gov/legal/>

## Notes





Meanders of Chippewa River.								
Posts	Courses	Ch. <sup>2</sup> Lk.	Posts	Courses	Ch. <sup>2</sup> Lk.	Posts	Courses	Ch. <sup>2</sup> Lk.
Left bank, up stream.								
			10	N. 67 1/2° W.	7.50			
				N. 75° W.	3.90			
1	N. 58° E.	3.00						
	S. 68° E.	13.00		N. 75° W.	10.50			
	S. 50° E.	7.50		West	21.00			
	S. 24° E.	14.00		N. 84° W.	5.00			
	S. 24 1/2° E.	24.00		S. 67 1/2° W.	5.50			
2	S. 77 1/2° E.	13.18		S. 54° W.	2.00			
			11	S. 54 1/2° W.	2.50			
3	N. 27 1/2° E.	13.00						
	N. 41° E.	15.00		S. 64 1/2° W.	2.00			
	N. 50° E.	3.00		S. 53 1/2° W.	2.00			
	N. 60° E.	4.50		S. 45° W.	8.00			
	N. 71 1/2° E.	5.10		S. 38 1/2° W.	4.00			
	N. 50 1/2° E.	2.00		S. 40 3/4° W.	3.00			
	N. 60° E.	6.00		S. 31° W.	2.00			
	N. 29° E.	5.00		S. 40° W.	3.50			
4	N. 60° E.	2.50		S. 66 1/2° W.	5.50			
				S. 73° W.	10.00			
	N. 45° E.	2.50	12	S. 62° W.	5.00			
	N. 17° E.	2.50						
	N. 60° E.	2.50		S. 49° W.	7.00			
	N. 61° E.	6.00		S. 62° W.	8.00			
	N. 68 1/2° E.	5.50		S. 84° W.	8.00			
	N. 75 1/2° E.	3.50		S. 42 1/2° W.	13.50			
	N. 58° E.	7.00		S. 44 1/2° W.	3.50			
	N. 43° E.	18.00		S. 36° W.	3.50			
	N. 64 1/2° E.	10.00		S. 19 1/2° E.	1.50			
	N. 84 1/2° E.	12.00		S. 26° W.	7.00			
	S. 86° E.	6.00		S. 40 1/2° W.	7.00			
	S. 74° E.	10.00	13	S. 35° W.	16.00			
5	S. 51 1/2° E.	8.50						
			14	N. 57 1/2° W.	12.69			
	S. 55° E.	7.00		N. 75 3/4° W.	5.00			
	S. 51 1/2° E.	15.00		S. 86° W.	6.00			
	S. 70 3/4° E.	13.50		S. 84° W.	4.50			
	N. 51 1/2° E.	10.00	15	S. 63 1/2° W.	7.00			
	N. 74° E.	6.00						
	N. 51 1/2° E.	7.00		West	12.00			
	N. 41 1/2° E.	3.00		N. 81° W.	14.00			
	N. 36° E.	19.00		N. 74 1/2° W.	8.00			
6	N. 32° E.	4.00		S. 89 1/2° W.	14.00			
				N. 78° W.	10.00			
	N. 22 3/4° W.	14.00		N. 86 3/4° W.	5.00			
	N. 9° W.	9.00		N. 59° W.	10.00			
	N. 5° E.	24.00	16	S. 85° W.	8.00			
	N. 33° E.	7.50						
	N. 32 1/2° E.	7.00		S. 85 1/2° W.	14.50			
7	N. 52° E.	12.50		West	6.00			
				N. 72 1/2° W.	9.00			
Right bank, down stream.				N. 58 3/4° W.	7.00			
				N. 49 1/2° W.	4.00			
8	S. 81° W.	6.20		N. 26° W.	10.50			
	N. 78° W.	6.50		N. 15° W.	10.00			
	S. 49° W.	10.00		N. 43° W.	26.00			
	S. 35° W.	5.00		N. 37 1/2° W.	3.00			
	S. 34° W.	23.00	17	N. 72° W.	14.60			
	S. 17° W.	8.25						
	S. 3 1/2° E.	21.00		Nls	Chs.	Trs.		
	S. 27° E.	10.00	Total	11	54	92		
9	S. 14 1/2° E.	3.00						
	S. 4 1/2° E.	5.00						
	S. 20 1/2° W.	5.00						
	S. 52° W.	10.00						
	S. 68° W.	7.50						
	N. 44 3/4° W.	11.00						
	N. 47° W.	17.50						

	Surveys Designated	By Whom Surveyed	Date of Contract	Amount of Surveys	When Surveyed	When p <sup>d</sup> for and ch <sup>d</sup> in the Sur <sup>t</sup> Gen <sup>l</sup> acc <sup>t</sup>
W. & S.	Township lines, Subdivisions,	James E. Freeman	July 15 <sup>th</sup> 1848	M. Ch <sup>d</sup> Lks. 17 - 73 - 03	October, 1848	
		Alexander Anderson	July 11 <sup>th</sup> 1849	70 - 25 - 12	July 8 <sup>th</sup> August 1849	
E.	Township line,	George O. Harrick	July 18 <sup>th</sup> 1848	5 - 77 - 50	September, 1848	

The above Map of Township 19 27 North of Range 19 10 West of the 4<sup>th</sup> Principal Meridian, Wisconsin, is strictly conformable to the field notes of the survey thereof on file in this Office, which have been examined and approved.

Surveyor General's Office.  
 Dubuque, Dec. 11, 1849.

C. H. Booth  
 Sur. Gen.





TONY EVERS

GOVERNOR

JOEL BRENNAN

SECRETARY

**Municipal Boundary Review**

PO Box 1645, Madison WI 53701

Voice (608) 264-6102 Fax (608) 264-6104

Email: [wimunicipalboundaryreview@wi.gov](mailto:wimunicipalboundaryreview@wi.gov)

Web: <http://doa.wi.gov/municipalboundaryreview>

April 28, 2021

PETITION FILE NO. 14383

CARRIE RIEPL, CLERK  
CITY OF EAU CLAIRE  
PO BOX 5148  
EAU CLAIRE, WI 54702-5148

BEVERLY CHRISTOPHERSON, CLERK  
TOWN OF UNION  
1506 N TOWN HALL RD  
EAU CLAIRE, WI 54703-9018

Subject: SCHIPPERS ANNEXATION

The proposed annexation submitted to our office on April 09, 2021, has been reviewed and found to be in the public interest. In determining whether an annexation is in the public interest, s. 66.0217 (6), Wis. Stats. requires the Department to examine "[t]he shape of the proposed annexation and the homogeneity of the territory with the annexing village or city...." so as, to ensure the resulting boundaries are rational and compact. The statute also requires the Department to consider whether the annexing city or village can provide needed municipal services to the territory. The subject petition is for territory that is reasonably shaped and contiguous to the **CITY OF EAU CLAIRE**, which is able to provide needed municipal services.

The Department reminds clerks of annexing municipalities of the requirements of s. 66.0217 (9)(a), Wis. Stats., which states:

"The clerk of a city or village which has annexed shall file immediately with the secretary of administration a certified copy of the ordinance, certificate and plat, and shall send one copy to each company that provides any utility service in the area that is annexed. The clerk shall record the ordinance with the register of deeds and file a signed copy of the ordinance with the clerk of any affected school district..."

State and federal aids based on population and equalized value may be significantly affected through failure to file with the Department of Administration. Please file a copy of your annexing ordinance, including a statement certifying the population of the annexed territory. **Please include your MBR number 14383 with your ordinance.** Ordinance filing checklist available at <http://mds.wi.gov/>, click on "Help on How to Submit Municipal Records". Email scanned copy of required materials (color scan maps with color) to [mds@wi.gov](mailto:mds@wi.gov) or mail to: Wisconsin Department of Administration, Municipal Boundary Review, PO Box 1645, Madison WI 53701-1645.

The petition file is available for viewing at: <http://mds.wi.gov/View/Petition?ID=2457>  
Please call me at (608) 264-6102, should you have any questions concerning this annexation review.

Sincerely,

Erich Schmidtke, Municipal Boundary Review

cc: petitioner